

1-Rescue  
1-Standard Tex  
1-Brown  
1-File

(SUBMIT IN TRIPLICATE)

UNITED STATES  
DEPARTMENT OF THE INTERIOR  
GEOLOGICAL SURVEY

Budget Bureau No. 42-R358.4.  
Approval expires 12-31-60.

Land Office **Santa Fe**  
Lease No. **87 080202**  
Unit \_\_\_\_\_

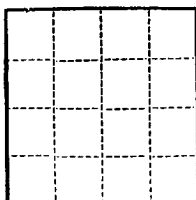

SUNDRY NOTICES AND REPORTS ON WELLS

NOTICE OF INTENTION TO DRILL _____	<input checked="" type="checkbox"/>	SUBSEQUENT REPORT OF WATER SHUT-OFF _____
NOTICE OF INTENTION TO CHANGE PLANS _____		SUBSEQUENT REPORT OF SHOOTING OR ACIDIZING _____
NOTICE OF INTENTION TO TEST WATER SHUT-OFF _____		SUBSEQUENT REPORT OF ALTERING CASING _____
NOTICE OF INTENTION TO RE-DRILL OR REPAIR WELL _____		SUBSEQUENT REPORT OF RE-DRILLING OR REPAIR _____
NOTICE OF INTENTION TO SHOOT OR ACIDIZE _____		SUBSEQUENT REPORT OF ABANDONMENT _____
NOTICE OF INTENTION TO PULL OR ALTER CASING _____		SUPPLEMENTARY WELL HISTORY _____
NOTICE OF INTENTION TO ABANDON WELL _____		

(INDICATE ABOVE BY CHECK MARK NATURE OF REPORT, NOTICE, OR OTHER DATA)

August 7

19 58

Well No. **Brown 1-24** is located **1980** ft. from **N** line and **1980** ft. from **E** line of sec. **24**  
**NW 1/4 Sec 24** **24N** **7W** **RMPM**  
 (1/4 Sec. and Sec. No.) (Twp.) (Range) (Meridian)  
**Escrito Ext.** **Rio Arriba** **New Mexico**  
 (Field) (County or Subdivision) (State or Territory)

The elevation of the ~~ground~~ **derrick floor** above sea level is **6652** ft.

DETAILS OF WORK

(State names of and expected depths to objective sands; show sizes, weights, and lengths of proposed casings; indicate mudding jobs, cementing points, and all other important proposed work)

Drill 12 1/2" hole to 236' set 8-5/8" J-55 csg; cemented w/125 sz. Drill 7-7/8" hole to 5660 and set 5 1/2" 15# J-55 csg cemented w/200 sz. It is intended to cut 100' of core through the lower Gallup sand. The well will be SOF w/approx 50,000 gal crude & 50,000# sd. Tbg run & the well completed.

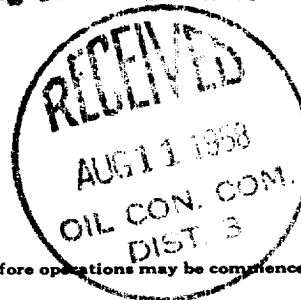

I understand that this plan of work must receive approval in writing by the Geological Survey before operations may be commenced.

Company **Val R. Reese & Assoc., Inc.**

Address **129 S. Commercial**

**Farmington, New Mexico**

By **Original signed by T. A. Dugan**

Title **Consulting Engineer**

NEW MEXICO OIL CONSERVATION COMMISSION

Well Location and Acreage Dedication Plat

Section A.

Date August 7, 1958

Operator Val E. Brown & Assoc., Inc. Lease Brown  
Well No. 1-24 Unit Letter 8 Section 24 Township 24 North Range 7 West NMPM  
Located 1980 Feet From South Line, 1980 Feet From East Line  
County Rio Arriba G. L. Elevation 6652 Dedicated Acreage 40 Acres  
Name of Producing Formation Gallup Pool Bonito-Gallup

1. Is the Operator the only owner\* in the dedicated acreage outlined on the plat below?  
Yes X No
2. If the answer to question one is "no," have the interests of all the owners been consolidated by communitization agreement or otherwise? Yes        No       . If answer is "yes,"  
Type of Consolidation
3. If the answer to question two is "no," list all the owners and their respective interests below:

Owner

Land Description

Section. B

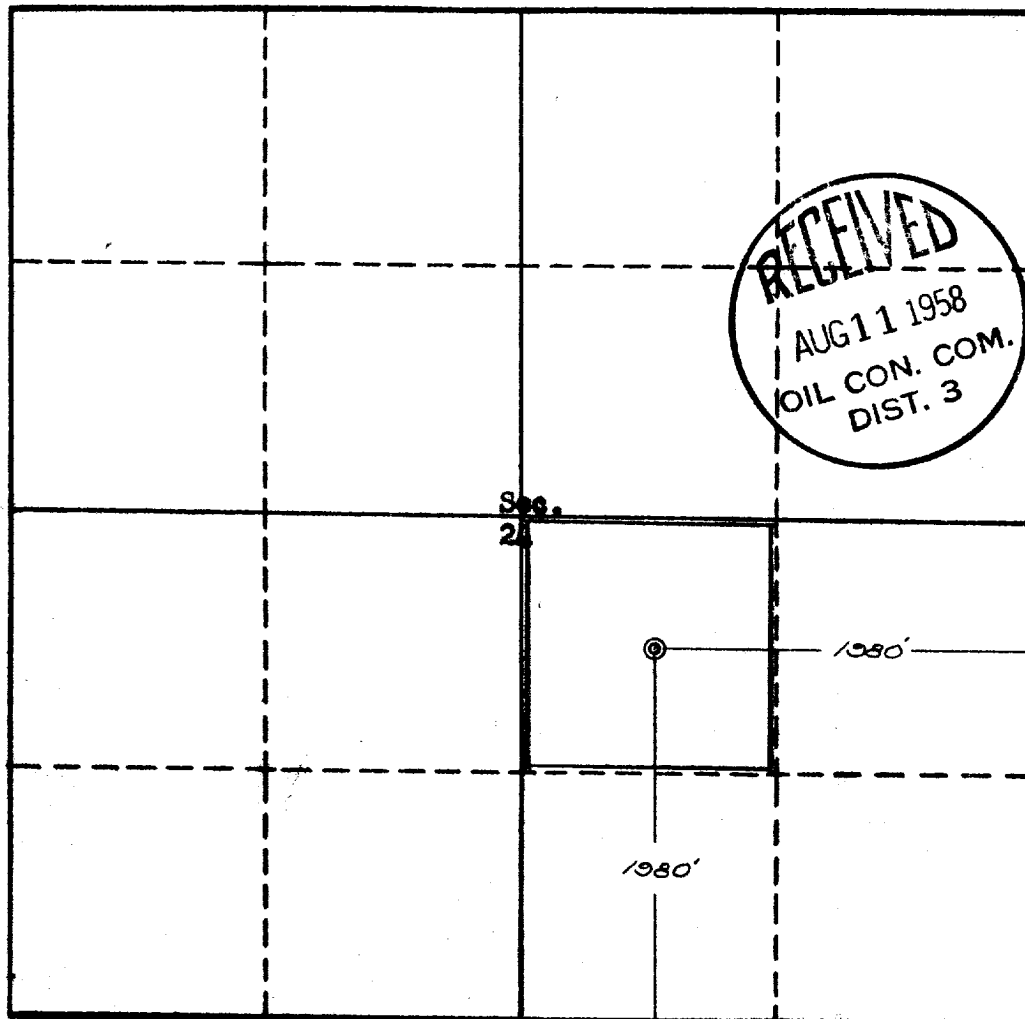

RECEIVED  
AUG 8 1958

This is to certify that the information in Section A above is true and complete to the best of my knowledge and belief.

Val E. Brown & Assoc., Inc.  
(Operator)

Original signed by T. A. Dugan  
(Representative)

130 S. Washington  
Farmington, New Mexico

Address

This is to certify that the well location is on the plat in Section A, plotted from field notes or other surveys made by me or under my supervision and that the same is true and correct to the best of my knowledge and belief.

Date Surveyed July 20, 1958

Ernest V. Echohawk  
Ernest V. Echohawk  
Registered Land Surveyor.

Certificate No. 1545