

NEW MEXICO OIL CONSERVATION COMMISSION

Well Location and Acreage Dedication Plat

Section A.

Date December, 13, 1960

Operator Val R. Reese & Associates, Inc. Lease Connie
Well No. 1-21 Unit Letter I Section 21 Township 24 North Range 7 West NMPM
Located 1980 Feet From South Line, 660 Feet From East Line
County Rio Arriba G. L. Elevation 6847 Dedicated Acreage 80 Acres
Name of Producing Formation Gallup Pool Escrito - Gallup

1. Is the Operator the only owner* in the dedicated acreage outlined on the plat below?
Yes X No _____
2. If the answer to question one is "no," have the interests of all the owners been consolidated by communitization agreement or otherwise? Yes _____ No _____. If answer is "yes,"
Type of Consolidation _____
3. If the answer to question two is "no," list all the owners and their respective interests below:

Owner

Land Description



Section. B

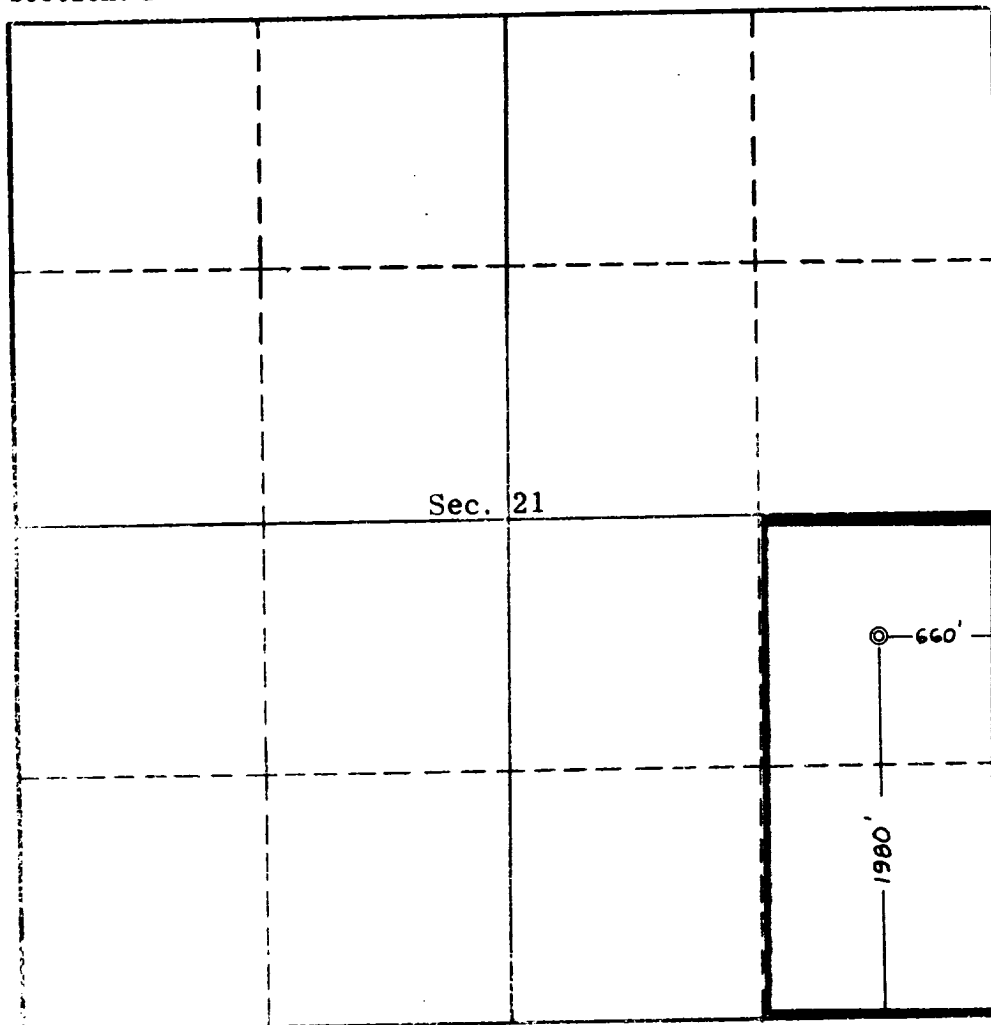

This is to certify that the information in Section A above is true and complete to the best of my knowledge and belief.

Val R. Reese & Assoc., Inc.
(Operator)

Lewis C. James
(Representative)

Lobby of Simms Bldg.
Address

Albuquerque, New Mexico

This is to certify that the well location shown on the plat in Section B was plotted from field notes of actual surveys made by me or under my supervision and that the same is true and correct to the best of my knowledge and belief.

Date Surveyed _____

Ernest V. Echshawk
Registered Land Surveyor.

Certificate No. _____

