

(SUBMIT IN TRIPLICATE)

UNITED STATES
DEPARTMENT OF THE INTERIOR
GEOLOGICAL SURVEY

Land Office Santa Fe
Lease No. 073846
Unit Canyon Largo Unit

SUNDRY NOTICES AND REPORTS ON WELLS

NOTICE OF INTENTION TO DRILL	<input checked="" type="checkbox"/>	SUBSEQUENT REPORT OF WATER SHUT-OFF
NOTICE OF INTENTION TO CHANGE PLANS	<input type="checkbox"/>	SUBSEQUENT REPORT OF SHOOTING OR ACIDIZING
NOTICE OF INTENTION TO TEST WATER SHUT-OFF	<input type="checkbox"/>	SUBSEQUENT REPORT OF ALTERING CASING
NOTICE OF INTENTION TO RE-DRILL OR REPAIR WELL	<input type="checkbox"/>	SUBSEQUENT REPORT OF RE-DRILLING OR REPAIR
NOTICE OF INTENTION TO SHOOT OR ACIDIZE	<input type="checkbox"/>	SUBSEQUENT REPORT OF ABANDONMENT
NOTICE OF INTENTION TO PULL OR ALTER CASING	<input type="checkbox"/>	SUPPLEMENTARY WELL HISTORY
NOTICE OF INTENTION TO ABANDON WELL	<input type="checkbox"/>	

(INDICATE ABOVE BY CHECK MARK NATURE OF REPORT, NOTICE, OR OTHER DATA)

August 29, 1961

Well No. 106 is located 990 ft. from N line and 1500 ft. from W line of sec. 20
NW/4 Sec. 20 24N 6W N.M.P.M.
(1/4 Sec. and Sec. No.) (Twp.) (Range) (Meridian)
Devils Fork Gallup Gas Rio Arriba New Mexico
(Field) (County or Subdivision) (State or Territory)

The elevation of the derrick floor above sea level is 6565 ft.

DETAILS OF WORK

(State names of and expected depths to objective sands; show sizes, weights, and lengths of proposed casings; indicate mudding jobs, cementing points, and all other important proposed work)

It is intended to drill a well with rotary tools thru the Gallup formation.
Possible producing zones will be perforated and fractured. Est. T. D. 5550'.

Casing Program:

- 9 5/8" set at 280' with 200 sacks of cement circulated to surface.
- 4 1/2" set at 5550' with two stage tool set 50' below base of Pictured Cliffs.
- 1st Stage - 150 sacks of cement - 150% to cover 600' above Gallup top.
- 2nd Stage w/120 sks. cement 0- 150% to cover Ojo Alamo.

The W/2 of Section 20 is dedicated to this well.

I understand that this plan of work must receive approval in writing by the Geological Survey before operations may be commenced.

Company El Paso Natural Gas Company

Address Box 990

Farmington, New Mexico

Original Signed R. G. MILLER

By ah Title Petroleum Engineer

NEW MEXICO OIL CONSERVATION COMMISSION

Well Location and Acreage Dedication Plat

Date May 26, 1961

Section A.

Operator **EL PASO NATURAL GAS COMPANY** Lease **CANYON LARGO UNIT** SF **078886**
 Well No. **106** Unit Letter **C** Section **20** Township **24-N** Range **6-W** NMPM
 Located **990** Feet From **NORTH** Line **1500** Feet From **WEST** Line
 County **RIO ARriba** G. L. Elevation **6555** Dedicated Acreage **320** Acres
 Name of Producing Formation **GALLUP** Pool **DEVILS FORK GALLUP GAS**

1. Is the Operator the only owner in the dedicated acreage outlined on the plat below?

Yes ☐ No ☐

2. If the answer to question one is "no", have the interests of all the owners been consolidated by communitization agreement or otherwise? Yes ☐ No ☐ If answer is "yes", Type of Consolidation.

3. If the answer to question two is "no", list all the owners and their respective interests below:

Owner

Land Description

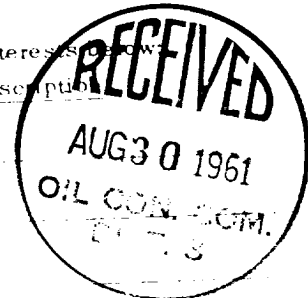

Section B.

This is to certify that the information in Section A above is true and complete to the best of my knowledge and belief.

El Paso Natural Gas Company

(Operator)
Original Signed **R. G. MILLER**

Box 990 (Representative)

Parlington, New Mexico

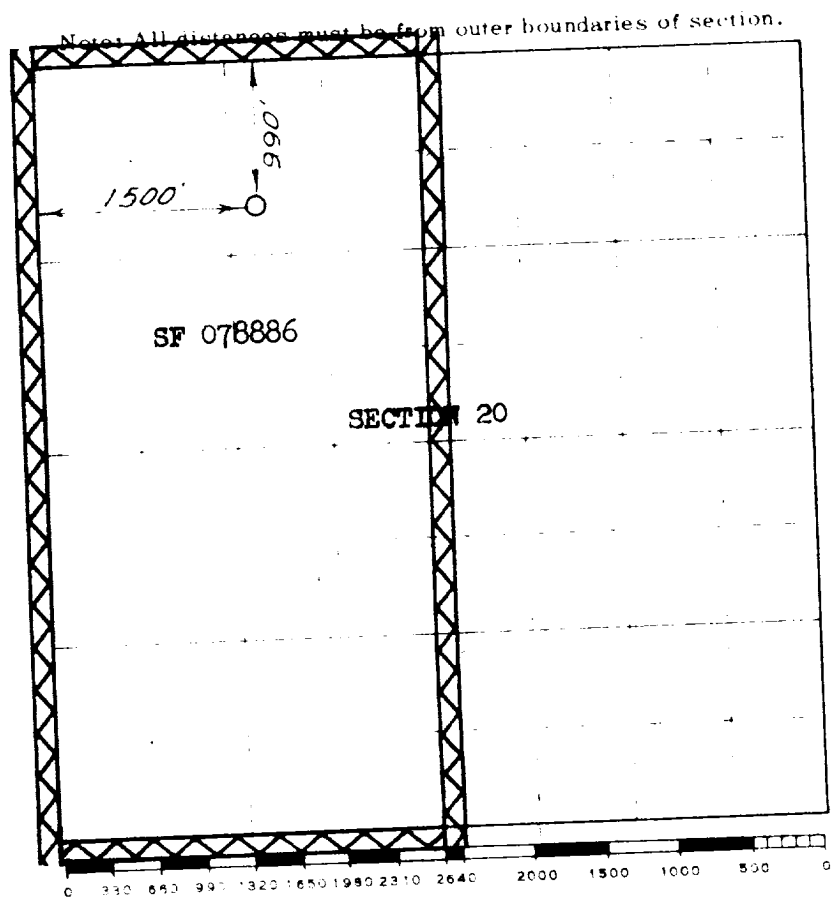

Scale 1 inch equal 1 mile

This is to certify that the above plat was prepared from field notes of actual surveys made by me or under my supervision and that the same are true and correct to the best of my knowledge and belief.

Date Surveyed May 18, 1961

David O. Wilburn
Registered Professional Engineer and/or Land Surveyor

(Seal)