

(SUBMIT IN TRIPLICATE)

Indian Agency Dulce

UNITED STATES  
DEPARTMENT OF THE INTERIOR  
GEOLOGICAL SURVEY

Jicarilla Apache  
Allottee Cont. #11-Tract #19  
Lease No. J. Apache "B"

T24N  
R5W

	Sec-20		

"AMENDED"

SUNDRY NOTICES AND REPORTS ON WELLS

NOTICE OF INTENTION TO DRILL	<input checked="" type="checkbox"/>	SUBSEQUENT REPORT OF WATER SHUT-OFF	
NOTICE OF INTENTION TO CHANGE PLANS		SUBSEQUENT REPORT OF SHOOTING OR ACIDIZING	
NOTICE OF INTENTION TO TEST WATER SHUT-OFF		SUBSEQUENT REPORT OF ALTERING CASING	
NOTICE OF INTENTION TO REDRILL OR REPAIR WELL		SUBSEQUENT REPORT OF REDRILLING OR REPAIR	
NOTICE OF INTENTION TO SHOOT OR ACIDIZE		SUBSEQUENT REPORT OF ABANDONMENT	
NOTICE OF INTENTION TO PULL OR ALTER CASING		SUPPLEMENTARY WELL HISTORY	
NOTICE OF INTENTION TO ABANDON WELL			

(INDICATE ABOVE BY CHECK MARK NATURE OF REPORT, NOTICE, OR OTHER DATA)

\* March 28, 1962

Well No. 9 is located 990' ft. from [N] line and 990' ft. from [E] line of sec. 20

SW-NE-NE-Sec-20  
(1/4 Sec. and Sec. No.)

24N  
(Twp.)

5W  
(Range)

NMPM  
(Meridian)

Basin Dakota  
(Field)

Rio Arriba  
(County or Subdivision)

New Mexico  
(State or Territory)

The elevation of the derrick floor above sea level is 6561' ft. Ground Elev.

DETAILS OF WORK

(State names of and expected depths to objective sands; show sizes, weights, and lengths of proposed casings; indicate mudding jobs, cementing points, and all other important proposed work)

Proposed Total Depth: To be drilled to 6920' or sufficient depth to test Dakota Formation.

Surface Casing: Will Set 9-5/8" OD 25.4# Armco SW SJ Casing @ 160' and Circulate Cement.

Production String: Will set production string to Total Depth if productive and cement with sufficient cement to protect Dakota & Gallup Zones, and second stage through staging tool approximately 100' below Pictured Cliffs and cement with sufficient cement to protect Pictured Cliffs Zone.

\*Note: Original "Notice of Intention to Drill" filed March 20, 1962.

I understand that this plan of work must receive approval in writing by the Geological Survey before operations may be commenced.

Company Amerada Petroleum Corporation

Address Box 1469

Durango, Colorado

PH-247-5353

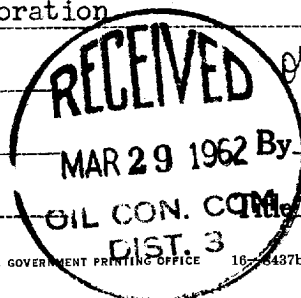

By D. F. Furse  
Foreman

## NEW MEXICO OIL CONSERVATION COMMISSION

## Well Location and Acreage Dedication Plat

Section A.

Date March 20, 1962Operator AMERADA PETROLEUM CORPORATIONLease Jicarilla Apache "B"Well No. 9 Unit Letter A Section 20Township 24 NORTH Range 5 WEST, NMPMLocated 990 Feet From the NORTH Line 990Feet From the EAST LineCounty BIO ARriba COUNTY G. L. Elevation 6561.0Dedicated Acreage 320 AcresName of Producing Formation Dakota FormationPool Basin Dakota

1. Is the Operator the only owner in the dedicated acreage outlined on the plat below?

Yes Yes No

2. If the answer to question one is "no", have the interests of all the owners been consolidated by communitization agreement or otherwise? Yes No If answer is "yes", Type of Consolidation.

3. If the answer to question two is "no", list all the owners and their respective interests below:

Owner

Land Description

Section B.

This is to certify that the information in Section A above is true and complete to the best of my knowledge and belief.

Amerada Petroleum Corporation  
(Operator)

D.F. Furse  
(Representative)

Box 1469

(Address)

Durango, Colorado

PH-247-5353

Note: All distances must be from outer boundaries of section.

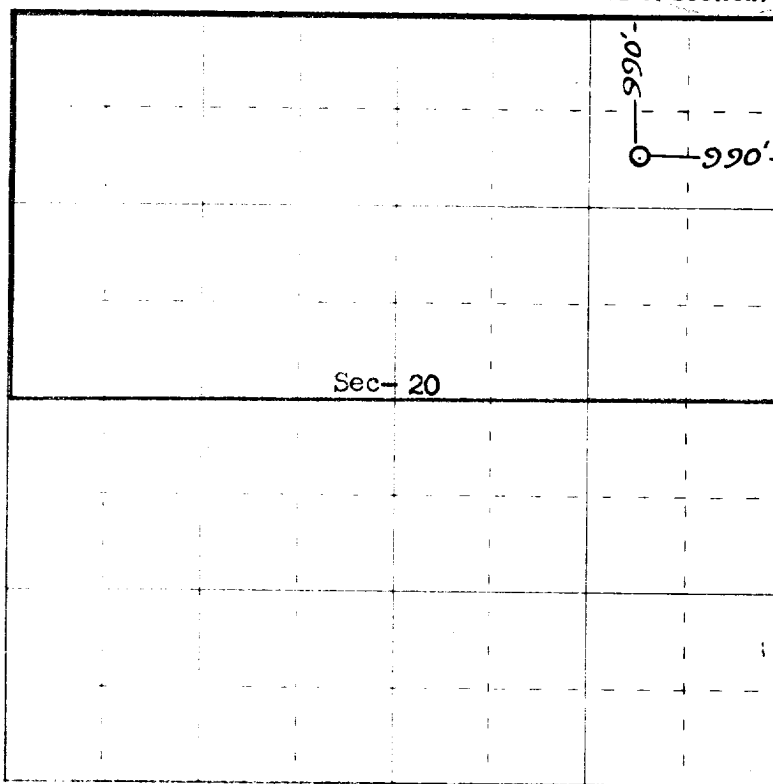

0 330 660 990 1320 1650 1980 2310 2640 2000 1500 1000 500 0

Scale 4 inches equal 1 mile

Ref: GLO plat dated 4 November 1882



This is to certify that the above plat was prepared from field notes of actual surveys made by me or under my supervision and that the same are true and correct to the best of my knowledge and belief.

Date Surveyed 26 February 1962

James P. Leese  
Registered Professional Engineer and/or Land Surveyor  
James P. Leese N. Mex. Reg. No. 1463