

NEW MEXICO OIL CONSERVATION COMMISSION

Well Location and Acreage Dedication Plat

Section A.

Date **October 6, 1959**

Operator **El Paso Natural Gas Company** Lease **Tonkin Federal SF080472-A**
 Well No. **4** Unit Letter **I** Section **18** Township **24N** Range **3W** N.M.P.M.
 Located **1500** Feet From **South** Line **990** Feet From **East** Line
 County **Rio Arriba** G. L. Elevation **6936** Dedicated Acreage **191.42** Acres
 Name of Producing Formation **Pictured Cliff** Pool **South Blanco PC Ext.**

1. Is the Operator the only owner in the dedicated acreage outlined in the plat below?
 Yes ☐ No ☒
2. If the answer to question one is "no", have the interests of all the owners been consolidated by communication agreement or otherwise? Yes ☒ No ☐ If answer is "yes", Type of Consolidation:
Operating Agreement

3. If the answer to question two is "no", list all the owners and their respective interests below:

Owner

and Description

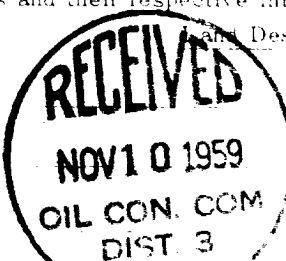

RECEIVED

NOV 9 1959

U. S. GEOLOGICAL SURVEY
FARMINGTON, NEW MEXICO

Section B.

Note: All distances must be from outer boundaries of section.

This is to certify that the information
 in Section A above is true and complete
 to the best of my knowledge and belief.

El Paso Natural Gas Company
ORIGINAL SIGNED J. J. TILLERSON

(Representative)

Box 997

(Address)

Farmington, New Mexico

**NOTE: THIS PLAT RE-ISSUED TO SHOW
 REVISED ACREAGE DEDICATION.**
 11 2 59

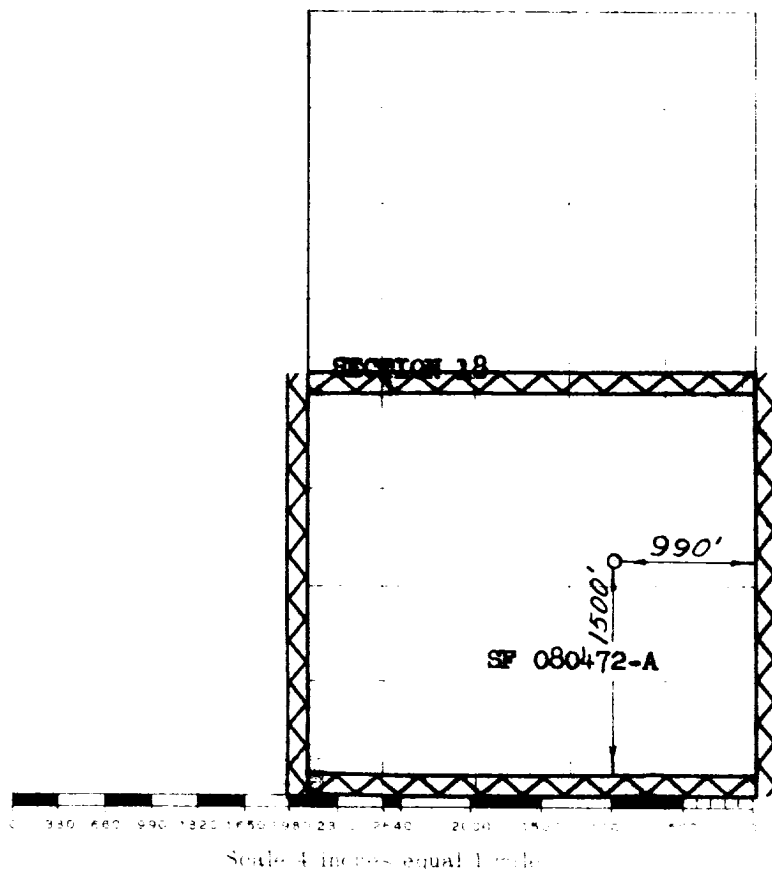

This is to certify that the above plat was prepared from field notes or ground surveys
 made by me or under my supervision and that the same are true and correct to the best
 of my knowledge and belief.

(Seal)

Date Signed

August 18, 1959

David O. Tillerson
 Registered Professional Land Surveyor

Farmington, New Mexico