

5 USGS
1 Pan American - Farmington
2 Redfern Development Co.
(SUBMIT IN TRIPLICATE)
1 File

UNITED STATES
DEPARTMENT OF THE INTERIOR
GEOLOGICAL SURVEY

Budget Bureau No. 42-R358.4.
Form Approved.

Land Office Santa Fe
Lease No. NH - 042835
Unit _____

SUNDRY NOTICES AND REPORTS ON WELLS

NOTICE OF INTENTION TO DRILL	<input checked="" type="checkbox"/>	SUBSEQUENT REPORT OF WATER SHUT-OFF	<div style="border: 2px solid black; padding: 5px; text-align: center;"> RECEIVED SEP 6 1962 U.S. GEOLOGICAL SURVEY FARMINGTON, NEW MEXICO </div>
NOTICE OF INTENTION TO CHANGE PLANS	<input type="checkbox"/>	SUBSEQUENT REPORT OF SHOOTING OR ACIDIZING	
NOTICE OF INTENTION TO TEST WATER SHUT-OFF	<input type="checkbox"/>	SUBSEQUENT REPORT OF ALTERING CASING	
NOTICE OF INTENTION TO RE-DRILL OR REPAIR WELL	<input type="checkbox"/>	SUBSEQUENT REPORT OF RE-DRILLING OR REPAIR	
NOTICE OF INTENTION TO SHOOT OR ACIDIZE	<input type="checkbox"/>	SUBSEQUENT REPORT OF ABANDONMENT	
NOTICE OF INTENTION TO PULL OR ALTER CASING	<input type="checkbox"/>	SUPPLEMENTARY WELL HISTORY	
NOTICE OF INTENTION TO ABANDON WELL	<input type="checkbox"/>		

(INDICATE ABOVE BY CHECK MARK NATURE OF REPORT, NOTICE, OR OTHER DATA)

September 4, 1962

Well No. 1 is located 1650 ft. from N line and 1140 ft. from E line of sec. 25

SE 1/4 NE 1/4 Sec 15 24N 7W 120M
(1/4 Sec. and Sec. No.) (Twp.) (Range) (Meridian)

Escrito - Gallup Rio Arriba New Mexico
(Field) (County or Subdivision) (State or Territory)

The elevation of the ~~formation~~ ground level above sea level is 7039 ft.

DETAILS OF WORK

(State names of and expected depths to objective sands; show sizes, weights, and lengths of proposed casings; indicate mudding jobs, cementing points, and all other important proposed work)

A 12 1/4" hole will be drilled to approx. 200' and 8 5/8" surface csg run and cemented w/sufficient cement to circulate. A 7 7/8" hole will then be drilled to an approx depth of 6100' to test the Gallup Formation. If commercial production is encountered, 4 1/2" Csg will be run and cemented w/150 sx cement. The Gallup will then be selectively perforated and Sand Oil Frac.

I understand that this plan of work must receive approval in writing by the Geological Survey before operations may be commenced.

Company Redfern Development Corporation
Address P.O. Box 1747
Midland, Texas
By Original signed by T. A. Dugan
Title Consulting Engineer

Form 9-381a
(Feb. 1961)

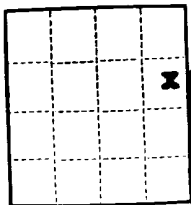

5 PAGES

1 Pan American - Farmington
2 Redfern Development Co.
1 File (SUBMIT IN TRIPLICATE)

APPROVED
UNITED STATES
DEPARTMENT OF THE INTERIOR
SEP 6 1962
GEOLOGICAL SURVEY

P. T. McGRATH
DISTRICT ENGINEER

Budget Bureau No. 42-R358.4.
Form Approved.

Land Office Santa Fe

Lease No. MM - 042635

Unit _____

SUNDRY NOTICES AND REPORTS ON WELLS

NOTICE OF INTENTION TO DRILL	<input checked="" type="checkbox"/>	SUBSEQUENT REPORT OF WATER SHUT-OFF
NOTICE OF INTENTION TO CHANGE PLANS		SUBSEQUENT REPORT OF SHOOTING OR ACIDIZING
NOTICE OF INTENTION TO TEST WATER SHUT-OFF		SUBSEQUENT REPORT OF ALTERING CASING
NOTICE OF INTENTION TO RE-DRILL OR REPAIR WELL		SUBSEQUENT REPORT OF RE-DRILLING OR REPAIR
NOTICE OF INTENTION TO SHOOT OR ACIDIZE		SUBSEQUENT REPORT OF ABANDONMENT
NOTICE OF INTENTION TO PULL OR ALTER CASING		SUPPLEMENTARY WELL HISTORY
NOTICE OF INTENTION TO ABANDON WELL		

(INDICATE ABOVE BY CHECK MARK NATURE OF REPORT, NOTICE, OR OTHER DATA)

September 4, 1962

Well No. 1 is located 1650 ft. from N line and 1140 ft. from E line of sec. 15
SE/4 NE/4 Sec 15 24N 7W NMPM
(1/4 Sec. and Sec. No.) (Twp.) (Range) (Meridian)
Escrito - Gallup Rio Arriba New Mexico
(Field) (County or Subdivision) (State or Territory)

The elevation of the ground level ~~surface~~ above sea level is 7039 ft.

DETAILS OF WORK

(State names of and expected depths to objective sands; show sizes, weights, and lengths of proposed casings; indicate mudding jobs, cementing points, and all other important proposed work)

A 12 1/4" hole will be drilled to approx. 200' and 8 5/8" surface csg run and cemented w/sufficient cement to circulate. A 7 7/8" hole will then be drilled to an approx depth of 6100' to test the Gallup Formation. If commercial production is encountered, 4 1/2" Csg will be run and cemented w/150 ex cement. The Gallup will then be selectively perforated and Sand Oil Frac.

OPERATIONS BY:

- ☐ RECORD LESSEE
☐ D. OF O. ON FILE
☒ D. OF O. ATTACHED

BOND COVERAGE:

- ☐ \$5,000 ATTACHED
☐ \$5,000 ON FILE
☒ LESSEE'S NATION-WIDE
☐ OPERATOR'S NATION-WIDE

I understand that this plan of work must receive approval in writing by the Geological Survey before operations are commenced.

Company Redfern Development Corporation

Address P.O. Box 1747

Midland, Texas

By Original signed by T. A. Dugan

Title Consulting Engineer

Form 9-331a
(Feb. 1961)

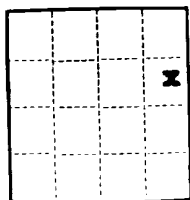

5 PAGES

1 Pan American - Farmington
2 Redfern Development Co.
1 File (SUBMIT IN TRIPLICATE)

Budget Bureau No. 42-R358.4.
Form Approved.

Land Office Santa Fe

Lease No. MM - 042835

Unit _____

APPROVED UNITED STATES
DEPARTMENT OF THE INTERIOR
SEP 6 1962 GEOLOGICAL SURVEY

P. T. McGRATH
DISTRICT ENGINEER

SUNDRY NOTICES AND REPORTS ON WELLS

NOTICE OF INTENTION TO DRILL	<input checked="" type="checkbox"/>	SUBSEQUENT REPORT OF WATER SHUT-OFF
NOTICE OF INTENTION TO CHANGE PLANS		SUBSEQUENT REPORT OF SHOOTING OR ACIDIZING
NOTICE OF INTENTION TO TEST WATER SHUT-OFF		SUBSEQUENT REPORT OF ALTERING CASING
NOTICE OF INTENTION TO RE-DRILL OR REPAIR WELL		SUBSEQUENT REPORT OF RE-DRILLING OR REPAIR
NOTICE OF INTENTION TO SHOOT OR ACIDIZE		SUBSEQUENT REPORT OF ABANDONMENT
NOTICE OF INTENTION TO PULL OR ALTER CASING		SUPPLEMENTARY WELL HISTORY
NOTICE OF INTENTION TO ABANDON WELL		

(INDICATE ABOVE BY CHECK MARK NATURE OF REPORT, NOTICE, OR OTHER DATA)

September 4, 1962

Dashko
Well No. 1 is located 1650 ft. from [N] line and 1140 ft. from [E] line of sec. 15

SE/4 NE/4 Sec 15 24N 7W NMPM
(1/4 Sec. and Sec. No.) (Twp.) (Range) (Meridian)

Escrito - Gallup Rio Arriba New Mexico
(Field) (County or Subdivision) (State or Territory)

The elevation of the ground level ~~surface~~ above sea level is 7039 ft.

DETAILS OF WORK

(State names of and expected depths to objective sands; show sizes, weights, and lengths of proposed casings; indicate mudding jobs, cementing points, and all other important proposed work)

A 12 1/4" hole will be drilled to approx. 200' and 8 5/8" surface csg run and cemented w/sufficient cement to circulate. A 7 7/8" hole will then be drilled to an approx depth of 6100' to test the Gallup Formation. If commercial production is encountered, 4 1/2" Csg will be run and cemented w/150 sx cement. The Gallup will then be selectively perforated and Sand Oil Frac.

OPERATIONS BY:

- ☐ RECORD LESSEE
☐ D. OF O. ON FILE
☒ D. OF O. ATTACHED

BOND COVERAGE:

- ☐ \$5,000 ATTACHED
☐ \$5,000 ON FILE
☒ OPERATOR'S NATION-WIDE
☐ OPERATOR'S NATION-WIDE

I understand that this plan of work must receive approval in writing by the Geological Survey before operations are commenced.

Company Redfern Development Corporation

Address P.O. Box 1747

Midland, Texas

By Original signed by T. A. Dugan

Title Consulting Engineer

Date September 4, 1962

Section 15 Township 24 North Range 7 West NMPM
 Unit Water Section 15 Line 2340 Feet From East Line
 Section 15 Feet Front 2340 Feet From East Line
 Pool Esquite - Gallup Dedicated Acreage 80 Acres
 Name of Producing Formation Gallup Pool Esquite - Gallup

Is the Operator the only owner in the dedicated acreage outlined on the plat below? Yes ☒ No

If the answer to question One is "No," have the interests of all the owners been consolidated by communitization agreement or otherwise? Yes ☐ No ☐ If answer is "Yes," Type of Consolidation

If the answer to question Two is "No," list all the owners and their respective interests below:

OWNER

LAND DESCRIPTION

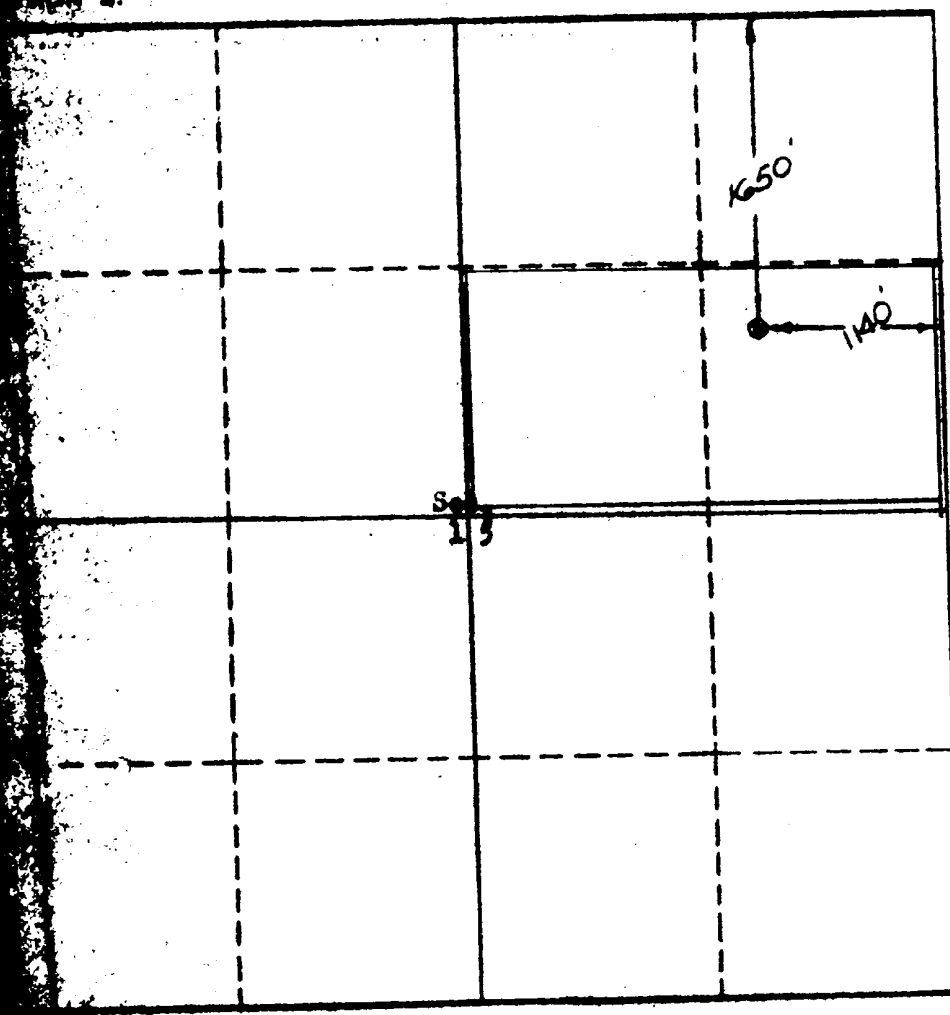

This is to certify that the information in Section A above is true and complete to the best of my knowledge and belief.

Redfern Development Corp.

(OPERATOR)

Original signed by T. A. Dugan

(REPRESENTATIVE)

**709 Bloomfield Road
Farmington, New Mexico**

This is to certify that the well location shown on the plat in Section B was plotted from field notes of actual survey made by me or under my supervision and that the same is true and correct to the best of my knowledge and belief.

Date Surveyed Aug. 28, 1962

Four States Engineering Co.
FARMINGTON, NEW MEXICO

Ernest J. Cook
REGISTERED ENGINEER OR
LAND SURVEYOR

Certificate No. 3602

NEW MEXICO OIL CONSERVATION COMMISSION

Well Location and Acreage Dedication Plat

SECTION A.

Date September 4, 1962

Operator Bedfern Development Corp. Lease Dashito
Well No. I Unit Letter II Section 25 Township 24 North Range 7 West NMPM
Located 1650 Feet From North Line, 1110 Feet From East Line
County Rio Arriba G. L. Elevation 7039 Dedicated Acreage 80 Acres
Name of Producing Formation Gallup Pool Escrito - Gallup

1. Is the Operator the only owner* in the dedicated acreage outlined on the plat below? Yes ☒ No ☐
2. If the answer to question One is "No," have the interests of all the owners been consolidated by communitization agreement or otherwise? Yes ☐ No ☐ If answer is "Yes," Type of Consolidation _____
3. If the answer to question Two is "No," list all the owners and their respective interests below:

OWNER

SECTION B.

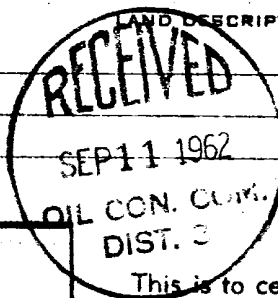
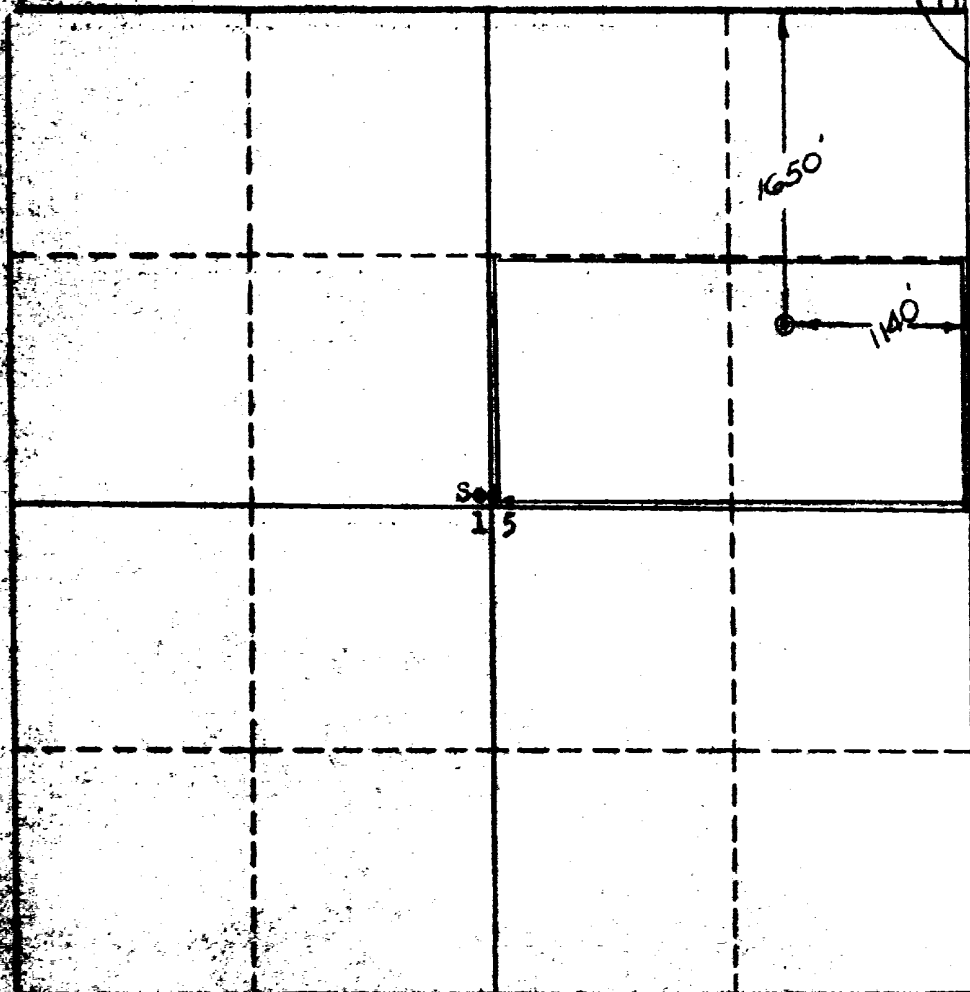

This is to certify that the information in Section A above is true and complete to the best of my knowledge and belief.

Bedfern Development Corp.
(OPERATOR)

Original signed by T. A. Dugan
(REPRESENTATIVE)

700 Bloomfield Road
Farmington, New Mexico

This is to certify that the well location shown on the plat in Section B was plotted from field notes of actual survey made by me or under my supervision and that the same is true and correct to the best of my knowledge and belief.

Date Surveyed Aug. 28, 1962
Four States Engineering Co.
FARMINGTON, NEW MEXICO

Ernest V. Eckhardt
REGISTERED ENGINEER OR
LAND SURVEYOR

Certificate No. 3602





... King and

100