



IN REPLY REFER TO:

UNITED STATES  
DEPARTMENT OF THE INTERIOR  
GEOLOGICAL SURVEY  
P. O. Box 965  
Farmington, New Mexico

September 15, 1955

E. B. Germany  
Box 8007  
Dallas 5, Texas

Re: Santa Fe 079086

Gentlemen:

Receipt is acknowledged of your "Notice of Intention to Drill" dated September 14, 1955 covering your well No. 2 Nancy Cutler in NE $\frac{1}{4}$  sec. 14, T. 24 N., R. 6 W., N. M. P. M., Rio Arriba County, New Mexico, Wildcat pool.

Your proposed work is hereby approved subject to compliance with the provisions of the "Oil and Gas Operating Regulations" revised May 25, 1942, a copy of which will be sent to you on request, and subject to the following conditions:

1. Drilling operations so authorized are subject to the attached sheet for general conditions of approval.
2. Furnish copies of all logs.

Very truly yours,

Jerry W. Long  
Acting District Engineer

JWLong:ac

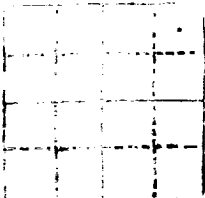

DATA DE CRIACAO  
SECRETARIA DE DEFESA  
MINISTERIO DA DEFESA

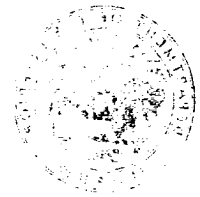

101-1070-10000

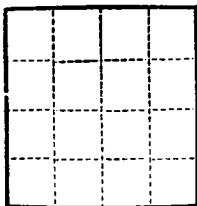

(SUBMIT IN TRIPLICATE)

UNITED STATES  
DEPARTMENT OF THE INTERIOR  
GEOLOGICAL SURVEY

Land Office **SF 079086**

Lease No. \_\_\_\_\_

Unit \_\_\_\_\_

**SUNDRY NOTICES AND REPORTS ON WELLS**

NOTICE OF INTENTION TO DRILL.....	<input checked="" type="checkbox"/>	SUBSEQUENT REPORT OF WATER SHUT-OFF.....
NOTICE OF INTENTION TO CHANGE PLANS.....	<input type="checkbox"/>	SUBSEQUENT REPORT OF SHOOTING OR ACIDIZING.....
NOTICE OF INTENTION TO TEST WATER SHUT-OFF.....	<input type="checkbox"/>	SUBSEQUENT REPORT OF ALTERING CASING.....
NOTICE OF INTENTION TO RE-DRILL OR REPAIR WELL.....	<input type="checkbox"/>	SUBSEQUENT REPORT OF RE-DRILLING OR REPAIR.....
NOTICE OF INTENTION TO SHOOT OR ACIDIZE.....	<input type="checkbox"/>	SUBSEQUENT REPORT OF ABANDONMENT.....
NOTICE OF INTENTION TO PULL OR ALTER CASING.....	<input type="checkbox"/>	SUPPLEMENTARY WELL HISTORY.....
NOTICE OF INTENTION TO ABANDON WELL.....	<input type="checkbox"/>	

(INDICATE ABOVE BY CHECK MARK NATURE OF REPORT, NOTICE, OR OTHER DATA)

**Nancy Catler**

**September 14**, 19**55**

Well No. **2** is located **1050** ft. from **(N)** line and **1170** ft. from **(E)** line of sec. **14**

**NE/4 Sec. 14**

(1/4 Sec. and Sec. No.)

**24N**

(Twp.)

**6W**

(Range)

(Meridian)

**Wildcat**

(Field)

**Rio Arriba County**

(County or Subdivision)

**New Mexico**

(State or Territory)

The elevation of the derrick floor above sea level is **6446** ft. **6440' Ground Level**

**DETAILS OF WORK**

(State names of and expected depths to objective sands; show sizes, weights, and lengths of proposed casings; indicate mudding jobs, cementing points, and all other important proposed work)

Set 100' of 9-5/8" casing and cement w/100 sacks regular cement.  
Drill with rotary tools to test Pictured Cliffs formation and set  
5-1/2" x 14# - J-55 casing, cement with 100 sacks regular cement.  
Drill plug with cable tools and complete by frac method using  
total 13,000 gallons #2 diesel, 8000 lbs. sand - 3 Halliburton pump  
trucks - install 2-3/8" tubing.

I understand that this plan of work must receive approval in writing by the Geological Survey before operations may be commenced.

Company **E. B. Germany**

Address **Box 8007**

**Dallas 5, Texas**

By 

Title \_\_\_\_\_

Company E. B. GERMANY

Lease Nancy Cutler

Well No. 2

Sec. 14 T. 24 N. R. 6 W. N.M.P.M.

Location 1050 feet from north line; 1170 feet from east line

Elevation: 6440 GL.

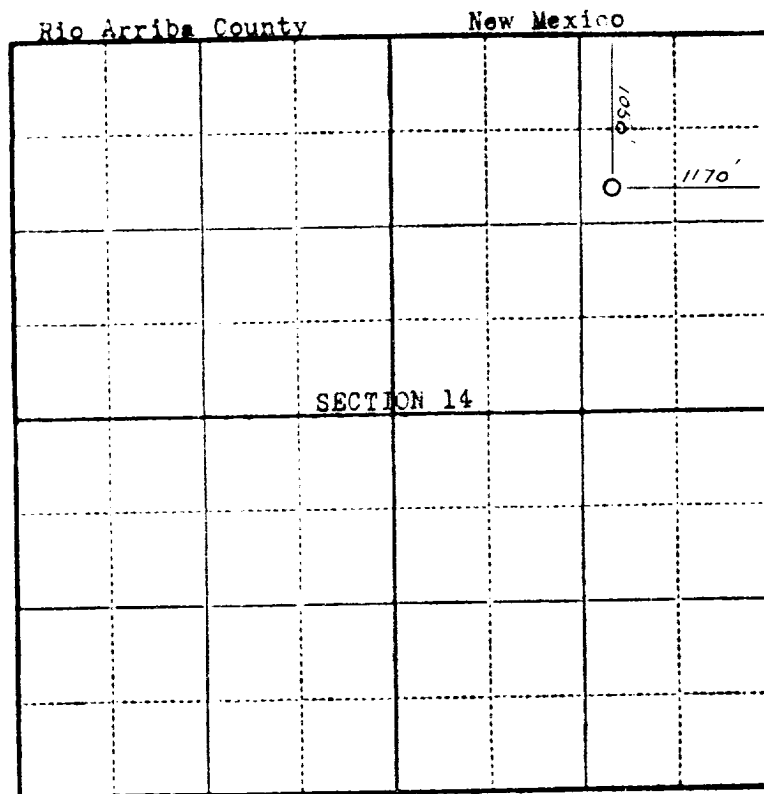

Scale--4 inches equal 1 mile.

This is to certify that the above plat was prepared from field notes of actual surveys made by me or under my supervision and that the same are true and correct to the best of my knowledge and belief.

*Stephen H. Kinney*  
STEPHEN H. KINNEY  
Registered Professional  
Engineer and Land Surveyor

Surveyed August 30

, 1955

Seal:

RECEIVED  
SEP 15 1955  
U. S. GEOLOGICAL SURVEY  
FARMINGTON, NEW MEXICO