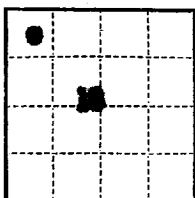

(SUBMIT IN TRIPLICATE)

Indian Agency **Jicarilla Tribal**
#69UNITED STATES
DEPARTMENT OF THE INTERIOR
GEOLOGICAL SURVEYAllettee _____
Contract **72930**

SUNDRY NOTICES AND REPORTS ON WELLS

NOTICE OF INTENTION TO DRILL	<input checked="" type="checkbox"/>	SUBSEQUENT REPORT OF WATER SHUT-OFF	
NOTICE OF INTENTION TO CHANGE PLANS		SUBSEQUENT REPORT OF SHOOTING OR ACIDIZING	
NOTICE OF INTENTION TO TEST WATER SHUT-OFF		SUBSEQUENT REPORT OF ALTERING CASING	
NOTICE OF INTENTION TO REDRILL OR REPAIR WELL		SUBSEQUENT REPORT OF REDRILLING OR REPAIR	
NOTICE OF INTENTION TO SHOOT OR ACIDIZE		SUBSEQUENT REPORT OF ABANDONMENT	
NOTICE OF INTENTION TO PULL OR ALTER CASING		SUPPLEMENTARY WELL HISTORY	
NOTICE OF INTENTION TO ABANDON WELL			

(INDICATE ABOVE BY CHECK MARK NATURE OF REPORT, NOTICE, OR OTHER DATA)

May 8, 1961

Apache Federal
Well No. **14** is located **990** ft. from **[N]** line and **990** ft. from **[W]** line of sec. **18**
SE NE NE Section 18 **24N** **3W** **100PM**
($\frac{1}{4}$ Sec. and Sec. No.) (Twp.) (Range) (Meridian)
Dakota **Big Horn** **New Mexico**
(Field) (County or Subdivision) (State or Territory)

The elevation **6450** ft.

DETAILS OF WORK

(State names of and expected depths to objective sands; show sizes, weights, and lengths of proposed casings; indicate mudding jobs, cementing points, and all other important proposed work)

It is proposed to drill a development well to test the Dakota to an approx depth of 6900'. Approx 200' of 8-5/8" surface casg will be set and cemented to the top. If well is productive, 4 1/2" casing will be set through all possible pays and cemented from total depth through Gallup and from 100' below Pictured Cliffs to 100' above. All possible producing zones will be adequately tested by 5-logs, DST's, etc.

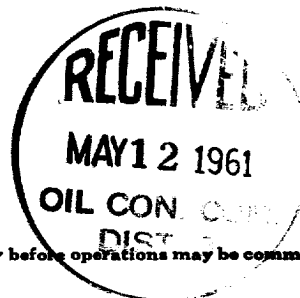

I understand that this plan of work must receive approval in writing by the Geological Survey before operations may be commenced.

Company **Gulf Oil Corporation**Address **Production Department****Box 1246****Salt Lake City, Utah**By **T. A. TRAX**Title **Area Production Manager**

NEW MEXICO OIL CONSERVATION COMMISSION

Well Location and Acreage Dedication Plat

SECTION A.

Date **May 8, 1961**Operator **Gulf Oil Corporation**Lease **Apache Federal**Well No. **14** Unit Letter _____ Section **18** Township **24 North** Range **5 West** NMPMLocated **990** Feet From **North** Line, **990** Feet From **West** LineCounty **Rio Arriba** G. L. Elevation **6459** Dedicated Acreage **320-N 321.61** AcresName of Producing Formation **Dakota** Pool **Basin-Dakota**1. Is the Operator the only owner* in the dedicated acreage outlined on the plat below? Yes ☒ No _____

2. If the answer to question One is "No," have the interests of all the owners been consolidated by communitization agreement or otherwise? Yes _____ No _____ If answer is "Yes," Type of Consolidation _____

3. If the answer to question Two is "No," list all the owners and their respective interests below:

OWNER

LAND DESCRIPTION

SECTION B.

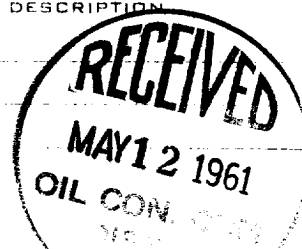
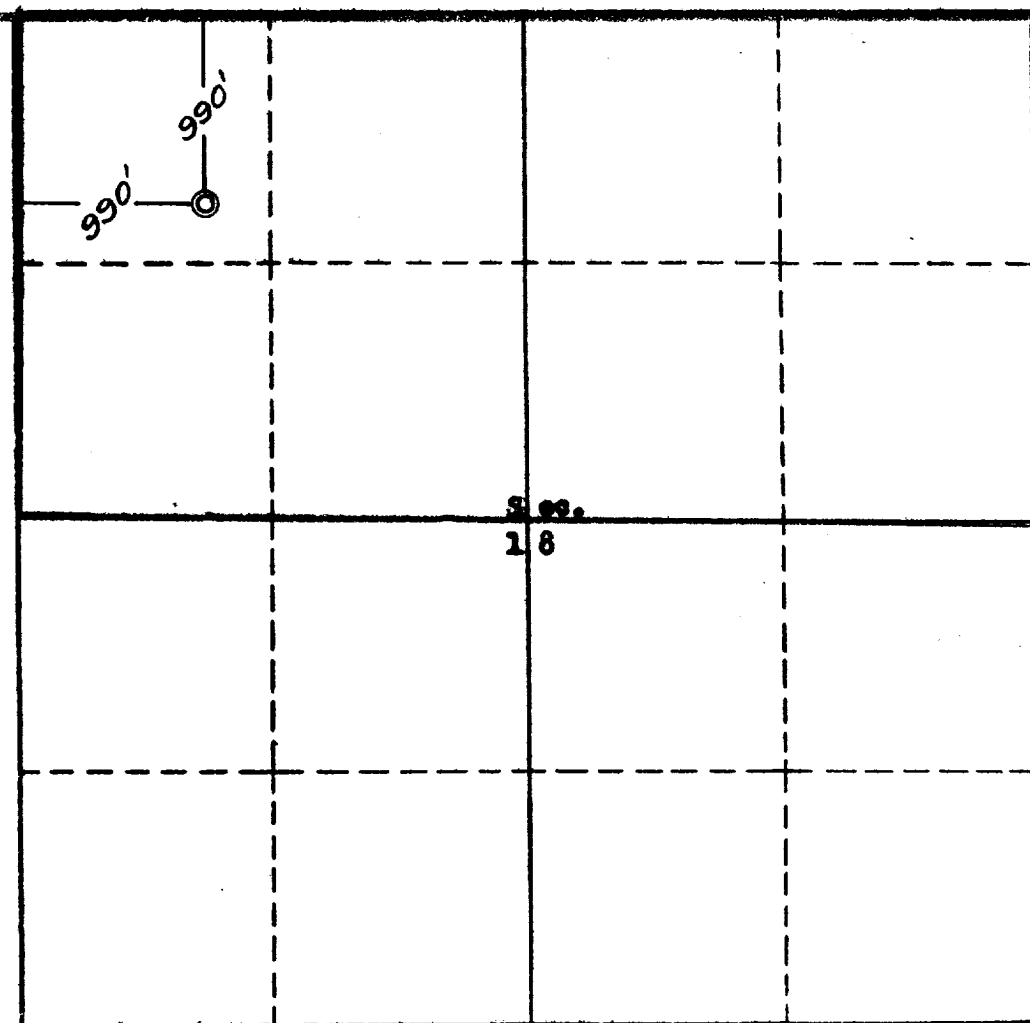

This is to certify that the information in Section A above is true and complete to the best of my knowledge and belief.

Gulf Oil Corporation

ORIGINAL SIGNED

By: **T. A. TRAX**

Area Production Manager
Production Department
Box 1346
Salt Lake City, Utah
(ADDRESS)

This is to certify that the well location shown on the plat in Section B was plotted from **2001** notes of actual survey made by me or under my supervision and that the same is true and correct to the best of my knowledge.

Date Surveyed **Mar. 15, 1961**

Four States Engineering Co.
FARMINGTON, NEW MEXICO

E. J. T. T. T. T.
REGISTERED ENGINEER OR
LAND SURVEYOR

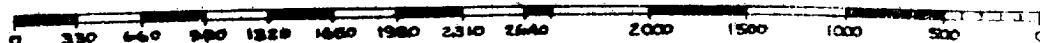
Certificate No. **1545**

3-25-68

GULF OIL CORPORATION

WELLS REQUIRING FILE CORRECTIONS ONLY

<u>LEASE NAME & WELL NUMBER</u>	<u>LOCATION</u>	<u>POOL</u>	<u>PRESENT ACREAGE</u>	<u>CORRECT ACREAGE</u>
Apache Federal #14	D-18-24N-5W	Basin Dakota	N 320	N 321.61 ✓
Apache Federal #10	J-18-24N-5W	Basin Dakota	S 320	S 321.50 ✓
Western Federal #3	L-7-26N-11W	Gallegos Gallup	40	39.35 ✓