

NEW MEXICO OIL CONSERVATION COMMISSION  
Santa Fe, New Mexico

Form C-101  
Revised (12/1/55)

NOTICE OF INTENTION TO DRILL

Notice must be given to the District Office of the Oil Conservation Commission and approval obtained before drilling or recompletion begins. If changes in the proposed plan are considered advisable, a copy of this notice showing such changes will be returned to the sender. Submit this notice in QUINTUPLICATE. One copy will be returned following approval. See additional instructions in Rules and Regulations of the Commission. If State Land submit 6 Copies Attach Form C- 128 in triplicate to first 3 copies of form C-101

Farmington, New Mexico

November 7, 1960.

(Place)

(Date)

OIL CONSERVATION COMMISSION  
SANTA FE, NEW MEXICO

Gentlemen:

You are hereby notified that it is our intention to commence the Drilling of a well to be known as

**Edna W. Merriam Trusts**

Edna

(Lease)

Well No. **1**

**N**

(Unit)

The well is

located **790** feet from the **South** line and **790** feet from the **790 West**

Line of Section **7**, T. **24 North**, R. **6 West**, NMPM.

(GIVE LOCATION FROM SECTION LINE) **Devil's Fork** Pool, **Rio Arriba** County

If State Land the Oil and Gas Lease is No. \_\_\_\_\_

If patented land the owner is **Mark and Ida Elkins**

Address **P.O. Box 177, Grants New Mexico**

We propose to drill well with drilling equipment as follows:

**Rotary Tools**

The status of plugging bond is **One well bond with U.S. Fidelity and Guaranty Company.**

Drilling Contractor **Not yet selected.**

We intend to complete this well in the **Gallup and Dakota** formation at an approximate depth of **5000 to 7100** feet.

CASING PROGRAM

We propose to use the following strings of Casing and to cement them as indicated:

Size of Hole	Size of Casing	Weight per Foot	New or Second Hand	Depth	Sacks Cement
<b>11"</b>	<b>8 5/8"</b>	<b>22.7</b>	<b>new</b>	<b>203 G.L.</b>	<b>100</b>
<b>7 7/8"</b>	<b>5 1/2"</b>	<b>14 15.5</b>	<b>new</b>	<b>7100</b>	<b>*</b>

If changes in the above plans become advisable we will notify you immediately.

ADDITIONAL INFORMATION (If recompletion give full details of proposed plan of work.)

**\* Will use 400 cubic feet of cement slurry( including admix as yet to be determined) to cover Dakota and Gallup. Will set stage collar / base of Pictured Cliffs and cement with 50 sacks cement.**

Approved 11-14, 1960  
Except as follows:

Sincerely yours,

**Edna W. Merriam Trusts**

(Company or Operator)

By **J. Gregory Merriam**  
**J. Gregory Merriam**  
**Petroleum Engineer**

Position **Send Communications regarding well to**

Name **J. Gregory Merriam**

Address **P.O. Box 507, Farmington**

OIL CONSERVATION COMMISSION

By J. Gregory Merriam

## NEW MEXICO OIL CONSERVATION COMMISSION

## Well Location and Acreage Dedication Plat

## SECTION A.

Date 11-5-60

Operator Merrion Trust Co. Lease Edna  
 Well No. Edna #1 Unit Letter ■ Section 7 Township 24-North Range 6-West NMPM  
 Located 790 Feet From South Line, 790 Feet From West Line  
 County Rio Arriba G. L. Elevation 6900' Dedicated Acreage 320 Acres  
 Name of Producing Formation Gallup Pool Devil's Fork  
Dakota Undesignated

1. Is the Operator the only owner\* in the dedicated acreage outlined on the plat below? Yes ■ No ■
2. If the answer to question One is "No," have the interests of all the owners been consolidated by communization agreement or otherwise? Yes ■ No ■ If answer is "Yes," Type of Consolidation Undivided interests - Joint venture.
3. If the answer to question Two is "No," list all the owners and their respective interests below

OWNER

LAND DES.

## SECTION B.

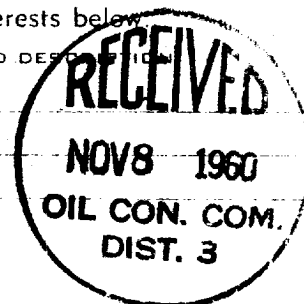
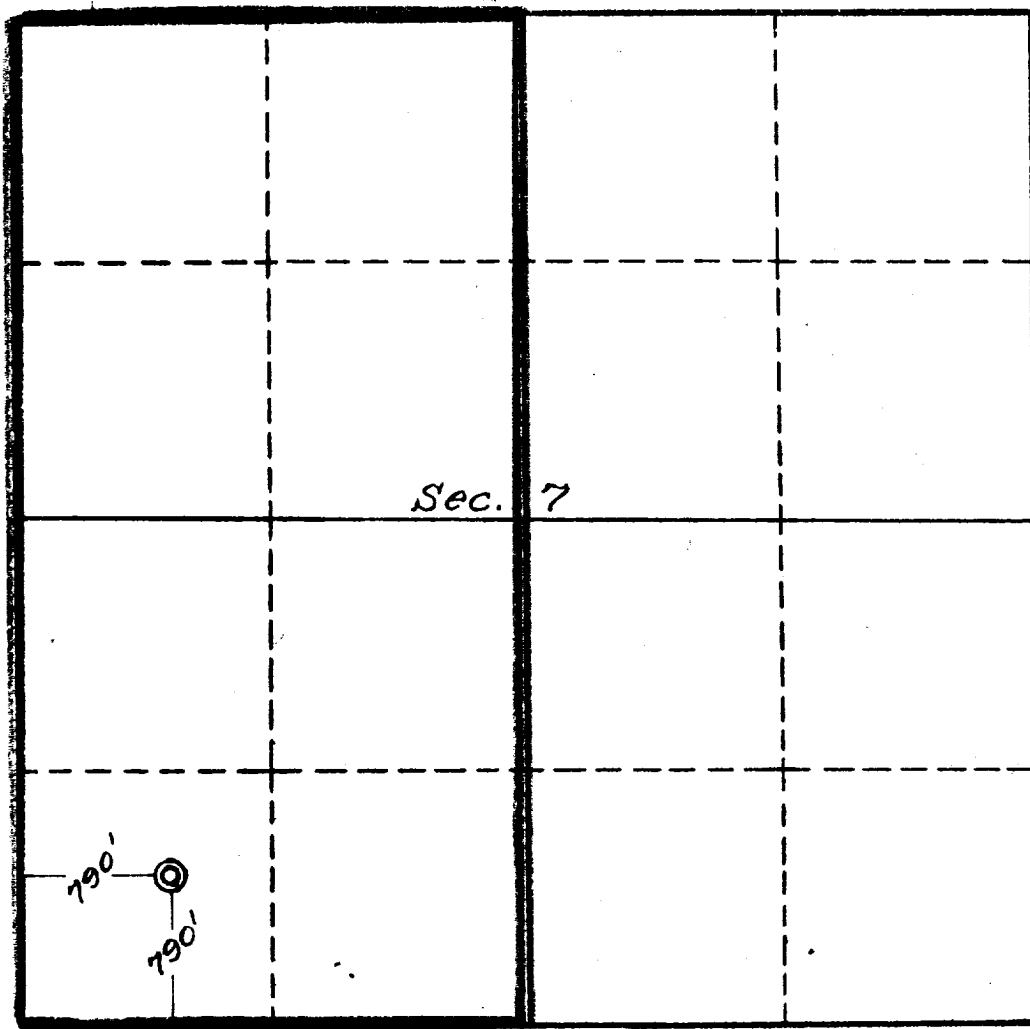

This is to certify that the information in Section A above is true and complete to the best of my knowledge and belief.

Merrion Trust Co.  
(OPERATOR)J. Gregory Merrion  
(REPRESENTATIVE)J. Gregory Merrion  
P.O. Box 507, Farmington  
(ADDRESS)

This is to certify that the well location shown on the plat in Section B was plotted from field notes of actual surveys made by me or under my supervision and that the same is true and correct to the best of my knowledge and belief.

Date Surveyed 11-5-60Four States Engineering Co.  
FARMINGTON, NEW MEXICOC. L. Polat  
REGISTERED ENGINEER OR  
LAND SURVEYORCertificate No. 3084