

STATE OF NEW MEXICO
ENERGY, MINERALS AND NATURAL RESOURCES DEPARTMENT
OIL CONSERVATION DIVISION

GARREY CARRUTHERS
GOVERNOR

November 28, 1990

POST OFFICE BOX 2088
STATE LAND OFFICE BUILDING
SANTA FE, NEW MEXICO 87504
(505) 827-5800

Meridian Oil, Inc.
P.O. Box 4289
Farmington, NM 87499-4289

Attention: Peggy Bradfield

RECEIVED
DEC 3 1990
OIL CON. DIV
DIST. 3

Administrative Order NSL-2950

Dear Ms. Bradfield:

Reference is made to your application dated October 23, 1990 for a non-standard Basin-Fruitland coal gas well location for your existing Jicarilla "126" S Well No. 13 which was drilled in 1956 and completed in the South Blanco Pictured Cliffs Pool at a standard gas well location 1850 feet from the South line and 990 feet from the East line (Unit I) of Section 12, Township 24 North, Range 4 West, NMPM, Rio Arriba County, New Mexico.

It is my understanding that the Pictured Cliffs zone will be properly plugged back and said well will be recompleted to the Basin-Fruitland Coal Gas Pool, which pursuant to the Special Rules and Regulations for the Basin-Fruitland Coal Gas Pool as promulgated by Division Order No. R-8768, is unorthodox. Further, the E/2 of said Section 12 shall be dedicated to the well forming a standard 320-acre gas spacing and proration unit for said pool.

By the authority granted me under the provisions of Rule 8 of said Division Order No. R-8768, the above-described unorthodox coal gas well location is hereby approved.

Sincerely,

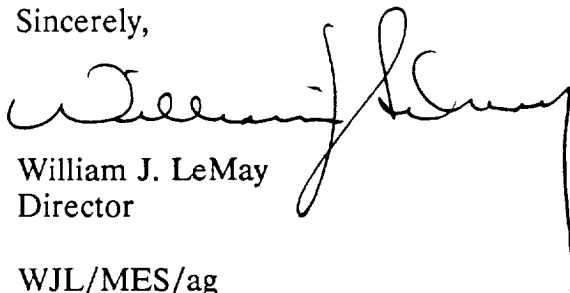
William J. LeMay
Director

WJL/MES/ag

cc: Oil Conservation Division - Aztec
US Bureau of Land Management - Farmington



STATE OF NEW MEXICO
ENERGY AND MINERALS DEPARTMENT
OIL CONSERVATION DIVISION
AZTEC DISTRICT OFFICE

ARREY CAPRUTHERS
GOVERNOR

1000 TWO HAZARD ROAD
AZTEC, NEW MEXICO 87410
(505) 334-0170

Date: 11-26-90

Attn: M. Foyner

Oil Conservation Division
P.O. Box 2088
Santa Fe, NM 87504-2088

Re: Proposed HC _____
Proposed DHC _____
Proposed NSL X _____
Proposed SWD _____
Proposed WFX _____
Proposed PMX _____

Gentlemen:

I have examined the application dated 10-25-90
for the Mendocino Fire, Picavilla 126 S #13
Operator Lease & Well No.

I-12-24N-4W and my recommendations are as follows:
Unit, S-T-R

Approved

Yours truly,

Ernest Brach

MERIDIAN OIL

October 22, 1990

Federal Express

Mr. William LeMay
New Mexico Oil Conservation Division
310 Old Santa Fe Trail
Santa Fe, New Mexico 87503

RECEIVED
OCT 25 1990
OIL CON. DIV.
DIST. 3

RE: Jicarilla 126 S #13
1850'FSL, 990'FEL
Section 12, T-24-N, R-04-W
Rio Arriba County, New Mexico

Dear Mr. LeMay:

This is a request for administrative approval for a non-standard gas well location in the Basin Fruitland Pool.

Meridian Oil intends to plugback and recompleate the Jicarilla 126 S #13 well from the Pictured Cliffs pool to the Basin Fruitland Coal Pool. The current location of this well is 1850'FSL, 990'FEL, Section 12, T-24-N, R-04-W, Rio Arriba County, New Mexico. The well is considered non-standard due to the NE-SW dedicated pattern established for the Basin Fruitland Coal Pool. To comply with the New Mexico Oil Conservation Division rules, Meridian is submitting the following for your approval of this non-standard location:

1. C-102 plat showing location of the well;
2. Plat showing offset owners/operators;
3. Affidavit of notification of offset owners/operators;
4. Copy of Well Completion Log for original completion.

A copy of this application is being submitted to all offset owners/operators by certified mail with a request that they furnish your Santa Fe office with a Waiver of Objection, and return one copy to this office.

Sincerely yours,

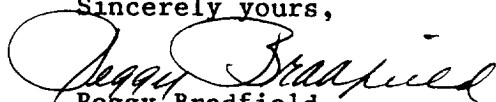
Peggy Bradford
encl.

WAIVER

_____ hereby waives objection to Meridian Oil Inc.'s application for a non-standard location for their Jicarilla 126 S #13 as proposed above.

By: _____ Date: _____

xc: Apache Corporation
Cotton Petroleum
Mobil Producing Texas & New Mexico
J. Felix Hickman Estate

Meridian Oil Inc., 3535 East 30th St., P.O. Box 4289, Farmington, New Mexico 87499-4289, Telephone 505-326-9700

Jicarilla 126 S #13
1850'FSL, 990'FEL
Section 12, T-24-N, R-04-W
Rio Arriba County, New Mexico

I hereby certify that the following offset owners/operators have been notified by certified mail of our application for administrative approval for non-standard gas well location for the plugback and recompletion of the above well.

Apache Corporation
Two Warren Place, Suite 1500
Tulsa, OK 74136

Cotton Petroleum
Suite 4200, One Williams Center
Tulsa, OK 74103

Mobil Producing Texas & New Mexico
P.O. Box 5444
Denver, CO 80202

J. Felix Hickman Estate
P.O. Box 12307
El Paso, TX 79912



Peggy Bradfield
October 22, 1990

San Juan County
State of New Mexico

My commission expires August 17, 1992

MERIDIAN OIL INC

Well Name Jicarilla 126 S #13

Footage 1850' FSL; 990' FEL

APPLICATION FOR NON-STANDARD LOCATION

County Rio Arriba State New Mexico Section 12 Township 24N Range 4 W

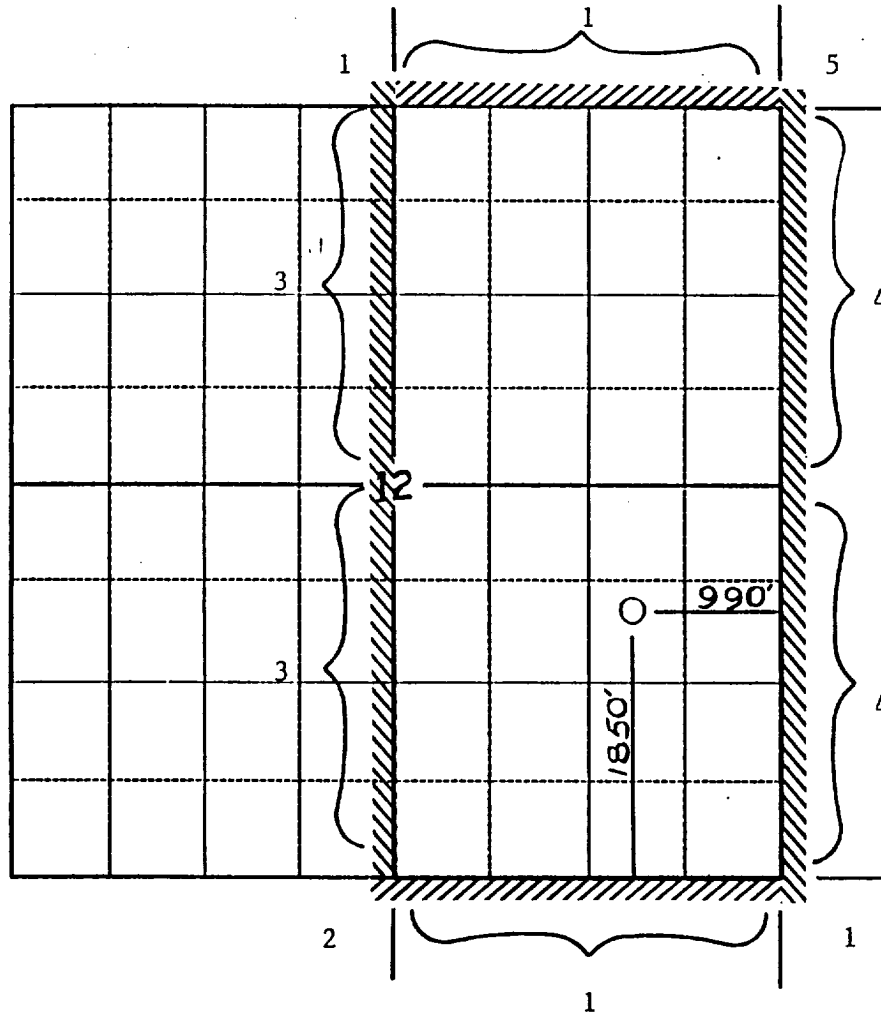

Remarks 1) Meridian Oil Inc.

2) Apache Corporation - Two Warren Place, Suite 1500, Tulsa, OK 74136

3) Cotton Petroleum - Suite 4200, One Williams Center, Tulsa, OK 74103

4) Mobil Producing Texas & NM Inc.

5) J. Felix Hickman Estate, P.O. Box 12307, El Paso, TX 79912

Submit to Appropriate
District Office
State Lease - 4 copies
Fee Lease - 3 copies

State of New Mexico
Energy, Minerals and Natural Resources Department

Form C-102
Revised 1-1-89

OIL CONSERVATION DIVISION

P.O. Box 2088
Santa Fe, New Mexico 87504-2088

DISTRICT I
P.O. Box 1980, Hobbs, NM 88240

DISTRICT II
P.O. Drawer DD, Artesia, NM 88210

DISTRICT III
1000 Rio Brazos Rd., Aztec, NM 87410

WELL LOCATION AND ACREAGE DEDICATION PLAT

All Distances must be from the outer boundaries of the section

Operator Meridian Oil Inc.			Lease Jicarilla 126 S (Jic. Cont #126)		Well No. 13
Unit Letter I	Section 12	Township 24 North	Range 4 West	County NMNM Rio Arriba	
Actual Footage Location of Well: 1850 feet from the North line and 990 feet from the East line					
Ground level Elev. 6820'	Producing Formation Fruitland Coal		Pool Basin	Dedicated Acreage: 320 Acres	

1. Outline the acreage dedicated to the subject well by colored pencil or hatchure marks on the plat below.
2. If more than one lease is dedicated to the well, outline each and identify the ownership thereof (both as to working interest and royalty).
3. If more than one lease of different ownership is dedicated to the well, have the interest of all owners been consolidated by communitization, unitization, force-pooling, etc.?
☐ Yes ☐ No If answer is "yes" type of consolidation _____

If answer is "no" list the owners and tract descriptions which have actually been consolidated. (Use reverse side of this form if necessary.)

No allowable will be assigned to the well until all interests have been consolidated (by communitization, unitization, forced-pooling, or otherwise) or until a non-standard unit, eliminating such interest, has been approved by the Division.

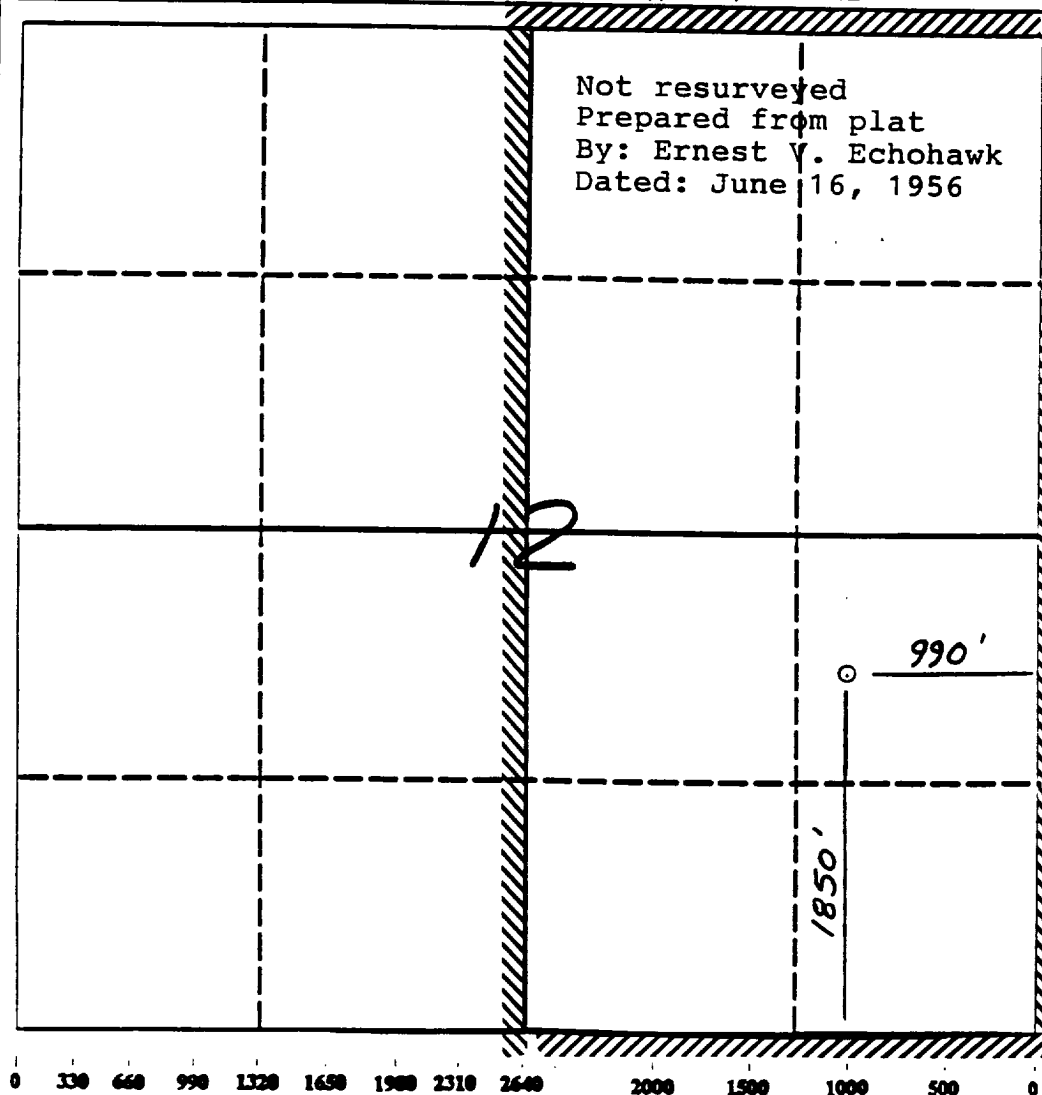

OPERATOR CERTIFICATION

I hereby certify that the information contained herein is true and complete to the best of my knowledge and belief.

Signature
Peggy Bradfield
Printed Name
Regulatory Affairs
Position
Meridian Oil Inc.
Company

Date

SURVEYOR CERTIFICATION

I hereby certify that the well location shown on this plat was plotted from field notes of actual surveys made by me or under my supervision, and that the same is true and correct to the best of my knowledge and belief.

10-20-90

Date Surveyed

Signature
Professional Surveyor

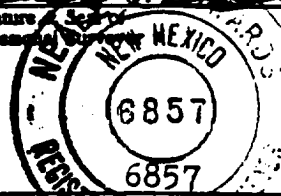

Certificate No.
Neale Edwards

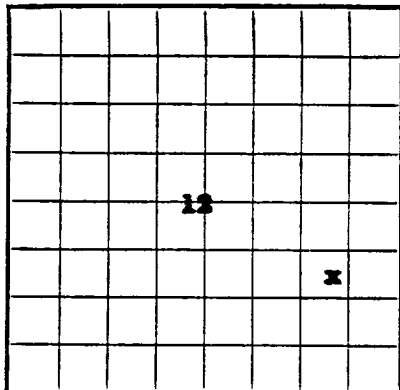

LOCATE WELL CORRECTLY

 U. S. LAND OFFICE _____
 SERIAL NUMBER Jicarilla _____
 LEASE OR PERMIT TO PROSPECT _____
Contract #126

 UNITED STATES
 DEPARTMENT OF THE INTERIOR
 GEOLOGICAL SURVEY
LOG OF OIL OR GAS WELL
 Company Northwest Production Corporation Address 520 Simms Building, Albuquerque, N.M.
 Lessor or Tract "E" Field Wildcat (JC) State New Mexico
 Well No. 13-12 Sec. 12 T 24N R. 4W Meridian NMPM County Rio Arriba
 Location 1850 ft. [N.] of Sec. Line and 922 ft. [E.] of Sec. Line of Sec. 12 Elevation 6320.0 Gr
(Derrick base relative to sea level)

The information given herewith is a complete and correct record of the well and all work done thereon so far as can be determined from all available records.

Signed RAY PHILLIPSDate 9-28-56Title Asst. Mgr., Production Oper.

The summary on this page is for the condition of the well at above date.

Commenced drilling 7-29-56, 19____ Finished drilling 8-29, 1956**OIL OR GAS SANDS OR ZONES**

(Denote gas by G)

 No. 1, from 2927 to 3003 G No. 4, from 3037 to 3041 G
 No. 2, from 3007 to 3011 G No. 5, from 3049 to 3053 G
 No. 3, from 3019 to 3027 G No. 6, from _____ to _____
IMPORTANT WATER SANDS
 No. 1, from 2927 to 3003 G No. 4, from 3037 to 3041 G
 No. 2, from 3007 to 3011 G No. 5, from 3049 to 3053 G
 No. 3, from 3019 to 3027 G No. 6, from _____ to _____

Size casing	Weight per foot	Threads per inch	Make	Amount	Kind of shoe	Cut and pulled from	From—	To—	Purpose
7-5/8	240	8 RD		97.53					
4-1/2	100	10 RD		3142.20					
1-1/4	2.3	10 RD		2028.0					

MUDDING AND CEMENTING RECORD

Size casing	Where set	Number sacks of cement	Method used	Mud gravity	Amount of mud used
7-5/8	104.93	75	BONCO		
4-1/2	3142.20	100 w/1/2 fls 5516/BX BONCO			

PLUGS AND ADAPTERS
 Heaving plug—Material None Length _____ Depth set _____