

NEW MEXICO OIL CONSERVATION COMMISSION
Santa Fe, New Mexico

NOTICE OF INTENTION TO DRILL OR RECOMPLETE

Notice must be given to the District Office of the Oil Conservation Commission and approval obtained before drilling or recompleting begins. If changes in the proposed plan are considered advisable, a copy of this notice showing such changes will be returned to the sender. Submit this notice in QUINTUPLICATE. One copy will be returned following approval. See additional instructions in Rules and Regulations of the Commission.

If State Land submit 6 Copies

Farmington, New Mexico

October 17, 1956

(Place)

(Date)

OIL CONSERVATION COMMISSION
SANTA FE, NEW MEXICO

Gentlemen:

You are hereby notified that it is our intention to commence the (Drilling) (~~Recompletion~~) of a well to be known as
El Paso Natural Gas Company

(Company or Operator)

Lindrith Unit

(Lease)

Well No. **11**, in **E** The well is

1650

feet from the

North

line and **890** feet from the

West

line of Section **9**, T. **24N**, R. **2W**, NMPM.

(GIVE LOCATION FROM SECTION LINE)

Wildcat

Pool, **Rio Arriba** County

If State Land the Oil and Gas Lease is No.

If patented land the owner is **Albert P. Avant**

Address.

We propose to drill well with drilling equipment as follows: **Rotary tools thru Pictured Cliff formation.**

The status of plugging bond is **Statewide**

Drilling Contractor **Company Tools**

We intend to complete this well in the **Pictured Cliff** formation at an approximate depth of **3305** feet.

D	C	B	A
E	F	G	H
L	K	J	I
M	N	O	P

Elev. 7169'Gr., 7179'DF

CASING PROGRAM

We propose to use the following strings of Casing and to cement them as indicated:

Size of Hole	Size of Casing	Weight per Foot	New or Second Hand	Depth	Sacks Cement
13 3/4"	9 5/8"	25.4#	New	120'	125
8 3/4"	5 1/2"	15.5#	New	3305'	150

If changes in the above plans become advisable we will notify you immediately.

ADDITIONAL INFORMATION (If recompleting give full details of proposed plan of work.) It is proposed to perforate and water fracture possible producing zones. The NW/4 of Section 9 is dedicated to this well. NW/4 Albert P. Avant.

Approved 10-22, 1956
Except as follows:

OIL CONSERVATION COMMISSION

By Emery C. Amos

Sincerely yours,

El Paso Natural Gas Company
(Company or Operator)

By S. Schuler

Position **Petroleum Engineer**

Send Communications regarding well to

Name **E. J. Coal**

Address **Box 997, Farmington, N.M.**

NEW MEXICO
OIL CONSERVATION COMMISSION

Form O-128

WELL LOCATION AND/OR GAS PRORATION PLAT

DATE OCTOBER 15, 1956

BY EL PASO NATURAL GAS COMPANY LEASE LINDRITH UNIT FEE

SECTION 11 TOWNSHIP 9 RANGE 24-N RANGE 2-W NORTH

1650 FEET FROM NORTH LINE 890 FEET FROM WEST LINE

RIO ARriba COUNTY, NEW MEXICO ELEVATION 7169

WELL NAME PICTURED CLIFF WILDCAT ACRES 160 ACRES
(1917 PLAT)

Note: All distances must be from outer boundaries of section.

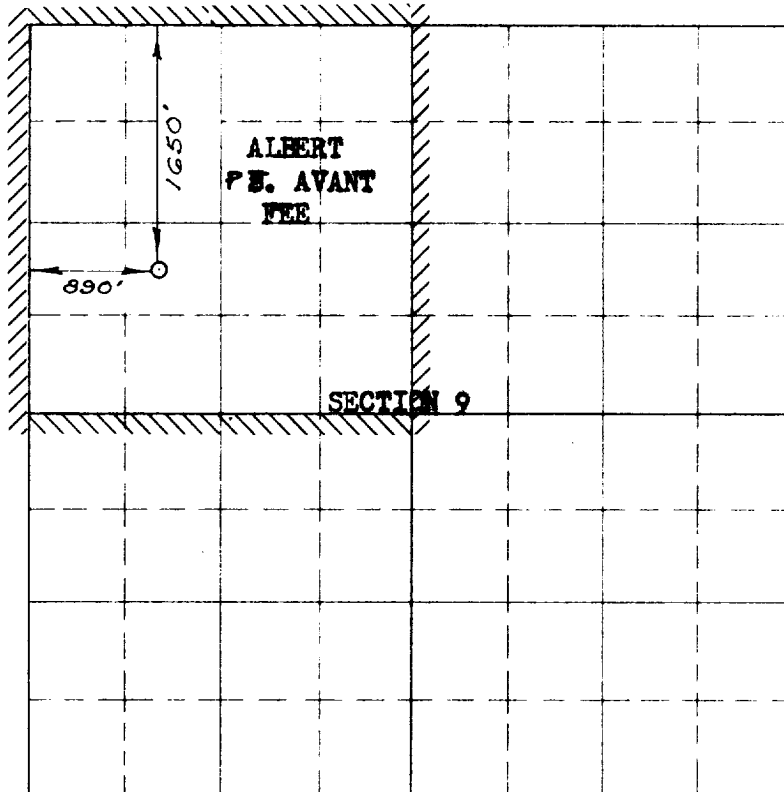

Scale 4 inches equal 1 mile

NOTE

This section of
form is to be used
for gas wells only

This is to certify that the above plat was prepared from
field notes of actual surveys made by me or under my
supervision and that the same are true and correct to the
best of my knowledge and belief.

Date Surveyed SEPTEMBER 17, 1956

E. O. Walker
Registered Professional Engineer and Land Surveyor

1. Is this well a Dual Comp.
Yes _____ No X

2. If the answer to Question 1
is yes, are there any other dually
completed wells within the
dedicated acreage.

Yes _____ No _____

Name S. Schuler

Position Petroleum Engineer

Representing El Paso Natural Gas Co.
Box 997, Farmington, N.M.

Address _____



(Seal)

Farmington, New Mexico

WILDLIFE CONSERVATION COMMISSION		
AZTEC DISTRICT OFFICE		
No. Copies Received		6
DISTRIBUTION		
	COPIES	
Director	2	
Asst. Dir.	1	
Executive Office		
State Land Office		
U. S. G. S.	2	
Transporter		
File	1	2