

IN REPLY REFER TO:



UNITED STATES
DEPARTMENT OF THE INTERIOR
GEOLOGICAL SURVEY
P. O. Box 965
Farmington, New Mexico

May 17, 1956



Oil Corporation
Lester LeFavour
Box 2097
Denver 1, Colorado

Re: Jicarilla Contract 69
Tract 131

Gentlemen:

Receipt is acknowledged of your "Notice of Intention to Drill" dated May 16, 1956 covering your well No. 6 Apache in SW 1/4 sec. 7, T. 24 N., R. 5 W., N. M. P. M., Rio Arriba County, New Mexico, Otero-Pic Cliffs pool.

Your proposed work is hereby approved subject to compliance with the provisions of the "Oil and Gas Operating Regulations" revised May 25, 1942, a copy of which will be sent to you on request, and subject to the following conditions:

1. Drilling operations so authorized are subject to the attached sheet for general conditions of approval.
2. Furnish copies of all logs.

Very truly yours,

Jerry W. Long
Acting District Engineer

J Long:ac
cc - Jicarilla Agency

IN REPLY, REFER TO:

UNITED STATES
DEPARTMENT OF THE INTERIOR
GEOLOGICAL SURVEY



[Faint, mostly illegible handwritten text and notes, possibly a survey report or correspondence.]

(SUBMIT IN TRIPLICATE)
UNITED STATES
DEPARTMENT OF THE INTERIOR
GEOLOGICAL SURVEY

Indian Agency Alamogordo
Tribal
Allottee _____

SUNDRY NOTICES AND REPORTS ON WELLS

NOTICE OF INTENTION TO DRILL	<input checked="" type="checkbox"/>	SUBSEQUENT REPORT OF WATER SHUT-OFF	
NOTICE OF INTENTION TO CHANGE PLANS		SUBSEQUENT REPORT OF SHOOTING OR ACIDIZING	
NOTICE OF INTENTION TO TEST WATER SHUT-OFF		SUBSEQUENT REPORT OF ALTERING CASING	
NOTICE OF INTENTION TO REDRILL OR REPAIR WELL		SUBSEQUENT REPORT OF REDRILLING OR REPAIR	
NOTICE OF INTENTION TO SHOOT OR ACIDIZE		SUBSEQUENT REPORT OF ABANDONMENT	
NOTICE OF INTENTION TO PULL OR ALTER CASING		SUPPLEMENTARY WELL HISTORY	
NOTICE OF INTENTION TO ABANDON WELL			

(INDICATE ABOVE BY CHECK MARK NATURE OF REPORT, NOTICE, OR OTHER DATA)

May 16, 1956.

Well No. 6 Apache is located 1650 ft. from [N] line and 1650 ft. from [E] line of sec. 7

SE SW NE Sec. 7 21 North - 5 West RMPN
(14 Sec. and Sec. No.) (Twp.) (Range) (Meridian)
Otero-Pictured Cliffs Rio Arriba New Mexico
(Field) (County or Subdivision) (State or Territory)

The elevation of the ground level above sea level is 6574 ft. Will furnish DFE later.

DETAILS OF WORK

(State names of and expected depths to objective sands; show sizes, weights, and lengths of proposed casings; indicate mudding jobs, cementing points, and all other important proposed work)

It is proposed to drill a well to test the Pictured Cliffs Formation, approximate depth 2400'. Approximately 150' of 8-5/8" surface casing will be set and cemented to the surface. 4-1/2" OD oil string will be used if commercial production is encountered. All possible producing zones will be adequately tested.

I understand that this plan of work must receive approval in writing by the Geological Survey before operations may be commenced.

Company Gulf Oil Corporation

Address c/o Lester LeFavour

Box 2097

Denver 1, Colorado

By _____

Title Area Sup't. of Production

cc: New Mexico Oil & Gas Conservation Commission.

RECEIVED
JAN 10 1964

NEW MEXICO
OIL CONSERVATION COMMISSION

Form C-128

Well Location and/or Gas Production Plat

Date: **May 16, 1956**

Operator **Gulf Oil Corporation**

Lease **Apache Federal**

Well No. **76**

Section **7**

Township

24 North

Range

5 West

NMPM

Located **1650**

Feet From

North

Line,

1650

Feet From

East

Line,

Rio Arriba

County, New Mexico,

G. L. Elevation

6574

Name of Producing Formation **Matured Cliffs**

Pool **Staro-Matured Cliffs**

Dedicated Acreage **160**

(Note: All distances must be from outer boundaries of Section)

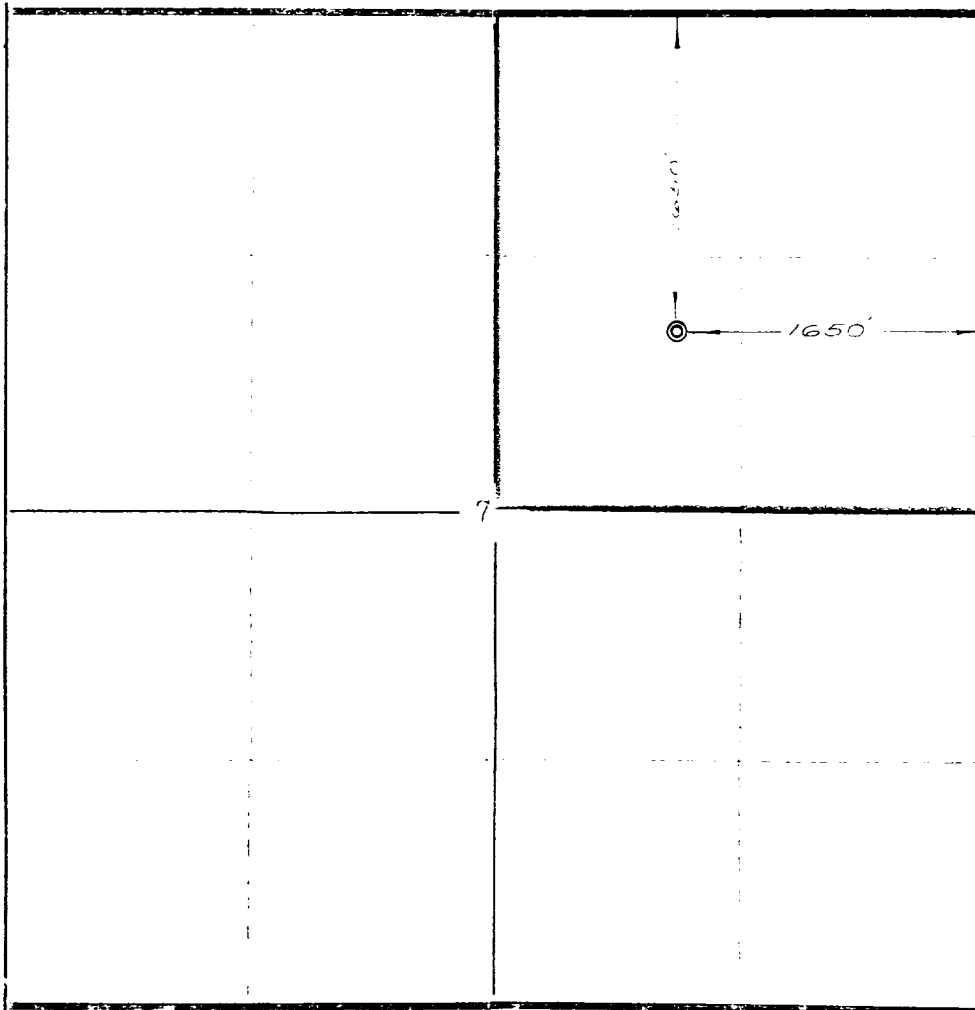

NOTE

This section of form is to be used for gas wells only.

SCALE: 1" = 1000'

1. Is this Well a Dual Comp. ? Yes No
2. If the answer to Question 1 is yes, are there any other dually completed wells within the dedicated acreage?
Yes No

This is to certify that the above plat was prepared from field notes of actual surveys made by me or under my supervision and that the same are true and correct to the best of my knowledge and belief.

Name **Area Superintendent of Production**
Position **Gulf Oil Corporation**
Representing **P. O. Box 209, Denver 1, Colorado**
Address

Date Surveyed **May 11, 1956**

Ernest V. Echolaw
Reg. Land Surveyor, N. Mex., Reg. No. 1515