

(SUBMIT IN TRIPLICATE)

UNITED STATES
DEPARTMENT OF THE INTERIOR
GEOLOGICAL SURVEY

Indian Agency _____
Jicarilla Tribal
Allottee **Jicarilla "B"**
Lease No. **Contract No. 60**

Sec. 6
#22

SUNDRY NOTICES AND REPORTS ON WELLS

NOTICE OF INTENTION TO DRILL	<input checked="" type="checkbox"/>	SUBSEQUENT REPORT OF WATER SHUT-OFF	
NOTICE OF INTENTION TO CHANGE PLANS	<input checked="" type="checkbox"/>	SUBSEQUENT REPORT OF SHOOTING OR ACIDIZING	
NOTICE OF INTENTION TO TEST WATER SHUT-OFF		SUBSEQUENT REPORT OF ALTERING CASING	
NOTICE OF INTENTION TO REDRILL OR REPAIR WELL		SUBSEQUENT REPORT OF REDRILLING OR REPAIR	
NOTICE OF INTENTION TO SHOOT OR ACIDIZE		SUBSEQUENT REPORT OF ABANDONMENT	
NOTICE OF INTENTION TO PULL OR ALTER CASING		SUPPLEMENTARY WELL HISTORY	
NOTICE OF INTENTION TO ABANDON WELL			

JAN 2 1962
U. S. GEOLOGICAL SURVEY

(INDICATE ABOVE BY CHECK MARK NATURE OF REPORT, NOTICE, OR OTHER DATA)

Hobbs, New Mexico - December 28, 19 **61**

Jicarilla "B"
Well No. **22** is located **1690** ft. from **[N]** line and **790** ft. from **[E]** line of sec. **6**
SW 1/4 NW 1/4 Sec. 6 **24-N** **5-W** **N.M.P.M.**
(1/4 Sec. and Sec. No.) (Twp.) (Range) (Meridian)
Basin Dakota **Rio Arriba** **New Mexico**
(Field) (County or Subdivision) (State or Territory)

The elevation of the derrick floor above sea level is _____ ft.

DETAILS OF WORK

(State names of and expected depths to objective sands; show sizes, weights, and lengths of proposed casings; indicate mudding jobs, cementing points, and all other important proposed work)

Propose to drill with rotary tools from surface to total depth of approx. 7200' in the Dakota Formation. Casing program to be approx. as follows:

Size Hole	Size Casing	Casing Point	Sacks Cement
12-1/4"	8-5/8"	315'	315
7-7/8"	4-1/2"	7200'	600

Pump & Plug Process will be used in cementing both strings of casing & cement will be circulated to surface on 8-5/8" OD casing. The 4-1/2" OD casing will be set at approx. 7200' with DV Tool set below Pictured Cliffs & Chacra Formations at approx. 3700' with 300 sacks. The 4-1/2" OD casing will be perforated and treated with approx. 50,000 gal sand and 50,000 gals. water.

I understand that this plan of work must receive approval in writing by the Geological Survey before operations may be commenced.

Company **Shelly Oil Company**

Address **Box 36**

Hobbs, New Mexico

By **J E Cobb**

Title **Dist. Supt.**

NEW MEXICO OIL CONSERVATION COMMISSION
WELL LOCATION AND ACREAGE DEDICATION PLAT

SECTION A.

DATE December 28, 1961

OPERATOR Skelly Oil Company LEASE Jicarilla "B"
WELL NO. 22 UNIT LETTER B SECTION 6 TOWNSHIP 24 North RANGE 5 West NMMP
LOCATED 1850 FEET FROM North LINE, 790 FEET FROM West LINE
COUNTY Rio Arriba G. L. ELEVATION 6765 DEDICATED ACREAGE 366.95 ACRES
NAME OF PRODUCING FORMATION Dakota POOL Basin Dakota

1. IS THE OPERATOR THE ONLY OWNER* IN THE DEDICATED ACREAGE OUTLINED ON THE PLAT BELOW? YES XX NO _____
2. IF THE ANSWER TO QUESTION ONE IS "NO," HAVE THE INTERESTS OF ALL THE OWNERS BEEN CONSOLIDATED BY COMMUNITIZATION AGREEMENT OR OTHERWISE? YES _____ NO _____ IF ANSWER IS "YES," TYPE OF CONSOLIDATION _____
3. IF THE ANSWER TO QUESTION TWO IS "NO," LIST ALL THE OWNERS AND THEIR RESPECTIVE INTERESTS BELOW:

OWNER

LAND DESCRIPTION



SECTION B.

(Section as shown on record plat)

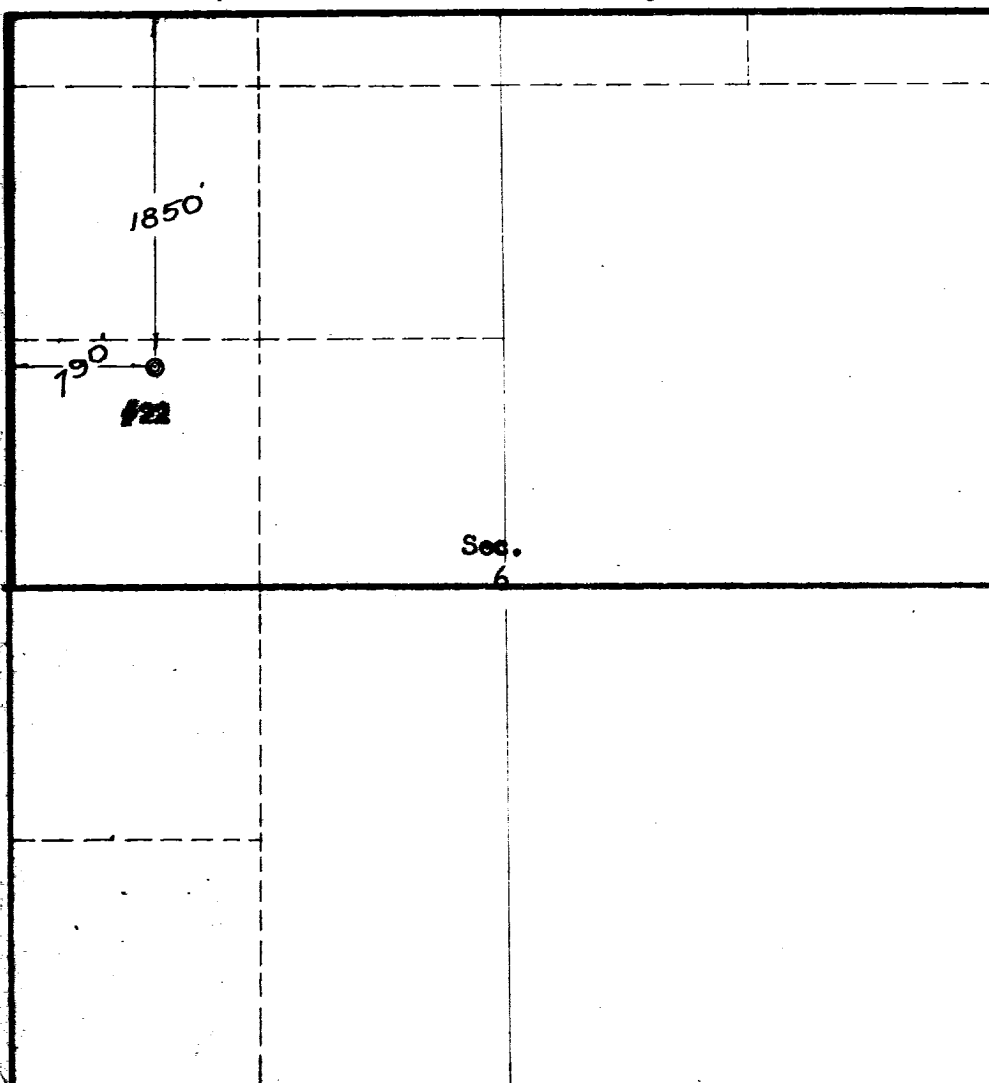

THIS IS TO CERTIFY THAT THE INFORMATION IN SECTION A ABOVE IS TRUE AND COMPLETE TO THE BEST OF MY KNOWLEDGE AND BELIEF.

Skelly Oil Company
(OPERATOR)

J E Gab Dist. Supt.
(REPRESENTATIVE)

Box 38 - Hobbs, New Mexico
(ADDRESS)

THIS IS TO CERTIFY THAT THE WELL LOCATION SHOWN ON THE PLAT IN SECTION B WAS PLOTTED FROM FIELD NOTES OF ACTUAL SURVEYS MADE BY ME OR UNDER MY SUPERVISION AND THAT THE SAME IS TRUE AND CORRECT TO THE BEST OF MY KNOWLEDGE AND BELIEF.

DATE SURVEYED Dec. 21, 1961

FOUR STATES
ENGINEERING CO.
FARMINGDALE, NEW YORK

CERTIFICATE NO. 181579

