

(SUBMIT IN TRIPLICATE)

UNITED STATES
DEPARTMENT OF THE INTERIOR
GEOLOGICAL SURVEY

Land Office Santa Fe
Lease No. 000594 and 000594-8
WELL W200

SUNDRY NOTICES AND REPORTS ON WELLS

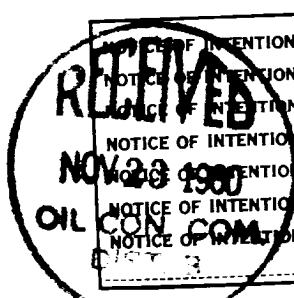

NOTICE OF INTENTION TO DRILL	<input checked="" type="checkbox"/>	SUBSEQUENT REPORT OF WATER SHUT-OFF	
NOTICE OF INTENTION TO CHANGE PLANS		SUBSEQUENT REPORT OF SHOOTING OR ACIDIZING	
NOTICE OF INTENTION TO TEST WATER SHUT-OFF		SUBSEQUENT REPORT OF ALTERING CASING	
NOTICE OF INTENTION TO RE-DRILL OR REPAIR WELL		SUBSEQUENT REPORT OF RE-DRILLING OR REPAIR	
NOTICE OF INTENTION TO SHOOT OR ACIDIZE		SUBSEQUENT REPORT OF ABANDONMENT	
NOTICE OF INTENTION TO PULL OR ALTER CASING		SUPPLEMENTARY WELL HISTORY	
NOTICE OF INTENTION TO ABANDON WELL			

(INDICATE ABOVE BY CHECK MARK NATURE OF REPORT, NOTICE, OR OTHER DATA)

October 31, 19 60

Well No. 1 Boleak is located 1190 ft. from N line and 990 ft. from EX line of sec. 1
WW 1 24N 6W W200
(1/4 Sec. and Sec. No.) (Twp.) (Range) (Meridian)
Undesignated Dakota Rio Arriba New Mexico
(Field) (County or Subdivision) (State or Territory)

The elevation of the derrick floor above sea level is 6699 ft.

DETAILS OF WORK

(State names of and expected depths to objective sands; show sizes, weights, and lengths of proposed casings; indicate mudding jobs, cementing points, and all other important proposed work)

We propose to drill and complete this well as follows:

1. Drilling procedure - Rotary tools surface to total depth, E. P. Campbell drilling contractor.
2. Surface casing - 200' 10-3/4" casing cemented to surface.
3. Production casing - 7075' 7" casing cemented to approximately 5500' to cover Gallup formation and from 2600 to 2400 through 6W tool to cover Pictured Cliffs formation.
4. Completion - Dual through two strings of tubing from perforations in Gallup oil zone (approximately 5700-6000) and Dakota (approximately 6700-7075) with packer set below Gallup perforations.

I understand that this plan of work must receive approval in writing by the Geological Survey before operations may be commenced.

Company Key Kimbell
Address 2127 San Mateo NE
Albuquerque, New Mexico

By Jay J. Warner
Geologist
Title _____

Approved subject to State approval of the unorthodox location.



NEW MEXICO OIL CONSERVATION COMMISSION
Well Location and Acreage Dedication Plat

SECTION A.

Date **10-31-60**

Operator **Kay Kimbell** Lease **Delack**
Well No. **8** Unit Letter **D** Section **1** Township **24-North** Range **6-West** NMPM
Located **1190** Feet From **North** Line, **990** Feet From **West** Line
County **Rio Arriba** G. L. Elevation **6690'** Dedicated Acreage **90-00 Delack** Acres
Name of Producing Formation **Delack - Gallup dual** Pool **Store Gallup, Undesignated Delack**

1. Is the Operator the only owner* in the dedicated acreage outlined on the plat below? Yes _____ No **X**
2. If the answer to question One is "No," have the interests of all the owners been consolidated by communization agreement or otherwise? Yes **X** No _____. If answer is "Yes," Type of Consolidation **Operating Agreements**
3. If the answer to question Two is "No," list all the owners and their respective interests below:

OWNER

LAND DESCRIPTION

SECTION B.

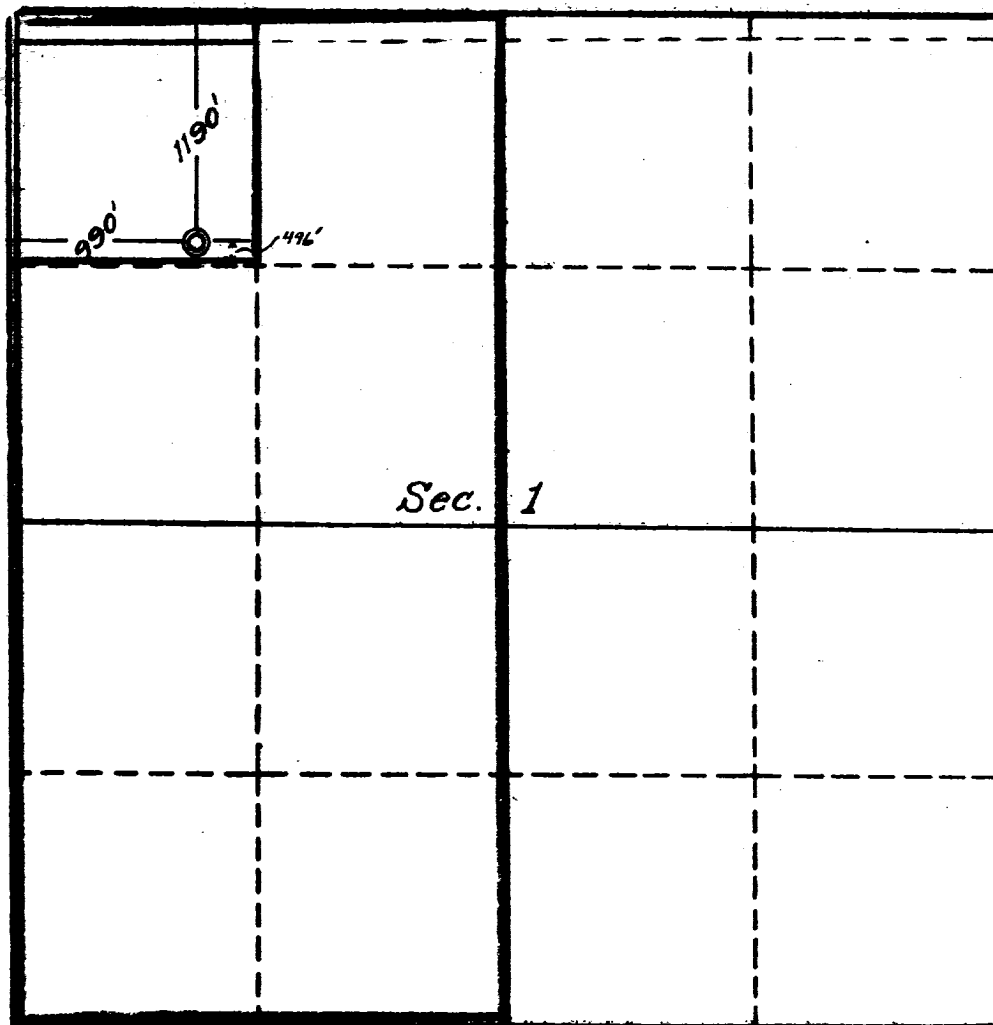

This is to certify that the information in Section A above is true and complete to the best of my knowledge and belief.

Kay Kimbell

(OPERATOR)

(REPRESENTATIVE)

**2127 San Mateo NE
Albuquerque, New Mexico**

(ADDRESS)

This is to certify that the well location shown on the plat in Section B was plotted from field notes of actual survey made by me or under my supervision and that the same is true and correct to the best of my knowledge and belief.

Date Surveyed **10-23-60**

Four States Engineering Co.
FARMINGTON, NEW MEXICO

C. L. Fotal
REGISTERED ENGINEER OR
LAND SURVEYOR

Certificate No. **3084**



6-1-3