

(SUBMIT IN TRIPLICATE)  
UNITED STATES  
DEPARTMENT OF THE INTERIOR  
GEOLOGICAL SURVEY

Indian Agency Alamogordo  
Tribal Alamogordo  
Allottee Alamogordo  
Lease No. Contract No.

# SUNDRY NOTICES AND REPORTS ON WELLS

NOTICE OF INTENTION TO DRILL	<input checked="" type="checkbox"/>	SUBSEQUENT REPORT OF WATER SHUT-OFF	
NOTICE OF INTENTION TO CHANGE PLANS		SUBSEQUENT REPORT OF SHOOTING OR ACIDIZING	
NOTICE OF INTENTION TO TEST WATER SHUT-OFF		SUBSEQUENT REPORT OF ALTERING CASING	
NOTICE OF INTENTION TO REDRILL OR REPAIR WELL		SUBSEQUENT REPORT OF REDRILLING OR REPAIR	
NOTICE OF INTENTION TO SHOOT OR ACIDIZE		SUBSEQUENT REPORT OF ABANDONMENT	
NOTICE OF INTENTION TO PULL OR ALTER CASING		SUPPLEMENTARY WELL HISTORY	
NOTICE OF INTENTION TO ABANDON WELL			

(INDICATE ABOVE BY CHECK MARK NATURE OF REPORT, NOTICE, OR OTHER DATA)

**RECEIVED**  
OCT 29 1958

U. S. GEOLOGICAL SURVEY  
WASHINGTON, NEW MEXICO  
October 21, 1958

Alamogordo 73  
Well No. 16 is located 543 ft. from N line and 1912 ft. from E line of sec. 6  
SW 1/4 - NE 1/4 Section 6 24N 5W N.M.P.M.  
(1/4 Sec. and Sec. No.) (Twp.) (Range) (Meridian)  
Olvera-Gallup Rio Arriba New Mexico  
(Field) (County or Subdivision) (State or Territory)

The elevation of the derrick floor above sea level is \_\_\_\_\_ ft.

## DETAILS OF WORK

(State names of and expected depths to objective sands; show sizes, weights, and lengths of proposed casings; indicate mudding jobs, cementing points, and all other important proposed work)

It is our intention to drill Well No. 16 to approximately 4400' to test the Gallup formation. Our casing program is as follows:

300' of 10-3/4" OD 32.75# K-40 casing with 250 sacks regular cement, to be circulated.

4400' of 5-1/2" OD 15.5# J-55 casing with 450 sacks regular cement.

The designated drilling unit is the SW 1/4 - NE 1/4 of Section 6-24N-5W, Rio Arriba County, New Mexico.

I understand that this plan of work must receive approval in writing by the Geological Survey before operations may be commenced.

Company \_\_\_\_\_

Address \_\_\_\_\_

By (Signed) P. E. Cosper

Title District Superintendent



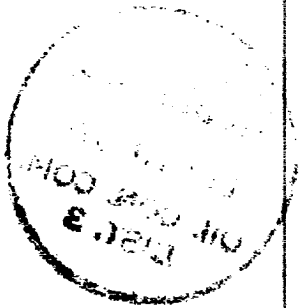

NEW MEXICO OIL CONSERVATION COMMISSION  
Well Location and Acreage Dedication Plat

Section A.

Date October 21, 1958

Operator SKELLY OIL COMPANY Lease JICARILLA  
Well No. B-16 Unit Letter B Section 6 Township 24 NORTH Range 5 WEST NMPM  
Located 543 Feet From THE NORTH Line, 1912 Feet From THE EAST Line  
County SAN JUAN G. L. Elevation - Dedicated Acreage 40 Acres  
Name of Producing Formation Gallup Pool Otero

1. Is the Operator the only owner\* in the dedicated acreage outlined on the plat below?  
Yes X No       .
2. If the answer to question one is "no," have the interests of all the owners been consolidated by communitization agreement or otherwise? Yes        No       . If answer is "yes," Type of Consolidation
3. If the answer to question two is "no," list all the owners and their respective interests below:  
Ref: GLO Plat dated 4 Nov. 1832

Owner

Land Description

Section B

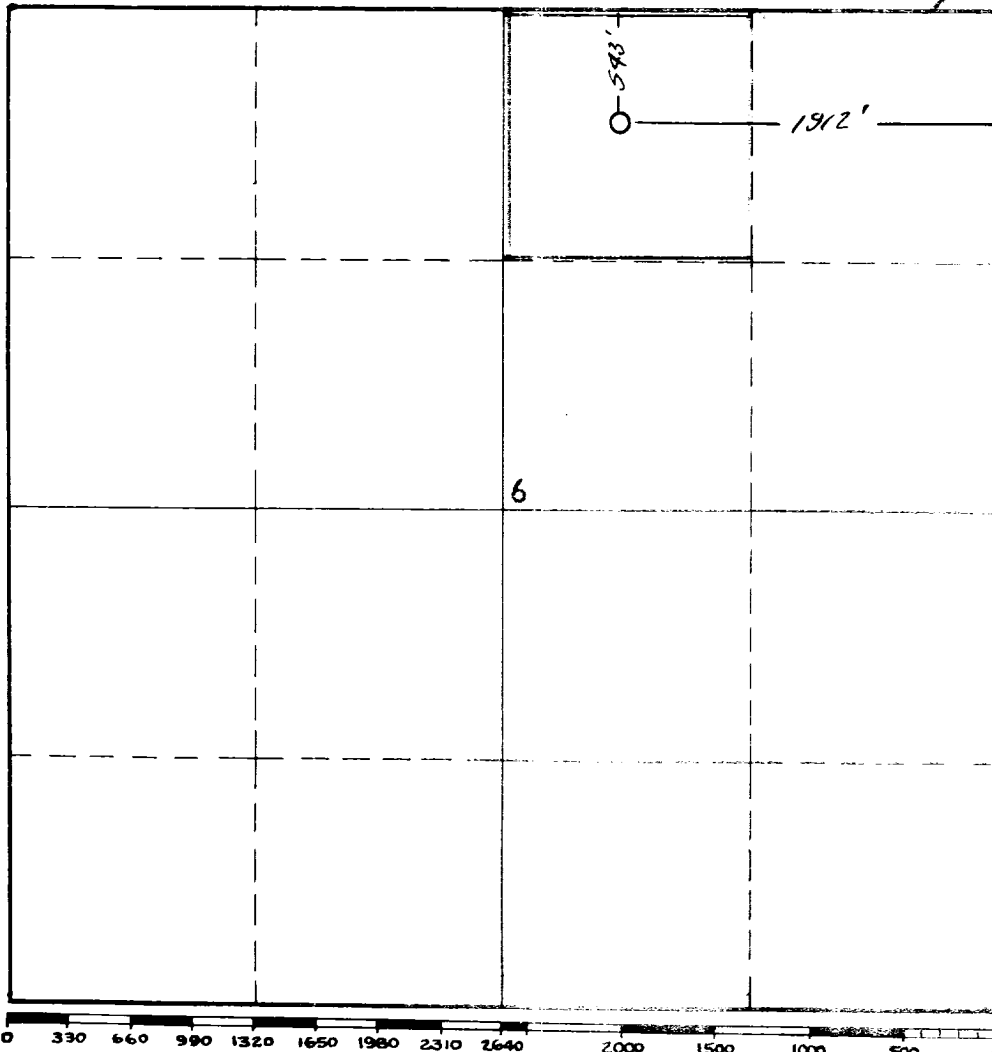

This is to certify that the information in Section A above is true and complete to the best of my knowledge and belief.

SKELLY OIL COMPANY

(Operator)

(Signed) P. E. Cosper

(Representative)

Box 426 - Farmington, New Mexico  
Address

This is to certify that the well location shown on the plat in Section B was plotted from field notes of actual surveys made by me or under my supervision and that the same is true and correct to the best of my knowledge and belief.

Date Surveyed 23 Oct. 1958

James P. Leese  
Registered Professional  
Engineer and/or Land Surveyor.  
James P. Leese

Certificate No. 1463

INSTRUCTIONS FOR COMPLETION:

1. Operator shall furnish and certify to the information called for in Section A.
2. Operator shall outline the dedicated acreage for both oil and gas wells on the plat in Section B.
3. A registered professional engineer or land surveyor registered in the State of New Mexico or approved by the Commission shall show on the plat the location of the well and certify this information in the space provided.
4. All distances shown on the plat must be from the outer boundaries of Section.
5. If additional space is needed for listing owners and their respective interests as required in question 3, Section A, please use space below

\* "Owner" means the person who has the right to drill into and to produce from any pool and to appropriate the production either for himself or for himself and another. (65-3-29 (e) NMSA 1953 Comp.)