

Well Location and Acreage Dedication Plat

Section A.

Date MAY 15, 1962

Operator STANDARD OIL COMPANY OF TEXAS Lease FEDERAL 17
 Well No. 32-1 Unit Letter N Section 32 Township 25 NORTH Range 1 EAST, NMPM
 Located 660 Feet From the SOUTH Line, 1650 Feet From the WEST Line
 County RIO ARriba G. L. Elevation 6994.0 Dedicated Acreage 40 Acres
 Name of Producing Formation Gallup Pool UNDESIGNATED

1. Is the Operator the only owner in the dedicated acreage outlined on the plat below?

Yes X No

2. If the answer to question one is "no", have the interests of all the owners been consolidated by communitization agreement or otherwise? Yes No. If answer is "yes", Type of Consolidation.

3. If the answer to question two is "no", list all the owners and their respective interests below:

Owner

Land Description

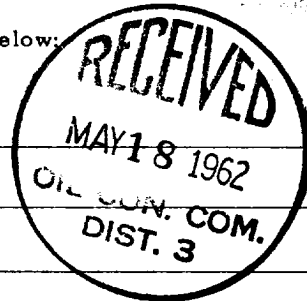

Section B.

Note: All distances must be from outer boundaries of section.

This is to certify that the information
 in Section A above is true and complete
 to the best of my knowledge and belief.

STANDARD OIL CO. OF TEXAS, A DIVI-
SION OF CALIFORNIA OIL CO.

D. C. Helm
 (Representative)

DRAWER "S"
 (Address)

MONAHANS, TEXAS

Ref: GLO plat dated 22 April 1918

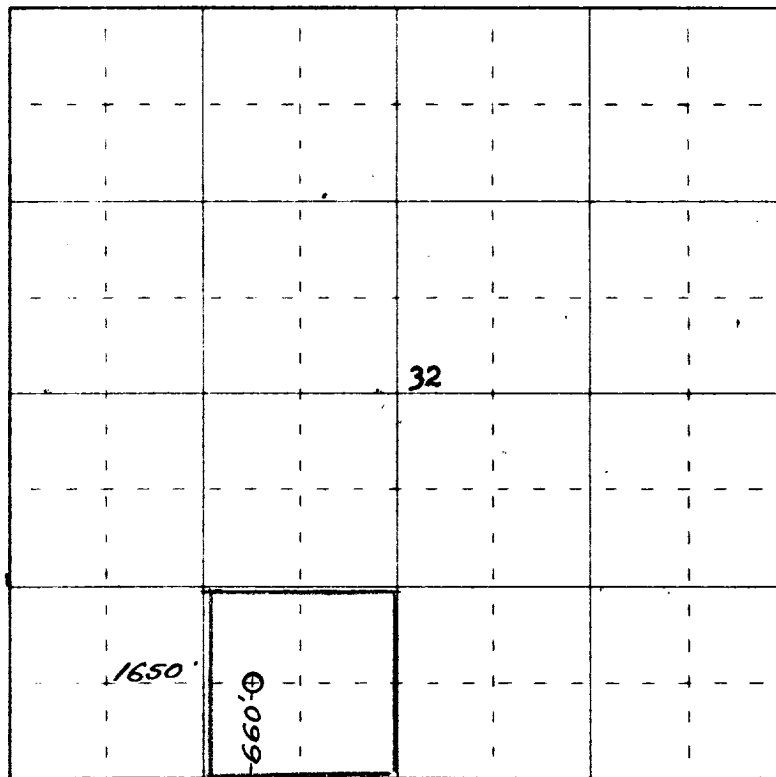

0 330 660 990 1320 1650 1980 2310 2640 2000 1500 1000 500 0

Scale 4 inches equal 1 mile

This is to certify that the above plat was prepared from field notes of actual surveys
 made by me or under my supervision and that the same are true and correct to the best
 of my knowledge and belief.

Date Surveyed 12 May 1962

James P. Leese
 Registered Professional Engineer and/or Land Surveyor
 James P. Leese N. Mex. Reg. No. 1463
 San Juan Engineering Company



Farmington, New Mexico