

(SUBMIT IN TRIPLICATE)

Indian Agency Jicarilla

UNITED STATES
DEPARTMENT OF THE INTERIOR
GEOLOGICAL SURVEY

Allottee Jicarilla Tribal
Lease No. Lease No. 41

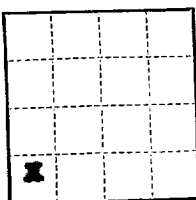

SUNDRY NOTICES AND REPORTS ON WELLS

NOTICE OF INTENTION TO DRILL	<input checked="" type="checkbox"/>	SUBSEQUENT REPORT OF WATER SHUT-OFF	RECEIVED JUL 31 1959 U.S. GEOLOGICAL SURVEY FARMINGTON NEW MEXICO
NOTICE OF INTENTION TO CHANGE PLANS	<input type="checkbox"/>	SUBSEQUENT REPORT OF SHOOTING OR ACIDIZING	
NOTICE OF INTENTION TO TEST WATER SHUT-OFF	<input type="checkbox"/>	SUBSEQUENT REPORT OF ALTERING CASING	
NOTICE OF INTENTION TO REDRILL OR REPAIR WELL	<input type="checkbox"/>	SUBSEQUENT REPORT OF REDRILLING OR REPAIR	
NOTICE OF INTENTION TO SHOOT OR ACIDIZE	<input type="checkbox"/>	SUBSEQUENT REPORT OF ABANDONMENT	
NOTICE OF INTENTION TO PULL OR ALTER CASING	<input type="checkbox"/>	SUPPLEMENTARY WELL HISTORY	
NOTICE OF INTENTION TO ABANDON WELL	<input type="checkbox"/>		

(INDICATE ABOVE BY CHECK MARK NATURE OF REPORT, NOTICE, OR OTHER DATA)

July 30th, 19 59

Well No. 6-D is located 990 ft. from [S] line and 990 ft. from [W] line of sec. 32
SW/4 SW/4 Sec. 32 25N 4W N.M.P.M.
(1/4 Sec. and Sec. No.) (Twp.) (Range) (Meridian)
S. Blanco PC Est. Rio Arriba New Mexico
(Field) (County or Subdivision) (State or Territory)

The elevation of the derrick floor above sea level is 6804 ft.

DETAILS OF WORK

(State names of and expected depths to objective sands; show sizes, weights, and lengths of proposed casings; indicate mudding jobs, cementing points, and all other important proposed work)

Pictured Cliffs Sand test. Estimated total depth 3200'.

Surface Casing: 90' of 8-5/8" OD 24# J-55 cemented to surface.
Production : Approximately 3200' of 5-1/2" OD 15.5# J-55 cemented with 150 sacks.

If commercial production is indicated, the producing section will be sand-water fractured.

I understand that this plan of work must receive approval in writing by the Geological Survey before operations may be commenced.

Company EL PASO NATURAL GAS COMPANY

Address Box 997
Farmington, New Mexico

By S. S. Oberly
 Title Division Petroleum Engineer

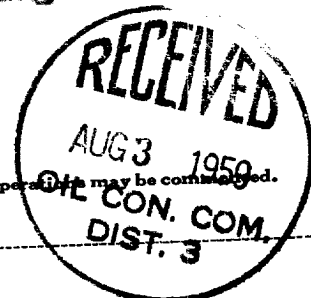



NEW MEXICO OIL CONSERVATION COMMISSION
WELL LOCATION AND ACREAGE DEDICATION PLAT

FORM C-128
Revised 5/1/57

SEE INSTRUCTIONS FOR COMPLETING THIS FORM ON THE REVERSE SIDE

SECTION A

Operator EL PASO NATURAL GAS COMPANY			Lease JICARILLA		Well No. 6 - D
Unit Letter M	Section 32	Township 25 NORTH	Range 4 WEST	County EL PASO	
Actual Footage Location of Well: 990 feet from the SOUTH line and 990 feet from the WEST line					
Ground Level Elev. 6796.0	Producing Formation Fractured Cliffs		Pool S. Blanco PC	Dedicated Acreage: 180 Acres	

- Ref: GLO plat dated 4 November 1882
1. Is the Operator the only owner in the dedicated acreage outlined on the plat below? YES ☒ NO ☐ . ("Owner" means the person who has the right to drill into and to produce from any pool and to appropriate the production either for himself or for himself and another. (65-3-29 (e) NMSA 1935 Comp.)
 2. If the answer to question one is "no," have the interests of all the owners been consolidated by a joint ownership agreement or otherwise? YES ☐ NO ☐ . If answer is "yes," Type of Consolidation _____
 3. If the answer to question two is "no," list all the owners and their respective interests below:

Owner	Land Description

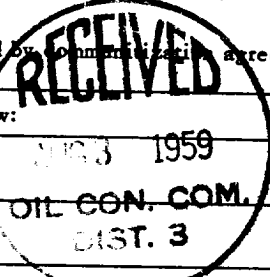

SECTION B

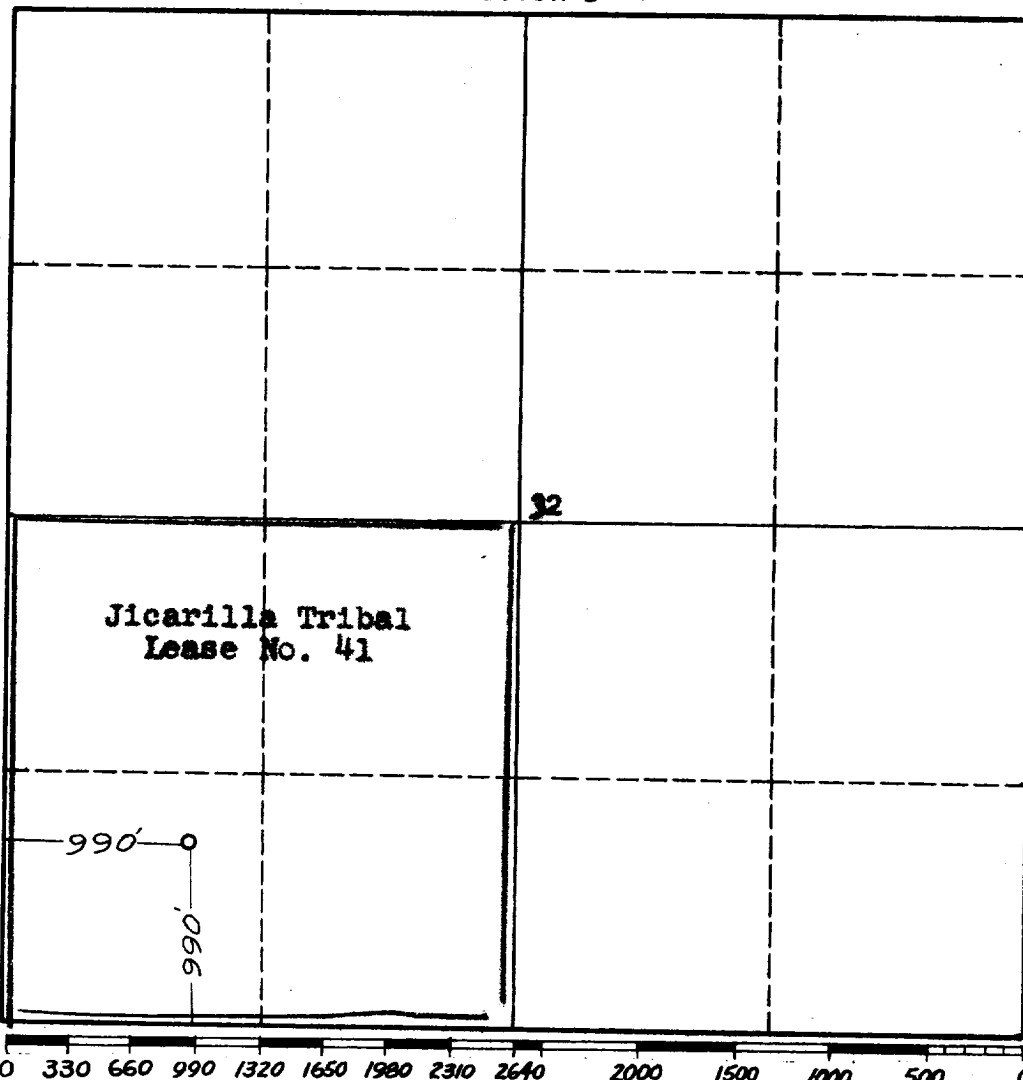

CERTIFICATION

I hereby certify that the information in SECTION A above is true and complete to the best of my knowledge and belief.

Name	S. S. Oberly
Position	Division Petroleum Engr.
Company	El Paso Natural Gas Co.
Date	July 30, 1959

I hereby certify that the well location shown on the plat in SECTION B was plotted from field notes of actual surveys made by me or under my supervision, and that the same is true and correct to the best of my knowledge and belief.

Date Surveyed	28 July 1959
Registered Professional Engineer and/or Land Surveyor	James P. Lease
Certificate No.	1463

INSTRUCTIONS FOR COMPLETION OF FORM C-128

1. Operator shall furnish and certify to the information called for in Section A.
2. Operator shall outline the dedicated acreage for *both* oil and gas wells on the plat in Section B.
3. A registered professional engineer or land surveyor registered in the State of New Mexico or approved by the Commission shall show on the plat the location of the well and certify this information in the space provided.
4. All distances shown on the plat must be from the outer boundaries of the Section.
5. If additional space is needed for listing owners and their respective interests as required in question 3 of Section A, please use space below.