

(SUBMIT IN TRIPLICATE)

Indian Agency **Jicarilla**

UNITED STATES
DEPARTMENT OF THE INTERIOR
GEOLOGICAL SURVEY

Allottee **Jicarilla Tribal**

Lease No. **Lease No. 66**

SUNDRY NOTICES AND REPORTS ON WELLS

NOTICE OF INTENTION TO DRILL	<input checked="" type="checkbox"/>	SUBSEQUENT REPORT OF WATER SHUT-OFF	
NOTICE OF INTENTION TO CHANGE PLANS		SUBSEQUENT REPORT OF SHOOTING OR ACIDIZING	
NOTICE OF INTENTION TO TEST WATER SHUT-OFF		SUBSEQUENT REPORT OF ALTERING CASING	
NOTICE OF INTENTION TO REDRILL OR REPAIR WELL		SUBSEQUENT REPORT OF REDRILLING OR REPAIR	
NOTICE OF INTENTION TO SHOOT OR ACIDIZE		SUBSEQUENT REPORT OF ABANDONMENT	
NOTICE OF INTENTION TO PULL OR ALTER CASING		SUPPLEMENTARY WELL HISTORY	
NOTICE OF INTENTION TO ABANDON WELL			

(INDICATE ABOVE BY CHECK MARK NATURE OF REPORT, NOTICE, OR OTHER DATA)

October 16th, 1958

Well No. **10-B** is located **1830** ft. from **[N]** line and **1530** ft. from **[W]** line of sec. **34**

NE/4 SW/4 Sec. 34
(1/4 Sec. and Sec. No.)

25N 4W
(Twp.) (Range)

N.M.P.M.
(Meridian)

S. Blanco PC Ext.
(Field)

Rio Arriba
(County or Subdivision)

New Mexico
(State or Territory)

The elevation of the derrick floor above sea level is **7043** ft.

DETAILS OF WORK

(State names of and expected depths to objective sands; show sizes, weights, and lengths of proposed casings; indicate mudding jobs, cementing points, and all other important proposed work)

Pictured Cliffs Sand test. Estimated total depth 3500'.

Surface Casing: 90' of 8-5/8" OD 24# J-55 cemented to surface.
Production " : Approximately 3500' of 5-1/2" OD 15.5# J-55 cemented with 100 sacks.

If commercial production is indicated, the producing section will be sand-water fractured.

I understand that this plan of work must receive approval in writing by the Geological Survey before operations may be commenced.

Company **EL PASO NATURAL GAS COMPANY**

Address **Box 997**
Farmington, New Mexico

By **DC Johnston**

Title **Petroleum Engineer**



NEW MEXICO OIL CONSERVATION COMMISSION

Well Location and Acreage Dedication Plat

Section A.

Date October 16, 1958

Operator EL PASO NATURAL GAS COMPANY Lease JICARILLA
 Well No. 10-B Unit Letter K Section 34 Township 25 NORTH Range 4 WEST NMPM
 Located 1850 Feet From THE SOUTH Line 1530 Feet From THE WEST Line
 County RIO ARriba G. L. Elevation 7034.9 Dedicated Acreage 160 Acres
 Name of Producing Formation Pictured Cliffs Pool S. Blanco PC Est.

1. Is the Operator the only owner in the dedicated acreage outlined on the plat below?
 Yes X No _____
2. If the answer to question one is "no", have the interests of all the owners been consolidated by communitization agreement or otherwise? Yes _____ No _____. If answer is "yes", Type of Consolidation.
3. If the answer to question two is "no", list all the owners and their respective interests below:

Owner

Land Description

Section B.

This is to certify that the information in Section A above is true and complete to the best of my knowledge and belief.

EL PASO NATURAL GAS COMPANY

DC Phuntom
 (Representative)

Box 997

(Address)

Farmington, New Mexico

Note: All distances must be from outer boundaries of section.

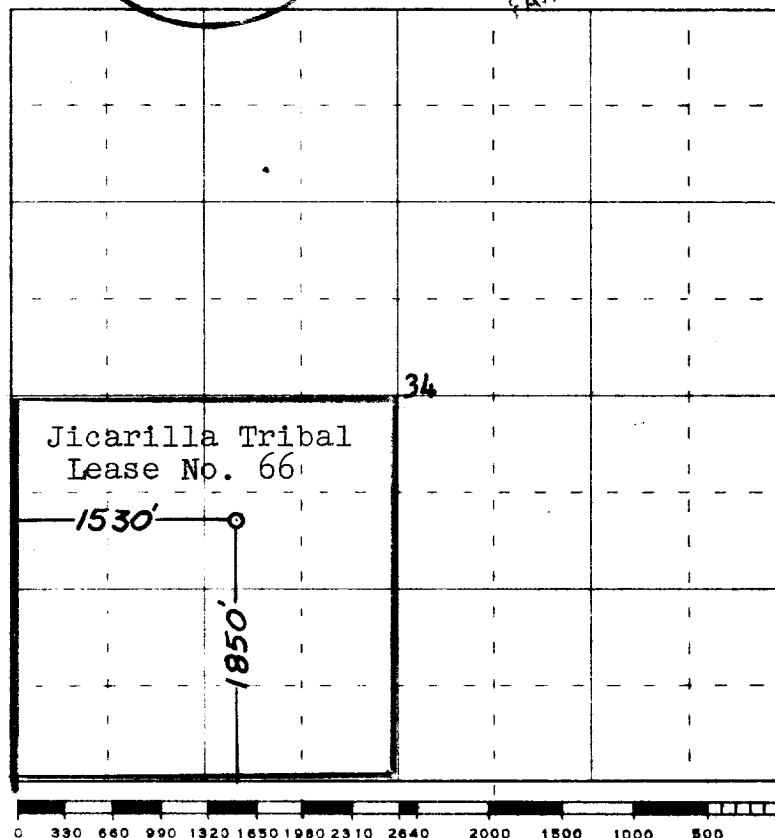

Ref. GLO Plat dated: 4 Dec. 1882

Scale 4 inches equal 1 mile

This is to certify that the above plat was prepared from field notes of actual surveys made by me or under my supervision and that the same are true and correct to the best of my knowledge and belief.

Date Surveyed 9 October 1958

James P. Lee
 Registered Professional Engineer and/or Land Surveyor
 JAMES P. LEESE N. Mex. Reg. No. 1463



Farmington, New Mexico