

NEW MEXICO
OIL CONSERVATION COMMISSION

Form C-128

Well Location and/or Gas Proration Plat

Date July 23, 1956

Operator Skelly Oil Company Lease _____

Well No. L.L. McConnell #5 Section 31 Township 25 North Range 3 West NMPM

Located 820 Feet From North Line, 1840 Feet From East Line,

Rio Arriba County, New Mexico. G. L. Elevation _____

Name of Producing Formation Placer Cliffs Pool Undesignated Dedicated Acreage 160

(Note: All distances must be from outer boundaries of Section)

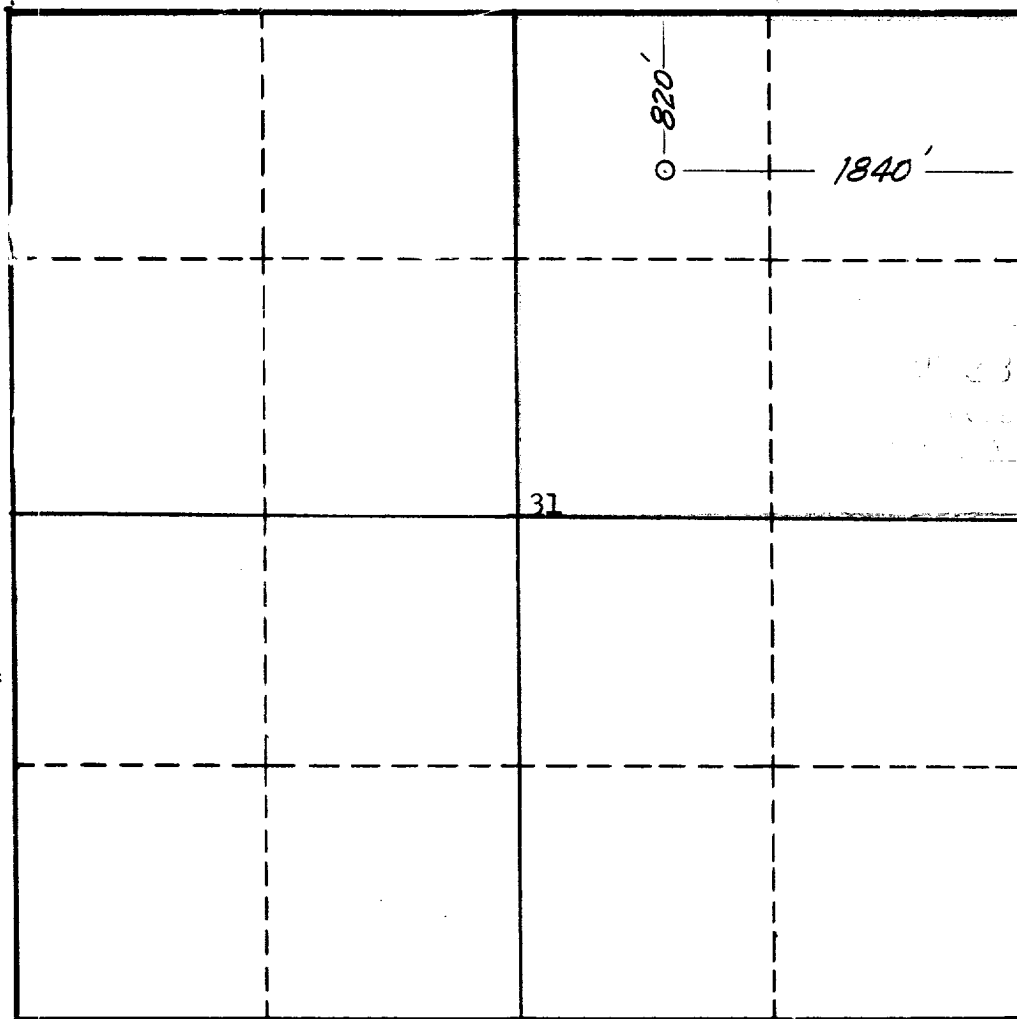

NOTE

This section of form is to be used for gas wells only.



SCALE: 1"=1000'

1. Is this Well a Dual Comp. ? Yes No
2. If the answer to Question 1 is yes, are there any other dually completed wells within the dedicated acreage? Yes No

Name _____
Position District Foreman
Representing Skelly Oil Company
Address Box 126, Huntington, New Mexico

This is to certify that the above plat was prepared from field notes of actual surveys made by me or under my supervision and that the same are true and correct to the best of my knowledge and belief.

Date Surveyed July 21, 1956
James P. Leese
Registered Professional Engineer and/or
Land Surveyor James P. Leese
Reg. No. 1463 New Mexico.