

(SUBMIT IN TRIPLICATE)

Indian Agency **Jicarilla Tribal**

#66 Tr. 125

UNITED STATES
DEPARTMENT OF THE INTERIOR
GEOLOGICAL SURVEY

Allottee

Lease No. **Jicarilla**

SUNDRY NOTICES AND REPORTS ON WELLS

NOTICE OF INTENTION TO DRILL	<input checked="" type="checkbox"/>	SUBSEQUENT REPORT OF WATER SHUT-OFF	
NOTICE OF INTENTION TO CHANGE PLANS		SUBSEQUENT REPORT OF SHOOTING OR ACIDIZING	
NOTICE OF INTENTION TO TEST WATER SHUT-OFF		SUBSEQUENT REPORT OF ALTERING CASING	
NOTICE OF INTENTION TO REDRILL OR REPAIR WELL		SUBSEQUENT REPORT OF REDRILLING OR REPAIR	
NOTICE OF INTENTION TO SHOOT OR ACIDIZE		SUBSEQUENT REPORT OF ABANDONMENT	
NOTICE OF INTENTION TO PULL OR ALTER CASING		SUPPLEMENTARY WELL HISTORY	
NOTICE OF INTENTION TO ABANDON WELL			

(INDICATE ABOVE BY CHECK MARK NATURE OF REPORT, NOTICE, OR OTHER DATA)

April 9

19 57

Well No. **4-B** is located **1170** ft. from **[N]** line and **925.3** ft. from **[W]** line of sec. **34**
SW Section 34 **25N** **4W** **N.M.P.M.**
(1/4 Sec. and Sec. No.) (Twp.) (Range) (Meridian)
So. Blanco P.C. Ext. **Rio Arriba** **New Mexico**
(Field) (County or Subdivision) (State or Territory)

The elevation of the derrick floor above sea level is **6930** ft.

DETAILS OF WORK

(State names of and expected depths to objective sands; show sizes, weights, and lengths of proposed casings; indicate mudding jobs, cementing points, and all other important proposed work)

It is intended to drill a well thru the **Pictured Cliffs** formation using rotary tools and to perforate and water fracture possible producing zones. Estimated Total Depth **3250'**.

Casing Program:

9-5/8" at **120'** with **125** sacks regular cement.

5-1/2" at **3250'** with **75** sacks regular cement and **75** sacks Formix.

The **NW/4** of Section **34** is dedicated to this well.

NW/4 Jicarilla Tribal #66 Tr. 125.



I understand that this plan of work must receive approval in writing by the Geological Survey before operations may be commenced.

Company **El Paso Natural Gas Company**

Address **Box 997**

Farmington, New Mexico

By **W. F. Corral**

Title **Petroleum Engineer**



NEW MEXICO
OIL CONSERVATION COMMISSION

Form No. 1

WELL LOCATION AND/OR GAS PRODUCTION PLAT

APRIL 3, 1957

EL PASO NATURAL GAS COMPANY

JICARILLA

66-TR-125

4-B

34

25 N

4 W

1170

NORTH

925.3

WEST

RIO ARRIBA

6919.91

PICTURED CLIFF

SO BLANCO PC
EXTENSION

160 AC.
(1882 PLAT)

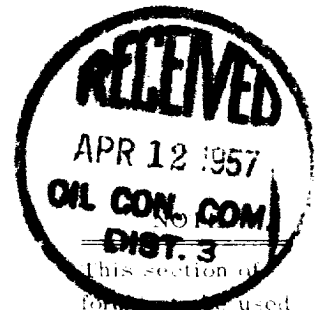
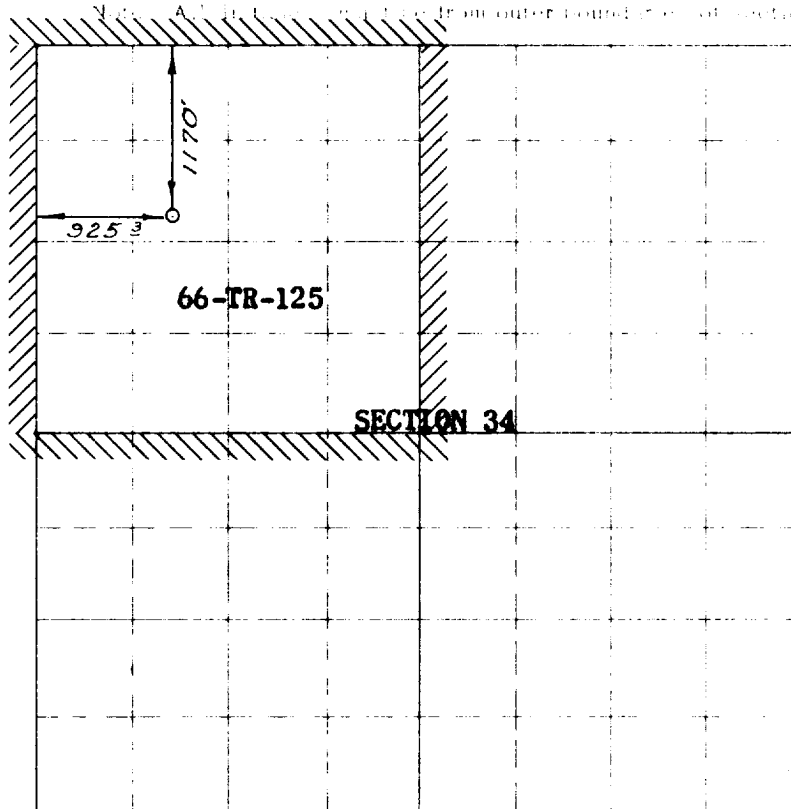

This is to certify that the above plat was prepared from field notes of actual surveys made by me or under my supervision and that the same are true and correct to the best of my knowledge and belief.

Date Surveyed **DECEMBER 28, 1956**

C. O. Walker
Registered Professional Engineer and/or Land Surveyor

1. Is this well a Dual Comp.

Yes _____ No **XX**

2. If the answer to Question 1 is yes, are there any other dually completed wells within the dedicated acreage.

Yes _____ No _____

Name *W. F. Dorset*

Position **Petroleum Engineer**

Representing **El Paso Natural Gas**

Address **Box 997, Farmington, N.M.**

(Send)

Farmington, New Mexico