

(SUBMIT IN TRIPLICATE)

Indian Agency **Jicarilla Tribal**

UNITED STATES
DEPARTMENT OF THE INTERIOR
GEOLOGICAL SURVEY

#66 Tr. 125

Allottee

Lease No. **Jicarilla**

SUNDRY NOTICES AND REPORTS ON WELLS

NOTICE OF INTENTION TO DRILL	<input checked="" type="checkbox"/>	SUBSEQUENT REPORT OF WATER SHUT-OFF
NOTICE OF INTENTION TO CHANGE PLANS		SUBSEQUENT REPORT OF SHOOTING OR ACIDIZING
NOTICE OF INTENTION TO TEST WATER SHUT-OFF		SUBSEQUENT REPORT OF ALTERING CASING
NOTICE OF INTENTION TO REDRILL OR REPAIR WELL		SUBSEQUENT REPORT OF REDRILLING OR REPAIR
NOTICE OF INTENTION TO SHOOT OR ACIDIZE		SUBSEQUENT REPORT OF ABANDONMENT
NOTICE OF INTENTION TO PULL OR ALTER CASING		SUPPLEMENTARY WELL HISTORY
NOTICE OF INTENTION TO ABANDON WELL		

(INDICATE ABOVE BY CHECK MARK NATURE OF REPORT, NOTICE, OR OTHER DATA)

April 9

19 **57**

Well No. **6-B** is located **800** ft. from **N** line and **1750** ft. from **E** line of sec. **33**

NE Section 33

(1/4 Sec. and Sec. No.)

23N

(Twp.)

4W

(Range)

N.M.P.M.

(Meridian)

So. Blanco P.C. Ext.

(Field)

Rio Arriba

(County or Subdivision)

New Mexico

(State or Territory)

The elevation of the derrick floor above sea level is **6865** ft.

DETAILS OF WORK

(State names of and expected depths to objective sands; show sizes, weights, and lengths of proposed casings; indicate mud logging jobs, casing points, and all other important proposed work)

It is intended to drill a well thru the Pictured Cliffs formation using rotary tools and to perforate and water fracture possible producing zones.
Estimated Total Depth **3175'**.

Casing Program:

9-5/8" at 120' with 125 sacks regular cement circulated to surface.

5-1/2" at 3175' with 75 sacks regular cement and 75 sacks Pomix.

The NE/4 of Section 33 is dedicated to this well.

NE/4 Jicarilla Tribal #66 Tr. 125.

I understand that this plan of work must receive approval in writing by the Geological Survey before operations may be commenced.

Company **El Paso Natural Gas Company**

Address **Box 997**

Farmington, New Mexico

By

Title

Petroleum Engineer

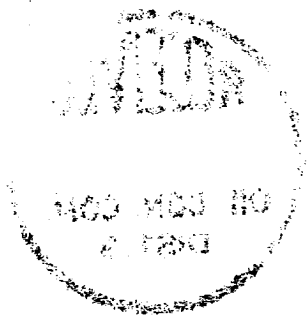

NEW MEXICO
OIL CONSERVATION COMMISSION

Form No. 29

WELL LOCATION AND/OR GAS PRORATION PLAT

APRIL 3, 1957

EL PASO NATURAL GAS COMPANY

JICARILLA

66-TR-125

6-B

33

25-N

4-W

800

NORTH

1750

EAST

RIO ARRIBA

6854.82

PICTURED CLIFF

SO. BLANCO

P.C. EXT.

160 ACRES
(1882 PLAT)

Note: All distances must be from outer boundaries of section.

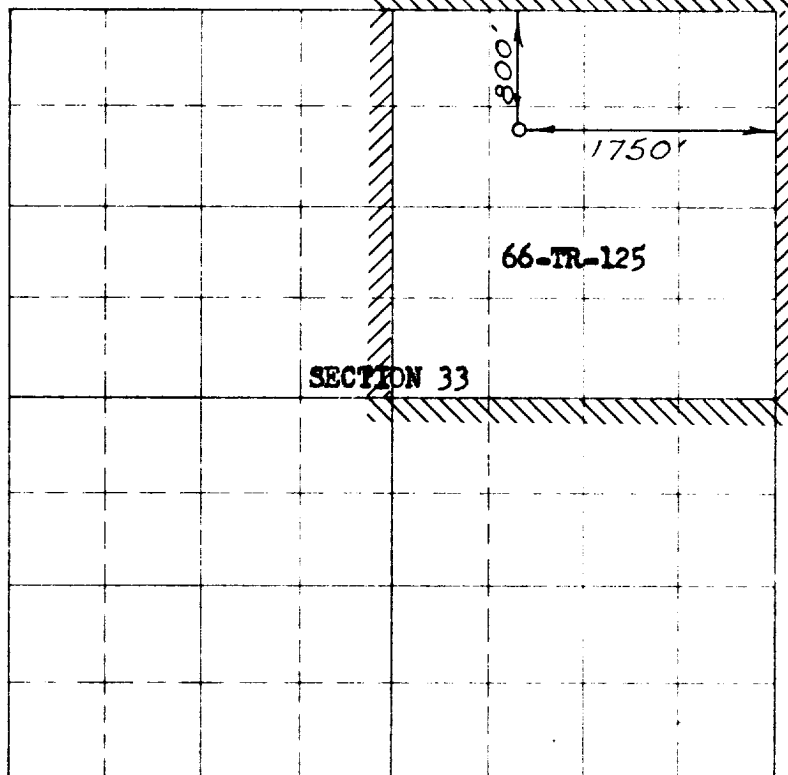

Scale 1 inch equals 1 mile



This section of
form is to be used
for gas wells only

I hereby certify that the above plat was prepared from
field notes of actual surveys made by me or under my
supervision and that the same are true and correct to the
best of my knowledge and belief.

Date Surv. **DECEMBER 28, 1956**

C. O. Walker
Registered Professional Engineer and/or Land Surveyor

1. Is this well a Dual Comp.
Yes _____ No **X**

2. If the answer to Question 1
is yes, are there any other dually
completed wells within the
dedicated acreage.

Yes _____ No _____

Name *W. F. Abbott*

Position **Petroleum Engineer**

Representing **El Paso Natural Gas**

Address **Box 997, Farmington, N.M.**

(Seal)

Farmington, New Mexico