

(SUBMIT IN TRIPLICATE)

Indian Agency Jicarilla

UNITED STATES

Tribal

DEPARTMENT OF THE INTERIOR

Allottee Jicarilla "C"

GEOLOGICAL SURVEY

Lease No. Contract #34

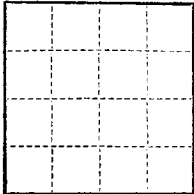

SUNDRY NOTICES AND REPORTS ON WELLS

NOTICE OF INTENTION TO DRILL	<input checked="" type="checkbox"/>	SUBSEQUENT REPORT OF WATER SHUT-OFF	
NOTICE OF INTENTION TO CHANGE PLANS		SUBSEQUENT REPORT OF SHOOTING OR ACIDIZING	
NOTICE OF INTENTION TO TEST WATER SHUT-OFF		SUBSEQUENT REPORT OF ALTERING CASING	
NOTICE OF INTENTION TO REDRILL OR REPAIR WELL		SUBSEQUENT REPORT OF REDRILLING OR REPAIR	
NOTICE OF INTENTION TO SHOOT OR ACIDIZE		SUBSEQUENT REPORT OF ABANDONMENT	
NOTICE OF INTENTION TO PULL OR ALTER CASING		SUPPLEMENTARY WELL HISTORY	
NOTICE OF INTENTION TO ABANDON WELL			

RECEIVED
NOV 5 1958
U. S. GEOLOGICAL SURVEY

(INDICATE ABOVE BY CHECK MARK NATURE OF REPORT, NOTICE, OR OTHER DATA)

November 3, 1958

Jicarilla "C"
Well No. 20 is located 660 ft. from N line and 660 ft. from W line of sec. 33

SW 1/4 - NW 1/4 Section 33 25N 3W N.M.P.M.
(1/4 Sec. and Sec. No.) (Twp.) (Range) (Meridian)

Osage (Gallup) ext Rio Arriba New Mexico
(Field) (County or Subdivision) (State or Territory)

The elevation of the derrick floor above sea level is _____ ft.

DETAILS OF WORK

(State names of and expected depths to objective sands; show sizes, weights, and lengths of proposed casings; indicate mudlogging jobs, cementing points, and all other important proposed work)

It is our intention to drill Well No. 20 approximately 6300' to test the Gallup formation. Our casing program is as follows:

300' of 10-3/4" OD 32.75# N-40 casing with 250 sacks regular cement, to be circulated.

6300' of 5-1/2" OD 15.5# J-55 casing with 450 sacks regular cement.

The designated drilling unit is the NW 1/4 - SW 1/4 of Section 33-25N-3W, Rio Arriba County, New Mexico.

If necessary, IW tool to be run to cover PC with cement.

I understand that this plan of work must receive approval in writing by the Geological Survey before operations may be commenced.

Company _____

Address _____

By (Signed) P. E. Cosper

Title District Superintendent



NEW MEXICO OIL CONSERVATION COMMISSION
Well Location and Acreage Dedication Plat

Section A.

Date November 1, 1958

Operator SKELLY OIL COMPANY Lease JICARILLA
Well No. C-20 Unit Letter D Section 33 Township 25 NORTH Range 5 WEST, NMPM
Located 660' Feet From THE NORTH Line, 660' Feet From THE WEST Line
County RIO ARriba G. L. Elevation - Dedicated Acreage 40 Acres
Name of Producing Formation Gallup Pool Chero

1. Is the Operator the only owner* in the dedicated acreage outlined on the plat below?
Yes X No .
2. If the answer to question one is "no," have the interests of all the owners been consolidated by communitization agreement or otherwise? Yes No . If answer is "yes," Type of Consolidation
3. If the answer to question two is "no," list all the owners and their respective interests below:

Ref: GLO Plat dated 4 Nov. 1882

Owner

Land Description



RECEIVED

Section B

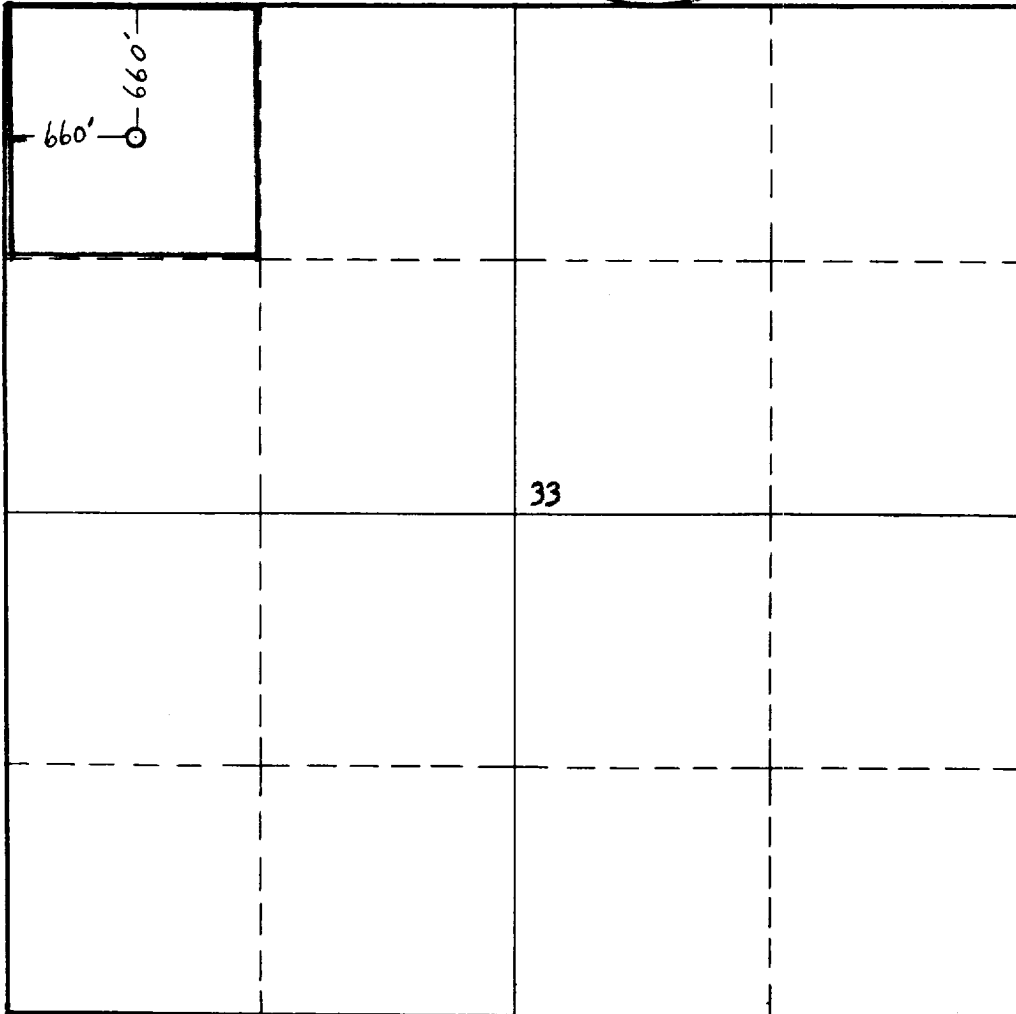

This is to certify that the information in Section A above is true and complete to the best of my knowledge and belief.

SKELLY OIL COMPANY

(Operator)

(Signed) P. E. Gosper

(Representative)

Box 426, Farmington, New Mexico

Address

This is to certify that the well location shown on the plat in Section B was plotted from field notes of actual surveys made by me or under my supervision and that the same is true and correct to the best of my knowledge and belief.

Date Surveyed 30 Oct. 1958

James P. Lease
Registered Professional
Engineer and/or Land Surveyor.

James P. Lease

Certificate No. 1463

(See instructions for completing this form on the reverse side)

INSTRUCTIONS FOR COMPLETION:

1. Operator shall furnish and certify to the information called for in Section A.
2. Operator shall outline the dedicated acreage for both oil and gas wells on the plat in Section B.
3. A registered professional engineer or land surveyor registered in the State of New Mexico or approved by the Commission shall show on the plat the location of the well and certify this information in the space provided.
4. All distances shown on the plat must be from the outer boundaries of Section.
5. If additional space is needed for listing owners and their respective interests as required in question 3, Section A, please use space below

* "Owner" means the person who has the right to drill into and to produce from any pool and to appropriate the production either for himself or for himself and another. (65-3-29 (e) NMSA 1953 Comp.)