

(SUBMIT IN TRIPLICATE)

UNITED STATES
DEPARTMENT OF THE INTERIOR
GEOLOGICAL SURVEY

Budget Bureau No. 42-K359.4.
Approval expires 12-31-60.
Indian Agency Jicarilla
Tribal
Allottee Jicarilla "B"
Lease No. Contract #66
Tract #127

SUNDRY NOTICES AND REPORTS ON WELLS

NOTICE OF INTENTION TO DRILL.....	<input checked="" type="checkbox"/>	SUBSEQUENT REPORT OF WATER SHUT-OFF.....	
NOTICE OF INTENTION TO CHANGE PLANS.....		SUBSEQUENT REPORT OF SHOOTING OR ACIDIZING.....	
NOTICE OF INTENTION TO TEST WATER SHUT-OFF.....		SUBSEQUENT REPORT OF ALTERING CASING.....	
NOTICE OF INTENTION TO REDRILL OR REPAIR WELL.....		SUBSEQUENT REPORT OF REDRILLING OR REPAIR.....	
NOTICE OF INTENTION TO SHOOT OR ACIDIZE.....		SUBSEQUENT REPORT OF ABANDONMENT.....	
NOTICE OF INTENTION TO PULL OR ALTER CASING.....		SUPPLEMENTARY WELL HISTORY.....	
NOTICE OF INTENTION TO ABANDON WELL.....			

(INDICATE ABOVE BY CHECK MARK NATURE OF REPORT, NOTICE, OR OTHER DATA)

August 13 1958

Jicarilla "B"
Well No. 14 is located 660 ft. from [N] line and 660 ft. from [W] line of sec. 32
SW/4-NW/4 (1/4 Sec. and Sec. No.) 29N (Twp.) 9W (Range) N.M.P.M. (Meridian)
Otero-Gallup (Field) Rio Arriba (County or Subdivision) New Mexico (State or Territory)

The elevation of the derrick floor above sea level is _____ ft.

DETAILS OF WORK

(State names of and expected depths to objective sands; show sizes, weights, and lengths of proposed casings; indicate mudlogging logs, cementing points, and all other important proposed work)

It is our intention to drill Well No. 14 to approximately 6400' to test the Gallup formation. Our casing program is as follows:

300' of 10-3/4" OD 32.7% N-40 casing with 250 sacks regular cement, to be circulated.

6400' of 5-1/2" OD 15.5% J-55 casing with 450 sacks regular cement.

The designated drilling unit is the NW/4-NW/4 of Section 32-29N-9W, Rio Arriba County, New Mexico.

I understand that this plan of work must receive approval in writing by the Geological Survey before operations may be commenced.

Company SKELLY OIL COMPANY

Address Box 426
San Mexican

By (Signed) P. E. Cooper
Title District Superintendent

1

(21 12 1971)
222:02
100 100

NEW MEXICO OIL CONSERVATION COMMISSION
Well Location and Acreage Dedication Plat

Section A.

Date August 13, 1958

Operator SKELLY OIL COMPANY Lease JICARILLA
Well No. B-14 Unit Letter D Section 32 Township 25 NORTH Range 5 WEST NMPM
Located 660 Feet From THE NORTH Line, 660 Feet From THE WEST Line
County RIO ARriba G. L. Elevation _____ Dedicated Acreage 40 Acres
Name of Producing Formation Gallup Pool One

1. Is the Operator the only owner* in the dedicated acreage outlined on the plat below?
Yes X No _____.
2. If the answer to question one is "no," have the interests of all the owners been consolidated by communitization agreement or otherwise? Yes _____ No _____. If answer is "yes," Type of Consolidation _____
3. If the answer to question two is "no," list all the owners and their respective interests below:
REF. GLO Plat dated: 4 November 1882

Owner

Land Description

Section B

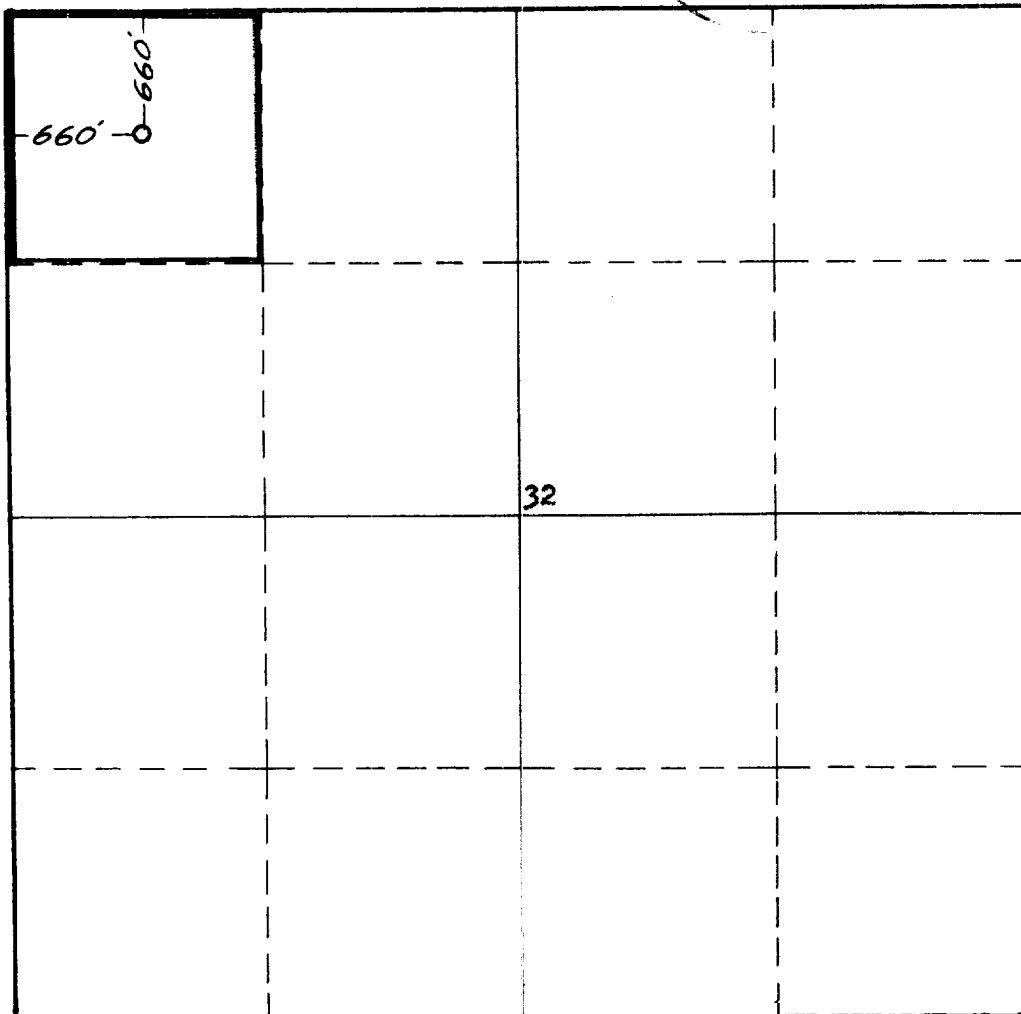

This is to certify that the information in Section A above is true and complete to the best of my knowledge and belief.

SKELLY OIL COMPANY

(Operator)

(Signed) P. E. Cosper

(Representative)

Box 426, Farmington, New Mexico

Address

This is to certify that the well location shown on the plat in Section B was plotted from field notes of actual surveys made by me or under my supervision and that the same is true and correct to the best of my knowledge and belief.

Date Surveyed 9 AUGUST 1958

James P. Lese
Registered Professional
Engineer and/or Land Surveyor.
JAMES P. LEESE

Certificate No. 1463

(See instructions for completing this form on the reverse side)

INSTRUCTIONS FOR COMPLETION:

1. Operator shall furnish and certify to the information called for in Section A.
2. Operator shall outline the dedicated acreage for both oil and gas wells on the plat in Section B.
3. A registered professional engineer or land surveyor registered in the State of New Mexico or approved by the Commission shall show on the plat the location of the well and certify this information in the space provided.
4. All distances shown on the plat must be from the outer boundaries of Section.
5. If additional space is needed for listing owners and their respective interests as required in question 3, Section A, please use space below

* "Owner" means the person who has the right to drill into and to produce from any pool and to appropriate the production either for himself or for himself and another. (65-3-29 (e) NMSA 1953 Comp.)