

(SUBMIT IN TRIPLICATE)
UNITED STATES
DEPARTMENT OF THE INTERIOR
GEOLOGICAL SURVEY

Budget Bureau No. 42-R368.4.
Approval expires 12-31-60.

Land Office Santa Fe
Lease No. 079149
Unit 57/4

SUNDRY NOTICES AND REPORTS ON WELLS

NOTICE OF INTENTION TO DRILL.....	XXXX	SUBSEQUENT REPORT OF WATER SHUT-OFF.....	
NOTICE OF INTENTION TO CHANGE PLANS.....		SUBSEQUENT REPORT OF SHOOTING OR ACIDIZING.....	
NOTICE OF INTENTION TO TEST WATER SHUT-OFF.....		SUBSEQUENT REPORT OF ALTERING CASING.....	
NOTICE OF INTENTION TO RE-DRILL OR REPAIR WELL.....		SUBSEQUENT REPORT OF RE-DRILLING OR REPAIR.....	
NOTICE OF INTENTION TO SHOOT OR ACIDIZE.....		SUBSEQUENT REPORT OF ABANDONMENT.....	
NOTICE OF INTENTION TO PULL OR ALTER CASING.....		SUPPLEMENTARY WELL HISTORY.....	
NOTICE OF INTENTION TO ABANDON WELL.....			

(INDICATE ABOVE BY CHECK MARK NATURE OF REPORT, NOTICE, OR OTHER DATA)

~~XXX~~ Gardner May 18, 1959, 19__
~~XXXXXXXXXXXXXXXXXXXX~~
Well No. 3 is located 330 ft. from S line and 1850 ft. from E line of sec. 27
Sec. 27 T. 25-N R. 3-E N.M.P.
(1/4 Sec. and Sec. No.) (Twp.) (Range) (Meridian)
Co. Blanco extension Chislerida New Mexico
(Field) (County or Subdivision) (State or Territory)

The elevation of the derrick floor above sea level is 7,337 ft.

DETAILS OF WORK

(State names of and expected depths to objective sands; show sizes, weights, and lengths of proposed casings; indicate mudding jobs, cementing points, and all other important proposed work)

Pictured slide test. Estimated total depth 3,750 feet. 140 acres dedicated to well.
Surface casing: 90' of 8-5/8" J-55 casing cemented to surface with 70 sacks of cement.
Production: Approximately 3,750 feet of 3-1/2" J-55 casing cements with 100 sacks.
If commercial production is indicated, the production section will be sand water fracture, and 1" tubing will be run.

I understand that this plan of work must receive approval in writing by the Geological Survey before operations may be commenced.

Company Frank J. Schultz
Address Box 200
Paria, New Mexico

By [Signature]
Title Inspector, Agent in Charge

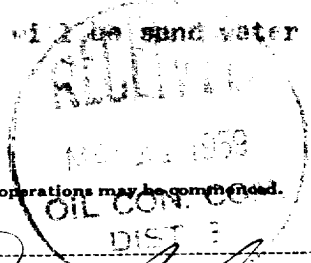

NEW MEXICO OIL CONSERVATION COMMISSION
WELL LOCATION AND ACREAGE DEDICATION PLAT

FORM C-128
Revised 5/1/57

SEE INSTRUCTIONS FOR COMPLETING THIS FORM ON THE REVERSE SIDE

SECTION A

Operator BEESON NEAL OIL DRILLING CO. FRANK A. SCHULTZ		Lease Gardner		Well No. 3
Unit Letter 0	Section 27	Township 25 NORTH	Range 3 WEST	County RIO ARriba
Actual Footage Location of Well: 830 feet from the SOUTH line and 1850 feet from the EAST line				
Ground Level Elev. 7329.0	Producing Formation Pictured Cliffs	Pool So. Blanco P. C. Ext.	Dedicated Acreage: 160 Acres	

1. Is the Operator the only owner in the dedicated acreage outlined on the plat below? YES ☒ NO ☐ . ("Owner" means the person who has the right to drill into and to produce from any pool and to appropriate the production either for himself or for himself and another. (65-3-29 (e) NMSA 1935 Comp.)
2. If the answer to question one is "no," have the interests of all the owners been consolidated by communitization agreement or otherwise? YES ☐ NO ☐ . If answer is "yes," Type of Consolidation _____
3. If the answer to question two is "no," list all the owners and their respective interests below:

Owner	Land Description

SECTION B

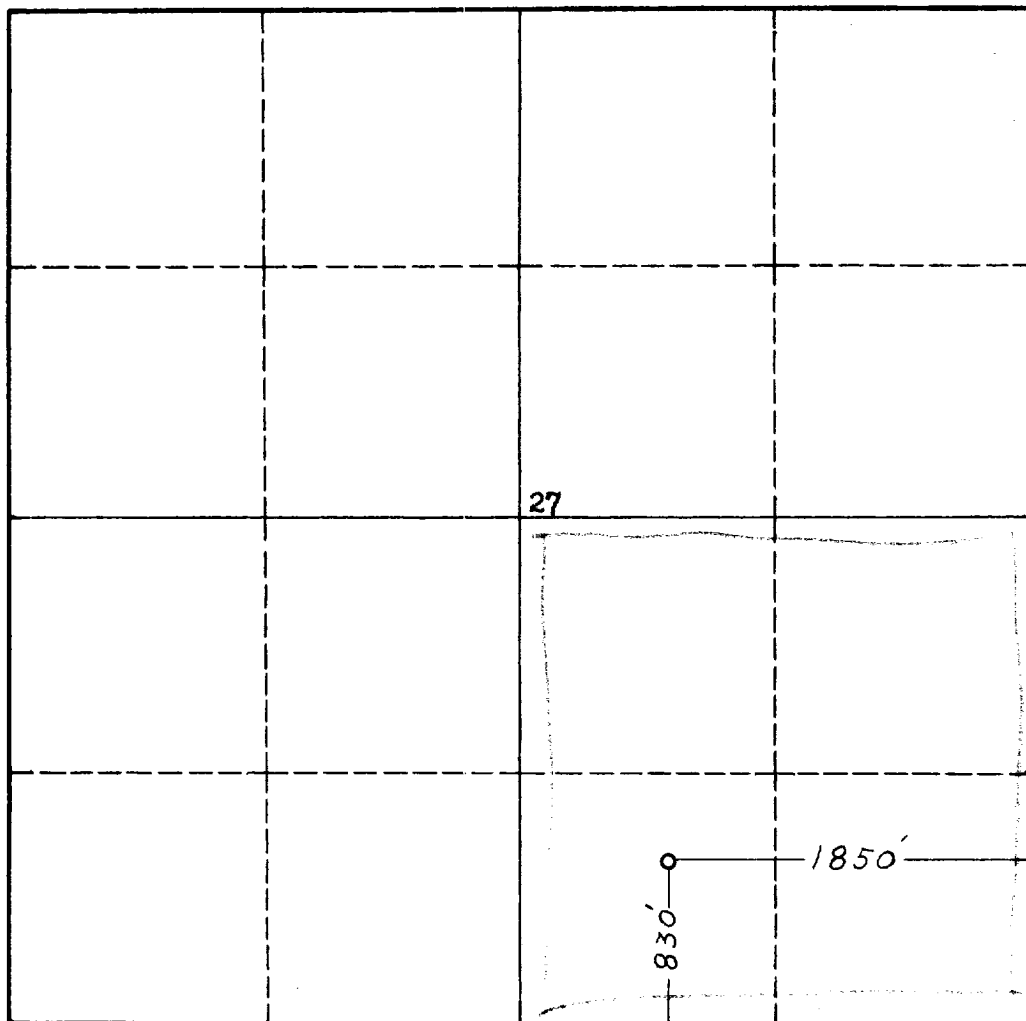

RECEIVED

MAY 21 1959

OIL CON. COM.
DISCERTIFICATION

I hereby certify that the information in SECTION A above is true and complete to the best of my knowledge and belief.

Name
C. Beeson Neal

Position
Agent in Farmington

Company
Frank A. Schultz

Date
May 19, 1959

I hereby certify that the well location shown on the plat in SECTION B was plotted from field notes of actual surveys made by me or under my supervision, and that the same is true and correct to the best of my knowledge and belief.

Date Surveyed
5 May 1959

Registered Professional Engineer and/or Land Surveyor
James P. Lesse

Certificate No.
1463

INSTRUCTIONS FOR COMPLETION OF FORM C-128

1. Operator shall furnish and certify to the information called for in Section A.
2. Operator shall outline the dedicated acreage for *both* oil and gas wells on the plat in Section B.
3. A registered professional engineer or land surveyor registered in the State of New Mexico or approved by the Commission shall show on the plat the location of the well and certify this information in the space provided.
4. All distances shown on the plat must be from the outer boundaries of the Section.
5. If additional space is needed for listing owners and their respective interests as required in question 3 of Section A, please use space below.