

(SUBMIT IN TRIPLICATE)

Indian Agency **Jicarilla Tribal**

UNITED STATES
DEPARTMENT OF THE INTERIOR
GEOLOGICAL SURVEY

Allottee _____

Lease No. **Cont. No. 67**

Jicarilla

SUNDRY NOTICES AND REPORTS ON WELLS

NOTICE OF INTENTION TO DRILL.....	<input checked="" type="checkbox"/>	SUBSEQUENT REPORT OF WATER SHUT-OFF.....	
NOTICE OF INTENTION TO CHANGE PLANS.....		SUBSEQUENT REPORT OF SHOOTING OR ACIDIZING.....	
NOTICE OF INTENTION TO TEST WATER SHUT-OFF.....		SUBSEQUENT REPORT OF ALTERING CASING.....	
NOTICE OF INTENTION TO REDRILL OR REPAIR WELL.....		SUBSEQUENT REPORT OF REDRILLING OR REPAIR.....	
NOTICE OF INTENTION TO SHOOT OR ACIDIZE.....		SUBSEQUENT REPORT OF ABANDONMENT.....	
NOTICE OF INTENTION TO PULL OR ALTER CASING.....		SUPPLEMENTARY WELL HISTORY.....	
NOTICE OF INTENTION TO ABANDON WELL.....			

RECEIVED

OCT 24 1958

(INDICATE ABOVE BY CHECK MARK NATURE OF REPORT, NOTICE, OR OTHER DATA)

U. S. GEOLOGICAL SURVEY
FARMINGTON, NEW MEXICO

October 24, 1958

Well No. **67-5** is located **1019** ft. from **S** line and **1547** ft. from **W** line of sec. **29**.

SW Sec. 29
(1/4 Sec. and Sec. No.)

25N
(Twp.)

5W
(Range)

N.M.P.M.
(Meridian)

Wildcat

Rio Arriba

New Mexico

(Field)

(County or Subdivision)

(State or Territory)

The elevation of the derrick floor above sea level is **6668** ft.

DETAILS OF WORK

(State names of and expected depths to objective sands; show sizes, weights, and lengths of proposed casings; indicate mudding jobs, cementing points, and all other important proposed work)

It is intended to drill a well with rotary tools thru the Dakota formation. Mud circulation will be used thru the Mesa Verde and set intermediate casing. Mud circulation will be used thru the Dakota and production liner will be set. Possible productive intervals will be perforated and fractured. Estimated T. D. 7260'.

Casing Program:

10 3/4" at 170' with 150 sacks cement circulated to the surface.

7 5/8" at 6406' with 250 sacks cement.

5 1/2" liner at 7260' with 300 sacks cement.

The SW/4 of Section 29 is dedicated to this well.

SW/4: Jicarilla Cont. No. 67

I understand that this plan of work must receive approval in writing by the Geological Survey before operations may be commenced.

Company **El Paso Natural Gas Company**

Address **Box 997**

Farmington, New Mexico

By **Original Signed D. W. Meehan**

Title **Petroleum Engineer**

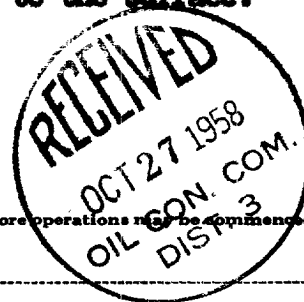



OCTOBER 22, 1958

EL PASO NATURAL GAS COMPANY

67-5 N 29

1019 SOUTH

RIO ARRIBA

DAKOTA

JICARILLA

1547

6658

JICARILLA CONTRACT NO. 67

25-N 5-W

WEST

160

WILDCAT

Designation of Operator.

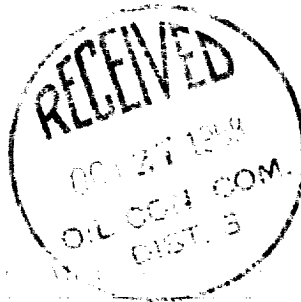

RECEIVED

OCT 24 1958

U.S. GEOLOGICAL SURVEY
ALBUQUERQUE, NEW MEXICO

El Paso Natural Gas Company

Original Signed D. W. Meehan

Box 997

Farmington, New Mexico

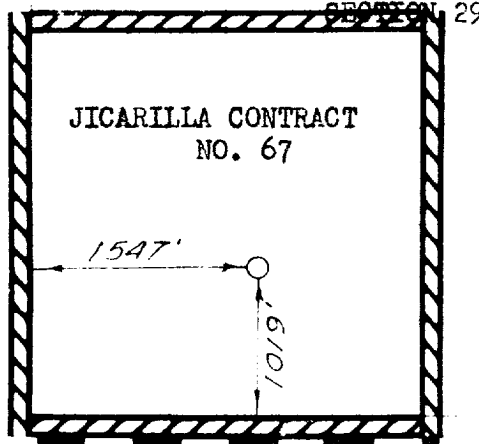

OCTOBER 20, 1958

David O. Kilwen

