

Form 9-331a
(Feb. 1951)

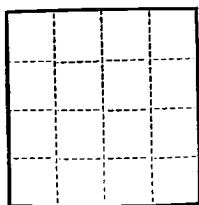

(SUBMIT IN TRIPLICATE)

UNITED STATES
DEPARTMENT OF THE INTERIOR
GEOLOGICAL SURVEY

Land Office New Mexico
Lease No. 01385
Unit Federal

SUNDRY NOTICES AND REPORTS ON WELLS

NOTICE OF INTENTION TO DRILL.....	<input checked="" type="checkbox"/>	SUBSEQUENT REPORT OF WATER SHUT-OFF.....	
NOTICE OF INTENTION TO CHANGE PLANS.....		SUBSEQUENT REPORT OF SHOOTING OR ACIDIZING.....	
NOTICE OF INTENTION TO TEST WATER SHUT-OFF.....		SUBSEQUENT REPORT OF ALTERING CASING.....	
NOTICE OF INTENTION TO RE-DRILL OR REPAIR WELL.....		SUBSEQUENT REPORT OF RE-DRILLING OR REPAIR.....	
NOTICE OF INTENTION TO SHOOT OR ACIDIZE.....		SUBSEQUENT REPORT OF ABANDONMENT.....	
NOTICE OF INTENTION TO PULL OR ALTER CASING.....		SUPPLEMENTARY WELL HISTORY.....	
NOTICE OF INTENTION TO ABANDON WELL.....			

(INDICATE ABOVE BY CHECK MARK NATURE OF REPORT, NOTICE, OR OTHER DATA)

March 11, 19 58

Well No. 25-D is located 1500 ft. from ~~XXX~~ S line and 990 ft. from ~~XXX~~ E line of sec. 25

SE Sec. 25 25N 2W N.M.P.M.
($\frac{1}{4}$ Sec. and Sec. No.) (Twp.) (Range) (Meridian)
Cavalin P. C. Rio Arriba New Mexico
(Field) (County or Subdivision) (State or Territory)

The elevation of the derrick floor above sea level is 7444 ft.

DETAILS OF WORK

(State names of and expected depths to objective sands; show sizes, weights, and lengths of proposed casings; indicate mudding jobs, cementing points, and all other important proposed work)

It is intended to drill a well thru the Pictured Cliff formation using rotary tools and to perforate and water fracture possible producing zones. Est. T. D. 3581'.

Casing Program:

8 5/8" at 120' with 125 sacks regular cement circulated to surface.
5 1/2" at 3581' with 75 sacks regular cement, 75 sacks ~~light~~

The SE/4 of Section 25 is dedicated to this well.

SE/4: 01385

I understand that this plan of work must receive approval in writing by the Geological Survey before operations may be commenced.

Company San Juan Gas Corporation

Address Box 997

Farmington, New Mexico

Attn: E. S. Oberly

By Lloyd Rhea
Title District Superintendent

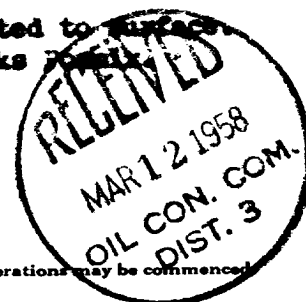

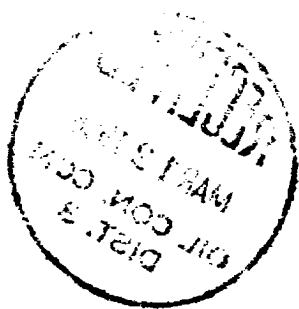

NEW MEXICO OIL CONSERVATION COMMISSION

Well Location and Acreage Designation Plat

Section A.

Date **MARCH 10, 1958**

Operator **SAN JUAN GAS CORPORATION** Lease **FEDERAL** NM **01385**
 Well No. **25-D** Unit Letter **I** Section **25** Township **25-N** Range **2-W** NMPM
 Located **1500** Feet From **SOUTH** Line **990** Feet From **EAST** Line
 County **RIO ARriba** G. L. Elevation **7434** Diluted Acreage **160** Acres
 Name of Producing Formation **PICTURED CLIFF** Pool **CAVALIN**

1. Is the Operator the only owner in the delineated acreage outlined on the plat below?
 Yes ☒ No ☐
2. If the answer to question one is "No", have the interests of all the owner been consolidated by communitization agreement or otherwise? Yes ☐ No ☐ If answer is "Yes", Type of Consolidation:

3. If the answer to question two is "No", list all the owners and their respective interests below:

Owner

Land Description



RECEIVED
MAR 11 1958
 U. S. GEOLOGICAL SURVEY
 FARMINGTON, NEW MEXICO

Section B.

Note: All distances must be from outer boundaries of section.

This is to certify that the information in Section A above is true and complete to the best of my knowledge and belief.

San Juan Gas Corporation

(Operator)

Lloyd Rhea

(Representative)

Box 997

(Address)

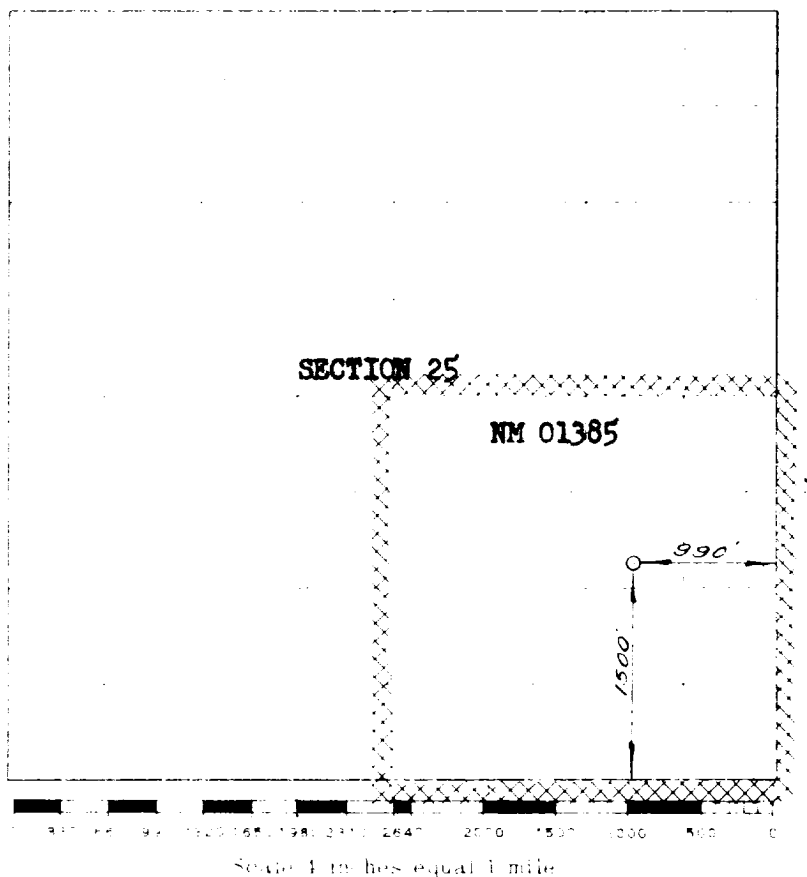
Farmington, New Mexico**Attn: E. S. Oberly**

This is to certify that the above plat was prepared from field notes of actual surveys made by me or under my supervision and that the same are true and correct to the best of my knowledge and belief.

(Seal)

Date Surveyed

MARCH 5, 1958

David O. Kilmer
 Registered Professional Engineer and/or Land Surveyor

Farmington, New Mexico