

(SUBMIT IN TRIPLICATE)

Indian Agency **Sicoutilla-Apache**

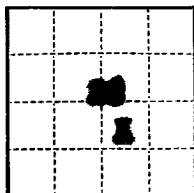

UNITED STATES
DEPARTMENT OF THE INTERIOR
GEOLOGICAL SURVEY

Allottee _____

Lease No. **66**

SUNDRY NOTICES AND REPORTS ON WELLS

NOTICE OF INTENTION TO DRILL	<input checked="" type="checkbox"/>	SUBSEQUENT REPORT OF WATER SHUT-OFF	
NOTICE OF INTENTION TO CHANGE PLANS		SUBSEQUENT REPORT OF SHOOTING OR ACIDIZING	
NOTICE OF INTENTION TO TEST WATER SHUT-OFF		SUBSEQUENT REPORT OF ALTERING CASING	
NOTICE OF INTENTION TO REDRILL OR REPAIR WELL		SUBSEQUENT REPORT OF REDRILLING OR REPAIR	
NOTICE OF INTENTION TO SHOOT OR ACIDIZE		SUBSEQUENT REPORT OF ABANDONMENT	
NOTICE OF INTENTION TO PULL OR ALTER CASING		SUPPLEMENTARY WELL HISTORY	
NOTICE OF INTENTION TO ABANDON WELL			

(INDICATE ABOVE BY CHECK MARK NATURE OF REPORT, NOTICE, OR OTHER DATA)

August 7, 19**59**

Sicoutilla Apache
Well No. **22-1** is located **1900** ft. from **NE** line and **1900** ft. from **E** line of sec. **20**

SE 1/4 Sec. 20 (1/4 Sec. and Sec. No.) **T22N, R4W** (Twp.) **107W** (Range) **107W** (Meridian)
(Undesignated) (Field) **San Arriba County** (County or Subdivision) **New Mexico** (State or Territory)

The elevation of the derrick floor above sea level is **6937** ft. (**Sec. 20, R4W 11'**)

DETAILS OF WORK

(State names of and expected depths to objective sands; show sizes, weights, and lengths of proposed casings; indicate mudding jobs, cementing points, and all other important proposed work)

We propose to drill this well with rotary tools to an estimated depth of **700'** to test the **Sabota** and **Gallup** formations. Approximately **200'** of **10 1/4"** surface casing will be run and cemented and if commercial production is found a string of **7"** production casing will be run and cemented with a stage collar at approximately **100'** and the well completed.



I understand that this plan of work must receive approval in writing by the Geological Survey before operations may be commenced.

Company **Sentimental Oil Co.**

Address **Box 1112**

Durango, Colorado

ORIGINAL SIGNED BY:
W. J. YOUNG

By _____

Title **District Engineer**

Handwritten notes:
Held 2-110-20, 2-128
Ref'd to spec 7-11-59
EAB:go
EAB(4), HMB(4), CNO, JMM



CERTIFICATE OF SURVEY

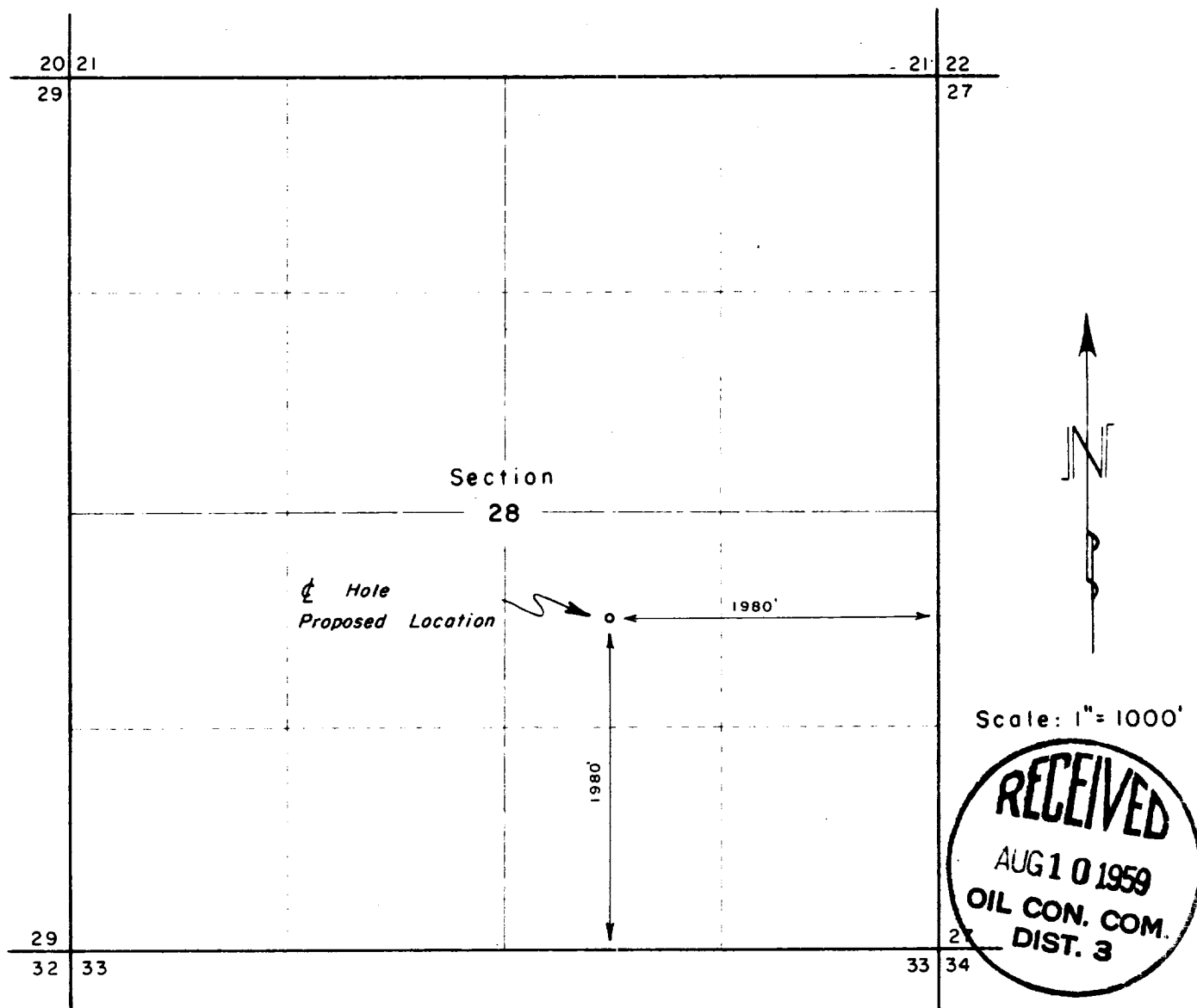

WELL LOCATION: The Continental Oil Co. — Jicarilla Apache No. 28-1

Located 1980 feet North of the South line and 1980 feet West of the East line of Section 28.
 Township 25 North Range 4 West New Mexico Principal Meridian
 Rio Arriba County, New Mexico
 Existing ground elevation determined at 6926 feet based on adjoining well locations.

I hereby certify the above plat represents a survey made under my supervision and is accurate to the best of my knowledge and belief.

Elmer M. Clark

ELMER M. CLARK
 Registered Land Surveyor
 State of New Mexico (No. 3189)

E.M. CLARK & ASSOCIATES
 Durango, Colorado

AUGUST 6 1959