

UNITED STATES
DEPARTMENT OF THE INTERIOR
BUREAU OF LAND MANAGEMENT

SUBMIT IN TRIPLICATE*
(Other instructions on
reverse side)

Form approved.
Budget Bureau No. 1004-0135
Expires August 31 1985

SUNDRY NOTICES AND REPORTS ON WELLS

(Do not use this form for proposals to drill or to deepen or plug back to a different reservoir.
Use "APPLICATION FOR PERMIT-" for such proposals.)

1. OIL WELL <input checked="" type="checkbox"/> GAS WELL <input checked="" type="checkbox"/> OTHER	5. LEASE DESIGNATION AND SERIAL NO. SF 079602
2. NAME OF OPERATOR TEXACO EXPLORATION AND PRODUCTION INC.	6. IF INDIAN, ALLOTTEE OR TRIBE NAME
3. ADDRESS OF OPERATOR P. O. Box 3109, Midland, Texas 79702	7. UNIT AGREEMENT NAME
4. LOCATION OF WELL (Report location clearly and in accordance with any State requirements.* See also space 17 below.) At surface 790' FNL & 2310' FEL, UNIT LETTER B, NW/NE 990' N, 330' E	8. FARM OR LEASE NAME L.L. McCONNELL 11177
14. PERMIT NO. API #30-039-25319	9. WELL NO. **14A (OLD #16)
15. ELEVATIONS (Show whether DF, RT, GR, etc.) GR-7460'	10. FIELD AND POOL, OR WILDCAT Blanco NW/4 Lin Dale OK
16. Check Appropriate Box To Indicate Nature of Notice, Report, or Other Data	11. SEC., T., R., OR BLK. AND SURVEY OR AREA SEC.29, T-25-N, R-3-W
	12. COUNTY OR PARISH RIO ARRIBA
	13. STATE NM

NOTICE OF INTENTION TO:

TEST WATER SHUT-OFF

FRACTURE TREAT

SHOOT OR ACIDIZE

REPAIR WELL

(Other) MOVE LOCATION, ADD FIELD, BOP

PULL OR ALTER CASING

MULTIPLE COMPLETE

ABANDON*

CHANGE PLANS

SUBSEQUENT REPORT OF:

WATER SHUT-OFF

FRACTURE TREATMENT

SHOOTING OR ACIDIZING

(Other)

REPAIRING WELL

ALTERING CASING

ABANDONMENT*

(NOTE: Report results of multiple completion on well
Completion or Recompletion Report and Log form.)

17. DESCRIBE PROPOSED OR COMPLETED OPERATIONS (Clearly state all pertinent details, and give pertinent dates, including estimated date of starting any proposed work. If well is directionally drilled, give subsurface locations and measured and true vertical depths for all markers and zones pertinent to this work.)*

*FIELDS: BLANCO, MESA VERDE AND WEST LINDRITH, GALLUP-DAKOTA.

UPON FURTHER REVIEW OF THIS AREA, IT HAS BEEN DETERMINED THAT AN ANNULAR BOP IS NOT NEEDED AS ORIGINALLY SUBMITTED WITH THE APD. TEXACO RESPECTFULLY REQUESTS THAT THE MINIMUM BOP REQUIREMENTS FOR THIS WELL BE MODIFIED TO ONLY A 3000 psig WORKING PRESSURE DOUBLE RAM PREVENTER AS PER THE ATTACHED SCHEMATIC.

TEXACO REQUESTS THAT THE BLANCO, MESA VERDE FIELD BE ADDED TO THE APD. IT IS PLANNED TO MAKE A SINGLE, DOWNHOLE COMMINGLED COMPLETION IN THE MESA VERDE (CHACRA, MENEFE, POINT LOOKOUT) AND THE GALLUP-DAKOTA ZONES. APPLICATION TO DOWNHOLE COMMINGLED IS BEING APPLIED FOR. ** THE WELL NUMBER IS BEING CHANGED FROM 16 TO 14A TO BE CONSISTANT WITH THE WELL NUMBERING FOR THE MESA VERDE FIELD.

THIS WELL WILL BE AN UNORTHODOX LOCATION FOR THE BLANCO, MESA VERDE FIELD. THE REQUEST FOR THE UNORTHODOX LOCATION BECAUSE OF TOPOGRAPHY IS BEING APPLIED FOR IN SANTA FE. THIS WELL WAS MOVED TO MINIMIZE THE CHANCES FOR OBJECTION FROM THE DIRECT OFFSET OPERATOR REGARDING THE UNORTHODOX LOCATION.

THE SURFACE AGREEMENT FOR THE NEW LOCATION IS ATTACHED.

RECEIVED
APR 11 1994

OIL CON. DIV.
DIST. 3

18. I hereby certify that the foregoing is true and correct

SIGNED C.P. Basham/cwh

TITLE DRILLING OPERATIONS MANAGER

DATE 02-25-94

(This space for Federal or State office use)

SHIRLEY MONDY

APPROVED BY

CONDITIONS OF APPROVAL, IF ANY:

TITLE Chief, Lands and Mineral Resources

DATE APR 7 1994

*See Instructions on Reverse Side

NMOCD

Submit to Appropriate
District Office
State Lease - 4 copies
Fee Lease - 3 copies

State of New Mexico
Energy, Minerals and Natural Resources Department

Form C-102
Revised 1-1-89

OIL CONSERVATION DIVISION

P.O. Box 2088

Santa Fe, New Mexico 87504-2088

DISTRICT I

P.O. Box 1980, Hobbs, NM 88240

DISTRICT II

P.O. Drawer DD, Artesia, NM 88210

DISTRICT III

1000 Rio Brazos Rd., Aztec, NM 87410

WELL LOCATION AND ACREAGE DEDICATION PLAT

All Distances must be from the outer boundaries of the section

Operator TEXACO			Lease L.L. McCONNELL			Well No. 14A			
Unit Letter B	Section 29	Township 25 NORTH	Range 3 WEST	County NMPM		RIO ARRIBA			
Actual Footage Location of Well: 790 feet from the NORTH line and 2310 feet from the EAST line									
Ground level Elev. 7460' UG			Producing Formation Mesa Verde Gallup-Dakota			Pool Blanco, Mesa Verde West Lindrith Gallup-Dakota			Dedicated Acreage: 320/160 Acres

1. Outline the acreage dedicated to the subject well by colored pencil or hatchure marks on the plat below.

2. If more than one lease is dedicated to the well, outline each and identify the ownership thereof (both as to working interest and royalty).

3. If more than one lease of different ownership is dedicated to the well, have the interest of all owners been consolidated by communitization, unitization, force-pooling, etc.?

☐ Yes ☐ No If answer is "yes" type of consolidation

If answer is "no" list the owners and tract descriptions which have actually been consolidated. (Use reverse side of this form if necessary.)

No allowable will be assigned to the well until all interests have been consolidated (by communitization, unitization, forced-pooling, or otherwise) or until a non-standard unit, eliminating such interest, has been approved by the Division.

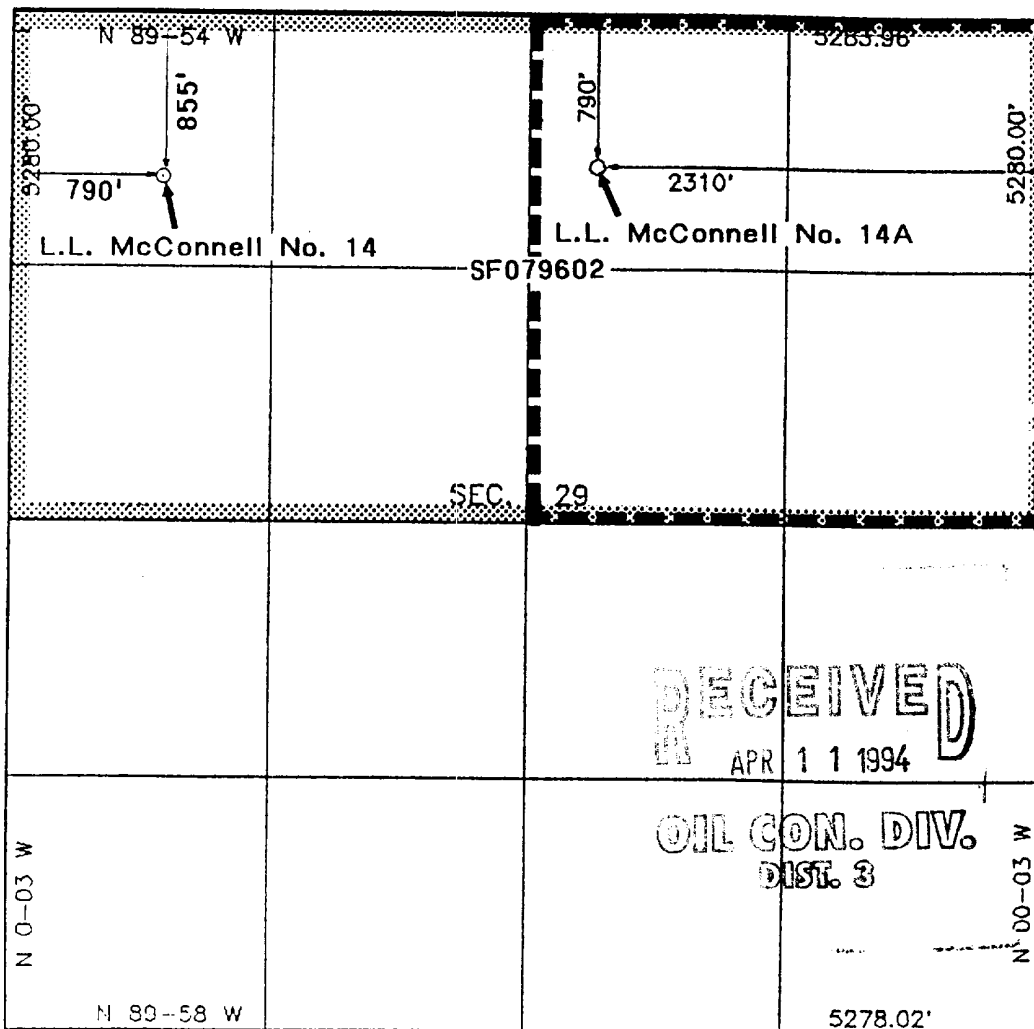

OPERATOR CERTIFICATION

I hereby certify that the information contained herein is true and complete to the best of my knowledge and belief.

Signature
Royce Marriott
Printed Name
Royce Marriott
Position
Division Surveyor
Company
TEXACO E&P Inc
Date
4-24-94

SURVEYOR CERTIFICATION

I hereby certify that the well location shown on this plat was plotted from field notes of actual surveys made by me or under my supervision, and that the same is true and correct to the best of my knowledge and belief.

Date Surveyed
12/09/93
Signature
Neale C. Edwards
Professional Surveyor
NEW MEXICO
6857
REGISTERED LAND SURVEYOR
Certificate No.
Neale C. Edwards

RECEIVED
APR 11 1994
OIL CON. DIV.
DIST. 3



STATE OF NEW MEXICO
ENERGY, MINERALS AND NATURAL RESOURCES DEPARTMENT
OIL CONSERVATION DIVISION



BRUCE KING
GOVERNOR

ANITA LOCKWOOD
CABINET SECRETARY

March 4, 1994

POST OFFICE BOX 2088
STATE LAND OFFICE BUILDING
SANTA FE, NEW MEXICO 87504
(505) 827-5800

Texaco Exploration and Production Company
P.O. Box 3109
Midland, TX 79702

Attention: C.P. Basham

Administrative Order NSL-3360

Dear Mr. Basham:

Reference is made to your application dated January 27, 1994 to drill the L.L. McConnell Well No. 14-A 790 feet from the North line and 2310 feet from the East line (Unit B) of Section 29, Township 25 North, Range 3 West, NMPM, Rio Arriba County, New Mexico, and complete in both the Blanco Mesaverde (Gas) and the West Lindrith Gallup-Dakota Oil Pools. Pursuant to the Special Rules and Regulations applicable to both pools, said location is considered to be non-standard.

By the authority granted me under the provisions of Rule 5 of the Special Rules and Regulations for the West Lindrith Gallup-Dakota Oil Pool, as promulgated by Division Order No. R-4314-A, as amended, and Rule 2(c) of the General Rules for the Prorated Gas Pools of New Mexico/Special Rules and Regulations for the Blanco Mesaverde Pool, as promulgated by Division Order No. R-8170, as amended, the above-described unorthodox oil/gas well location is hereby approved.

The NE/4 of said Section 29 shall be dedicated to the well to form a standard 160-acre oil spacing and proration unit for the West Lindrith Gallup-Dakota Oil Pool and the N/2 of said Section 29 shall be dedicated to the well to form a standard 320-acre gas spacing and proration unit for the Blanco Mesaverde Pool.

Sincerely,

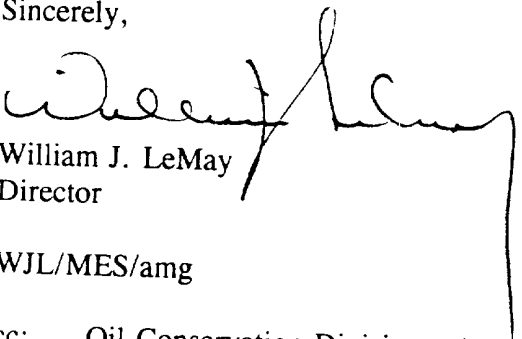
William J. LeMay
Director

WJL/MES/amg

cc: Oil Conservation Division - Aztec
US Bureau of Land Management - Albuquerque

