

NEW MEXICO OIL CONSERVATION COMMISSION
Santa Fe, New Mexico

Form G-101
 Revised (12/1/55)

NOTICE OF INTENTION TO DRILL

Notice must be given to the District Office of the Oil Conservation Commission and approval obtained before drilling or recompletion begins. If changes in the proposed plan are considered advisable, a copy of this notice showing such changes will be returned to the sender. Submit this notice in **QUINTUPPLICATE**. One copy will be returned following approval. See additional instructions in Rules and Regulations of the Commission. **If State Land submit 6 Copies Attach Form G- 128 in triplicate to first 3 copies of form G-101**

Farmington, New Mexico

(Place)

September 29, 1958

(Date)

OIL CONSERVATION COMMISSION
 SANTA FE, NEW MEXICO

Gentlemen:

You are hereby notified that it is our intention to commence the **Drilling** of a well to be known as
San Juan Gas Corporation

(Company or Operator)

Federal

(Lease)

Well No. 27-1-C, in

A

(Unit)

located 990 feet from the North line and 1040 feet from the

East

line of Section 27, T. 25N, R. 2W, NMPM.

(GIVE LOCATION FROM SECTION LINE) Gavalin P. C. Ext. Pool, Rio Arriba County

If State Land the Oil and Gas Lease is No.

If patented land the owner is Lewis & Ingram

Address.....

We propose to drill well with drilling equipment as follows: Rotary tools thru
Pictured Cliff formation.

The status of plugging bond is Statewide

Drilling Contractor Rio Arriba

We intend to complete this well in the Pictured Cliff
 formation at an approximate depth of 3474 feet.

CASING PROGRAM

We propose to use the following strings of Casing and to cement them as indicated:

Size of Hole	Size of Casing	Weight per Foot	New or Second Hand	Depth	Sacks Cement
13 3/4"	8 5/8"	24	New	120	125
8 3/4"	5 1/2"	15.5	New	3474	150

If changes in the above plans become advisable we will notify you immediately.

ADDITIONAL INFORMATION (If recompletion give full details of proposed plan of work.) **It is proposed to perforate and water fracture possible producing zones.**
The NE/4 of Section 27 is dedicated to this well.

NE/4: Lewis & Ingram

Approved.....
 Except as follows:

10-6, 1958

Sincerely yours,

San Juan Gas Corporation
 (Company or Operator)

By OR'G'NAL SIGNED E. S. OBERLY

Position Agent

Send Communications regarding well to

Name E. S. Oberly

Address Box 997, Farmington, New Mexico

OIL CONSERVATION COMMISSION

By Emory C. ...

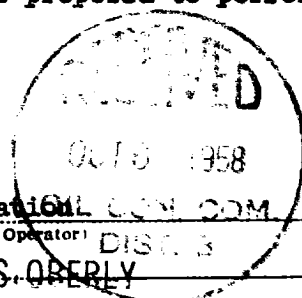

OIL CONSERVATION COMMISSION		
AZTEC DISTRICT OFFICE		
No. Copies Received		6
DISTRIBUTION		
	NO. FURNISHED	
Operator	2	
Santa Fe	1	
Proration Office		
State Land Office		
S. G. S.	2	
Transporter		
File	1	✓

NEW MEXICO OIL CONSERVATION COMMISSION

Well Location and Acreage Information

SEPTEMBER 29, 1958

Section A.

Operator **SAN JUAN GAS CORPORATION** Lease **FEDERAL** Fee **FEE**
 Well No. **27-1-C** Unit Letter **A** Section **27** Township **25-N** Range **2-W** NE/4
 Located **990** Foot From **NORTH** Line **1040** East From **EAST** Line
 County **RIO ARriba** G. L. Number **7236** Section A Acres **160** Acre
 Name of Producing Formation **PICTURED CLIFF** Loc **GAVALIN P.C. EXTENSION**

1. Is the Operator the only owner in the town and block of this tract of land?
 Yes ☒ No
2. If the answer to question one is "No", have the owners of the tract of land in question agreed to the agreement or otherwise? Yes ☐ No ☐ If the answer is "No", state the name of the owner.
3. If the answer to question two is "No", list all the names and addresses of the owners of the tract of land.

Section B.

This is to certify that the information in Section A above is true and complete to the best of my knowledge and belief.

San Juan Gas Corporation

(Operator)

ORIGINAL SIGNED E. S. OBERLY

(Representative)

Box 997

Address

Farmington, New Mexico

SECTION 27

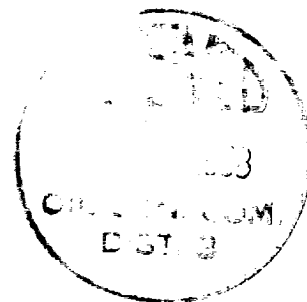
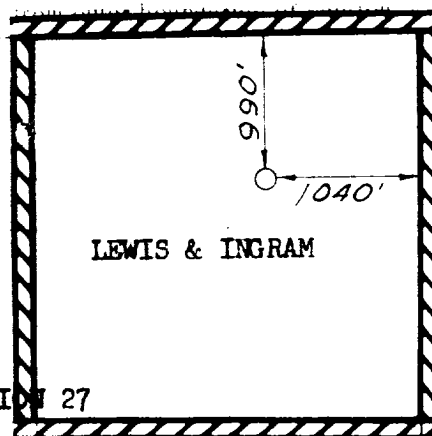

This is to certify that the information was obtained from the records of the New Mexico Oil Conservation Commission and is true and complete to the best of my knowledge and belief.

(Seal)

Farmington, New Mexico

SEPTEMBER 26, 1958

David O. Wilson

Regional Production Engineer and/or Land Surveyor