

(SUBMIT IN TRIPLICATE)

Indian Agency Jicarilla Tribal

#65 Tr. 122

UNITED STATES  
DEPARTMENT OF THE INTERIOR  
GEOLOGICAL SURVEY

Allottee \_\_\_\_\_

Lease No. Jicarilla

SUNDRY NOTICES AND REPORTS ON WELLS

NOTICE OF INTENTION TO DRILL	<input checked="" type="checkbox"/>	SUBSEQUENT REPORT OF WATER SHUT-OFF
NOTICE OF INTENTION TO CHANGE PLANS	<input type="checkbox"/>	SUBSEQUENT REPORT OF SHOOTING OR ACIDIZING
NOTICE OF INTENTION TO TEST WATER SHUT-OFF	<input type="checkbox"/>	SUBSEQUENT REPORT OF ALTERING CASING
NOTICE OF INTENTION TO REDRILL OR REPAIR WELL	<input type="checkbox"/>	SUBSEQUENT REPORT OF REDRILLING OR REPAIR
NOTICE OF INTENTION TO SHOOT OR ACIDIZE	<input type="checkbox"/>	SUBSEQUENT REPORT OF ABANDONMENT
NOTICE OF INTENTION TO PULL OR ALTER CASING	<input type="checkbox"/>	SUPPLEMENTARY WELL HISTORY
NOTICE OF INTENTION TO ABANDON WELL	<input type="checkbox"/>	

(INDICATE ABOVE BY CHECK MARK NATURE OF REPORT, NOTICE, OR OTHER DATA)

April 9, 19 57

Well No. 3-C is located 1090 ft. from S line and 804 ft. from E line of sec. 21

SE Section 21 25N 4W N.M.P.M.  
(1/4 Sec. and Sec. No.) (Twp.) (Range) (Meridian)

So. Blanco P.C. Ext. Rio Arriba New Mexico  
(Field) (County or Subdivision) (State or Territory)

The elevation of the derrick floor above sea level is 6981 ft.

DETAILS OF WORK

(State names of and expected depths to objective sands; show sizes, weights, and lengths of proposed casings; indicate mudding jobs, cementing points, and all other important proposed work)

It is intended to drill a well thru the Pictured Cliffs formation using rotary tools and to perforate and water fracture possible producing sands. Estimated Total Depth 3400'.

Casing Program:

9-5/8" at 120' with 125 sacks regular cement circulated to surface.

5-1/2" at 3400' with 75 sacks regular cement and 75 sacks Pozmix.

The SE/4 of Section 21 is dedicated to this well.

SE/4 Jicarilla Tribal #65 Tr. 122.

I understand that this plan of work must receive approval in writing by the Geological Survey before operations may be commenced.

Company El Paso Natural Gas Company

Address Box 997

Farmington, New Mexico

By W. F. Conant

Title Petroleum Engineer



*Handwritten text, possibly a signature or date.*

## WELL LOCATION AND/OR GAS PRODUCTION PLAT

APRIL 3, 1957

EL PASO NATURAL GAS COMPANY

JICARILLA

65-TR-122

3-0

21

25-N

4-W

1090

SOUTH

804

EAST

RIO ARriba

6970<sup>80</sup>

PICTURED CLIFF

SO BLANCO

P.C. EXT.

160 ACRES  
(1882 PLAT)

Note: All distances are from corner to corner of section.

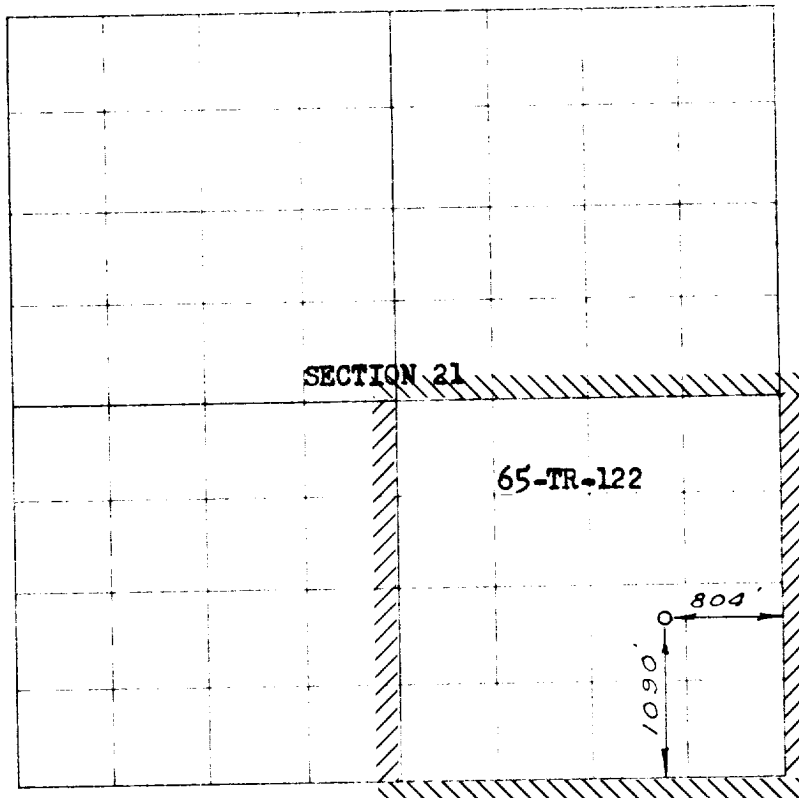

Scale: 1 inch = 1 mile



I hereby certify that the above plat was prepared from a comparison of actual surveys made by me or under my supervision and that the same are true and correct to the best of my knowledge and belief.

Date Surveyed DECEMBER 28, 1956

*C. O. Stacker*  
 Registered Professional Engineer and/or Land Surveyor

1. Is this well a Dry Comp?

Yes ☐ No ☒

2. If the answer to Question 1

is yes, are there any other fully completed wells within the dedicated acreage?

Yes ☐ No ☐Name W. F. AsuntPosition Petroleum EngineerRepresentative El Paso Natural GasAddress Box 997, Farmington, N.M.

Seal