

(SUBMIT IN TRIPLICATE)

Indian Agency         

UNITED STATES  
DEPARTMENT OF THE INTERIOR  
GEOLOGICAL SURVEY

Allottee         

Lease No.         

Contract # 105

SUNDRY NOTICES AND REPORTS ON WELLS

NOTICE OF INTENTION TO DRILL	<input checked="" type="checkbox"/>	SUBSEQUENT REPORT OF WATER SHUT-OFF	
NOTICE OF INTENTION TO CHANGE PLANS		SUBSEQUENT REPORT OF SHOOTING OR ACIDIZING	
NOTICE OF INTENTION TO TEST WATER SHUT-OFF		SUBSEQUENT REPORT OF ALTERING CASING	
NOTICE OF INTENTION TO REDRILL OR REPAIR WELL		SUBSEQUENT REPORT OF REDRILLING OR REPAIR	
NOTICE OF INTENTION TO SHOOT OR ACIDIZE		SUBSEQUENT REPORT OF ABANDONMENT	
NOTICE OF INTENTION TO PULL OR ALTER CASING		SUPPLEMENTARY WELL HISTORY	
NOTICE OF INTENTION TO ABANDON WELL			

(INDICATE ABOVE BY CHECK MARK NATURE OF REPORT, NOTICE, OR OTHER DATA)

August 17, 1952

Arizona Maricopa

Well No. 124 is located 1100 ft. from S line and 1100 ft. from E line of sec. 36

124  
(1/4 Sec. and Sec. No.)

T-22N  
(Twp.)

R-10W  
(Range)

N.M.P.M.  
(Meridian)

South Maricopa Pictorial  
(Field)

Maricopa  
(County or Subdivision)

New Mexico  
(State or Territory)

The elevation of the derrick floor above sea level is 4995 ft.

DETAILS OF WORK

(State names of and expected depths to objective sands; show sizes, weights, and lengths of proposed casings; indicate mudding jobs, cementing points, and all other important proposed work)

Propose to: Drill with rotary to approximate depth of 150'  
Set 3 1/2" surface casing - cement to surface.  
Drill to approximate depth of 300' or through Pictorial Grits formation  
Run 2 1/2" casing to total depth and cement with 50 sacks cement.  
Sand-water test  
Run 2" tubing.



I understand that this plan of work must receive approval in writing by the Geological Survey before operations may be commenced.

Company Artes Oil and Gas Company

Address Box # 704,

Farmington, New Mexico

By ORIGINAL SIGNED BY JOE C. SALMON

Title Joe C. Salmon  
District Superintendent

NEW MEXICO OIL CONSERVATION COMMISSION

Well Location and Acreage Dedication Plat

Section A.

Date August 12, 1959

Operator Antec Oil & Gas Company Lease Arizona Jicarilla  
Well No. 1-A Unit Letter I Section 23 Township 25N Range 4W NMPN  
Located 1450 Feet From South Line, 1190 Feet From East Line  
County El Arriba G. L. Elevation 6996 Dedicated Acreage 160 Acres  
Name of Producing Formation Pictured Cliffs Pool South Blanco Pictured Cliffs

1. Is the Operator the only owner\* in the dedicated acreage outlined on the plat below?  
Yes XXXX No       .
2. If the answer to question one is "no," have the interests of all the owners been consolidated by communitization agreement or otherwise? Yes        No       . If answer is "yes,"  
Type of Consolidation
3. If the answer to question two is "no," list all the owners and their respective interests below:

Owner

Land Description

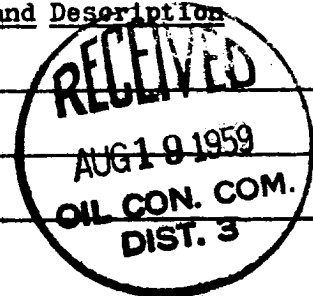

Section. B

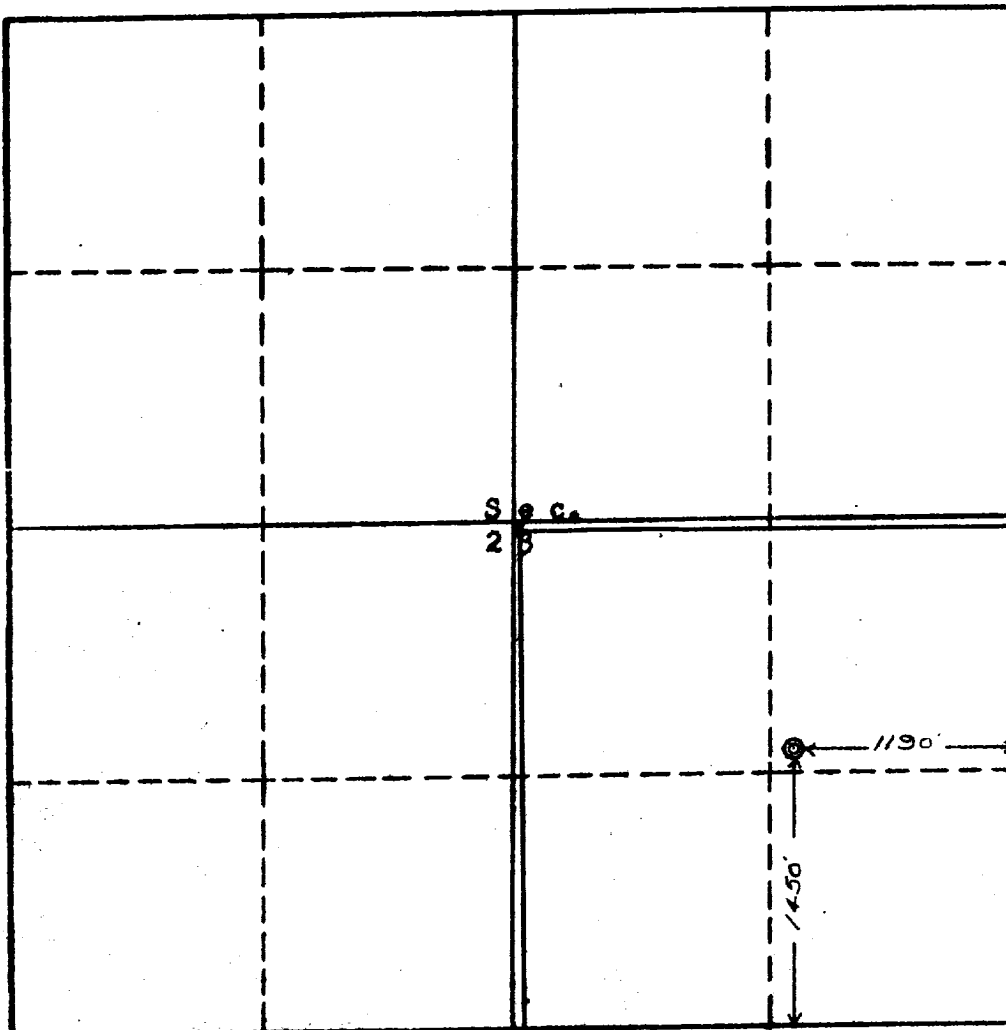

This is to certify that the information in Section A above is true and complete to the best of my knowledge and belief.

Antec Oil & Gas Company  
(Operator)

ORIGINAL SIGNED BY JOE C. SALMON  
(Representative)

Box 786, Farmington, N. M.  
Address

This is to certify that the well location shown on the plat is correct as determined from field notes and actual survey made under my supervision and to the best of my knowledge and belief.

Date Surveyed Aug. 7, 1959  
Ernest V. Echoshawk  
Registered Land Surveyor.

Certificate No. 1545