

018JSZZ

**JICARILLA APACHE TRIBE  
ENVIRONMENTAL PROTECTION OFFICE  
P.O. BOX 507  
DULCE, NEW MEXICO 87528**

SUBMIT 1 COPY TO  
NATURAL RESOURCE DEPT  
AND OIL & GAS ADMINISTRATION

**PIT REMEDIATION AND CLOSURE REPORT**

**Operator:** AMOCO PRODUCTION COMPANY **Telephone:** (505) 326-9200

**Address:** 200 Amoco Court, Farmington, NM 87401

**Facility or Well Name:** JICARILLA CONTRACT 148 - 3

**Location:** Unit or Qtr/Qtr Sec F Sec 24 T25N R5W County RIO ARriba

**Pit Type:** Separator ☐ Dehydrator ☐ Other BLOW

**Land Type:** RANGE

**Pit Location:** (Attach diagram) Pit dimensions: length 25', width 18', depth 17'

Reference: wellhead X, other \_\_\_\_\_

Footage from reference: 155'

Direction from reference: 76 Degrees X East of North X  
\_\_\_\_\_ West of South \_\_\_\_\_

**Depth To Groundwater:**

(Vertical distance from  
contaminants to seasonal  
high water elevation of  
groundwater)

**RECEIVED**  
AUG 24 1999

Less than 50 feet	(20 points)	
50 feet to 99 feet	(10 points)	<u>0</u>
Greater than 100 feet	(0 points)	

**Distance to an Ephemeral Stream**

(Downgradient dry wash greater than  
ten feet in width)

**CON. DIV.  
DIST. 3**

Less than 100 feet	(10 points)	
Greater than 100 feet	(0 points)	<u>0</u>

**Distance to Nearest Lake, Playa, or Watering Pond**

(Downgradient lakes, playas and  
livestock or wildlife watering ponds)

Less than 100 feet	(10 points)	
Greater than 100 feet	(0 points)	<u>0</u>

**Wellhead Protection Area:**

(Less than 200 feet from a private  
domestic water source, or: less than  
1000 feet from all other water sources)

Yes	(20 points)	
No	(0 points)	<u>0</u>

**Distance To Surface Water:**

(Horizontal distance to perennial  
lakes, ponds, rivers, streams, creeks,  
irrigation canals and ditches)

Less than 100 feet	(20 points)	
100 feet to 1000 feet	(10 points)	<u>0</u>
Greater than 1000 feet	(0 points)	

**RANKING SCORE (TOTAL POINTS):** 0



BJ 522

BLOW PIT

Date Remediation Started: \_\_\_\_\_ Date Completed: 1/27/98

Remediation Method: Excavation ☒ Approx. cubic yards 200  
Check all appropriate sections) Landfarmed ☒ Insitu Bioremediation \_\_\_\_\_  
Other \_\_\_\_\_

Remediation Location: Onsite ☒ Offsite \_\_\_\_\_  
(i.e. landfarmed onsite, name and location of offsite facility)

General Description of Remedial Action: Excavation

Groundwater Encountered: No ☒ Yes \_\_\_\_\_ Depth \_\_\_\_\_

Final Pit: Sample location see Attached Documents

Closure Sampling: (if multiple samples, attach sample results and diagram of sample locations and depths)

Sample depth 19' (PIT BOTTOM)

Sample date 1/26/98 Sample time 1215

Sample Results

Soil: Benzene	(ppm)	_____	Water: Benzene	(ppb)	_____
Total BTEX	(ppm)	_____	Toluene	(ppb)	_____
Field Headspace	(ppm)	<u>0.0</u>	Ethylbenzene	(ppb)	_____
TPH	(ppm)	<u>20.4</u>	Total Xylenes	(ppb)	_____

Groundwater Sample: Yes \_\_\_\_\_ No ☒ (If yes, attach sample results)

I HEREBY CERTIFY THAT THE INFORMATION ABOVE IS TRUE AND COMPLETE TO THE BEST OF MY KNOWLEDGE AND BELIEF

DATE 1/27/98 PRINTED NAME Buddy D. Shaw  
SIGNATURE Buddy D. Shaw AND TITLE Environmental Coordinator

AFTER REVIEW OF THE PIT CLOSURE INFORMATION, PIT CLOSURE IS APPROVED IN ACCORDANCE TO THE JICARILLA APACHE TRIBE PIT CLOSURE ORDINANCE.

APPROVED: YES ☒ NO \_\_\_\_\_ (REASON) \_\_\_\_\_

SIGNED: Kate C. Mamm DATE: 2-6-98



CLIENT: <u>AMOCO</u>	BLAGG ENGINEERING, INC. P.O. BOX 87, BLOOMFIELD, NM 87413 (505) 632-1199	LOCATION NO: <u>BJS27</u> C.O.C. NO: <u>5713</u>
----------------------	--	---

FIELD REPORT: CLOSURE VERIFICATION	PAGE No: <u>1</u> of <u>1</u>
------------------------------------	-------------------------------

LOCATION: NAME: <u>JICA. CONTR. 148 WELL # 3</u> PIT: <u>BLOW</u>	DATE STARTED: <u>1/26/98</u> DATE FINISHED: _____
QUAD/UNIT: <u>F SEC 24 TWP 25N RNG 5W PM: UM CNTY: RA STNM</u>	ENVIRONMENTAL SPECIALIST: <u>NV</u>
QTR/FOOTAGE: <u>SE 1/4 NW 1/4</u> CONTRACTOR: <u>P &amp; S</u>	

EXCAVATION APPROX. <u>25</u> FT. x <u>18</u> FT. x <u>17</u> FT. DEEP. CUBIC YARDAGE: <u>200</u>
DISPOSAL FACILITY: <u>ON-SITE</u> REMEDIATION METHOD: <u>LANDFARMED</u>
LAND USE: <u>RANGE</u> LEASE: <u>FED. # 148</u> FORMATION: _____

FIELD NOTES & REMARKS:	PIT LOCATED APPROXIMATELY <u>155</u> FT. <u>N76E</u> FROM WELLHEAD. DEPTH TO GROUNDWATER: <u>2100'</u> NEAREST WATER SOURCE: <u>21000'</u> NEAREST SURFACE WATER: <u>21000'</u> NMOCED RANKING SCORE: <u>0</u> NMOCED TPH CLOSURE STD: <u>5000</u> PPM
SOIL AND EXCAVATION DESCRIPTION:	<div style="border: 1px solid black; padding: 5px;">           CHECK ONE:  <input checked="" type="checkbox"/> PIT ABANDONED  <input type="checkbox"/> STEEL TANK INSTALLED  <input type="checkbox"/> FIBERGLASS TANK INSTALLED         </div>

MOSTLY MOD. TO DK. YELL. BROWN SAND, NON COHESIVE SLIGHTLY MOIST, FIRM, NO APPARENT STAINING OR HC ODOR OBSERVED W/IN EXCAVATION, NO APPARENT HC ODOR OBSERVED IN ANY OF THE OVM SAMPLES.

CLOSED

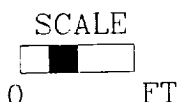

FIELD 418.1 CALCULATIONS

TIME	SAMPLE I.D.	LAB No:	WEIGHT (g)	mL. FREON	DILUTION	READING	CA.C. ppm

PIT PERIMETER AN

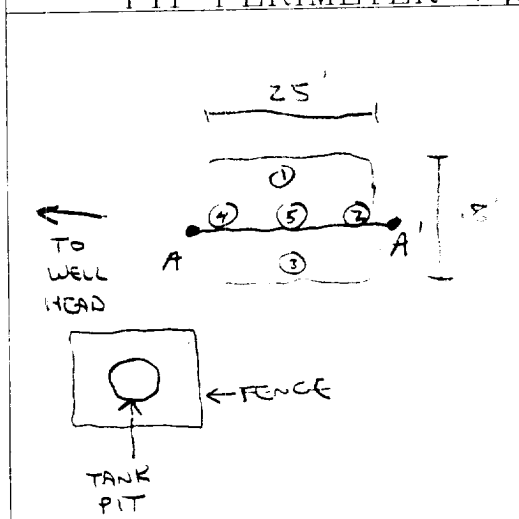

OVM RESULTS

SAMPLE ID	FIELD HEADSPACE PID (ppm)
1 e 11'	0.0
2 e 11'	0.0
3 e 10'	0.0
4 e 10'	0.0
5 e 19'	0.0

LAB SAMPLES

SAMPLE ID	ANALYSIS	TIME
(5) e 19'	TPH 418.1	1215
<u>PASSED</u>		

PIT PROFILE

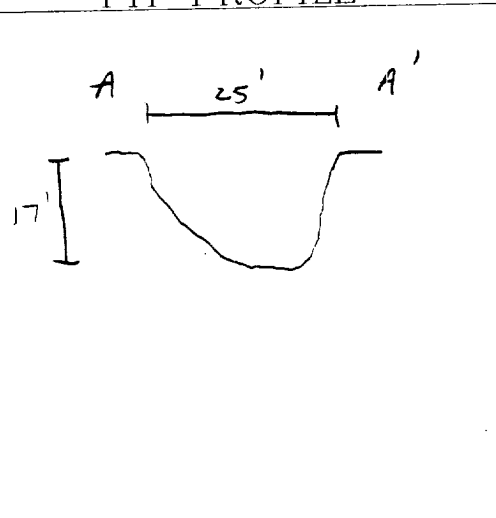

TRAVEL NOTES:	CALLOUT: _____	ONSITE: <u>1/13/98</u> , <u>1/26/98</u>
---------------	----------------	---



# ENVIROTECH LABS

PRACTICAL SOLUTIONS FOR A BETTER TOMORROW

## EPA METHOD 418.1 TOTAL PETROLEUM HYDROCARBONS

Client:	Blagg / AMOCO	Project #:	04034-10
Sample ID:	5 @ 19'	Date Reported:	01-27-98
Laboratory Number:	C848	Date Sampled:	01-26-98
Chain of Custody No:	5713	Date Received:	01-27-98
Sample Matrix:	Soil	Date Extracted:	01-27-98
Preservative:	Cool	Date Analyzed:	01-27-98
Condition:	Cool and Intact	Analysis Needed:	TPH-418.1

Parameter	Concentration (mg/kg)	Det. Limit (mg/kg)
Total Petroleum Hydrocarbons	20.4	5.0

ND = Parameter not detected at the stated detection limit.

References: Method 418.1, Petroleum Hydrocarbons, Total Recoverable, Chemical Analysis of Water and Waste, USEPA Storet No. 4551, 1978.

Comments: Jicarilla Contract 148-3 Blow Pit.

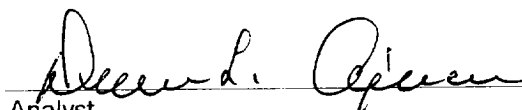
  
Analyst

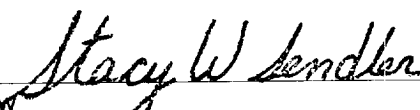
  
Review





## CHAIN OF CUSTODY RECORD

Client/Project Name <b>BLRG / Anoco</b>			Project Location <b>Blau PT</b>			ANALYSIS/PARAMETERS										
Sampler: (Signature) <i>W. L. L.</i>			Chain of Custody Tape No. <b>04034-10</b>													
Sample No./ Identification <b>5019</b>	Sample Date <b>1/26/98</b>	Sample Time <b>1215</b>	Lab Number <b>C848</b>	Sample Matrix <b>SOIL</b>	No. of Containers <b>1</b>	Remarks <b>TPH (418.1)</b>										
<div style="text-align: center;"> <b>SAMPLE RECEIVED</b>  <b>COOL &amp; INSURET</b>  <b>DUN</b> </div>						<b>PRESERV. - COOL</b>										
Relinquished by: (Signature) <i>W. L. L.</i>			Date <b>1/27/98</b>	Time <b>0705</b>	Received by: (Signature) <i>Robert L. Ogden</i>	Date <b>1/27/98</b> Time <b>0705</b>										
Relinquished by: (Signature)					Received by: (Signature)											
Relinquished by: (Signature)					Received by: (Signature)											

ENVIROTECH INC.

5796 U.S. Highway 64-3014

Farmington, New Mexico 87401

(505) 632-0615



85522

SUBMIT 1 COPY TO  
NATURAL RESOURCE DEPT  
AND OIL & GAS ADMINISTRATION

**JICARILLA APACHE TRIBE  
ENVIRONMENTAL PROTECTION OFFICE  
P.O. BOX 507  
DULCE, NEW MEXICO 87528**

**ON-SITE SOIL REMEDIATION REPORT**

Operator: AMOCO PRODUCTION COMPANY Telephone: (505) 326-9200  
Address: 200 Amoco Court, Farmington, NM 87401  
Facility or Well Name: JICARILLA CONTRACT 148 - 3  
Location: Unit or Qtr/Qtr Sec F Sec 24 T 25N R 5W County RIO ARriba  
Land Type: RANGE

Date Remediation Started: 1-26-98 Date Completed: 1/12/99  
Remediation Method: Landfarmed ☒ Approx. cubic yards 200  
Composted ☐  
Other ☐

Depth To Groundwater: (pts.) 0  
Distance to an Ephemeral Stream (pts.) 0  
Distance to Nearest Lake, Playa, or Watering Pond (pts.) 0  
Wellhead Protection Area: (pts.) 0  
Distance To Surface Water: (pts.) 0

RANKING SCORE (TOTAL POINTS): 0

**Final Closure Sampling:**  
Sampling Date: 1-5-99 Time: 1300  
Sample Results:  
Field Headspace (ppm) 0.0  
TPH (ppm) 2.7 Method (8015)  
Other ☐

I HEREBY CERTIFY THAT THE INFORMATION ABOVE IS TRUE AND COMPLETE TO THE BEST OF MY KNOWLEDGE AND BELIEF

DATE 1/12/99 PRINTED NAME Buddy D. Shaw  
SIGNATURE Buddy D. Shaw AND TITLE Environmental Coordinator

AFTER REVIEW OF THE SOIL REMEDIATION INFORMATION, ON-SITE REMEDIATION IS APPROVED IN ACCORDANCE TO THE JICARILLA APACHE TRIBE PIT CLOSURE ORDINANCE.

APPROVED: YES ☒ NO ☐ (REASON) \_\_\_\_\_

SIGNED: K. C. M. A. DATE: 3-31-99



CLIENT: <u>AMOCO</u>	<b>BLAGG ENGINEERING, INC.</b> P.O. BOX 87, BLOOMFIELD, NM 87413 (505) 632-1199	LOCATION NO: <u>B3622</u>  C.O.C. NO: <u>6530</u>
----------------------	---	---

## FIELD REPORT: LANDFARM/COMPOST PILE CLOSURE VERIFICATION

LOCATION: NAME: <u>SICARILLA CONTRACT 148</u> WELL #: <u>3</u> PITS: <u>BLOW</u>	DATE STARTED: <u>1.5.99</u> DATE FINISHED: <u>11.2.99</u>
QUAD/UNIT: <u>F</u> SEC: <u>24</u> TWP: <u>25N</u> RNG: <u>5W</u> PM: <u>NM</u> CNTY: <u>RA</u> ST: <u>NM</u>	ENVIRONMENTAL SPECIALIST: <u>REP</u>
QTR/FOOTAGE: <u>SE/4 NW/4</u> CONTRACTOR: <u>P+S</u>	

### SOIL REMEDIATION:

REMEDIALATION SYSTEM: <u>LANDFARM</u>	APPROX. CUBIC YARDAGE: <u>200</u>
LAND USE: <u>RANGE</u>	LIFT DEPTH (ft): <u>1.1.5'</u>

### FIELD NOTES & REMARKS:

DEPTH TO GROUNDWATER: >100' NEAREST WATER SOURCE: >1000' NEAREST SURFACE WATER: >1000'

NMOCB RANKING SCORE: 0 NMOCB TPH CLOSURE STD: 5000 PPM

DK. YELLOW ORANGE TO BROWN. NON COHESIVE, SLIGHTLY MOIST, LOOSE.  
 NO APPARENT STAINING, NO HC ODOR DETECTED. SAMPLING DEPTHS RANGE  
 FROM 6" TO 18" TOOK A 5 PT COMPOSITE SAMPLE FOR LAB ANALYSIS

CLOSED

### FIELD 418.1 CALCULATIONS

SAMP. TIME	SAMPLE I.D.	LAB No:	WEIGHT (g)	mL. FREON	DILUTION	READING	CALC. ppm

### SKETCH/SAMPLE LOCATIONS

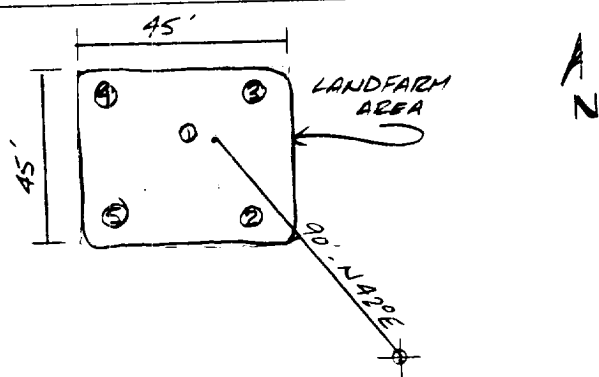

### OVM RESULTS

### LAB SAMPLES

SAMPLE ID	FIELD HEADSPACE PID (ppm)	SAMPLE ID	ANALYSIS	TIME	RESULTS
LF-1	0.0	LF-1	TPH (B015)	1300	2.7

### SCALE

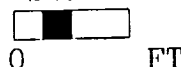

### TRAVEL NOTES:

CALLOUT: N/A

ONSITE: 1.5.99



# ENVIROTECH LABS

PRACTICAL SOLUTIONS FOR A BETTER TOMORROW

## EPA METHOD 8015 Modified Nonhalogenated Volatile Organics Total Petroleum Hydrocarbons

Client: Blagg / AMOCO  
Sample ID: LF - 1  
Laboratory Number: E470  
Chain of Custody No: 6530  
Sample Matrix: Soil  
Preservative: Cool  
Condition: Cool and Intact

Project #: 04034-10  
Date Reported: 01-08-99  
Date Sampled: 01-05-99  
Date Received: 01-07-99  
Date Extracted: 01-08-99  
Date Analyzed: 01-08-99  
Analysis Requested: 8015 TPH

Parameter	Concentration (mg/Kg)	Det. Limit (mg/Kg)
Gasoline Range (C5 - C10)	2.5	0.2
Diesel Range (C10 - C28)	0.2	0.1
Total Petroleum Hydrocarbons	2.7	0.2

ND - Parameter not detected at the stated detection limit.

References: Method 8015B, Nonhalogenated Volatile Organics, Test Methods for Evaluating Solid Waste, SW-846, USEPA, December 1996.

Comments: Jicarilla Contract 148 - 3 Landfarm. 5 Pt. Composite.

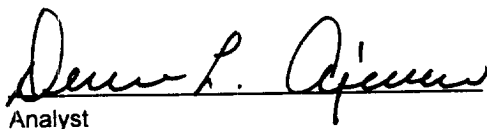
  
Analyst

  
Review





## 6530

[illegible]

