

NEW MEXICO OIL CONSERVATION COMMISSION

Well Location and Acreage Dedication Plat

Section A.

Date **NOVEMBER 16, 1959**

Operator **EL PASO NATURAL GAS COMPANY** Lease **FEE** **FEE**
 Well No. **23-1-C** Unit Letter **H** Section **23** Township **25-N** Range **2-W** NMPM
 Located **1550** Feet From **NORTH** Line, **1090** Foot From **EAST** Line
 County **RIO ARriba** G. L. Elevation **7420** Dedicated Acreage **160** Acres
 Name of Producing Formation **PICTURED CLIFF** Pool **CAVALIN PICTURED CLIFF**

1. Is the Operator the only owner in the dedicated acreage outlined on the plat below?
 Yes No **X**
2. If the answer to question one is "no", have the interests of all the owners been satisfactorily coordinated by agreement or otherwise? Yes **X** No . . . If answer is "yes", Type of Consolidation.

Operating Agreement

3. If the answer to question two is "no", list all the owners and their respective interests below:

Owner

Land Description

Section B.

This is to certify that the information in Section A above is true and complete to the best of my knowledge and belief.

El Paso Natural Gas Company(Operator)
Original Signed **F. H. WOOD**

(Representative)

Box 997

(Address)

Farmington, New Mexico

Note: All distances must be from outer boundaries of section.

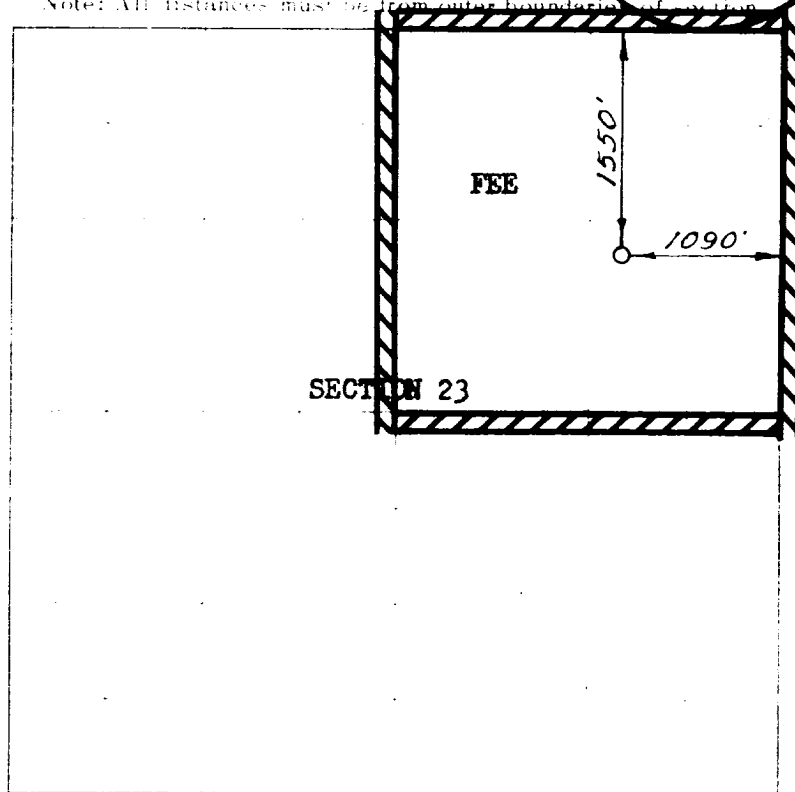

0 330 660 990 1320 1650 1980 2310 2640 2970 3300 3630 3960 4290 4620 4950

Scale 4 inches equal 1 mile

This is to certify that the above plat was prepared from field notes of actual surveys made by me or under my supervision and that the same are true and correct to the best of my knowledge and belief.

(Seal)

Date Surveyed

NOVEMBER 3, 1959

Farmington, New Mexico

David O. Filmer
 Registered Professional Engineer and/or Land Surveyor

OIL CONSERVATION COMMISSION
AZTEC DISTRICT OFFICE

No. Copies Received 6

DISTRIBUTION

	NO.	
	NO. COPIES	
Director	2	
Asst. Dir.	1	
Administration Office		
State Land Office		
U. S. G. S.	2	
Transporter		
File	1	✓

NEW MEXICO OIL CONSERVATION COMMISSION
Santa Fe, New Mexico

Form C-101
Revised (12/1/55)

NOTICE OF INTENTION TO DRILL

Notice must be given to the District Office of the Oil Conservation Commission and approval obtained before drilling or recompletion begins. If changes in the proposed plan are considered advisable, a copy of this notice showing such changes will be returned to the sender. Submit this notice in QUINTUPLICATE. One copy will be returned following approval. See additional instructions in Rules and Regulations of the Commission. If State Land submit 6 Copies Attach Form G- 128 in triplicate to first 3 copies of form C-101

Farmington, New Mexico
(Place)

November 17, 1959
(Date)

OIL CONSERVATION COMMISSION
SANTA FE, NEW MEXICO

Gentlemen:

You are hereby notified that it is our intention to commence the Drilling of a well to be known as

El Paso Natural Gas Company
(Company or Operator)

Fee
(Lease)

Well No. 23-1-C

H
(Unit)

The well is located 1550 feet from the North line and 1090 feet from the East

line of Section 23, T. 25N, R. 2W, NMPM.

(GIVE LOCATION FROM SECTION LINE) Cavalin P. C. Pool, Rio Arriba County

If State Land the Oil and Gas Lease is No. Fee

If patented land the owner is

Address

We propose to drill well with drilling equipment as follows: Rotary tools thru

Pictured Cliffs formation.

The status of plugging bond is Statewide

Drilling Contractor

We intend to complete this well in the Pictured Cliffs

formation at an approximate depth of 3899' feet.

Elev. 7420'G, 7430' DE

CASING PROGRAM

We propose to use the following strings of Casing and to cement them as indicated:

Size of Hole	Size of Casing	Weight per Foot	New or Second Hand	Depth	Sacks Cement
13 3/4"	8 5/8"	24	New	120'	125
8 3/4"	5 1/2"	15.5	New	3899'	150

If changes in the above plans become advisable we will notify you immediately.

ADDITIONAL INFORMATION (If recompletion give full details of proposed plan of work.) It is proposed to perforate and water fracture possible producing zones.

The NE/4 of Section 23 is dedicated to this well.

Approved 11-18, 1959
Except as follows:

Sincerely yours,

El Paso Natural Gas Company
(Company or Operator)

By Original Signed F. H. WOOD

Position Petroleum Engineer

Send Communications regarding well to

Name E. S. Oberly

Address Box 997, Farmington, New Mexico

OIL CONSERVATION COMMISSION

By Emory C. Wood

