

## NEW MEXICO OIL CONSERVATION COMMISSION

## Well Location and Acreage Dedication Plat

Section A.

Date **September 5, 1963**

Operator **BOLACK - GREER, INC.** Lease **CANADA OJITOS UNIT**  
 Well No. \_\_\_\_\_ Unit Letter **A** Section **23** Township **25 NORTH** Range **1 WEST** NMPM  
 Located **680** Feet From **the NORTH** Line, **620** Feet From **the EAST**, Line  
 County **RIO ARriba** G. L. Elevation **7140.8'** Dedicated Acreage **40** Acres  
 Name of Producing Formation **Dakota** Pool **Undesignated**

1. Is the Operator the only owner in the dedicated acreage outlined on the plat below?

Yes ☒ No \_\_\_\_\_

2. If the answer to question one is "no", have the interests of all the owners been consolidated by communitization agreement or otherwise? Yes \_\_\_\_\_ No \_\_\_\_\_. If answer is "yes", Type of Consolidation.

3. If the answer to question two is "no", list all the owners and their respective interests below:

Owner

Land Description



Section B.

Note: All distances must be from outer boundaries of section.

This is to certify that the information in Section A above is true and complete to the best of my knowledge and belief.

**BOLACK-GREER, INC.**

(Operator)

(Representative)

**158 Petroleum Center Bldg.**

(Address)

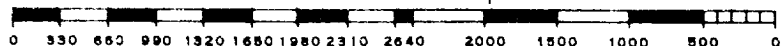
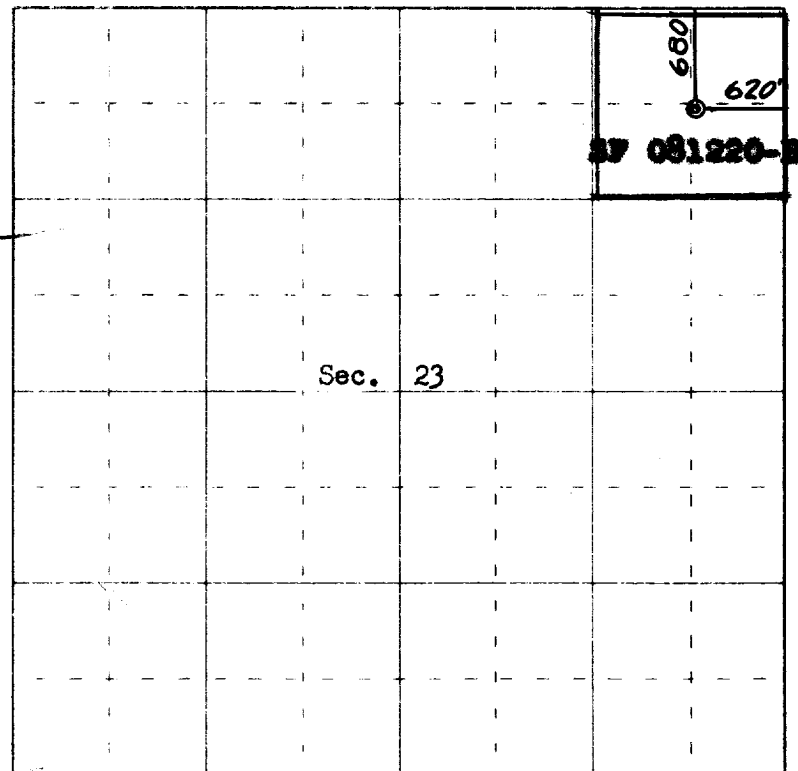
**Farmington, New Mexico**

Scale 4 inches equal 1 mile

This is to certify that the above plat was prepared from field notes of actual surveys made by me or under my supervision and that the same are true and correct to the best of my knowledge and belief.

(Seal)

Date Surveyed **16 August 1963**

Farmington, New Mexico

**James P. Leese**  
 Registered Professional Engineer and/or Land Surveyor  
 James P. Leese, N. Mex. Reg. No. 1463  
 San Juan Engineering Company