

NEW MEXICO OIL CONSERVATION COMMISSION
WELL LOCATION AND ACREAGE DEDICATION PLAT

Form C-102
Supersedes C-128
Effective 1-1-65

All distances must be from the outer boundaries of the Section.

Operator EL PASO NATURAL GAS COMPANY			Lease JICARILLA E (JICARILLA CONTR. NO. 64)		Well No. 10
Unit Letter E	Section 18	Township 25-N	Range 4-W	County RIO ARRIBA	
Actual Footage Location of Well: 1650 feet from the N line and 990 feet from the W line					
Ground Level Elev. 1431 DF	Producing Formation PICTURED CLIFFS		Pool SO. BLANCO PICTURED CLIFFS EXT.	Dedicated Acreage: 163.36 Acres	

1. Outline the acreage dedicated to the subject well by colored pencil or hachure marks on the plat below.
2. If more than one lease is dedicated to the well, outline each and identify the ownership thereof (both as to working interest and royalty).
3. If more than one lease of different ownership is dedicated to the well, have the interests of all owners been consolidated by communitization, unitization, force-pooling, etc?

☐ Yes ☐ No If answer is "yes," type of consolidation _____

If answer is "no," list the owners and tract descriptions which have actually been consolidated. (Use reverse side of this form if necessary.) _____

No allowable will be assigned to the well until all interests have been consolidated (by communitization, unitization, forced-pooling, or otherwise) or until a non-standard unit, eliminating such interests, has been approved by the Commission.

THIS PLAT REISSUED TO SHOW CORRECTED ACREAGE AS PER LETTER N.M.O.C. DATED 2-14-68

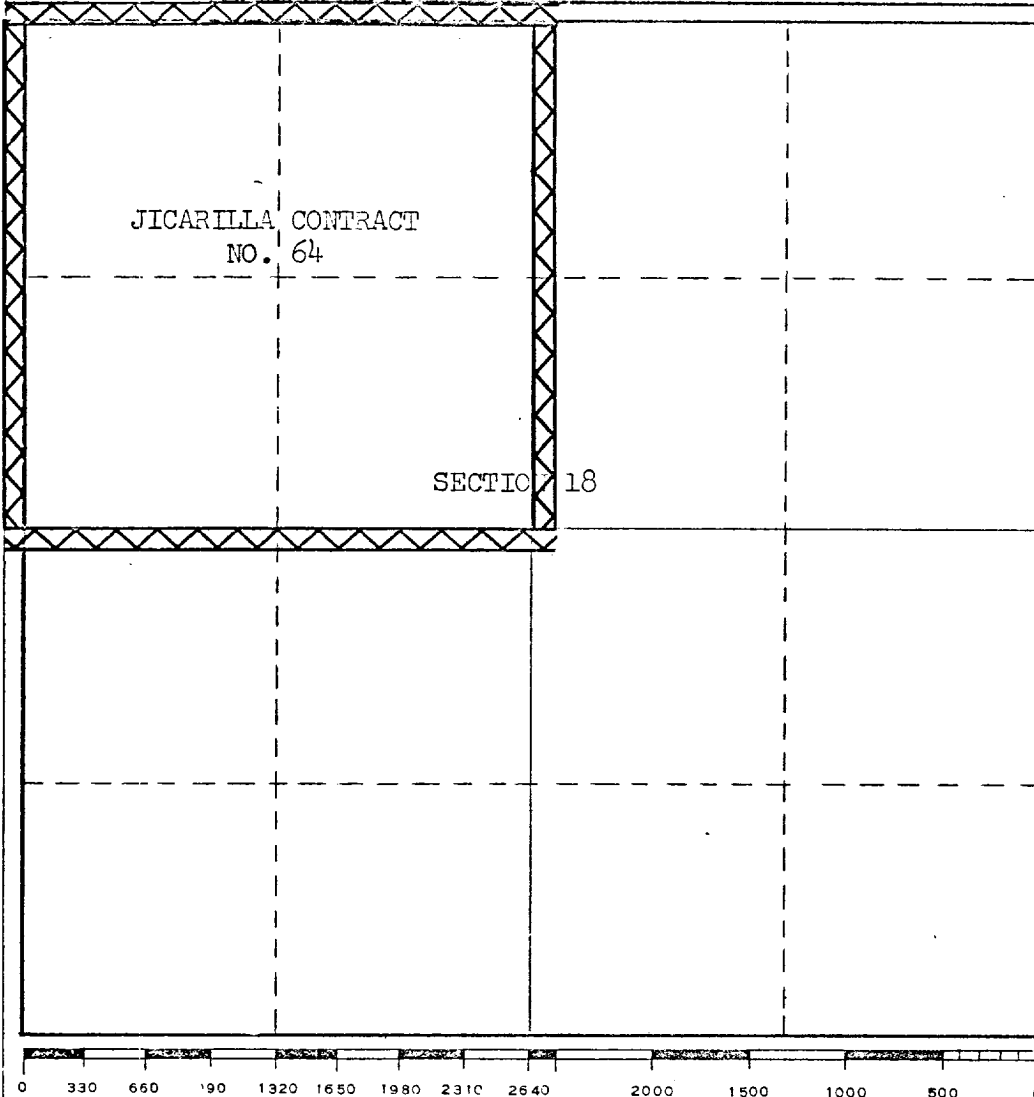

CERTIFICATION	
I hereby certify that the information contained herein is true and complete to the best of my knowledge and belief.	
<i>Carl E. Matthews</i>	
Name	Petroleum Engineer
Position	El Paso Natural Gas Company
Company	March 11, 1968
Date	
I hereby certify that the well location shown on this plat was plotted from field notes of actual surveys made by me or under my supervision, and that the same is true and correct to the best of my knowledge and belief.	
Date Surveyed	
Registered Professional Engineer and/or Land Surveyor	MAR 12 1968
	OIL CON. COM. DIST. 3
Certificate No.	