

(SUBMIT IN TRIPLICATE)

Indian Agency Siouxville

UNITED STATES  
DEPARTMENT OF THE INTERIOR  
GEOLOGICAL SURVEY

Contract #134

Allottee \_\_\_\_\_

Co. Lease No. 25 120003

			X

See Attached Plans

SUNDRY NOTICES AND REPORTS ON WELLS

NOTICE OF INTENTION TO DRILL	X	SUBSEQUENT REPORT OF WATER SHUT-OFF	
NOTICE OF INTENTION TO CHANGE PLANS		SUBSEQUENT REPORT OF SHOOTING OR ACIDIZING	
NOTICE OF INTENTION TO TEST WATER SHUT-OFF		SUBSEQUENT REPORT OF ALTERING CASING	
NOTICE OF INTENTION TO REDRILL OR REPAIR WELL		SUBSEQUENT REPORT OF REDRILLING OR REPAIR	
NOTICE OF INTENTION TO SHOOT OR ACIDIZE		SUBSEQUENT REPORT OF ABANDONMENT	
NOTICE OF INTENTION TO PULL OR ALTER CASING		SUPPLEMENTARY WELL HISTORY	
NOTICE OF INTENTION TO ABANDON WELL			

(INDICATE ABOVE BY CHECK MARK NATURE OF REPORT, NOTICE, OR OTHER DATA)

JICARILLA APACHE TRIBE OF  
INDIANS "H"

October 10, 19 57

Well No. 3 is located 300 ft. from N line and 300 ft. from E line of sec. 13

NE/4 Section 13

T-25-N

R-4-W

(1/4 Sec. and Sec. No.)

(Twp.)

(Range)

(Meridian)

So. Blance Pictured Cliff

Rio Arriba Co.

New Mexico

(Field)

(County or Subdivision)

(State or Territory)

The elevation of the derrick floor above sea level is later ft.

DETAILS OF WORK

(State names of and expected depths to objective sands; show sizes, weights, and lengths of proposed casings; indicate mudding jobs, cementing points, and all other important proposed work)

**CASING PROGRAM**  
8-5/8" 24'  
5-1/8" 24'  
3-1/2" 2500'

**CEMENTING RECORD**  
 Circulate to surface  
 Circulate to 8-5/8" casg.

**CORING PROGRAM**

Pictured Cliffs

Proposed total depth 2500' to test Pictured Cliff  
 Oil-water emulsion drilling fluids  
 Halliburton method of cementing



I understand that this plan of work must receive approval in writing by the Geological Survey before operations may be commenced.

Company Mobile Oil & Refining Company

Address Box 1000

Midland, Texas

By [Signature]

Title Asst. Div. Chief Clerk

NEW MEXICO OIL CONSERVATION COMMISSION  
Well Location and Acreage Dedication Plat

Section A.

Date 10-8-57

Operator HUMBLE OIL & REFG CO Lease JICARILLA APACHE TRIBE OF INDIANS "M"  
Well No. 3 Unit Letter "A" Section 13 Township - 25-N Range - 4-W NMPM  
Located 990 Feet From NORTH Line, 990 Feet From EAST Line  
County RIO ARriba G. L. Elevation \_\_\_\_\_ Dedicated Acreage 160 Acres  
Name of Producing Formation PICTURED CLIFF Pool SOUTH BLANCO

1. Is the Operator the only owner\* in the dedicated acreage outlined on the plat below?  
Yes ✓ No \_\_\_\_\_.
2. If the answer to question one is "no," have the interests of all the owners been consolidated by communitization agreement or otherwise? Yes \_\_\_\_\_ No \_\_\_\_\_. If answer is "yes," Type of Consolidation \_\_\_\_\_.
3. If the answer to question two is "no," list all the owners and their respective interests below:

Owner

Land Description

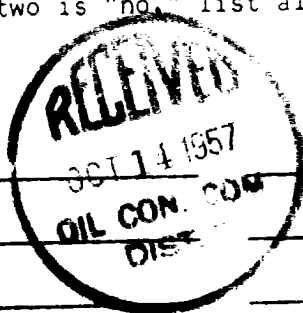

Section B

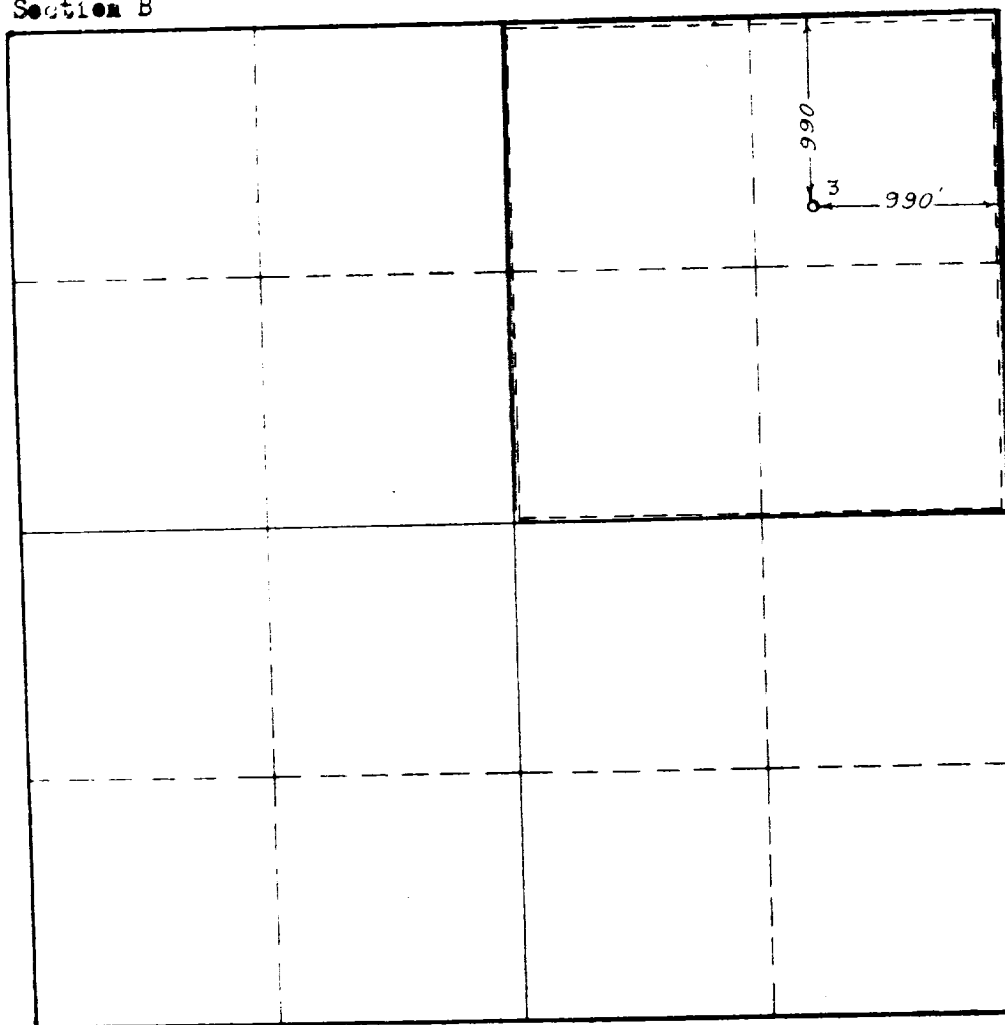

This is to certify that the information in Section A above is true and complete to the best of my knowledge and belief.

HUMBLE OIL & REFG CO  
(Operator)

H. E. Henology  
(Representative)  
Assistant Division Supt  
Box 1600 Midland, Texas  
Address

This is to certify that the well location shown on the plat in Section B was plotted from field notes of actual surveys made by me or under my supervision and that the same is true and correct to the best of my knowledge and belief.

Date Surveyed 10-7-57

E. T. Shahan  
Registered Professional  
Engineer and/or Land Surveyor.

Certificate No. 1513

LEASE NO 196083

W-A - 2417