

(SUBMIT IN TRIPLICATE)

UNITED STATES  
DEPARTMENT OF THE INTERIOR  
GEOLOGICAL SURVEY

Land Office SANTA FE  
Lease No. 1334  
Unit 0

## SUNDRY NOTICES AND REPORTS ON WELLS

NOTICE OF INTENTION TO DRILL	<input checked="" type="checkbox"/>	SUBSEQUENT REPORT OF WATER SHUT-OFF	
NOTICE OF INTENTION TO CHANGE PLANS		SUBSEQUENT REPORT OF SHOOTING OR ACIDIZING	
NOTICE OF INTENTION TO TEST WATER SHUT-OFF		SUBSEQUENT REPORT OF ALTERING CASING	
NOTICE OF INTENTION TO RE-DRILL OR REPAIR WELL		SUBSEQUENT REPORT OF RE-DRILLING OR REPAIR	
NOTICE OF INTENTION TO SHOOT OR ACIDIZE		SUBSEQUENT REPORT OF ABANDONMENT	
NOTICE OF INTENTION TO PULL OR ALTER CASING		SUPPLEMENTARY WELL HISTORY	
NOTICE OF INTENTION TO ABANDON WELL			

(INDICATE ABOVE BY CHECK MARK NATURE OF REPORT, NOTICE, OR OTHER DATA)

AUGUST 14, 19 59

Well No. 11-2-2 is located 1065 ft. from N line and 1810 ft. from E line of sec. 11

SE 1/4 Sec. 11 (Sec. and Sec. No.) 25 (Twp.) 2 (Range) 14N (Meridian)

SAN JUAN (Field) RIO ARRIOLA (County or Subdivision) NEW MEXICO (State or Territory)

The elevation of the derrick floor above sea level is 7445 ft.

### DETAILS OF WORK

(State names of and expected depths to objective sands; show sizes, weights, and lengths of proposed casings; indicate mudding jobs, cementing points, and all other important proposed work)

INTEND TO DRILL TO TEST PICTURE CLIFFS FORMATION AT AN ESTIMATED DEPTH OF 4000'

CASING PROGRAM AND COMPLETION PROGRAM

8 5/8 CASING @ 100' WILL CIRCULATE CEMENT (75SK)

4 1/2 CASING @ 4000 WITH 150 SK

WILL PERFORATE CASING OPPOSITE P C FORMATION  
SAND WATER FRACTURE, INSTALL 2" TUBING AND COMPLETE

I understand that this plan of work must receive approval in writing by the Geological Survey before operations may be commenced.

Company CLARK & CONDOR PRODUCTION CO.

Address 5543 YALE BLVD.

DALLAS, TEXAS

By [Signature]

Title [Signature]

NEW MEXICO OIL CONSERVATION COMMISSION  
WELL LOCATION AND ACREAGE DEDICATION PLAT

FORM C-128  
Revised 5/1/57

SEE INSTRUCTIONS FOR COMPLETING THIS FORM ON THE REVERSE SIDE

SECTION A

Operator <b>CLARK AND COWDEN PRODUCTION COMPANY</b>			Lease <b>35-081374</b>		Well No. <b>11-2-2</b>
Unit Letter <b>0</b>	Section <b>11</b>	Township <b>25 NORTH</b>	Range <b>3 WEST</b>	County <b>RIO ARriba</b>	
Actual Footage Location of Well: <b>1065</b> feet from the <b>SOUTH</b> line and <b>1810</b> feet from the <b>EAST</b> line					
Ground Level Elev. <b>7445.0</b>	Producing Formation <b>PICTURE CLIFF</b>		Pool <b>TAPACITE</b>		Dedicated Acreage: <b>160</b> Acres

Ref: GLO plat dated 18 December 1917

1. Is the Operator the only owner in the dedicated acreage outlined on the plat below? YES \_\_\_\_\_ NO \_\_\_\_\_. ("Owner" means the person who has the right to drill into and to produce from any pool and to appropriate the production either for himself or for himself and another. (65-3-29 (e) NMSA 1935 Comp.)
2. If the answer to question one is "no," have the interests of all the owners been consolidated by communitization agreement or otherwise? YES \_\_\_\_\_ NO \_\_\_\_\_. If answer is "yes," Type of Consolidation \_\_\_\_\_
3. If the answer to question two is "no," list all the owners and their respective interests below:

Owner <b>CLARK &amp; COWDEN PRODUCTION CO.</b> <b>5542 VALS BLVD. DALLAS, TEXAS</b>	Land Description <b>SEC. 11, T-25N, R-3W</b>
---	---

SECTION B

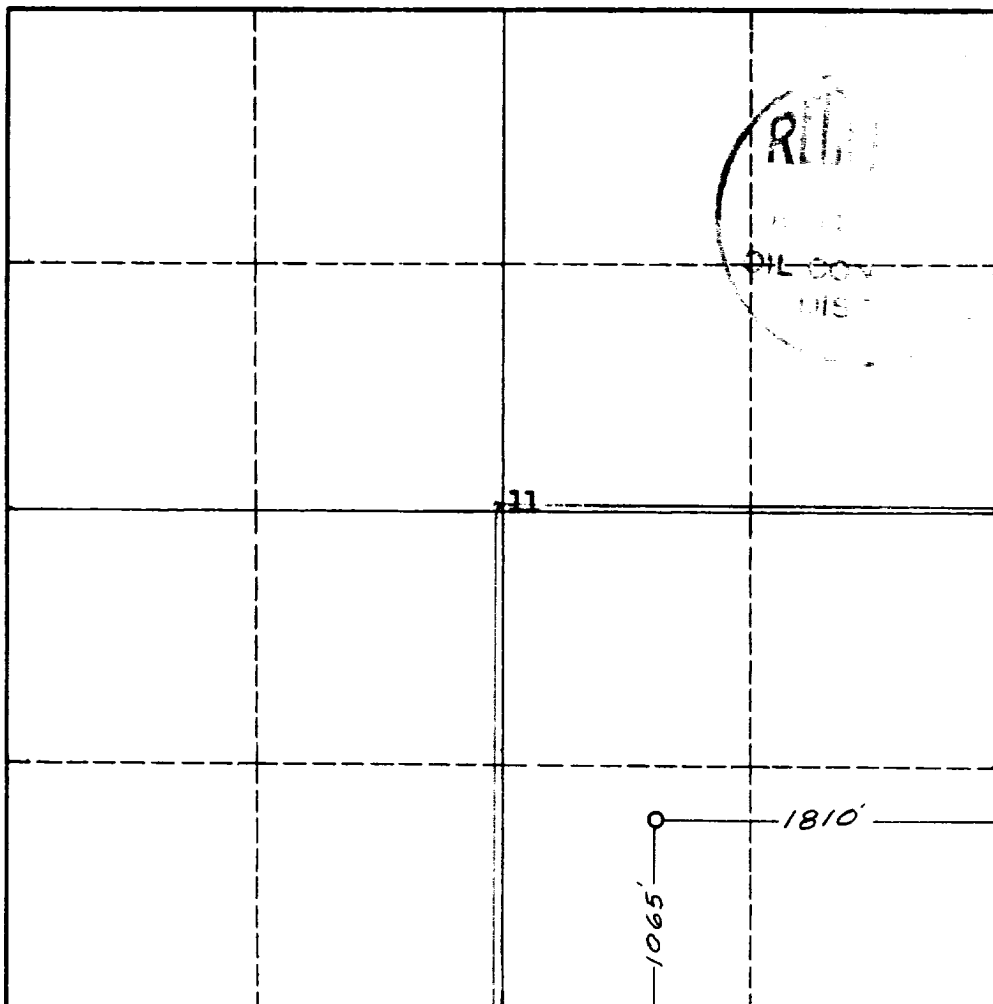

CERTIFICATION

I hereby certify that the information in SECTION A above is true and complete to the best of my knowledge and belief.

**Geological, Inc.**  
Name  
**AGENT**  
Position  
**CLARK & COWDEN PROD. CO.**  
Company  
**AUGUST 14, 1959**  
Date

I hereby certify that the well location shown on the plat in SECTION B was plotted from field notes of actual surveys made by me or under my supervision, and that the same is true and correct to the best of my knowledge and belief.

Date Surveyed  
**7 August 1959**  
Registered Professional Engineer and/or Land Surveyor  
**James P. Loese**  
Certificate No. **1463**

0 330 660 990 1320 1650 1980 2310 2640 2000 1500 1000 500 0

## **INSTRUCTIONS FOR COMPLETION OF FORM C-128**

1. Operator shall furnish and certify to the information called for in Section A.
2. Operator shall outline the dedicated acreage for *both* oil and gas wells on the plat in Section B.
3. A registered professional engineer or land surveyor registered in the State of New Mexico or approved by the Commission shall show on the plat the location of the well and certify this information in the space provided.
4. All distances shown on the plat must be from the outer boundaries of the Section.
5. If additional space is needed for listing owners and their respective interests as required in question 3 of Section A, please use space below.