

**JICARILLA APACHE TRIBE
ENVIRONMENTAL PROTECTION OFFICE
P.O. BOX 507
DULCE, NEW MEXICO 87528**

BT 536 Blow-Box
SEP-OK
SUBMIT 1 COPY TO

NATURAL RESOURCE DEPT
AND OIL & GAS ADMINISTRATION

PIT REMEDIATION AND CLOSURE REPORT

RECEIVED
AUG 16 1999

OIL CON. DIV.
5053-9200

Operator: AMOCO PRODUCTION COMPANY **Telephone:** (505) 328-9200
Address: 200 Amoco Court, Farmington, NM 87401
Facility or Well Name: JICARILLA CONTRACT 146-14
Location: Unit or Qtr/Qtr Sec J Sec 9 T 25N R 5W County RIO ARriba
Pit Type: Separator Dehydrator Other BLOW
Land Type: RANGE

Pit Location: Pit dimensions: length 44', width 40', depth 18'
(Attach diagram)
Reference: wellhead X, other
Footage from reference: 220'
Direction from reference: 34 Degrees East of North
X West of South X

Depth To Groundwater: (Vertical distance from contaminants to seasonal high water elevation of groundwater)	Less than 50 feet (20 points) 50 feet to 99 feet (10 points) Greater than 100 feet (0 points)	<u>0</u>
Distance to an Ephemeral Stream (Downgradient dry wash greater than ten feet in width)	Less than 100 feet (10 points) Greater than 100 feet (0 points)	<u>0</u>
Distance to Nearest Lake, Playa, or Watering Pond (Downgradient lakes, playas and livestock or wildlife watering ponds)	Less than 100 feet (10 points) Greater than 100 feet (0 points)	<u>0</u>
Wellhead Protection Area: (Less than 200 feet from a private domestic water source, or: less than 1000 feet from all other water sources)	Yes (20 points) No (0 points)	<u>0</u>
Distance To Surface Water: (Horizontal distance to perennial lakes, ponds, rivers, streams, creeks, irrigation canals and ditches)	Less than 100 feet (20 points) 100 feet to 1000 feet (10 points) Greater than 1000 feet (0 points)	<u>0</u>

RANKING SCORE (TOTAL POINTS): 0

BT 536

Blow PIT

Date Remediation Started: _____

Date Completed: _____

3/4/98

Remediation Method: Excavation ☒

Approx. cubic yards _____

800

(Check all appropriate sections)

Landfarmed ☒

Insitu Bioremediation _____

Other _____

Remediation Location: _____

Onsite ☒ Offsite _____

(i.e. landfarmed onsite, name and location of offsite facility)

General Description of Remedial Action: Excavation. BEDROCK BOTTOM. SPRAYED

NORTH SIDEWALL w/ FERTILIZER.

Groundwater Encountered: _____

No ☒

Yes _____

Depth _____

Final Pit: _____

Sample location see Attached Documents

Closure Sampling: _____

(if multiple samples, attach sample results and diagram of sample locations and depths)

Sample depth _____

12'

Sample date _____

3/2/98

Sample time _____

1245

Sample Results

Soil: Benzene

(ppm)

0.580

Water: Benzene

(ppb)

Total BTEX

(ppm)

143.580

Toluene

(ppb)

Field Headspace

(ppm)

792

Ethylbenzene

(ppb)

TPH

(ppm)

997

Total Xylenes

(ppb)

Groundwater Sample: _____

Yes _____

No ☒

(If yes, attach sample results)

I HEREBY CERTIFY THAT THE INFORMATION ABOVE IS TRUE AND COMPLETE TO THE BEST OF MY KNOWLEDGE AND BELIEF

DATE

3/4/98

PRINTED NAME

Buddy D. Shaw

SIGNATURE

Buddy D. Shaw

AND TITLE

Environmental Coordinator

AFTER REVIEW OF THE PIT CLOSURE INFORMATION, PIT CLOSURE IS APPROVED IN ACCORDANCE TO THE JICARILLA APACHE TRIBE PIT CLOSURE ORDINANCE.

APPROVED: YES _____ NO _____ (REASON) _____

SIGNED: _____

DATE: _____

CLIENT: <u>AMOCO</u>	BLAGG ENGINEERING, INC. P.O. BOX 87, BLOOMFIELD, NM 87413 (505) 632-1199	LOCATION NO: <u>8J536</u> C.O.C. NO: <u>5732</u>
----------------------	--	---

FIELD REPORT: CLOSURE VERIFICATION	PAGE No: <u>1</u> of <u>1</u>
------------------------------------	-------------------------------

LOCATION: NAME: <u>JICA CONTR. 146</u> WELL #: <u>14</u> PIT: <u>BLOW</u> QUAD/UNIT: <u>T</u> SEC: <u>9</u> TWP: <u>25N</u> RNG: <u>5W</u> PM: <u>NM</u> CNTY: <u>RA</u> ST: <u>NM</u> QTR/FOOTAGE: <u>NW1/4 SE1/4</u> CONTRACTOR: <u>P & S</u>	DATE STARTED: <u>3/2/98</u> DATE FINISHED: _____ ENVIRONMENTAL SPECIALIST: <u>NV</u>
---	--

EXCAVATION APPROX. <u>44</u> FT. x <u>40</u> FT. x <u>18</u> FT. DEEP. CUBIC YARDAGE: <u>800</u> DISPOSAL FACILITY: <u>ON-SITE</u> REMEDIATION METHOD: <u>LANDFARMED</u> LAND USE: <u>RANGE</u> LEASE: <u>JICA 146</u> FORMATION: <u>CK</u>

FIELD NOTES & REMARKS:	PIT LOCATED APPROXIMATELY <u>220</u> FT. <u>S34W</u> FROM WELLHEAD. DEPTH TO GROUNDWATER: <u>2100'</u> NEAREST WATER SOURCE: <u>21000'</u> NEAREST SURFACE WATER: <u>21000'</u> NMDCD RANKING SCORE: <u>0</u> NMDCD TPH CLOSURE STD: <u>5000</u> PPM SOIL AND EXCAVATION DESCRIPTION:
------------------------	--

CHECK ONE:
☒ PIT ABANDONED
☐ STEEL TANK INSTALLED
☐ FIBERGLASS TANK INSTALLED

MOSTLY OK. YELL. BROWN SAND TO SILTY SAND EXCEPT NORTH SIDEWALL WHICH WAS OLIVE GRAY, NON COHESIVE, SLIGHTLY MOIST FIRM, NO APPARENT STAINING OR HC ODOR OBSERVED W/IN EXCAVATION, STRONG HC ODOR IN NORTH SIDEWALL OUM SAMPLE ONLY.

 BOTTOM - BEDROCK SHALE/SANDSTONE VERY HARD, NO APPARENT HC ODOR IN OUM SAMPLE. DUSKY RED IN COLOR.

BEDROCK BOTTOM

RISK ASSESSED

SCALE

0 FT

TIME	SAMPLE I.D.	LAB No:	WEIGHT (g)	mL. FREON	DILUTION	READING	CALC. ppm

PIT PERIMETER

OVM RESULTS

SAMPLE ID	FIELD HEADSPACE PID (ppm)
1 @ 12'	792
2 @ 12'	0.0
3 @ 13'	0.0
4 @ 13'	46.2
5 @ 18'	0.0

PIT PROFILE

LAB SAMPLES

SAMPLE ID	ANALYSIS	TIME
① @ 12'	PH/BTEX	1245
(8015) (B021)		

TPH PASSED

BTEX FAILED

Well Name:	Jicarilla Contract 146 #14
Well Site location:	Unit J, Sec. 9, T25N, R5W
Pit Type:	Blow Pit
Producing Formation:	Chacra
Pit Category:	Non Vulnerable
Horizontal Distance to Surface Water:	> 1000 ft.
Vicinity Groundwater Depth:	> 100 ft.

RISK ASSESSMENT (non-vulnerable area)

Pit remediation activities were terminated when trackhoe encountered shale/sandstone bedrock at 18 feet below grade.

No past or future threat to surface water or groundwater is likely based on the following considerations:

1. Past production fluids were contained locally by a relatively shallow shale/sandstone bedrock located 18 feet below grade. Groundwater levels located on or close to the well pad are estimated to be at a greater depth below the shale/sandstone bedrock.
2. Topographic information does not indicate off site lateral fluid migration near the earthen pit.
3. Daily discharge into the earthen pit has been terminated (pit abandoned). Prior discharge into the pit is believed to be under 5 barrels per day.
4. Well site located at the head and fringe of the lapis valley vulnerable area boundary and is at the toe of the Wild Horse Mesa west side cliffs.

(Refer to Lapis Point Quadrangle, New Mexico - Rio Arriba County, 7.5 Minute Series (Topographic), 1963, (vulnerable area boundary developed by Mr. William C. Olson, Hydrogeologist, Environmental Bureau, New Mexico Oil Conservation Division).

Based upon the information given, we conclude that the subsurface lateral impact from the earthen pit is very limited and that the shale/sandstone bottom creates enough of a impermeable barrier as to subdue impact to groundwater below it (please refer to AMOCO's report "Post Excavation Pit Closure Investigation Summary, July, 1995", with cover letter dated November 30, 1995). AMOCO requests pit closure approval on this location.

ENVIROTECH LABS

PRACTICAL SOLUTIONS FOR A BETTER TOMORROW

EPA METHOD 8015 Modified Nonhalogenated Volatile Organics Total Petroleum Hydrocarbons

Client:	Blagg / AMOCO	Project #:	04034-10
Sample ID:	1 @ 12'	Date Reported:	03-03-98
Laboratory Number:	C962	Date Sampled:	03-02-98
Chain of Custody No:	5732	Date Received:	03-03-98
Sample Matrix:	Soil	Date Extracted:	03-03-98
Preservative:	Cool	Date Analyzed:	03-03-98
Condition:	Cool and Intact	Analysis Requested:	8015 TPH

Parameter	Concentration (mg/Kg)	Det. Limit (mg/Kg)
Gasoline Range (C5 - C10)	740	0.0
Diesel Range (C10 - C28)	257	0.0
Total Petroleum Hydrocarbons	997	0.0

ND - Parameter not detected at the stated detection limit.

References: Method 8015B, Nonhalogenated Volatile Organics, Test Methods for Evaluating Solid Waste, SW-846, USEPA, December 1996.

Comments: Jicarilla Contract 146-14 Blow Pit.

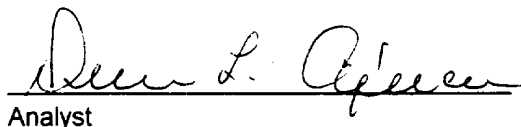
Analyst

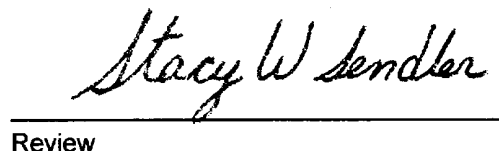
Review

ENVIROTECH LABS

PRACTICAL SOLUTIONS FOR A BETTER TOMORROW

EPA METHOD 8021 AROMATIC VOLATILE ORGANICS

Client:	Blagg / AMOCO	Project #:	04034-10
Sample ID:	1 @ 12'	Date Reported:	03-03-98
Laboratory Number:	C962	Date Sampled:	03-02-98
Chain of Custody:	5732	Date Received:	03-03-98
Sample Matrix:	Soil	Date Analyzed:	03-03-98
Preservative:	Cool	Date Extracted:	03-03-98
Condition:	Cool & Intact	Analysis Requested:	BTEX

Parameter	Concentration (ug/Kg)	Det. Limit (ug/Kg)
Benzene	580	8.8
Toluene	41,470	8.4
Ethylbenzene	22,260	7.6
p,m-Xylene	38,810	10.8
o-Xylene	40,460	5.2
Total BTEX	143,580	

ND - Parameter not detected at the stated detection limit.

Surrogate Recoveries:	Parameter	Percent Recovery
	Trifluorotoluene	98 %
	Bromofluorobenzene	98 %

References: Method 5030B, Purge-and-Trap, Test Methods for Evaluating Solid Waste, SW-846, USEPA, December 1996.

Method 8021B, Aromatic Volatile Organics, Test Methods for Evaluating Solid Waste, SW-84 USEPA, December 1996.

Comments: Jicarilla Contract 146-14 Blow Pit.

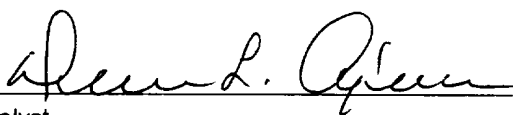
Analyst

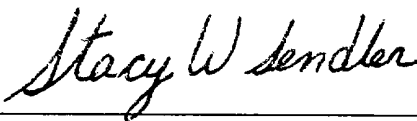
Review

**JICARILLA APACHE TRIBE
ENVIRONMENTAL PROTECTION OFFICE
P.O. BOX 507
DULCE, NEW MEXICO 87528**

BT 536

SUBMIT 1 COPY TO
NATURAL RESOURCE DEPT
AND OIL & GAS ADMINISTRATION

PIT REMEDIATION AND CLOSURE REPORT

Operator: AMOCO PRODUCTION COMPANY **Telephone:** (505) 326-9200
Address: 200 Amoco Court, Farmington, NM 87401
Facility or Well Name: JICARILLA CONTRACT 146-14
Location: Unit or Qtr/Qtr Sec J Sec 4 T 25N R 5W County RIO ARIZONA
Pit Type: Separator X Dehydrator Other
Land Type: RANGE

Pit Location: Pit dimensions: length 24', width 20', depth 18'
(Attach diagram) Reference: wellhead X, other
Footage from reference: 78'
Direction from reference: 22 Degrees East of North
X West of South X

Depth To Groundwater: (Vertical distance from contaminants to seasonal high water elevation of groundwater)	Less than 50 feet 50 feet to 99 feet Greater than 100 feet	(20 points) (10 points) (0 points)	<u>0</u>
Distance to an Ephemeral Stream (Downgradient dry wash greater than ten feet in width)	Less than 100 feet Greater than 100 feet	(10 points) (0 points)	<u>0</u>
Distance to Nearest Lake, Playa, or Watering Pond (Downgradient lakes, playas and livestock or wildlife watering ponds)	Less than 100 feet Greater than 100 feet	(10 points) (0 points)	<u>0</u>
Wellhead Protection Area: (Less than 200 feet from a private domestic water source, or: less than 1000 feet from all other water sources)	Yes No	(20 points) (0 points)	<u>0</u>
Distance To Surface Water: (Horizontal distance to perennial lakes, ponds, rivers, streams, creeks, irrigation canals and ditches)	Less than 100 feet 100 feet to 1000 feet Greater than 1000 feet	(20 points) (10 points) (0 points)	<u>0</u>

RANKING SCORE (TOTAL POINTS): 0

BJ 536

SEP. PIT

Date Remediation Started: _____ Date Completed: 3/4/98

Remediation Method: Excavation ☒ Approx. cubic yards 200
(Mark all appropriate sections) Landfarmed ☒ Insitu Bioremediation _____
Other _____

Remediation Location: Onsite ☒ Offsite _____
(i.e. landfarmed onsite, name and location of offsite facility)

General Description of Remedial Action: Excavation.Groundwater Encountered: No ☒ Yes _____ Depth _____

Final Pit: Sample location see Attached Documents
Closure Sampling: _____
(if multiple samples, attach sample results and diagram of sample locations and depths)
Sample depth 20'
Sample date 3/2/98 Sample time 1000
Sample Results

Soil: Benzene	(ppm)	_____	Water: Benzene	(ppb)	_____
Total BTEX	(ppm)	_____	Toluene	(ppb)	_____
Field Headspace	(ppm)	<u>0.0</u>	Ethylbenzene	(ppb)	_____
TPH	(ppm)	<u>18.6</u>	Total Xylenes	(ppb)	_____

Groundwater Sample: Yes _____ No ☒ (If yes, attach sample results)

I HEREBY CERTIFY THAT THE INFORMATION ABOVE IS TRUE AND COMPLETE TO THE BEST OF MY KNOWLEDGE AND BELIEF

DATE 3/4/98 PRINTED NAME Buddy D. Shaw
SIGNATURE Buddy D. Shaw AND TITLE Environmental Coordinator

AFTER REVIEW OF THE PIT CLOSURE INFORMATION, PIT CLOSURE IS APPROVED IN ACCORDANCE TO THE JICARILLA APACHE TRIBE PIT CLOSURE ORDINANCE.

APPROVED: YES _____ NO _____ (REASON) _____

SIGNED: _____ DATE: _____

CLIENT: <u>AMOCO</u>	BLAGG ENGINEERING, INC. P.O. BOX 87, BLOOMFIELD, NM 87413 (505) 632-1199	LOCATION NO: <u>8JS36</u> C.O.C. NO: <u>5732</u>
----------------------	--	---

FIELD REPORT: CLOSURE VERIFICATION	PAGE No: <u>1</u> of <u>1</u>
------------------------------------	-------------------------------

LOCATION: NAME: <u>JICA CONTR. 146</u> WELL #: <u>14</u> PIT: <u>SEP.</u>	DATE STARTED: <u>3/2/98</u>
QUAD/UNIT: <u>J</u> SEC: <u>9</u> TWP: <u>25N</u> RNG: <u>5W</u> PM: <u>Nm</u> CNTY: <u>RA</u> ST: <u>Nm</u>	DATE FINISHED: _____
QTR/FOOTAGE: <u>NW/4 SE/4</u> CONTRACTOR: <u>P+S</u>	ENVIRONMENTAL SPECIALIST: <u>NV</u>

EXCAVATION APPROX. <u>24</u> FT. x <u>20</u> FT. x <u>18</u> FT. DEEP.	CUBIC YARDAGE: <u>200</u>
DISPOSAL FACILITY: <u>ON-SITE</u>	REMEDIATION METHOD: <u>LANDFARMED</u>
LAND USE: <u>RANGE</u>	LEASE: <u>JIC 146</u> FORMATION: <u>CK</u>

FIELD NOTES & REMARKS:	PIT LOCATED APPROXIMATELY <u>78</u> FT. <u>S22W</u> FROM WELLHEAD.
DEPTH TO GROUNDWATER: <u>>100'</u>	NEAREST WATER SOURCE: <u>>1000'</u> NEAREST SURFACE WATER: <u>>1000'</u>

NMDCD RANKING SCORE: <u>0</u>	NMDCD TPH CLOSURE STD: <u>5000</u> PPM	CHECK ONE: <input checked="" type="checkbox"/> PIT ABANDONED <input type="checkbox"/> STEEL TANK INSTALLED <input type="checkbox"/> FIBERGLASS TANK INSTALLED
SOIL AND EXCAVATION DESCRIPTION:		

OK. YEL. BROWN SAND TO SILTY SAND, NON COHESIVE, SLIGHTLY MOIST FIRM, NO APPARENT STRAINING OR HC ODOOR OBSERVED, W/IN EXCAVATION, NO APPARENT HC ODOOR IN ANY OF THE DUM SAMPLES.

CLOSED

FIELD 418.1 CALCULATIONS

TIME	SAMPLE I.D.	LAB No:	WEIGHT (g)	mL. FREON	DILUTION	READING	CALC. ppm

SCALE



PIT PERIMETER N

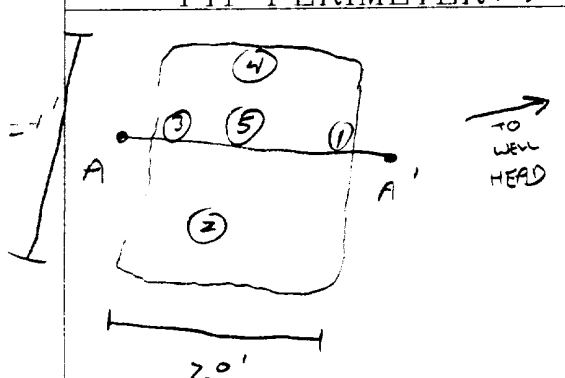

OVM RESULTS

SAMPLE ID	FIELD HEADSPACE PID (ppm)
1 @ 12'	0.0
2 @ 13'	0.0
3 @ 13'	0.0
4 @ 14'	0.0
5 @ 20'	0.0

LAB SAMPLES

SAMPLE ID	ANALYSIS	TIME
3 @ 20'	TPH (418.1)	1000
<u>PA55ED</u>		

PIT PROFILE

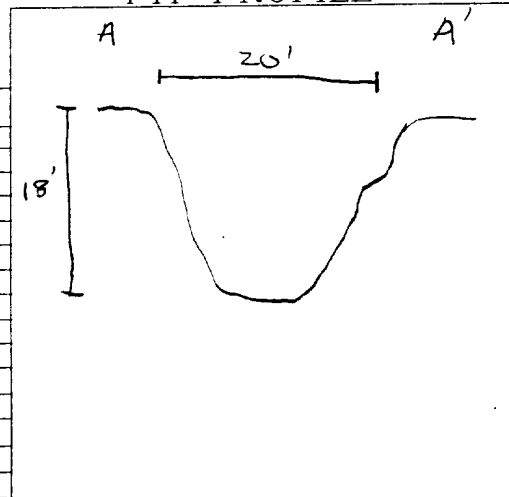

TRAVEL NOTES:	CALLOUT: _____	ONSITE: <u>3/2/98</u>
---------------	----------------	-----------------------

ENVIROTECH LABS

PRACTICAL SOLUTIONS FOR A BETTER TOMORROW

EPA METHOD 418.1 TOTAL PETROLEUM HYDROCARBONS

Client:	Blagg / AMOCO	Project #:	04034-10
Sample ID:	5 @ 20'	Date Reported:	03-03-98
Laboratory Number:	C961	Date Sampled:	03-02-98
Chain of Custody No:	5732	Date Received:	03-03-98
Sample Matrix:	Soil	Date Extracted:	03-03-98
Preservative:	Cool	Date Analyzed:	03-03-98
Condition:	Cool and Intact	Analysis Needed:	TPH-418.1

Parameter	Concentration (mg/kg)	Det. Limit (mg/kg)
Total Petroleum Hydrocarbons	18.6	5.0

ND = Parameter not detected at the stated detection limit.

References: Method 418.1, Petroleum Hydrocarbons, Total Recoverable, Chemical Analysis of Water and Waste, USEPA Storet No. 4551, 1978.

Comments: Jicarilla Contract 146-14 Separator Pit.

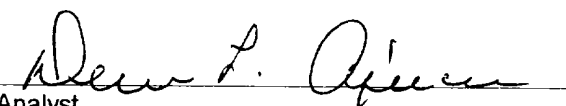
Analyst

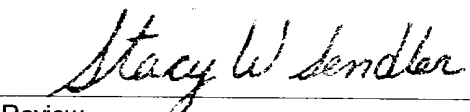
Review

ENVIROTECH INC.
5796 U.S. Highway 64-3014
Farmington, New Mexico 87401
(505) 632-0615

**JICARILLA APACHE TRIBE
ENVIRONMENTAL PROTECTION OFFICE
P.O. BOX 507
DULCE, NEW MEXICO 87528**

SUBMIT 1 COPY TO
NATURAL RESOURCE DEPT
AND OIL & GAS ADMINISTRATION

ON-SITE SOIL REMEDIATION REPORT

Operator: <u>AMOCO PRODUCTION COMPANY</u>		Telephone: <u>(505) 326-9200</u>
Address: <u>200 Amoco Court, Farmington, NM 87401</u>		
Facility or Well Name: <u>JICARILLA CONTRACT 146-14</u>		
Location: Unit or Qtr/Qtr Sec <u>3</u> Sec <u>9</u> T <u>25N</u> R <u>5W</u> County <u>BLAIRE</u>		
Land Type: <u>RANGE</u>		
Date Remediation Started: <u>3-2-98</u>		Date Completed: <u>5/4/99</u>
Remediation Method: Landfarmed <input checked="" type="checkbox"/>		Approx. cubic yards <u>1000</u>
Composted <input type="checkbox"/>		
Other <input type="checkbox"/>		
Depth To Groundwater: (pts.) <u>0</u>	Final Closure Sampling:	
Distance to an Ephemeral Stream (pts.) <u>0</u>	Sampling Date: <u>5-3-99</u> Time: <u>1045</u>	
Distance to Nearest Lake, Playa, or Watering Pond (pts.) <u>0</u>	Sample Results:	
Wellhead Protection Area: (pts.) <u>0</u>	Field Headspace (ppm) <u>0.0</u>	
Distance To Surface Water: (pts.) <u>0</u>	TPH (ppm) <u>14.3</u> Method ^{TPH} <u>(80.5)</u>	
Other <input type="checkbox"/>		
RANKING SCORE (TOTAL POINTS): <u>0</u>		
I HEREBY CERTIFY THAT THE INFORMATION ABOVE IS TRUE AND COMPLETE TO THE BEST OF MY KNOWLEDGE AND BELIEF		
DATE <u>5/4/99</u>	PRINTED NAME <u>Buddy D. Shaw</u>	
SIGNATURE <u>Buddy D. Shaw</u>	AND TITLE <u>Environmental Coordinator</u>	
AFTER REVIEW OF THE SOIL REMEDIATION INFORMATION, ON-SITE REMEDIATION IS APPROVED IN ACCORDANCE TO THE JICARILLA APACHE TRIBE PIT CLOSURE ORDINANCE.		
APPROVED: YES <input type="checkbox"/> NO <input type="checkbox"/> (REASON) _____		
SIGNED: _____ DATE: _____		

CLIENT: <u>AMOCO</u>	BLAGG ENGINEERING, INC. P.O. BOX 87, BLOOMFIELD, NM 87413 (505) 632-1199	LOCATION NO: <u>B5536</u> C.O.C. NO: <u>6905</u>
----------------------	--	---

FIELD REPORT: LANDFARM/COMPOST PILE CLOSURE VERIFICATION

LOCATION: NAME: <u>JICARILLA CONTRACT 146</u> WELL #: <u>14</u> PITS: <u>SEP, BLOW</u>	DATE STARTED: <u>5.3.99</u>
QUAD/UNIT: <u>5</u> SEC: <u>9</u> TWP: <u>25N</u> RNG: <u>5W</u> PM: <u>NM</u> CNTY: <u>RA</u> ST: <u>NM</u>	DATE FINISHED: _____
STR/FOOTAGE: <u>NW/4 SE/4</u> CONTRACTOR: <u>PHS</u>	ENVIRONMENTAL SPECIALIST: <u>REP</u>

SOIL REMEDIATION:

REMEDIALTION SYSTEM: LANDFARM APPROX. CUBIC YARDAGE: 1000
LAND USE: RANGE LIFT DEPTH (ft): 2-2.5

FIELD NOTES & REMARKS:

DEPTH TO GROUNDWATER: >100' NEAREST WATER SOURCE: >1000' NEAREST SURFACE WATER: >1000'

WELL PUMPING SCORE 0 NMCD TPH CLOSURE STD: 5000 PPM

LT. OLIVE GRAY SAND, NON COHESIVE, SLIGHTLY MOIST, FIRM.
NO APPARENT STAINING, NO HC ODOR DETECTED. SAMPLING
DEPTHS RANGE FROM 6"-18". COLLECTED A 5 FT. COMPOSITE SAMPLE
FOR LAB ANALYSIS.

CLOSED

FIELD 418.1 CALCULATIONS

SAMP. TIME	SAMPLE I.D.	LAB No:	WEIGHT (g)	mL FREON	DILUTION	READING	CALC. ppm

SKETCH/SAMPLE LOCATIONS

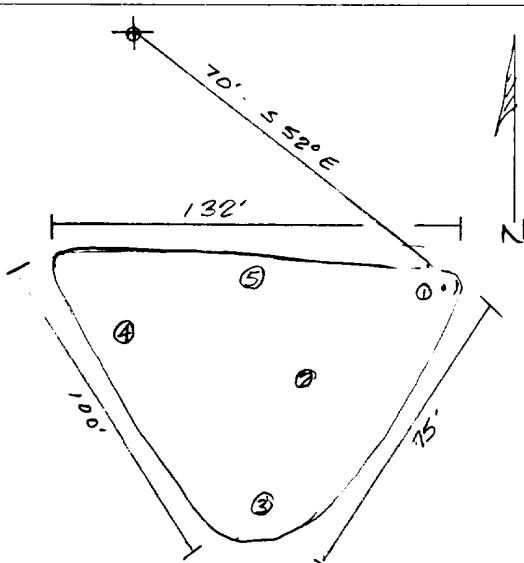

OVM RESULTS

LAB SAMPLES

SAMPLE ID	FIELD HEADSPACE PID (ppm)	SAMPLE ID	ANALYSIS	TIME	RESULTS
LF-1	0.0	LF-1	TPH (8015)	104'	14.3

SCALE

0 FT

TRAVEL NOTES: CALLOUT: N/A ONSITE: 5.3.99

ENVIROTECH LABS

PRACTICAL SOLUTIONS FOR A BETTER TOMORROW

EPA METHOD 8015 Modified Nonhalogenated Volatile Organics Total Petroleum Hydrocarbons

Client:	Blagg / AMOCO	Project #:	403410
Sample ID:	LF - 1	Date Reported:	05-04-99
Laboratory Number:	F119	Date Sampled:	05-03-99
Chain of Custody No:	6905	Date Received:	05-04-99
Sample Matrix:	Soil	Date Extracted:	05-04-99
Preservative:	Cool	Date Analyzed:	05-04-99
Condition:	Cool and Intact	Analysis Requested:	8015 TPH

Parameter	Concentration (mg/Kg)	Det. Limit (mg/Kg)
Gasoline Range (C5 - C10)	ND	0.2
Diesel Range (C10 - C28)	14.3	0.1
Total Petroleum Hydrocarbons	14.3	0.2

ND - Parameter not detected at the stated detection limit.

References: Method 8015B, Nonhalogenated Volatile Organics, Test Methods for Evaluating Solid Waste, SW-846, USEPA, December 1996.

Comments: Jicarilla Contract 146 - 14 Landfarm. 5 Pt. Composite.

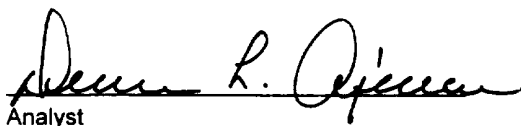
Analyst

Review

6905

ENVIROTECH INC.