

NEW MEXICO OIL CONSERVATION COMMISSION
Santa Fe, New Mexico

Form C-101
Revised (12/1/55)

NOTICE OF INTENTION TO DRILL

Notice must be given to the District Office of the Oil Conservation Commission and approval obtained before drilling or recompletion begins. If changes in the proposed plan are considered advisable, a copy of this notice showing such changes will be returned to the sender. Submit this notice in QUINTUPLICATE. One copy will be returned following approval. See additional instructions in Rules and Regulations of the Commission. If State Land submit 6 Copies Attach Form C- 128 in triplicate to first 3 copies of form C-101

LINDRITH, NEW MEXICO
(Place)

AUGUST 3rd, 1956
(Date)

OIL CONSERVATION COMMISSION
SANTA FE, NEW MEXICO

Gentlemen:

You are hereby notified that it is our intention to commence the Drilling of a well to be known as

SAN JUAN GAS CORPORATION # 11 C Fee
(Company or Operator)

NAZARENE CHURCH
(Lease)

Well No. 11 C Fee, in GAVILIN The well is
(Unit)

located 1190 feet from the NORTH line and 925 feet from the
WEST line of Section 11, T. 25 N, R. 2 W, NMPM.

(GIVE LOCATION FROM SECTION LINE) GAVILIN Pool, RIO ARRIBA County

D	C	B	A
E	F	G	H
L	K	J	I
M	N	O	P

If State Land the Oil and Gas Lease is No.

If patented land the owner is NAZARENE CHURCH

Address GAVILIN, NEW MEXICO

We propose to drill well with drilling equipment as follows: MODEL L 128 CARDWELL

The status of plugging bond is STATE WIDE

Drilling Contractor THE RIO ARRIBA DRILLING CO.

We intend to complete this well in the PICTURED CLIFFS SAND
formation at an approximate depth of 3500 feet.

CASING PROGRAM

We propose to use the following strings of Casing and to cement them as indicated:

Size of Hole	Size of Casing	Weight per Foot	New or Second Hand	Depth	Sacks Cement
11"	8 5/8"	24 lb.	NEW	APPROX. 100'	50
7 7/8"	4 1/2"	16.69	USED	APPROX. 3500'	150

If changes in the above plans become advisable we will notify you immediately.

ADDITIONAL INFORMATION (If recompletion give full details of proposed plan of work.)

Approved
Except as follows:

Sincerely yours,

THE SAN JUAN GAS CORPORATION
(Company or Operator)

By E.W. BENNETT

Position DRILLING SUPT.

Send Communications regarding well to

Name THE SAN JUAN GAS CORPORATION

Address 1716 First Nat'l Bldg. Tulsa, Oklahoma

OIL CONSERVATION COMMISSION

By Ernest Cardwell

NEW MEXICO
OIL CONSERVATION COMMISSION

Form C-128

Well Location and/or Gas Proration Plat

Date AUGUST 3rd. 1956

Operator JUAN GAS CORPORATION Lease Nazarene Church

Well No. 11 C Fee Section 11 Township 25 NORTH Range 2 WEST, NMPM

Located 1190 Feet From the NORTH Line, 925 Feet From the WEST Line,

RIO ARRIBA County, New Mexico. G. L. Elevation 7363.0 UNGRADED.

Name of Producing Formation The Pictured Cliffs Pool Gavilan Dedicated Acreage 100

(Note: All distances must be from outer boundaries of Section)

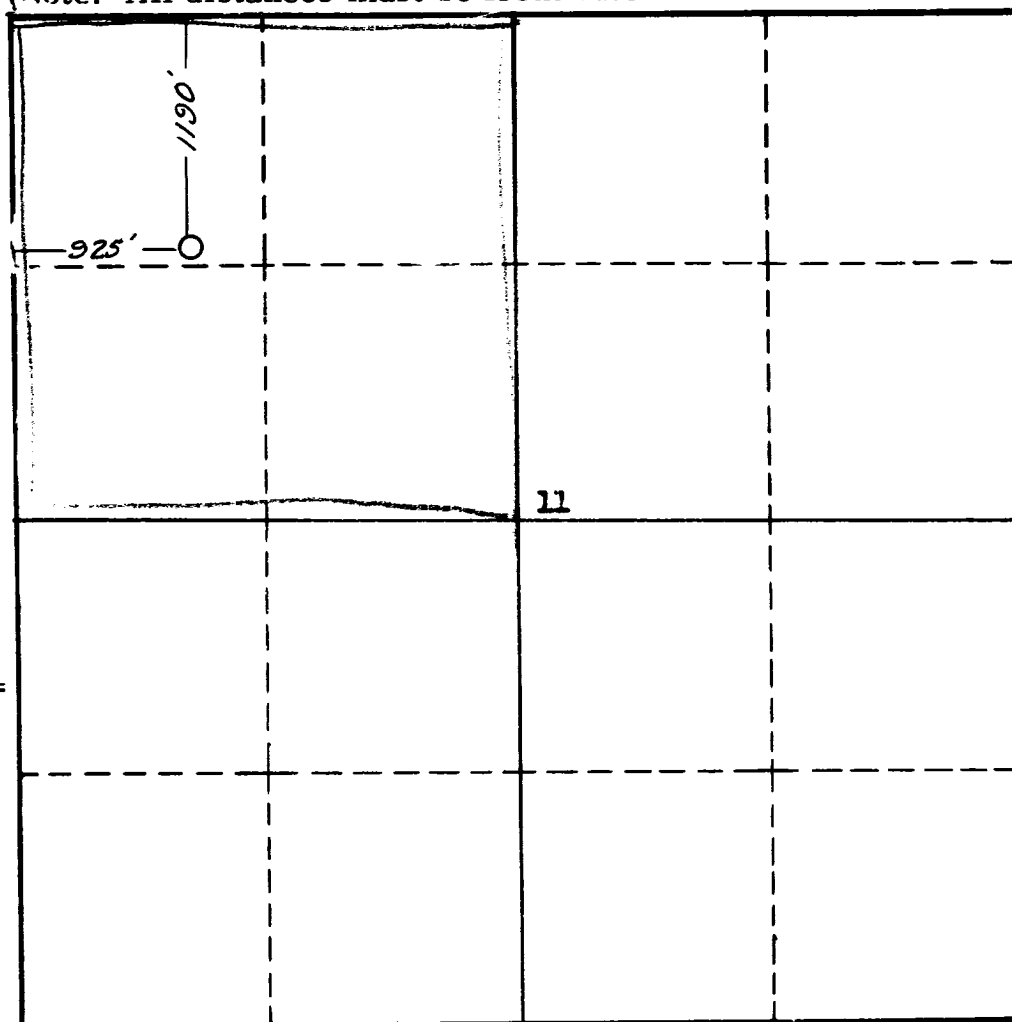

NOTE

This section of
form is to be
used for gas
wells only.



SCALE: 1"=1000'

1. Is this Well a Dual Comp. ? Yes ___ No x.
2. If the answer to Question 1 is yes, are there any other dually completed wells within the dedicated acreage? Yes ___ No ___.

Name E. W. Bennett
Position Drilling Supt.
Representing San Juan Gas Corporation
Address 1716 First Nat'l Bldg. Tulsa, Oklahoma

This is to certify that the above plat was prepared from field notes of actual surveys made by me or under my supervision and that the same are true and correct to the best of my knowledge and belief.

Date Surveyed 22 JULY 1956
James P. Leese
Registered Professional Engineer and/or
Land Surveyor James P. Leese
N. Mex. Reg. No. 1463

OIL CONSERVATION COMMISSION		
AZTEC DISTRICT OFFICE		
No. Copies Received <u>5</u>		
DISTRIBUTION		
	NO.	
	EX-100-5122	
Coordinator	<u>1</u>	
Santa Fe	<u>1</u>	
Promotion Office		
State Land Office		
U. S. G. S.	<u>2</u>	
Transporter		
File	<u>1</u>	<u>✓</u>