

(SUBMIT IN TRIPLICATE)

UNITED STATES
DEPARTMENT OF THE INTERIOR
GEOLOGICAL SURVEY

Land Office **Santa Fe**
Lease No. **S. F. 101397**
Unit _____

SUNDRY NOTICES AND REPORTS ON WELLS

NOTICE OF INTENTION TO DRILL.....	<input checked="" type="checkbox"/>	SUBSEQUENT REPORT OF WATER SHUT-OFF.....
NOTICE OF INTENTION TO CHANGE PLANS.....		SUBSEQUENT REPORT OF SHOOTING OR ACIDIZING.....
NOTICE OF INTENTION TO TEST WATER SHUT-OFF.....		SUBSEQUENT REPORT OF ALTERING CASING.....
NOTICE OF INTENTION TO RE-DRILL OR REPAIR WELL.....		SUBSEQUENT REPORT OF RE-DRILLING OR REPAIR.....
NOTICE OF INTENTION TO SHOOT OR ACIDIZE.....		SUBSEQUENT REPORT OF ABANDONMENT.....
NOTICE OF INTENTION TO PULL OR ALTER CASING.....		SUPPLEMENTARY WELL HISTORY.....
NOTICE OF INTENTION TO ABANDON WELL.....		

(INDICATE ABOVE BY CHECK MARK NATURE OF REPORT, NOTICE, OR OTHER DATA)

November 30, 1956

Well No. **Fed. 10-C** is located **1010** ft. from **N** line and **1340** ft. from **E** line of sec. **10**

NW/4 **Sec. 10** **25N** **2W** **New Mexico Prime**
(1/4 Sec. and Sec. No.) (Twp.) (Range) (Meridian)
Gavilan **Rio Arriba County** **New Mexico**
(Field) (County or Subdivision) (State or Territory)

The elevation of the ~~mountain~~ ^{ground level} above sea level is **7432.6** ft.

DETAILS OF WORK

(State names of and expected depths to objective sands; show sizes, weights, and lengths of proposed casings; indicate mudding jobs, cementing points, and all other important proposed work)

Approximately 100 feet of 8-5/8" - 20lb., surface casing.

Approximately 3600 feet of 4-1/2" - 16.60 lb., production casing.

Cement both surface and production casing.

Mud up for surface.



I understand that this plan of work must receive approval in writing by the Geological Survey before operations may be commenced.

Company **SAN JUAN GAS CORPORATION**

Address **1716 First National Building**

Tulsa, Oklahoma

By **Robert C. Penson**

Title **Vice President**

RC Lamar



NEW MEXICO
OIL CONSERVATION COMMISSION

JUL 24 1956

Form C-128

Well Location and/or Gas Proration Plat

Date November 30, 1954

Operator San Juan Gas Corporation Lease Santa Fe 001307

Well No. Fed. 10-C Section 10 Township 25 North Range 2 West NMPM

Located 1010 Feet From North Line, 1540 Feet From West Line,

Rio Arriba County, New Mexico. G. L. Elevation 7432.6

Name of Producing Formation Pictured Cliffs Pool Gavilan Dedicated Acreage 160

(Note: All distances must be from outer boundaries of Section)

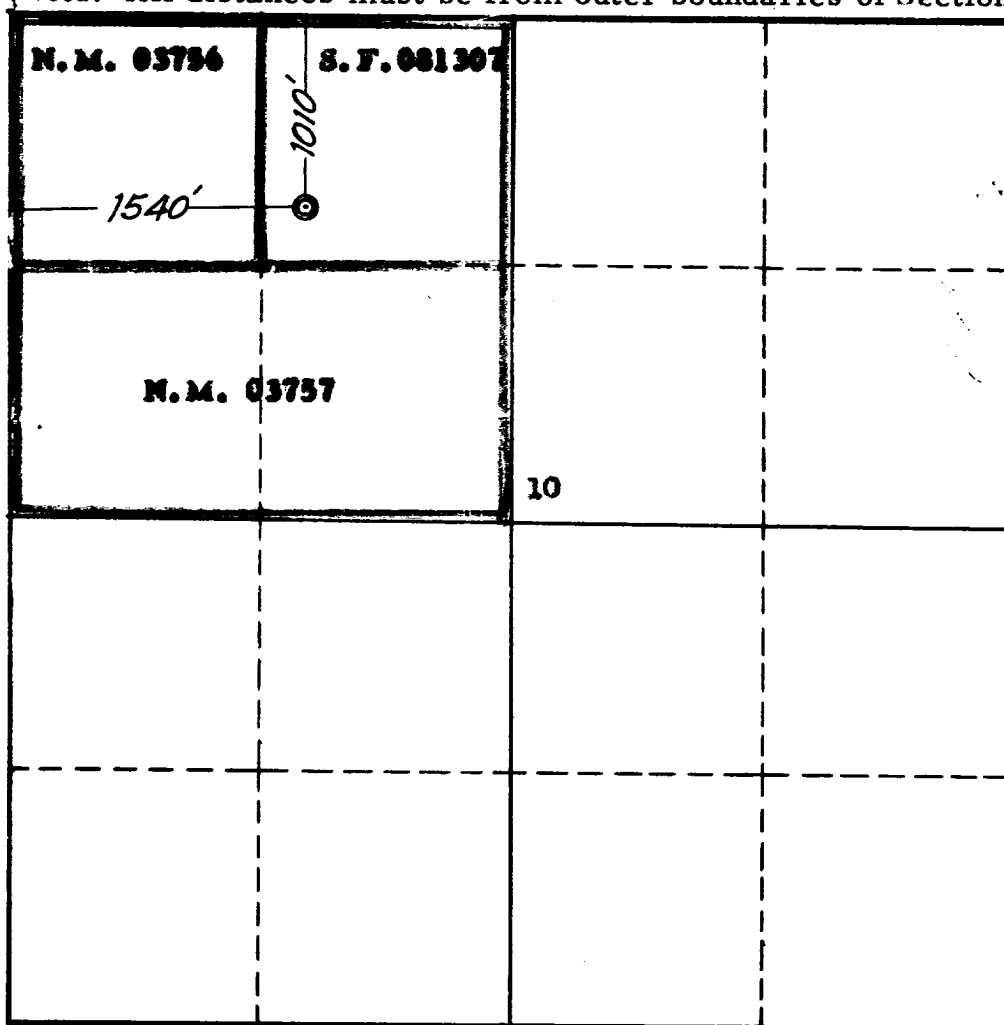

NOTE

This section of form is to be used for gas wells only.



SCALE: 1"=1000'

1. Is this Well a Dual Comp. ? Yes ___ No X.
2. If the answer to Question 1 is yes, are there any other dually completed wells within the dedicated acreage? Yes ___ No ___.

Name Robert C. Hanson
Position Vice President
Representing San Juan Gas Corporation
Address 1716 First National Building
Tulsa, Oklahoma

This is to certify that the above plat was prepared from field notes of actual surveys made by me or under my supervision and that the same are true and correct to the best of my knowledge and belief.

Date Surveyed July 22, 1956
James P. Lessor
Registered Professional Engineer and/or
Land Surveyor James P. Lessor
Reg. No. 1463 New Mex.