

District I
P.O. Box 1980, Hobbs, NM

District II
P.O. Drawer DD, Artesia, NM 88221

District III
1000 Rio Brazos Rd, Aztec, NM 87410

State of New Mexico
Energy, Minerals and Natural Resources Department

OIL CONSERVATION DIVISION

2040 South Pacheco Street
Santa Fe, New Mexico 87505

SUBMIT 1 COPY TO:
APPROPRIATE
DISTRICT OFFICE
AND 1 COPY TO
SANTA FE OFFICE

RECEIVED
APR 29 1999

PIT REMEDIATION AND CLOSURE REPORT

OIL CON. DIV.
DIST. 3

Operator: PNM Gas Services (Williams)		Telephone: 324-3764	
Address: 603 W. Elm Street Farmington, NM 87401			
Facility or Well Name: McCroden B #1 Drip			
Location:	Unit <u>K</u>	Sec <u>4</u>	T <u>25 N</u> R <u>3 W</u> County <u>Rio Arriba</u>
Pit Type:	Separator <input type="checkbox"/>	Dehydrator <input type="checkbox"/>	Other <u>Manual drip blowdown.</u>
Land Type:	BLM <input type="checkbox"/>	State <input type="checkbox"/>	Fee <input checked="" type="checkbox"/> Other <u> </u>
Pit Location:	Pit dimensions: length <u>18</u> ' width <u>18</u> ' depth <u>3</u> '		
(Attach diagram)	Reference:	wellhead <input type="checkbox"/>	other <u>Drip stand pipe.</u>
Footage from reference:		<u>9'</u>	
Direction from reference:		<u>45</u> Degrees <input type="checkbox"/> East <input checked="" type="checkbox"/> North <input checked="" type="checkbox"/> South <input type="checkbox"/> West <input checked="" type="checkbox"/>	
Depth to Ground Water:			
(Vertical distance from contaminants to seasonal high water elevation of ground water)	Less than 50 feet	(20 points)	
	50 feet to 99 feet	(10 points)	
	Greater than 100 feet	(0 points)	<u>0</u>
Wellhead Protection Area:			
(Less than 200 feet from a private domestic water source, or; less than 1,000 feet from all other water sources)	Yes	(20 points)	
	No	(0 points)	<u>0</u>
Distance to Surface Water:			
(Horizontal distance to perennial lakes, ponds, rivers, streams, creeks, irrigation canals and ditches)	Less than 200 feet	(20 points)	
	200 feet to 1,000 feet	(10 points)	
	Greater than 1,000 feet	(0 points)	<u>0</u>
RANKING SCORE (TOTAL POINTS):			<u>0</u>

McCroden B #1 Drip

Date Remediation Started: 1/25/99 Date Completed: 1/25/99

Remediation Method: Excavation X Approx. Cubic Yard 149
(Check all appropriate sections) Landfarmed _____ Amount Landfarmed (cubic yds) _____
Other _____

Remediation Location: Onsite _____ Offsite 149 cu yds hauled to TNT Landfarm.
(i.e., landfarmed onsite, name and location of offsite facility)

Backfill Material Location: _____

General Description of Remedial Action:

Excavated contaminated soil to a pit size of 18' X 16' X 14' and transported soil to an offsite commercial landfarm.

Ground Water Encountered: No ☒ Yes ☐ Depth _____

Final Pit Closure Sampling:

Sample Location Bottom of excavation.

(if multiple samples, attach sample result and diagram of sample locations and depths.)

Sample depth 14'

Sample date 1/25/99 Sample time 1:45:00 PM

Sample Results

Benzene (ppm) < 0.0010

Total BTEX (ppm) 0.0108

Field headspace (ppm) _____

TPH (ppm) < 25.00 Method 8015A

Vertical Extent (ft) _____ Risk Analysis form attached Yes ☐ No ☒

Ground Water Sample: Yes ☐ No ☒ (If yes, see attached Groundwater Site Summary Report)

I HEREBY CERTIFY THAT THE INFORMATION ABOVE IS TRUE AND COMPLETE TO THE BEST OF MY KNOWLEDGE AND MY BELIEF

DATE April 27, 1999

SIGNATURE Maureen Gannon

PRINTED NAME **Maureen Gannon**
AND TITLE **Project Manager**

McCroden B1 Drip
(K) 4-25N-3W
WFS
1-26-99

91
N

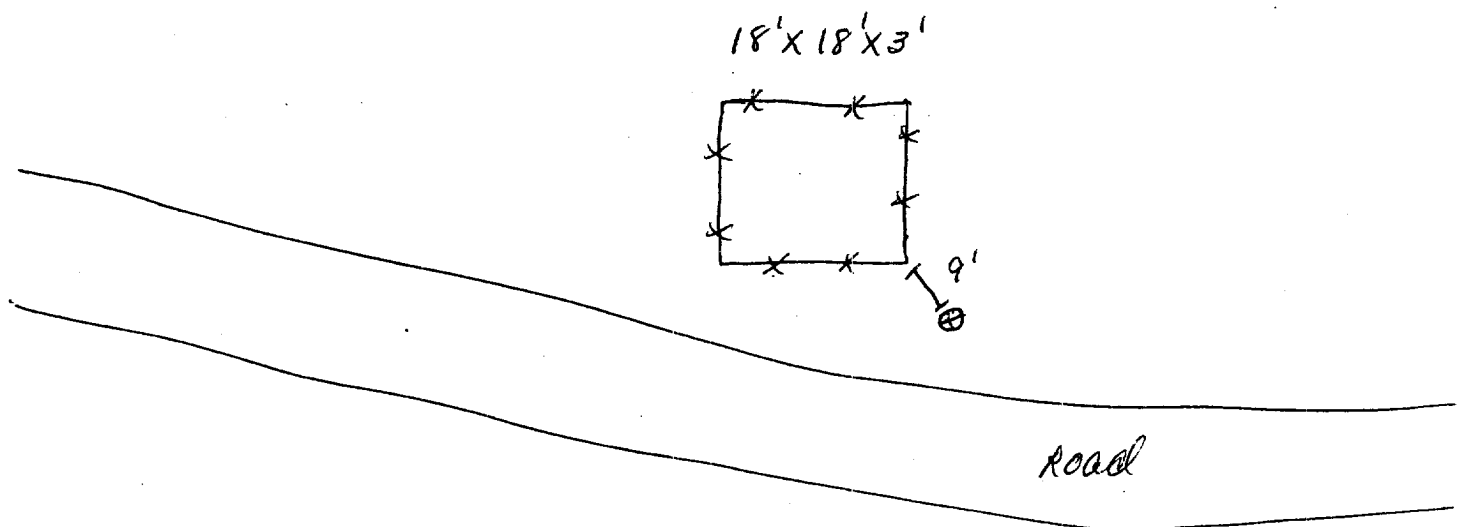

Excavation sampling

18'(N+S) x 16'(E+W) x 14'(D)

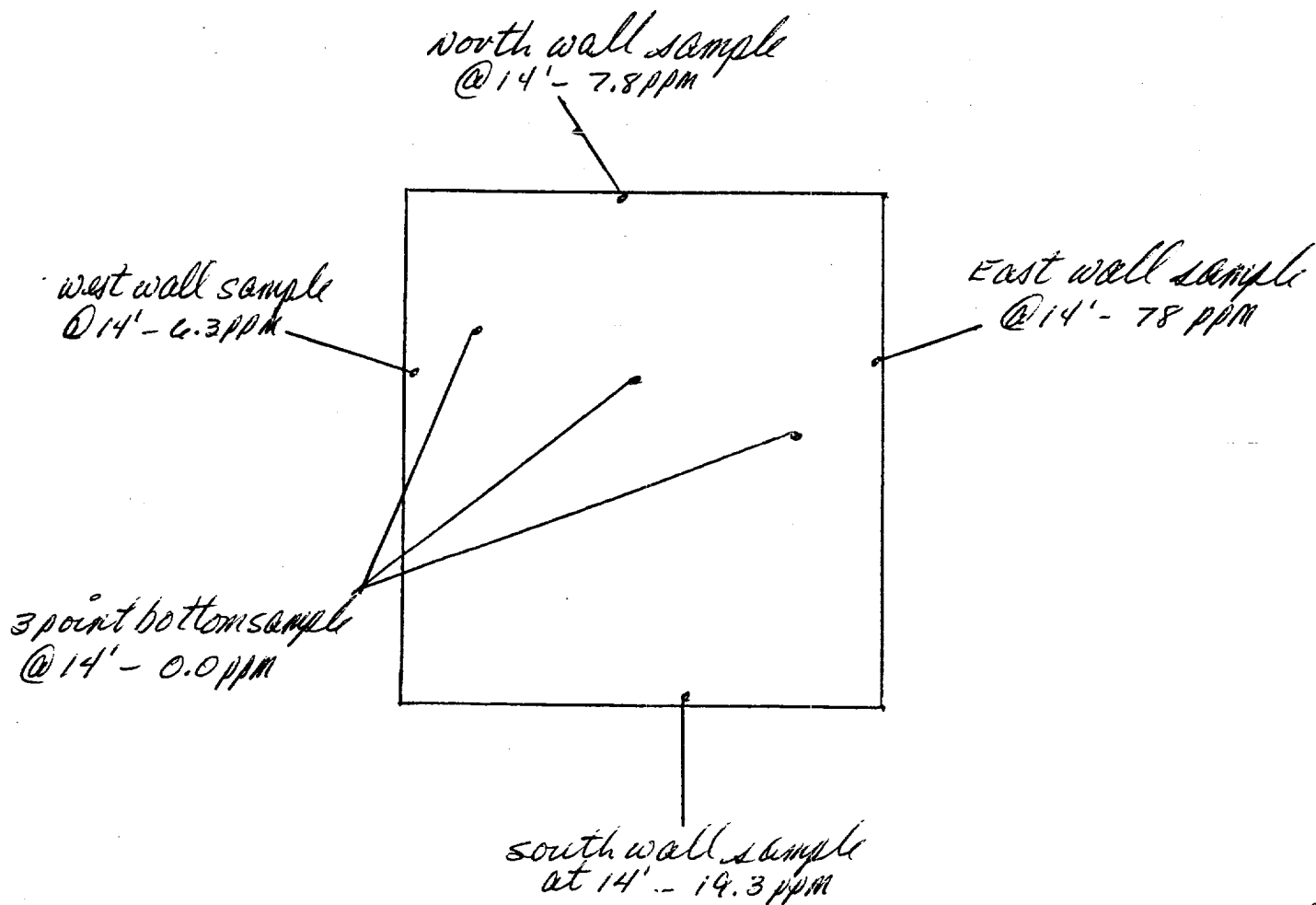

not to scale

OFF: (505) 325-5667



LAB: (505) 325-1556

On Site Technologies, LTD.

Date: 22-Feb-99

CLIENT: PNM - Public Service Company of NM
Project: McCroden B1 Drip
Lab Order: 9901025

CASE NARRATIVE

Analytical Comments for METHOD BTEX_S, SAMPLE 9901025-02A, McCroden B1 Drip 4 Wall Comp.: The reported results for m,p-Xylene and o-Xylene have an attached Qualifier (E), Value above Upper Quantitation Limit. Upon duplicate re-analyses it was observed the sample had lower amounts of volatile compounds, compared to original analysis. The loss of volatile compounds is suspect to sample analysis preparation and/or biological degradation, and therefore the original analysis is to be reported. Samples were analyzed using the methods outlined in the following references:

Test Methods for Evaluating Solid Waste, Physical/Chemical Methods, SW846, 3rd Edition

All method blanks, laboratory spikes, and/or matrix spikes met quality assurance objectives.

OFF: (505) 325-5667



LAB: (505) 325-1556

ANALYTICAL REPORT

Date: 22-Feb-99

Client:	PNM - Public Service Company of NM	Client Sample Info:	McCroden B1 Drip
Work Order:	9901025	Client Sample ID:	9901251345; 3pt. Bottom Comp.
Lab ID:	9901025-01A	Matrix:	SOIL
Project:	McCroden B1 Drip	Collection Date:	1/25/99 1:45:00 PM
		COC Record:	5780

Parameter	Result	PQL	Qual	Units	DF	Date Analyzed
DIESEL RANGE ORGANICS						
T/R Hydrocarbons: C10-C28	ND	25		mg/Kg	1	2/18/99
BTEX						
Benzene	ND	1		µg/Kg	1	1/29/99
Toluene	4	2		µg/Kg	1	1/29/99
Ethylbenzene	ND	1		µg/Kg	1	1/29/99
m,p-Xylene	5.1	2		µg/Kg	1	1/29/99
o-Xylene	1.7	1		µg/Kg	1	1/29/99

10.8
0.0108 ppm

Qualifiers:	PQL - Practical Quantitation Limit	S - Spike Recovery outside accepted recovery limits
	ND - Not Detected at Practical Quantitation Limit	R - RPD outside accepted recovery limits
	J - Analyte detected below Practical Quantitation Limit	E - Value above quantitation range
	B - Analyte detected in the associated Method Blank	Surrogate - Surrogate

P.O. BOX 2606 • FARMINGTON, NM 87499

- TECHNOLOGY BLENDING INDUSTRY WITH THE ENVIRONMENT -

OFF: (505) 325-5667



LAB: (505) 325-1556

ANALYTICAL REPORT

Date: 22-Feb-99

Client:	PNM - Public Service Company of NM	Client Sample Info:	McCroden B1 Drip
Work Order:	9901025	Client Sample ID:	9901251350; 4pt. Wall Comp.
Lab ID:	9901025-02A	Matrix:	SOIL
Project:	McCroden B1 Drip	Collection Date:	1/25/99 1:50:00 PM
		COC Record:	5780

Parameter	Result	PQL	Qual	Units	DF	Date Analyzed
DIESEL RANGE ORGANICS		SW8015				Analyst: HR
T/R Hydrocarbons: C10-C28	ND	25		mg/Kg	1	2/18/99
BTEX		SW8021B				Analyst: HR
Benzene	ND	1		µg/Kg	1	1/29/99
Toluene	67	2		µg/Kg	1	1/29/99
Ethylbenzene	62	1		µg/Kg	1	1/29/99
m,p-Xylene	380	2	E	µg/Kg	1	1/29/99
o-Xylene	280	1	E	µg/Kg	1	1/29/99

Qualifiers:

PQL - Practical Quantitation Limit

ND - Not Detected at Practical Quantitation Limit

J - Analyte detected below Practical Quantitation Limit

B - Analyte detected in the associated Method Blank

S - Spike Recovery outside accepted recovery limits

R - RPD outside accepted recovery limits

E - Value above quantitation range

Surr: - Surrogate

P.O. BOX 2606 • FARMINGTON, NM 87499

1 of 1