

DEPUTY OIL & GAS INSPECTOR

FEB 08 1999

**JICARILLA APACHE TRIBE**  
**ENVIRONMENTAL PROTECTION OFFICE**

**P.O. BOX 507  
DULCE, NEW MEXICO 87528**

SUBMIT 1 COPY TO  
NATURAL  
RESOURCE DEPT  
AND OIL -GAS  
ADMINISTRATION

# PIT REMEDIATION AND CLOSURE REPORT

Operator: PNM Gas Services ( *CONOCO* ) Telephone: 324-3764

**Address:** 603 W. Elm Street Farmington, NM 87401

Facility or Well Name: Aki Anache J9

**Location:** Unit: 0 Sec. 6 T. 25 N R. 5 W County Rio Arriba

**Pit Type:**      Separator      ☒      Dehydrator      ☐      Other      ☐

**Land Type:** Jicarilla Apache

**Pit Location:** Pit dimensions: length 15' width 15' depth 3'

(Attach diagram)      Reference:      wellhead ☒      other ☐

Footage from reference: 36'

Direction from reference: 72 Degrees N East of North N  
West of South

**Depth to Ground Water:**

(Vertical distance from contaminants to seasonal high water elevation of ground water)

Less than 50 feet	(20 points)
50 feet to 99 feet	(10 points)
Greater than 100 feet	( 0 points)

**Wellhead Protection Area:**

(Less than 200 feet from a private domestic water source, or, less than 1,000 feet from all other water sources)

Yes (20 points)  
No ( 0 points)

**Distance to Surface Water:**

(Horizontal distance to perennial lakes, ponds, rivers, streams, creeks, irrigation canals and ditches)

Less than 200 feet	(20 points)
200 feet to 1,000 feet	(10 points)
Greater than 1,000 feet	( 0 points)

**Distance to Ephemeral Stream (dry wash):**

(Horizontal distance to all downgradient streams having a width of at least 10 feet)

Less than or equal to 100 feet	(10 points)
Greater than 100 feet	(0 points)

Distance to Nearest Lake, Playa, or Watering Pond:

(Horizontal distance to all downgradient lakes, playas, and livestock or wildlife water ponds)

Less than or equal to 100 feet	(10 points)
Greater than 100 feet	(0 points)

**RANKING SCORE (TOTAL POINTS) :**

Date Remediation Started: 7-20-98 Date Completed: 9/3/98  
Remediation Method: Excavation X Approx. Cubic Yards 924.44  
(Check all appropriate sections) Landfarmed X Amount Landfarmed (cubic yds): 924.44  
Other \_\_\_\_\_

Remediation Location: Onsite 462.22 yds Offsite on J22A-6-25N-5W(0)  
(i.e., landfarmed onsite, name and location of offsite facility) 462.22 yds

General Description of Remedial Action:

Removed contaminated soil from all four side walls as to get a below 100 ppm head space reading. Bottom is rock  
Final excavation dimensions: 39'(E+W) X 32'(N+S) X 20'(D)

Ground Water Encountered: No X Yes \_\_\_\_\_ Depth \_\_\_\_\_

Final Pit Closure Sampling:

(if multiple samples, attach sample result and diagram of sample locations and depths.)

Sample Location North, East, South, and West side walls and 3 point composite of bottom

Sample depth 20'

Sample date 7-21-98 Sample time 1525 1510

Sample Results

Soil: Benzene (ppm) .28 Water: Benzene (ppb) \_\_\_\_\_

Total BTEX (ppm) 27.98 32.48 (K5) Toluene (ppb) \_\_\_\_\_

Field headspace (ppm) 1994 Ethylbenzene (ppb) \_\_\_\_\_

TPH 37 ppm Method 8015 Total Xylenes (ppb) \_\_\_\_\_

Ground Water Sample: Yes \_\_\_\_\_ No X (If yes, attach sample results)

I HEREBY CERTIFY THAT THE INFORMATION ABOVE IS TRUE AND COMPLETE TO THE BEST OF MY KNOWLEDGE AND MY BELIEF

DATE 8-17-98

PRINTED NAME ~~Roy Burnham~~ Ray Haston

SIGNATURE Ray Haston

AND TITLE Environmental Technician II

AFTER REVIEW OF THE PIT CLOSURE INFORMATION, PIT CLOSURE IS APPROVED IN ACCORDANCE TO JICARILLA APACHE TRIBE PIT CLOSURE ORDINANCE.

APPROVED: YES X NO \_\_\_\_\_ (REASON): \_\_\_\_\_

SIGNED: Kate C M... DATE: 8-18-98

↑  
N

AKI Apache J#9  
7-20-98  
6-25N-5W unit D  
CONOCO

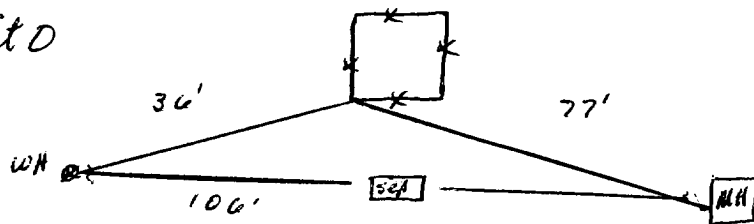

AKI Apache J#9  
7-21-98  
Excavation sampling

39 (E+W) X 32 (N+S) X 20 (D)

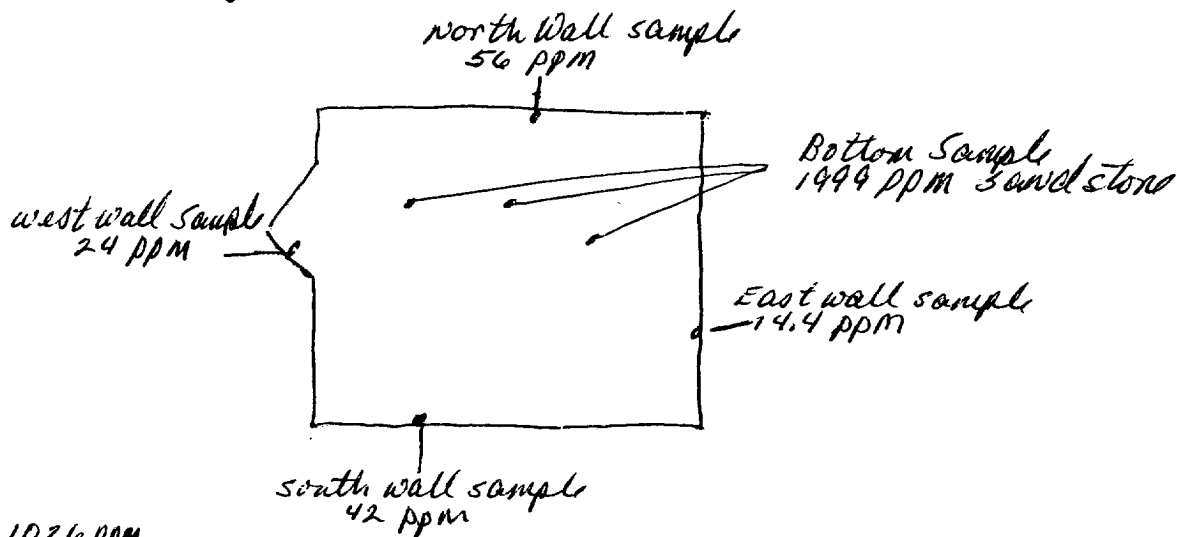

5' sample 1026 ppm  
10' sample 860 ppm  
15' sample 1902 ppm  
20' sample 1405 ppm (Rock)

not to scale

OFF: (505) 325-5667



LAB: (505) 325-1556

**On Site Technologies, LTD.**

**Date:** 04-Aug-98

---

**CLIENT:** PNM - Public Service Company of NM  
**Project:** PNM Pit Remediation  
**Lab Order:** 9807071

---

**CASE NARRATIVE**

Samples were analyzed using the methods outlined in the following references:

Test Methods for Evaluating Solid Waste, Physical/Chemical Methods, SW846, 3rd Edition

All method blanks, laboratory spikes, and/or matrix spikes met quality assurance objectives.

OFF: (505) 325-5667



LAB: (505) 325-1556

# ANALYTICAL REPORT

Date: 04-Aug-98

Client: PNM - Public Service Company of NM  
 Work Order: 9807071  
 Lab ID: 9807071-01A Matrix: SOIL  
 Project: PNM Pit Remediation

Client Sample Info: Axi Apache J9  
 Client Sample ID: 9807211510; J9 Bottom *3 pt. composite*  
 Collection Date: 7/21/98 3:10:00 PM  
 COC Record: 5232

Parameter	Result	PQL	Qual	Units	DF	Date Analyzed
<b>DIESEL RANGE ORGANICS</b>		<b>SW8015</b>				Analyst: HR
T/R Hydrocarbons: C10-C28	37	25		mg/Kg	1	7/30/98
<b>BTEX</b>		<b>SW8020A</b>				Analyst: DC
Benzene	280	250		µg/Kg	250	7/27/98
Toluene	3400	500		µg/Kg	250	7/27/98
Ethylbenzene	3900	250		µg/Kg	250	7/27/98
m,p-Xylene	20000	500		µg/Kg	250	7/27/98
o-Xylene	4900	250		µg/Kg	250	7/27/98

~~27,920~~  
 32,480  
 32.48 ppm

## Qualifiers:

PQL - Practical Quantitation Limit

ND - Not Detected at Practical Quantitation Limit

J - Analyte detected below Practical Quantitation Limit

B - Analyte detected in the associated Method Blank

S - Spike Recovery outside accepted recovery limits

R - RPD outside accepted recovery limits

E - Value above quantitation range

Surr: - Surrogate

1 of 1

P.O. BOX 2606 • FARMINGTON, NM 87499

- TECHNOLOGY BLENDING INDUSTRY WITH THE ENVIRONMENT -

OFF: (505) 325-5667



LAB: (505) 325-1556

## ANALYTICAL REPORT

Date: 04-Aug-98

**Client:** PNM - Public Service Company of NM  
**Work Order:** 9807071  
**Lab ID:** 9807071-02A     **Matrix:** SOIL  
**Project:** PNM Pit Remediation

**Client Sample Info:** Axi Apache J9  
**Client Sample ID:** 9807211525; J9 Walls *(composite of 4 walls)*  
**Collection Date:** 7/21/98 3:25:00 PM  
**COC Record:** 5232

Parameter	Result	PQL	Qual	Units	DF	Date Analyzed
<b>DIESEL RANGE ORGANICS</b>		<b>SW8015</b>				<b>Analyst: HR</b>
T/R Hydrocarbons: C10-C28	ND	25		mg/Kg	1	7/28/98

**Qualifiers:**  
PQL - Practical Quantitation Limit  
ND - Not Detected at Practical Quantitation Limit  
J - Analyte detected below Practical Quantitation Limit  
B - Analyte detected in the associated Method Blank

S - Spike Recovery outside accepted recovery limits  
R - RPD outside accepted recovery limits  
E - Value above quantitation range  
Surr: - Surrogate

1 of 1

P.O. BOX 2606 • FARMINGTON, NM 87499

- TECHNOLOGY BLENDING INDUSTRY WITH THE ENVIRONMENT -

JICARILLA APACHE TRIBE  
ENVIRONMENTAL  
PROTECTION OFFICE  
P.O. BOX 507  
DULCE, NEW MEXICO 87528

SUBMIT 1 COPY TO  
NATURAL  
RESOURCE DEPT  
AND OIL GAS  
ADMINISTRATION

ON-SITE SOIL REMEDIATION REPORT LF #1

Operator: PNM Gas Services ( CONOCO ) Telephone: 324-3764  
Address: 603 W. Elm Street Farmington, NM 87401  
Facility or Well Name: Aki Apache J9  
Location: Unit: 0 Sec. 6 T. 25 N. R. 5 W. County Rio Arriba  
Land Type: Jicarilla Apache

Date Remediation Started: 7-20-98 Date Completed: 8-21-98  
Remediation Method: Landfirmed X Approx. cubic yards 924 462  
Composted       
Other     

Depth to Ground Water: (pts.) 0  
Distance to an Ephemeral Stream: (pts.) 0  
Distance to Nearest Lake, Playa,  
or Watering Pond: (pts.) 0  
Wellhead Protection Area: (pts.) 0  
Distance to Surface Water: (pts.) 0  
Ranking Score (Total Points): 0

Final Closure Sampling:  
Sampling Date: 8-17-98 Time 1125  
Sampling Results:  
Field Headspace (ppm) 5.5  
TPH (ppm) ND Method 8015  
Other     

I HEREBY CERTIFY THAT THE INFORMATION ABOVE IS TRUE AND COMPLETE TO THE BEST OF MY KNOWLEDGE AND BELIEF

DATE 8-31-98 PRINTED NAME ~~Roy Burnham~~ Ray Haston  
SIGNATURE Ray Haston AND TITLE Environmental Technician II

AFTER REVIEW OF THE SOIL REMEDIATION INFORMATION, ON-SITE REMEDIATION APPROVED IN ACCORDANCE TO THE  
JICARILLA APACHE TRIBE PIT CLOSURE ORDINANCE

APPROVED: YES X NO      (REASON) use as Backfill  
SIGNED: Kenn C Mann DATE: 9-3-98

Ax: Apache J9 Land farm #1

O-6-25N-5W

Conoco

N  
↑

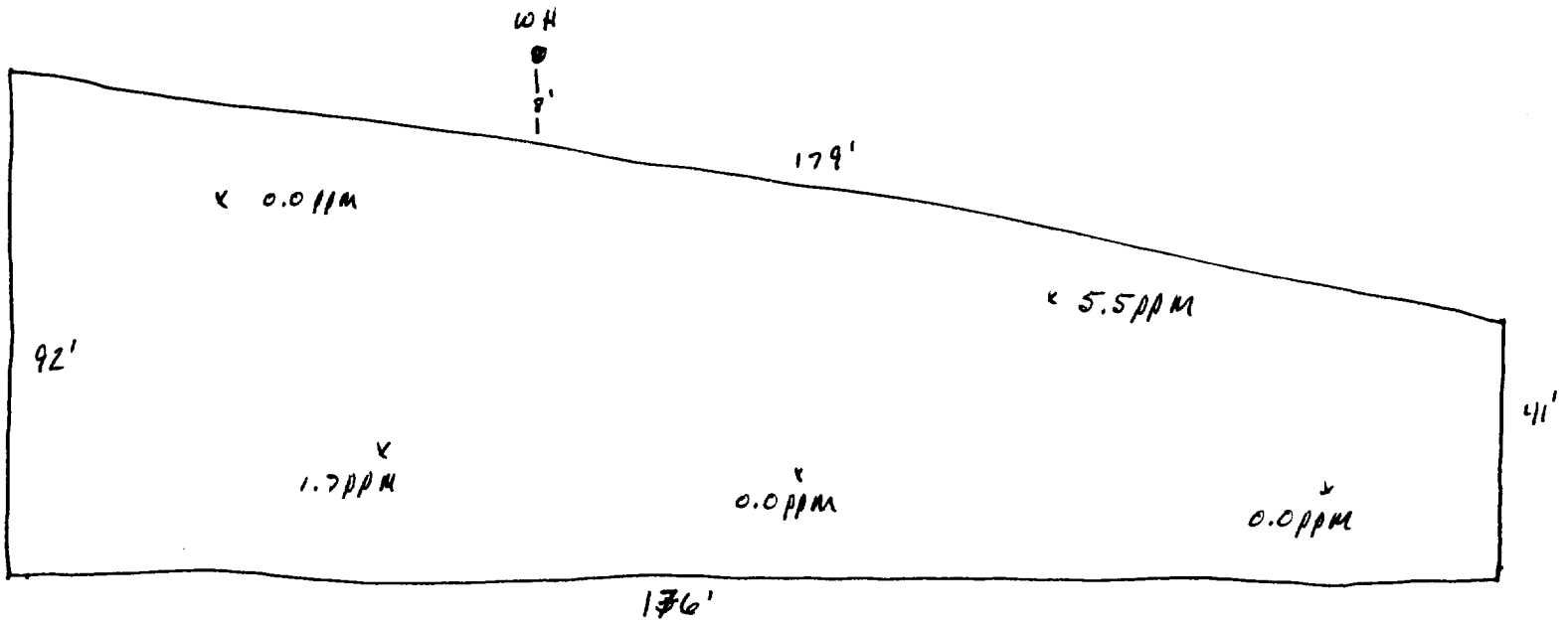

not to scale



OFF: (505) 325-5667



LAB: (505) 325-1556

**On Site Technologies, LTD.**

**Date:** 26-Aug-98

---

**CLIENT:** PNM - Public Service Company of NM

**Project:** PNM Pit Remediation

**Lab Order:** 9808036

## **CASE NARRATIVE**

---

Samples were analyzed using the methods outlined in the following references:

Test Methods for Evaluating Solid Waste, Physical/Chemical Methods, SW846, 3rd Edition

All method blanks, laboratory spikes, and/or matrix spikes met quality assurance objectives.

OFF: (505) 325-5667



LAB: (505) 325-1556

## ANALYTICAL REPORT

Date: 26-Aug-98

<b>Client:</b>	PNM - Public Service Company of NM	<b>Client Sample Info:</b>	Axi Apache J-9 #1 LF
<b>Work Order:</b>	9808036	<b>Client Sample ID:</b>	9808171125; 5pt. Comp.
<b>Lab ID:</b>	9808036-19A	<b>Matrix:</b>	SOIL
<b>Project:</b>	PNM Pit Remediation	<b>Collection Date:</b>	8/17/98 11:25:00 AM
		<b>COC Record:</b>	7333/34/35

Parameter	Result	PQL	Qual	Units	DF	Date Analyzed
<b>DIESEL RANGE ORGANICS</b>		<b>SW8015</b>				Analyst: HR
T/R Hydrocarbons: C10-C28	ND	25		mg/Kg	1	8/21/98

<b>Qualifiers:</b>	PQL - Practical Quantitation Limit	S - Spike Recovery outside accepted recovery limits
	ND - Not Detected at Practical Quantitation Limit	R - RPD outside accepted recovery limits
	J - Analyte detected below Practical Quantitation Limit	E - Value above quantitation range
	B - Analyte detected in the associated Method Blank	Surr: - Surrogate

1 of 1

P.O. BOX 2606 • FARMINGTON, NM 87499

- TECHNOLOGY BLENDING INDUSTRY WITH THE ENVIRONMENT -

SUBMIT 1 COPY TO  
NATURAL  
RESOURCE DEPT  
AND OIL GAS  
ADMINISTRATION

APPROVED: YES X NO        (REASON) USE as Backup

SIGNED: Kee C Mandle DATE: 9-3-98

Axi Apache J 4 LF \* 2  
on Axi Apache JZZA  
0-26N(0)-6-25N-6W  
CONOCO

↑  
N

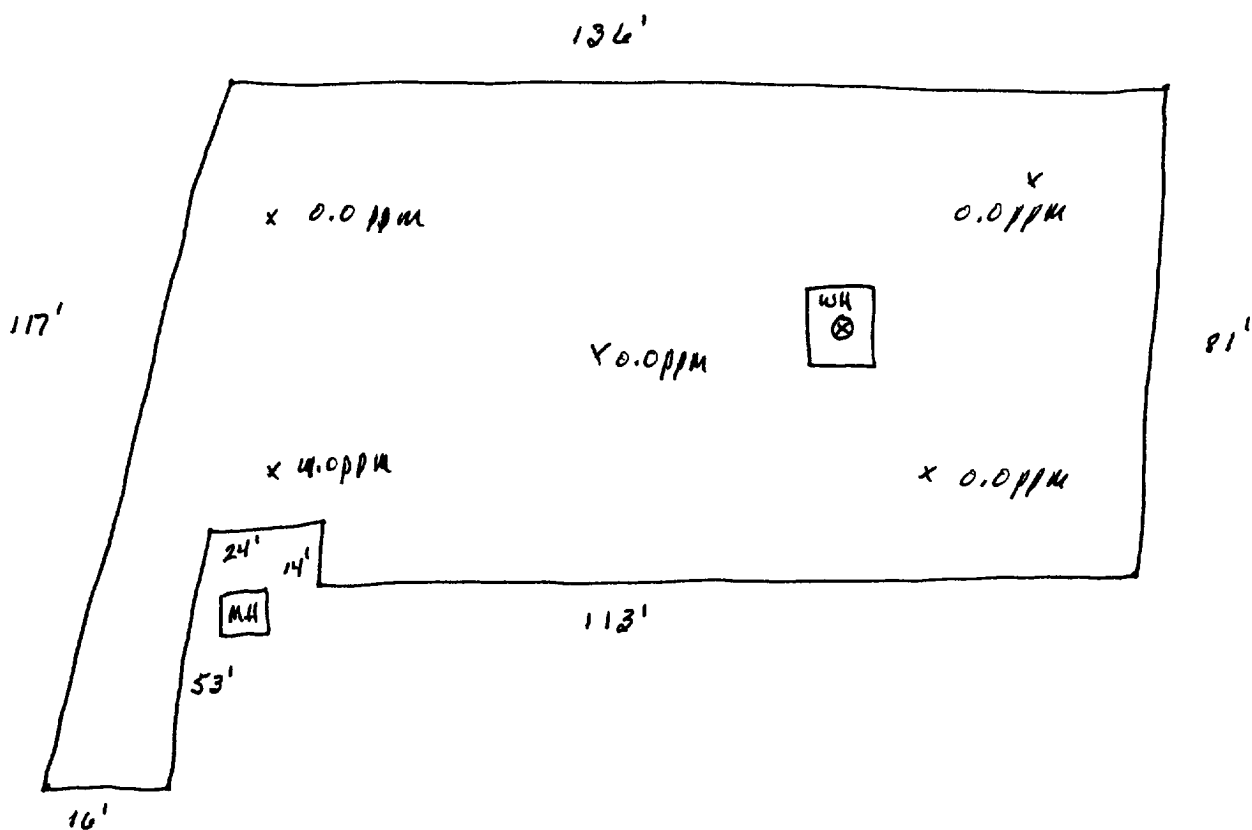

not to scale

OFF: (505) 325-5667



LAB: (505) 325-1556

**On Site Technologies, LTD.**

**Date:** 26-Aug-98

---

**CLIENT:** PNM - Public Service Company of NM  
**Project:** PNM Pit Remediation  
**Lab Order:** 9808036

---

## **CASE NARRATIVE**

Samples were analyzed using the methods outlined in the following references:

Test Methods for Evaluating Solid Waste, Physical/Chemical Methods, SW846, 3rd Edition

All method blanks, laboratory spikes, and/or matrix spikes met quality assurance objectives.

OFF: (505) 325-5667



LAB: (505) 325-1556

## ANALYTICAL REPORT

Date: 26-Aug-98

<b>Client:</b>	PNM - Public Service Company of NM	<b>Client Sample Info:</b>	Axi Apache J-9 #2 LF
<b>Work Order:</b>	9808036	<b>Client Sample ID:</b>	9808171132; 5pt. Comp.
<b>Lab ID:</b>	9808036-20A	<b>Matrix:</b>	SOIL
<b>Project:</b>	PNM Pit Remediation	<b>Collection Date:</b>	8/17/98 11:32:00 AM
		<b>COC Record:</b>	7333/34/35

Parameter	Result	PQL	Qual	Units	DF	Date Analyzed
<b>DIESEL RANGE ORGANICS</b>		<b>SW8015</b>				Analyst: HR
T/R Hydrocarbons: C10-C28	ND	25		mg/Kg	1	8/21/98

**Qualifiers:**

PQL - Practical Quantitation Limit

ND - Not Detected at Practical Quantitation Limit

J - Analyte detected below Practical Quantitation Limit

B - Analyte detected in the associated Method Blank

S - Spike Recovery outside accepted recovery limits

R - RPD outside accepted recovery limits

E - Value above quantitation range

Surr: - Surrogate

1 of 1

P.O. BOX 2606 • FARMINGTON, NM 87499

- TECHNOLOGY BLENDING INDUSTRY WITH THE ENVIRONMENT -