

Denny E. Faust
DEPUTY OIL & GAS INSPECTOR

JICARILLA APACHE TRIBE

FEB 08 1999

ENVIRONMENTAL PROTECTION OFFICE

P.O. BOX 507
DULCE, NEW MEXICO 87528

SUBMIT 1 COPY TO
NATURAL
RESOURCE DEPT
AND OIL-GAS
ADMINISTRATION

04

Approved

PIT REMEDIATION AND CLOSURE REPORT

Operator: PNM Gas Services (*CONOCO*) Telephone: 324-3764

Address: 603 W. Elm Street Farmington, NM 87401

Facility or Well Name: *Axi Apache J1*

Location: Unit: *K* Sec. *5* T. *25* N R. *5* W County *Rio Arriba*

Pit Type: Separator ☐ Dehydrator ☐ Other *Drip blowdown*

Land Type: *Jicarilla Apache*

Pit Location: Pit dimensions: length *15'* width *15'* depth *3'*

(Attach diagram) Reference: wellhead *K* other ☐

Footage from reference: *15'*

Direction from reference: *88* Degrees *K* East North ☐
West of South *K*

Depth to Ground Water:

(Vertical distance from contaminants to seasonal high water elevation of ground water)

Less than 50 feet (20 points)
50 feet to 99 feet (10 points)
Greater than 100 feet (0 points)

Wellhead Protection Area:

(Less than 200 feet from a private domestic water source, or, less than 1,000 feet from all other water sources)

Yes (20 points)
No (0 points)

Distance to Surface Water:

(Horizontal distance to perennial lakes, ponds, rivers, streams, creeks, irrigation canals and ditches)

Less than 200 feet (20 points)
200 feet to 1,000 feet (10 points)
Greater than 1,000 feet (0 points)

Distance to Ephemeral Stream (dry wash):

(Horizontal distance to all downgradient streams having a width of at least 10 feet)

Less than or equal to 100 feet (10 points)
Greater than 100 feet (0 points)

Distance to Nearest Lake, Playa, or Watering Pond:

(Horizontal distance to all downgradient lakes, playas, and livestock or wildlife water ponds)

Less than or equal to 100 feet (10 points)
Greater than 100 feet (0 points)

RANKING SCORE (TOTAL POINTS):

0

RECEIVED
FEB - 1 1999
OIL CON. DIV.
DIST. 3

Date Remediation Started: 7-28-98 Date Completed: 11/2/98

Remediation Method: Excavation X Approx. Cubic Yards 758

(Check all appropriate sections)

Landfarmed X Amount Landfarmed (cubic yds): (758)

Other _____

Remediation Location: Onsite 289 yds on site Offsite 469 yds. still staged on site
(i.e., landfarmed onsite, name and location of offsite facility) Land farmed on Axi-Hem J-19A
289 yds
758 yds

General Description of Remedial Action:

Removed contaminated soil from all four sidewalls as to ge a below 100 ppm lead space reading. Bottom is rock.
Final excavation dimensions: 30'(N+S) X 31'(E+W) X 12' (D)

Ground Water Encountered: No X Yes _____ Depth _____

Final Pit Closure Sampling:

Sample Location North, East, South and West sidewalls and 3 point composite of bottom

(if multiple samples, attach sample result and diagram of sample locations and depths.)

Sample depth 22'

Sample date 7-29-98 Sample time 0755 0745 (rs)

Sample Results

Soil: Benzene (ppm) N/D Water: Benzene (ppb) _____

Total BTEX (ppm) 1.284 Toluene (ppb) _____

Field headspace (ppm) 1999 Ethylbenzene (ppb) _____

TPH N/D ppm Method 8015 Total Xylenes (ppb) _____

Ground Water Sample: Yes _____ No X (If yes, attach sample results)

I HEREBY CERTIFY THAT THE INFORMATION ABOVE IS TRUE AND COMPLETE TO THE BEST OF MY KNOWLEDGE AND MY BELIEF

DATE 8-17-98

PRINTED NAME Ray Haston

SIGNATURE Ray Haston

AND TITLE Environmental Technician

AFTER REVIEW OF THE PIT CLOSURE INFORMATION, PIT CLOSURE IS APPROVED IN ACCORDANCE TO JICARILLA APACHE TRIBE PIT CLOSURE ORDINANCE.

APPROVED: YES X NO _____ (REASON): _____

SIGNED: Kew C. M... DATE: 8-18-98

Axi Apache II

7-28-98

5-25N-5W unit K

CONOCO

N

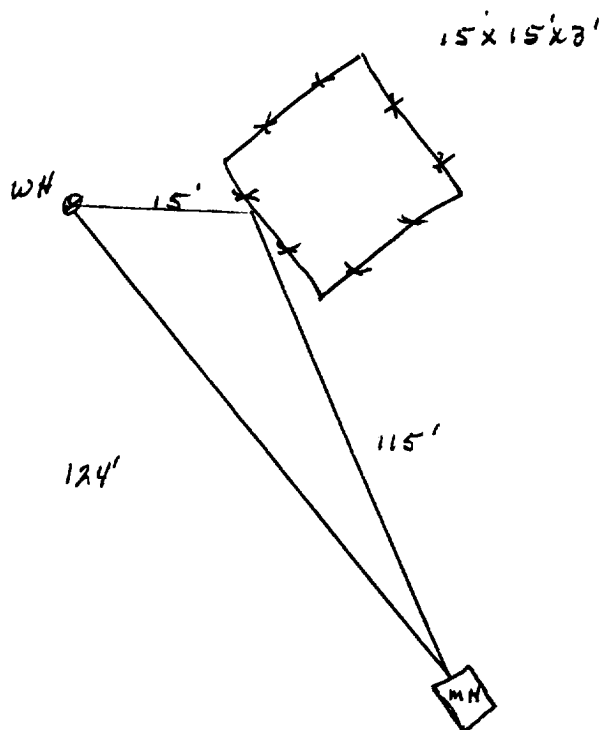

Excavation Sampling

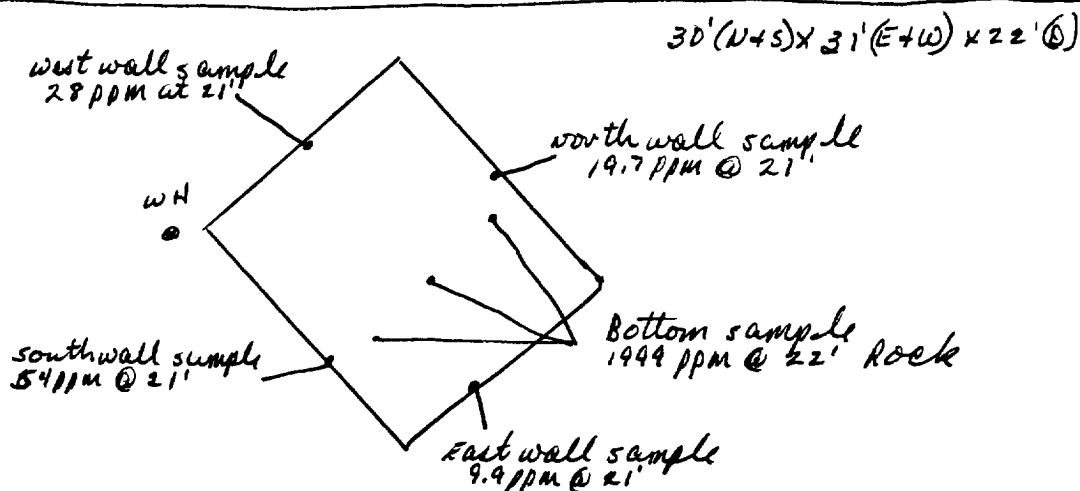

5' sample	935 ppm
10' sample	1012 ppm
15' sample	1487 ppm
20' sample	1863 ppm
22' sample	1754 ppm

drawings not to scale

OFF: (505) 325-5667



LAB: (505) 325-1556

On Site Technologies, LTD.

Date: 10-Aug-98

CLIENT: PNM - Public Service Company of NM

Project: PNM Pit Remediation

Lab Order: 9807086

CASE NARRATIVE

Samples were analyzed using the methods outlined in the following references:

Test Methods for Evaluating Solid Waste, Physical/Chemical Methods, SW846, 3rd Edition

All method blanks, laboratory spikes, and/or matrix spikes met quality assurance objectives.

OFF: (505) 325-5667



LAB: (505) 325-1556

ANALYTICAL REPORT

Date: 10-Aug-98

Client:	PNM - Public Service Company of NM	Client Sample Info:	Axi Apache J1
Work Order:	9807086	Client Sample ID:	9807290745; 3pt. Comp. Bottom
Lab ID:	9807086-01A	Matrix:	SOIL
Project:	PNM Pit Remediation	Collection Date:	7/29/98 7:45:00 AM
		COC Record:	5249

Parameter	Result	PQL	Qual	Units	DF	Date Analyzed
DIESEL RANGE ORGANICS		SW8015				Analyst: HR
T/R Hydrocarbons: C10-C28	ND	25		mg/Kg	1	8/5/98
BTEX		SW8020A				Analyst: HR
Benzene	ND	25		µg/Kg	25	8/6/98
Toluene	ND	50		µg/Kg	25	8/6/98
Ethylbenzene	94	25		µg/Kg	25	8/6/98
m,p-Xylene	820	50		µg/Kg	25	8/6/98
o-Xylene	370	25		µg/Kg	25	8/6/98
	1.284 ppm					

Qualifiers:

PQL - Practical Quantitation Limit

ND - Not Detected at Practical Quantitation Limit

J - Analyte detected below Practical Quantitation Limit

B - Analyte detected in the associated Method Blank

S - Spike Recovery outside accepted recovery limits

R - RPD outside accepted recovery limits

E - Value above quantitation range

Surr: - Surrogate

1 of 1

P.O. BOX 2606 • FARMINGTON, NM 87499

- TECHNOLOGY BLENDING INDUSTRY WITH THE ENVIRONMENT -

OFF: (505) 325-5667



LAB: (505) 325-1556

ANALYTICAL REPORT

Date: 10-Aug-98

Client:	PNM - Public Service Company of NM	Client Sample Info:	Axi Apache J1
Work Order:	9807086	Client Sample ID:	9807290755; Wall Comp.
Lab ID:	9807086-02A	Matrix:	SOIL
Project:	PNM Pit Remediation	Collection Date:	7/29/98 7:55:00 AM
		COC Record:	5249

Parameter	Result	PQL	Qual	Units	DF	Date Analyzed
DIESEL RANGE ORGANICS		SW8015				Analyst: HR
T/R Hydrocarbons: C10-C28	ND	25		mg/Kg	1	7/30/98

Qualifiers:

PQL - Practical Quantitation Limit
ND - Not Detected at Practical Quantitation Limit
J - Analyte detected below Practical Quantitation Limit
B - Analyte detected in the associated Method Blank

S - Spike Recovery outside accepted recovery limits
R - RPD outside accepted recovery limits
E - Value above quantitation range
Surr: - Surrogate

1 of 1

P.O. BOX 2606 • FARMINGTON, NM 87499

- TECHNOLOGY BLENDING INDUSTRY WITH THE ENVIRONMENT -

JICARILLA APACHE TRIBE
ENVIRONMENTAL
PROTECTION OFFICE
P.O. BOX 507
DULCE, NEW MEXICO 87528

SUBMIT 1 COPY TO
NATURAL
RESOURCE DEPT
AND OIL GAS
ADMINISTRATION

ON-SITE SOIL REMEDIATION REPORT LF #1

Operator: PNM Gas Services (<u>CONOCO</u>) Telephone: <u>324-3764</u>	
Address: <u>603 W. Elm Street Farmington, NM 87401</u>	
Facility or Well Name: <u>Axi Apache Jr</u>	
Location:	Unit: <u>K</u> Sec. <u>5</u> T. <u>25</u> N R. <u>5</u> W County <u>Rio Arriba</u>
Land Type:	<u>Jicarilla Apache</u>
Date Remediation Started: <u>7-28-98</u> Date Completed: <u>10-6-98</u>	
Remediation Method:	Landfamed <u>X</u> Approx. cubic yards <u>443 289 RAD</u>
	Composted <u>—</u>
	Other <u>—</u>
Depth to Ground Water: (pts.) <u>0</u>	Final Closure Sampling: Sampling Date: <u>9-30-98</u> Time <u>1244</u> Sampling Results: Field Headspace (ppm) <u>5.5</u> TPH (ppm) <u>N/D</u> Method <u>8015</u> Other <u>—</u>
Distance to an Ephemeral Stream: (pts.) <u>0</u>	
Distance to Nearest Lake, Playa, or Watering Pond: (pts.) <u>0</u>	
Wellhead Protection Area: (pts.) <u>0</u>	
Distance to Surface Water: (pts.) <u>0</u>	
Ranking Score (Total Points): <u>0</u>	
I HEREBY CERTIFY THAT THE INFORMATION ABOVE IS TRUE AND COMPLETE TO THE BEST OF MY KNOWLEDGE AND BELIEF	
DATE <u>10-24-98</u>	PRINTED NAME <u>Roy Burnham Ray Haston</u>
SIGNATURE <u>Ray Haston</u>	AND TITLE <u>Environmental Technician II</u>
AFTER REVIEW OF THE SOIL REMEDIATION INFORMATION, ON-SITE REMEDIATION APPROVED IN ACCORDANCE TO THE JICARILLA APACHE TRIBE PIT CLOSURE ORDINANCE	
APPROVED: YES <u>X</u> NO <u>—</u> (REASON) <u>42c or Beckfield</u>	
SIGNED: <u>Ken C McCall</u>	DATE: <u>11-2-98</u>

AX1 APACHE & FARMER TRAIL
(K) 5-25N-5W
CONOCO

↑
N

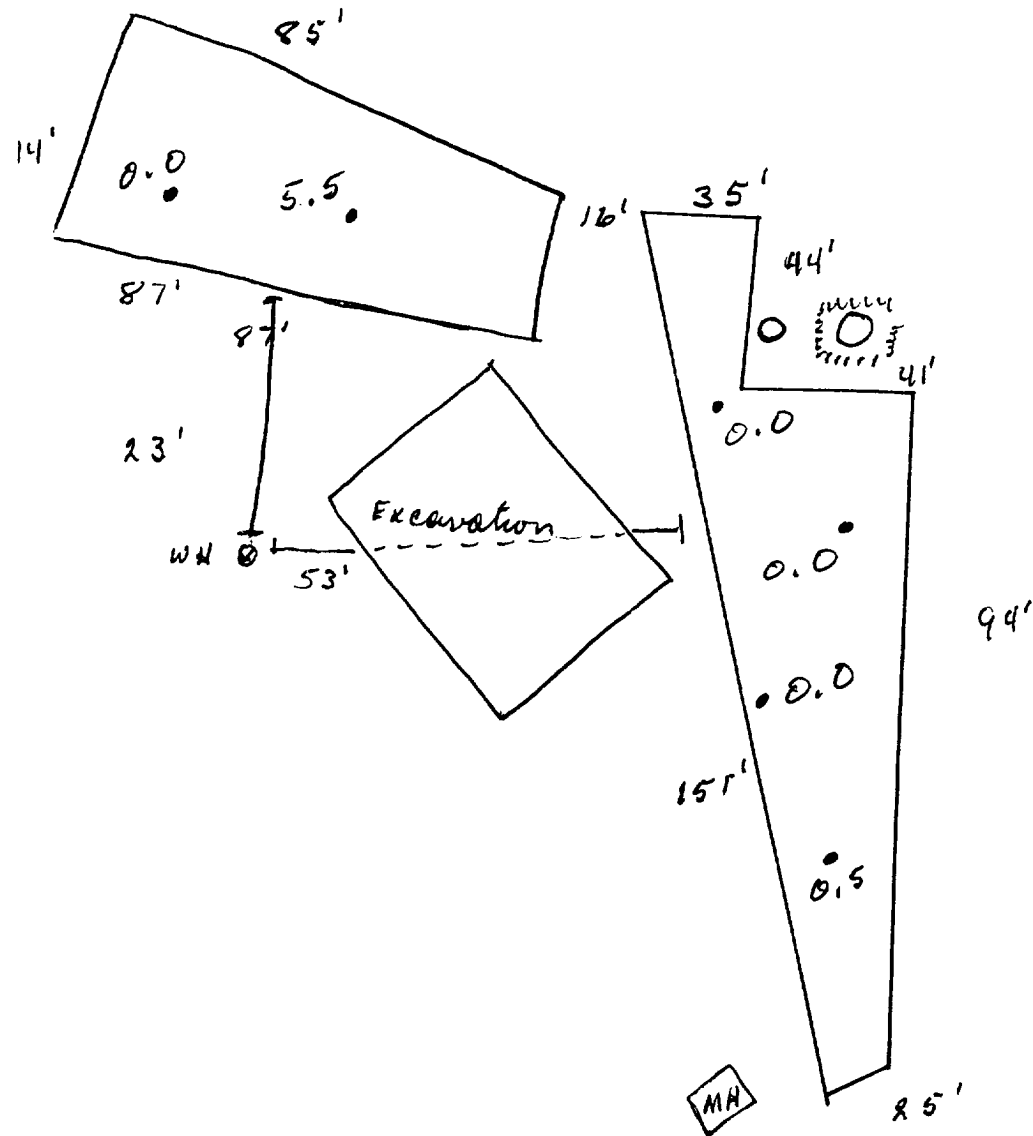

not to scale

OFF: (505) 325-5667



LAB: (505) 325-1556

ANALYTICAL REPORT

Date: 14-Oct-98

Client:	PNM - Public Service Company of NM	Client Sample Info:	Axi Apache J-1#1 LF
Work Order:	9810005	Client Sample ID:	9809301244; 6pt. Composite
Lab ID:	9810005-06A	Matrix:	SOIL
Project:	Jicarilla Landfarms	Collection Date:	9/30/98 12:44:00 PM
		COC Record:	7509

Parameter	Result	PQL	Qual	Units	DF	Date Analyzed
DIESEL RANGE ORGANICS		SW8015				Analyst: HR
T/R Hydrocarbons: C10-C28	ND	25		mg/Kg	1	10/6/98

Qualifiers:

PQL - Practical Quantitation Limit

ND - Not Detected at Practical Quantitation Limit

J - Analyte detected below Practical Quantitation Limit

B - Analyte detected in the associated Method Blank

S - Spike Recovery outside accepted recovery limits

R - RPD outside accepted recovery limits

E - Value above quantitation range

Surr: - Surrogate

1 of 1

P.O. BOX 2606 • FARMINGTON, NM 87499

- TECHNOLOGY BLENDING INDUSTRY WITH THE ENVIRONMENT -

JICARILLA APACHE TRIBE
ENVIRONMENTAL
PROTECTION OFFICE
P.O. BOX 507
DULCE, NEW MEXICO 87528

SUBMIT 1 COPY TO
NATURAL
RESOURCE DEPT
AND OIL GAS
ADMINISTRATION

ON-SITE SOIL REMEDIATION REPORT LF #2

Operator: PNM Gas Services (CONOCO) Telephone: 324-3764
Address: 603 W. Elm Street Farmington, NM 87401
Facility or Well Name: Axi Apache Jr
Location: Unit: K Sec. 5 T. 25 N. R. 5 W. County Rio Arriba
Land Type: Jicarilla Apache

Date Remediation Started: 7-28-98 Date Completed: 10-7-98
Remediation Method: Landfarmed X Approx. cubic yards ~~146~~ 469 RAO
Composted
Other

Depth to Ground Water: (pts.) 0
Distance to an Ephemeral Stream: (pts.) 0
Distance to Nearest Lake, Playa,
or Watering Pond: (pts.) 0
Wellhead Protection Area: (pts.) 0
Distance to Surface Water: (pts.) 0
Ranking Score (Total Points): 0

Final Closure Sampling:
Sampling Date: 9-30-98 Time 1256
Sampling Results:
Field Headspace (ppm) 30.3
TPH (ppm) N/D Method 9015
Other

I HEREBY CERTIFY THAT THE INFORMATION ABOVE IS TRUE AND COMPLETE TO THE BEST OF MY KNOWLEDGE AND BELIEF

DATE 10-24-98 PRINTED NAME ~~Ray Burnham~~ Ray Huston
SIGNATURE Ray Huston AND TITLE Environmental Technician II

AFTER REVIEW OF THE SOIL REMEDIATION INFORMATION, ON-SITE REMEDIATION APPROVED IN ACCORDANCE TO THE
JICARILLA APACHE TRIBE PIT CLOSURE ORDINANCE

APPROVED: YES X NO (REASON) use as Backfill
SIGNED: Ken C Moulle DATE: 11-2-98

Axi Apache J-1
Conoco
Sec. 5, 25N, 5W, K

9/2/98

Landfarm: Axi Apache J-19A

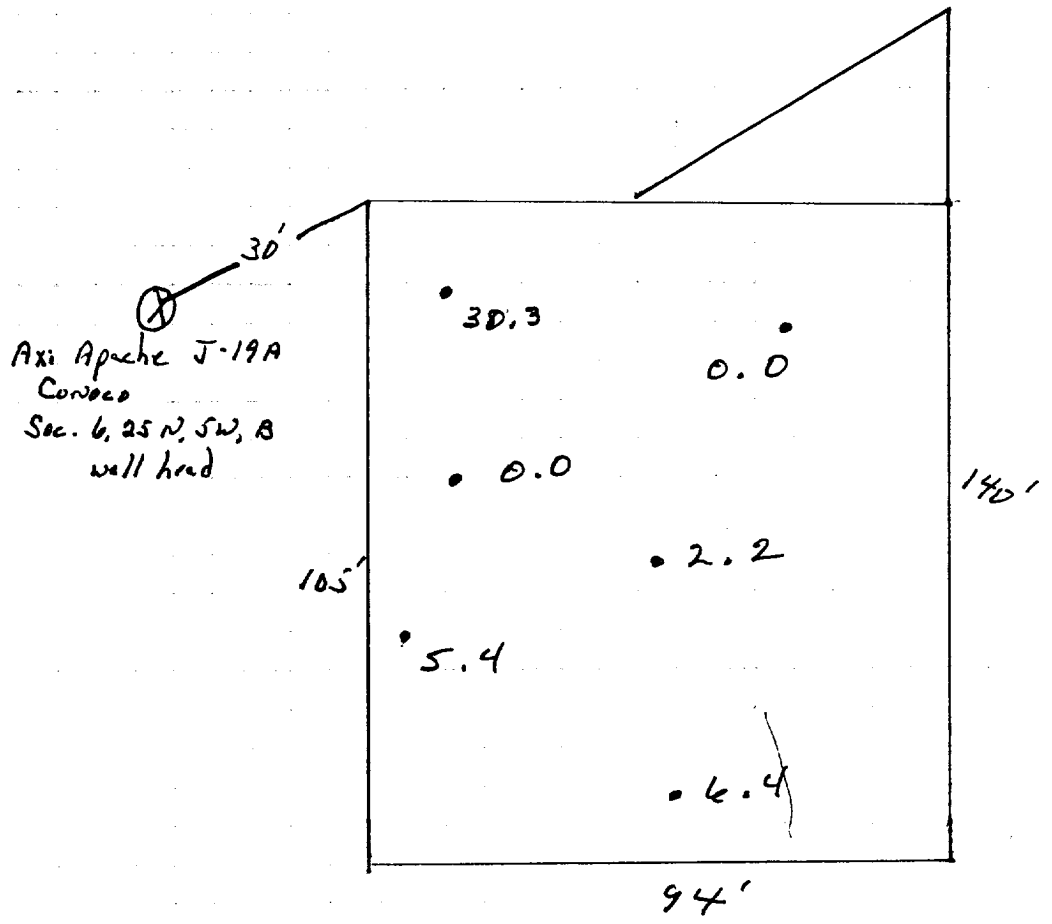

2"-12" depth
soil vapor head space 6.4

not to scale

OFF: (505) 325-5667



LAB: (505) 325-1556

ANALYTICAL REPORT

Date: 14-Oct-98

Client: PNM - Public Service Company of NM
Work Order: 9810005
Lab ID: 9810005-07A **Matrix:** SOIL
Project: Jicarilla Landfarms

Client Sample Info: Axi Apache J-1#2 LF
Client Sample ID: 9809301256; 6pt. Composite
Collection Date: 9/30/98 12:56:00 PM
COC Record: 7509

Parameter	Result	PQL	Qual	Units	DF	Date Analyzed
DIESEL RANGE ORGANICS		SW8015				
T/R Hydrocarbons: C10-C28	ND	25		mg/Kg	1	Analyst: HR 10/7/98

Qualifiers:

PQL - Practical Quantitation Limit

ND - Not Detected at Practical Quantitation Limit

J - Analyte detected below Practical Quantitation Limit

B - Analyte detected in the associated Method Blank

S - Spike Recovery outside accepted recovery limits

R - RPD outside accepted recovery limits

E - Value above quantitation range

Surr: - Surrogate

P.O. BOX 2606 • FARMINGTON, NM 87499

- TECHNOLOGY BLENDING INDUSTRY WITH THE ENVIRONMENT -

1 of 1