

MEXICO OIL CONSERVATION COMMISSION
Well Location and Acreage Dedication Plat

SECTION A.

Date August 17, 1964

Operator J. J. AUGUST & R. D. SAWYER Lease MOBIL FEDERAL
Well No. 1 Unit Letter J Section 36 Township 24 NORTH Range 1 WEST NMPM
Located 1980 Feet From SOUTH Line, 1980 Feet From EAST Line
County RIO ARriba G. L. Elevation 7200' Dedicated Acreage 80 Acres
Name of Producing Formation Gallup Zone - Mancos Sh. Pool Wildcat

1. Is the Operator the only owner* in the dedicated acreage outlined on the plat below? Yes XX No _____
2. If the answer to question One is "No," have the interests of all the owners been consolidated by communitization agreement or otherwise? Yes _____ No _____. If answer is "Yes," Type of Consolidation _____
3. If the answer to question Two is "No," list all the owners and their respective interests below:

OWNER

LAND DESCRIPTION

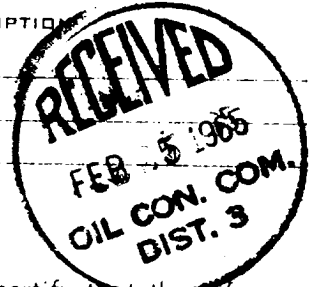

SECTION B.

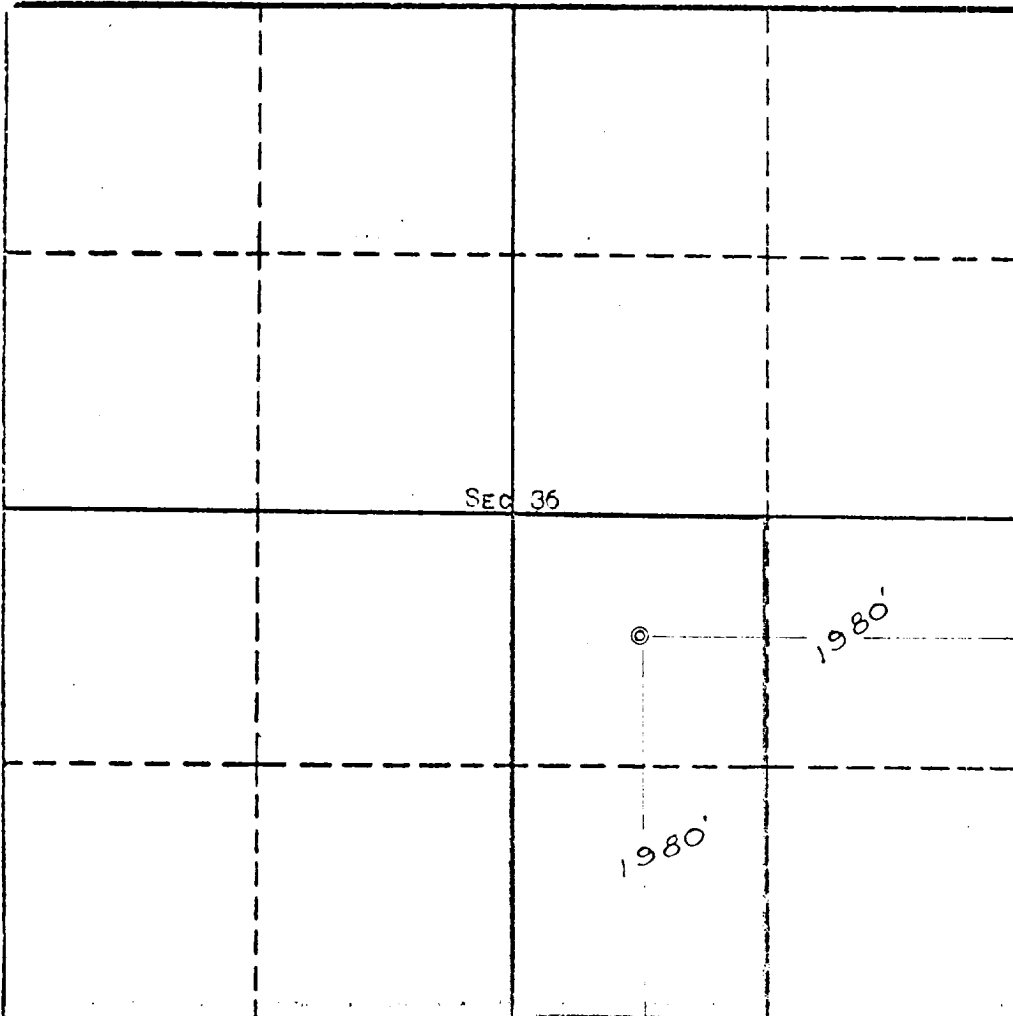

This is to certify that the information in Section A above is true and complete to the best of my knowledge and belief.

J. J. August and
R. D. Sawyer

(OPERATOR)

(REPRESENTATIVE)

1736 Westwood Blvd.
Los Angeles, California,
90024

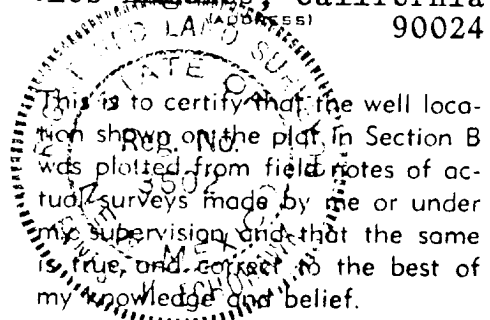

Date Surveyed AUGUST 14, 1964

Four States Engineering Co.
FARMINGTON, NEW MEXICO

Ernest V. Eckert
REGISTERED ENGINEER OR
LAND SURVEYOR

Certificate No. 3602

