

UNITED STATES
DEPARTMENT OF THE INTERIOR
GEOLOGICAL SURVEY

APPLICATION FOR PERMIT TO DRILL, DEEPEN, OR PLUG BACK

1a. TYPE OF WORK

DRILL ☒DEEPEN ☐PLUG BACK ☐

b. TYPE OF WELL

OIL
WELL ☐GAS
WELL ☒

OTHER

SINGLE
ZONE ☒MULTIPLE
ZONE ☐

2. NAME OF OPERATOR

Continental Oil Company

3. ADDRESS OF OPERATOR

200 North Wolcott, Casper, Wyoming 82601

4. LOCATION OF WELL (Report location clearly and in accordance with any State requirements.*)

At surface

1495' FSL, 1110' FWL

At proposed prod. zone

14. DISTANCE IN MILES AND DIRECTION FROM NEAREST TOWN OR POST OFFICE*

6734' GR

15. DISTANCE FROM PROPOSED*

LOCATION TO NEAREST
PROPERTY OR LEASE LINE, FT.
(Also to nearest drlg. unit line, if any)

16. NO. OF ACRES IN LEASE

2560

17. NO. OF ACRES ASSIGNED
TO THIS WELL

159.51

18. DISTANCE FROM PROPOSED LOCATION*
TO NEAREST WELL, DRILLING, COMPLETED,
OR APPLIED FOR, ON THIS LEASE, FT.

19. PROPOSED DEPTH

3880

20. ROTARY OR CABLE TOOLS

Rotary

21. ELEVATIONS (Show whether DF, RT, GR, etc.)

22. APPROX. DATE WORK WILL START*

1-20-69

23.

PROPOSED CASING AND CEMENTING PROGRAM

SIZE OF HOLE	SIZE OF CASING	WEIGHT PER FOOT	SETTING DEPTH	QUANTITY OF CEMENT
12-1/4	8-5/8	24	200	100 sacks
6-3/4	4-1/2	11.6	3880	200 sacks

We propose to drill the subject well to further test and develop the Chacra formation. If commercial production is encountered, 4-1/2" casing will be run to TD, the productive formation will be perforated, and sand-water fractured. The drilling rig will be equipped with a blowout preventer.

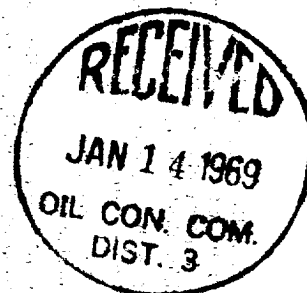
USGS-Durango(3) NMOCC(2) RCB File

IN ABOVE SPACE DESCRIBE PROPOSED PROGRAM: If proposal is to deepen or plug back, give data on present productive zone and proposed new productive zone. If proposal is to drill or deepen directionally, give pertinent data on subsurface locations and measured and true vertical depths. Give blowout preventer program, if any.

24.

ORIGINAL SIGNED BY:

SIGNED

J. A. UBBEN

TITLE

Admin. Section Chief

DATE

1-10-69

(This space for Federal or State office use)

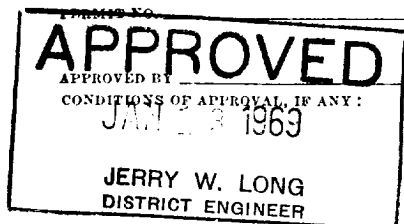

APPROVAL DATE

TITLE

DATE

*See Instructions On Reverse Side

All distances must be from the outer boundaries of the Section

J

13

€734.0

CONCLUSIONS

0700 0404

159.51

RECEIVED
JAN 14 1969
OIL CON. COM.
DIST. 3

I hereby certify that the information contained herein is true and complete to the best of my knowledge and belief.

ORIGINAL SIGNED BY:

J. A. UBBEN

Adm. Section Chief

Continental Oil Company

January 10, 1969

13.

I hereby certify that the well location shown on this plat was plotted from field notes of actual surveys made by me or under my supervision, and that the same is true and correct to the best of my knowledge and belief.

4 January, 1969

Registered Professional Engineer
 and/or Land Surveyor
JAMES P. LEET

1463
Certificate No.

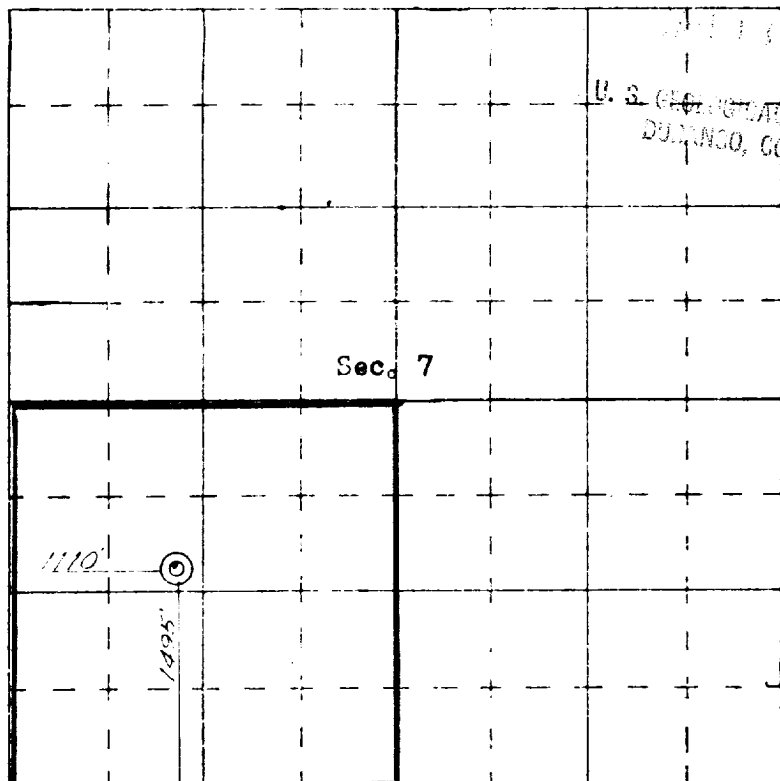

SCALE—4 INCHES EQUALS 1 MILE

SAN JUAN ENGINEERING COMPANY, FARMINGTON, N. M.