

UNITED STATES
DEPARTMENT OF THE INTERIOR
GEOLOGICAL SURVEY

(Other instructions on reverse side)

Budget Bureau No. 42-R1425.

039
30-24-20227

5. LEASE DESIGNATION AND SERIAL NO.

65

6. IF INDIAN, ALLOTTEE OR TRIBE NAME

Jicarilla Apache

7. UNIT AGREEMENT NAME

8. FARM OR LEASE NAME

Jicarilla 22

9. WELL NO.

4

10. FIELD AND POOL, OR WILDCAT

Undesignated Gallup
Undesignated Dakota

11. SEC., T., R., M., OR BLK.
AND SURVEY OR AREA

Sec. 15, T25N, R4W

12. COUNTY OR PARISH

13. STATE

Rio Arriba

New Mexico

1a. TYPE OF WORK

DRILL ☒

DEEPEN ☐

PLUG BACK ☐

b. TYPE OF WELL

OIL WELL ☒

GAS WELL ☐

OTHER

SINGLE ZONE ☐

MULTIPLE ZONE ☒

2. NAME OF OPERATOR

Continental Oil Company

3. ADDRESS OF OPERATOR

200 North Wolcott, Casper, Wyoming 82601

4. LOCATION OF WELL (Report location clearly and in accordance with any State requirements.)*

At surface

NW SE 2080' FSL, 2290' FEL (Unit Letter "D")

At proposed prod. zone

Same

14. DISTANCE IN MILES AND DIRECTION FROM NEAREST TOWN OR POST OFFICE*

10. DISTANCE FROM PROPOSED*

LOCATION TO NEAREST
PROPERTY OR LEASE LINE, FT.
(Also to nearest drig. unit line, if any.)

16. NO. OF ACRES IN LEASE

2560

17. NO. OF ACRES ASSIGNED
TO THIS WELL

40

18. DISTANCE FROM PROPOSED LOCATION*
TO NEAREST WELL, DRILLING, COMPLETED,
OR APPLIED FOR, ON THIS LEASE, FT.

19. PROPOSED DEPTH

8100'

20. ROTARY OR CABLE TOOLS

Rotary

21. ELEVATIONS (Show whether DF, RT, GR, etc.)

7086.5' Grd.

22. APPROX. DATE WORK WILL START*

6-23-69

23.

PROPOSED CASING AND CEMENTING PROGRAM

SIZE OF HOLE	SIZE OF CASING	WEIGHT PER FOOT	SETTING DEPTH	QUANTITY OF CEMENT
12 1/4"	8 5/8"	24#	200'	100 sacks
7 7/8"	5 1/2"	15.5# & 17#	8100'	700 sacks

We propose to drill this well to an estimated TD of 8100' to further develop the Gallup and Dakota reservoirs. If commercial production is encountered the well will be completed as follows:

Set and cement production casing to TD. Perforate and stimulate as indicated by logs. (A packer will be set approximately 150' above the Dakota to prevent communication between the two zones.) State approved producing equipment for downhole commingling in the tubing will be utilized to produce the two zones.

The drilling rig will be equipped with blowout preventer.

USGS-Durango(6) File

IN ABOVE SPACE DESCRIBE PROPOSED PROGRAM: If proposal is to deepen or plug back, give data on present productive zone and proposed new productive zone. If proposal is to drill or deepen directionally, give pertinent data on subsurface locations and measured and true vertical depths. Give blowout preventer program, if any.

24.

Original Signed By:

J. A. UBBEN

SIGNED

TITLE Administrative Section Chief

DATE

6-16-69

(This space for Federal or State office use)

PERMIT NO.

APPROVAL DATE

APPROVED BY

TITLE

CONDITIONS OF APPROVAL, IF ANY:

OK

*See Instructions On Reverse Side

U. S. GEOLOGICAL SURVEY
DURANGO, COLO.

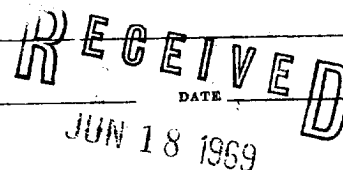
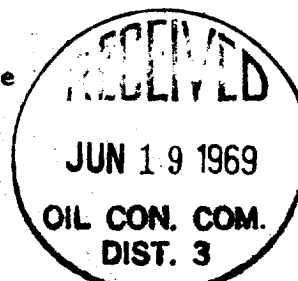

**NEW MEXICO OIL CONSERVATION COMMISSION
WELL LOCATION AND ACERAGE DEDICATION PLAT**

All distances must be from the outer boundaries of the Section

Operator **CONTINENTAL OIL COMPANY** Lease **22** Well No. **4**
 Unit Letter **J** Section **15** Township **25 NORTH** Range **4 WEST** County **RIO ARriba**
 Actual Footage Location of Well: **2080** feet from the **SOUTH** line of **2290** feet from the **EAST** line
 Ground Level Elev **7086.5** **Gallop-Sabote (Duel)** **Undesignated Gallop** **Undesignated Sabote** **0-40, 2-40** Acres

- Outline the acreage dedicated to the subject well by colored pencil or hachure marks on the plat below
- If more than one lease is dedicated to the well, outline each and identify the ownership thereof (the working interest and royalty).
- If more than one lease of different ownership is dedicated to the well, have the interests of all owners been consolidated by communitization, unitization, force-pooling, etc?
☐ Yes ☐ No If answer is "yes," type of consolidation _____

If answer is "no," list the owners and tract descriptions which have actually consolidated. (Use reverse of this form if necessary) _____

No allowable will be assigned to the well until all interests have been consolidated (by communitization, unitization, forced-pooling, or otherwise) or until a non standard unit, eliminating such interests, has been approved by the Commission.

CERTIFICATION

I hereby certify that the information contained herein is true and complete to the best of my knowledge and belief.

Name J. A. Wheeler
 Position **Administrative Section Chief**
 Company **Continental Oil Company**
 Date **June 16, 1969**

I hereby certify that the well location shown on this plat was plotted from field notes of actual surveys made by me or under my supervision, and that the same is true and correct to the best of my knowledge and belief.

24 January, 1969

Date Surveyed James P. Leese
 Registered Professional Engineer
 and/or Land Surveyor
JAMES P. LEESE

1463
 Certificate No.

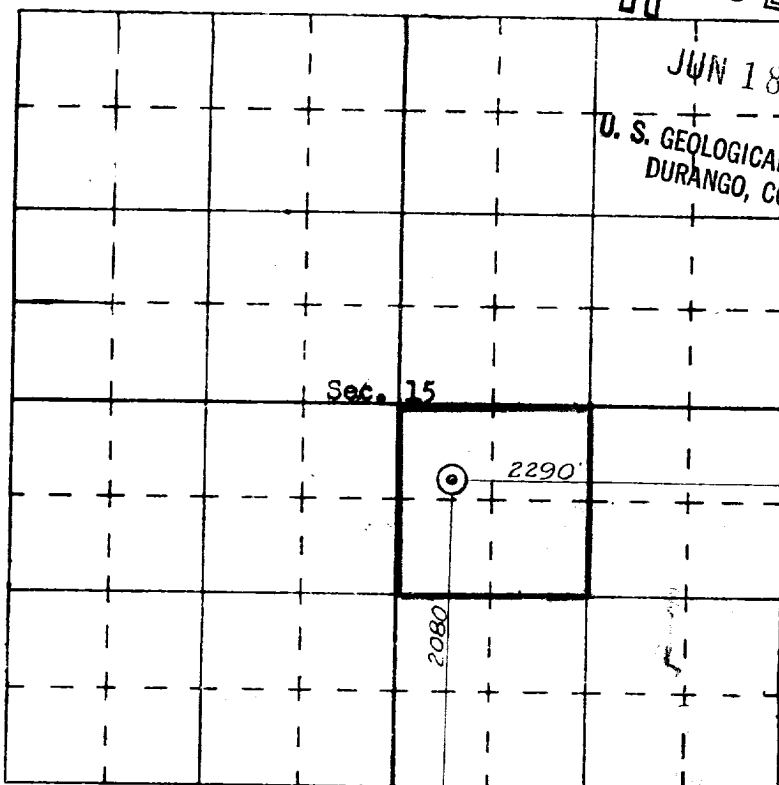

SCALE—4 INCHES EQUALS 1 MILE

SAN JUAN ENGINEERING COMPANY, FARMINGTON, N. M.