

UNITED STATES
DEPARTMENT OF THE INTERIOR
GEOLOGICAL SURVEY

30-039-20351

APPLICATION FOR PERMIT TO DRILL, DEEPEN, OR PLUG BACK

1a. TYPE OF WORK

DRILL ☒DEEPEN ☐PLUG BACK ☐

b. TYPE OF WELL

OIL
WELL ☒GAS
WELL ☐OTHER ☐SINGLE
ZONE ☐MULTIPLE
ZONE ☐

2. NAME OF OPERATOR

Continental Oil Company

3. ADDRESS OF OPERATOR

152 North Durbin, Casper, Wyoming 82601

4. LOCATION OF WELL (Report location clearly and in accordance with any State requirements.)*

At surface

660' FNL, 970' FEL (Unit Letter "A")

At proposed prod. zone

14. DISTANCE IN MILES AND DIRECTION FROM NEAREST TOWN OR POST OFFICE*

15. DISTANCE FROM PROPOSED*

LOCATION TO NEAREST
PROPERTY OR LEASE LINE, FT.
(Also to nearest drlg. unit line, if any)

16. NO. OF ACRES IN LEASE

2560

17. NO. OF ACRES ASSIGNED
TO THIS WELL

40

18. DISTANCE FROM PROPOSED LOCATION*
TO NEAREST WELL, DRILLING, COMPLETED,
OR APPLIED FOR, ON THIS LEASE, FT.

19. PROPOSED DEPTH

7745'

20. ROTARY OR CABLE TOOLS

Rotary

21. ELEVATIONS (Show whether DF, RT, GR, etc.)

6943' Gr.

22. APPROX. DATE WORK WILL START*

12-28-70

23.

PROPOSED CASING AND CEMENTING PROGRAM

SIZE OF HOLE	SIZE OF CASING	WEIGHT PER FOOT	SETTING DEPTH	QUANTITY OF CEMENT
12 1/4"	8 5/8"	24	200'	to surface
7 7/8"	4 1/2"	10.5	7745'	885 sacks (2 stage)

We propose to drill this well to further develop the Gallup and Dakota reserves. No coring or DST's are planned. All appropriate logs will be run. The rig will be equipped with a blowout preventer. If commercial production is encountered the well will be completed by running production casing as indicated above, perforated, stimulated, and will dual complete and commingle as approved by NMCCC Case No. 4462, Order No. R-4071, dated 12-1-70, a copy of which is attached.

RECEIVED

DEC 21 1970

U. S. GEOLOGICAL SURVEY
DURANGO COLO

USGS Durango(6) File(2)

IN ABOVE SPACE DESCRIBE PROPOSED PROGRAM: If proposal is to deepen or plug back, give data on present productive zone and proposed new productive zone. If proposal is to drill or deepen directionally, give pertinent data on subsurface locations and measured and true vertical depths. Give blowout preventer program, if any.

24.

SIGNED

TITLE Administrative Supervisor

DATE Dec. 16, 1970

(This space for Federal or State office use)

PERMIT NO.

APPROVAL DATE

APPROVED BY

TITLE

DATE

CONDITIONS OF APPROVAL, IF ANY:

*See Instructions On Reverse Side

NEW MEXICO OIL CONSERVATION COMMISSION WELL LOCATION AND ACERAGE DEDICATION PLAT

All distances must be from the outer boundaries of the Section

Section 28 Jicarilla 28 9
CONTINENTAL OIL COMPANY
A 28 15 NORTH 4 WEST RIO ARriba
Actual location of Well
660 970
6942.0 Gallup-Dakota-Dual Undesignated Gallup Undesignated Dakota G-40, D-40
Area

Outline the acreage set out to the subject well by owner, or by or both in number on the plat below

1. If more than one lease is recorded to the well, set out acreage for each lease, showing ownership, interest, both as to working interest and royalty.

2. If more than one lease of different ownership is recorded to the well, set out acreage for all owners, after consolidation by communitization, unitization, forced pooling, etc.

3. Yes No If answer is "No", state in what way the well is not in compliance with the above requirements.

4. If owner is not the owner of record, state the name of the owner and the date of acquisition. (Use reverse side of this form if necessary.)

5. If allowable well is drilled to the well and all interests have been consolidated by communitization, unitization, forced pooling, etc., which created a non-unit, unit, or similar, such interests, has been approved by the Commission.

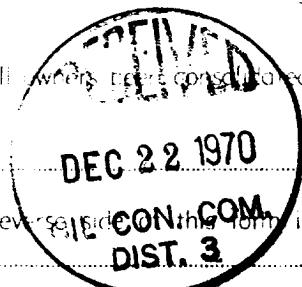

CERTIFICATION

I hereby certify that the information contained herein is true and complete to the best of my knowledge and belief.

Name *J. A. Ubben*

Administrative Supervisor
Position

Continental Oil Company
Company

December 16, 1970
Date

I hereby certify that the well location shown on this plat was plotted from field notes of actual surveys made by me or under my supervision, and that the same is true and correct to the best of my knowledge and belief.

8 December 1970
Professional Engineer
and Land Surveyor

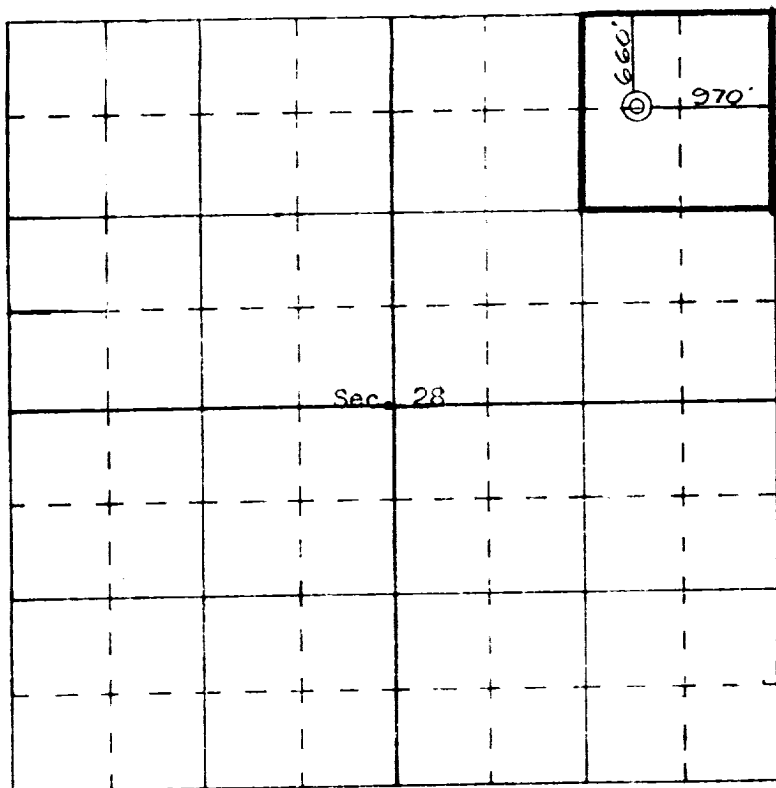

SCALE—4 INCHES EQUALS 1 MILE

SAN JUAN ENGINEERING COMPANY, FARMINGTON, N. M.

1463
Certificate No.