

UNITED STATES
DEPARTMENT OF THE INTERIOR
GEOLOGICAL SURVEY

APPLICATION FOR PERMIT TO DRILL, DEEPEN, OR PLUG BACK

30-039-20413

5. LEASE DESIGNATION AND SERIAL NO.
147

6. IF INDIAN, ALLOTTEE OR TRIBE NAME
Jicarilla Apache

7. UNIT AGREEMENT NAME

8. FARM OR LEASE NAME
AXI Apache "J"

9. WELL NO.
18

10. FIELD AND POOL, OR WILDCAT
Otero Chacra

11. SEC., T., R., M., OR BLK.
AND SURVEY OR AREA
Sec. 6, T25N, R5W

12. COUNTY OR PARISH
Rio Arriba

13. STATE
New Mexico

14. DISTANCE IN MILES AND DIRECTION FROM NEAREST TOWN OR POST OFFICE*

15. DISTANCE FROM PROPOSED*
LOCATION TO NEAREST
PROPERTY OR LEASE LINE, FT.
(Also to nearest drlg. unit line, if any)

16. NO. OF ACRES IN LEASE
2560

17. NO. OF ACRES ASSIGNED
TO THIS WELL
~~100~~ 159.11

18. DISTANCE FROM PROPOSED LOCATION*
TO NEAREST WELL, DRILLING, COMPLETED,
OR APPLIED FOR, ON THIS LEASE, FT.

19. PROPOSED DEPTH
3845'

20. ROTARY OR CABLE TOOLS
Rotary

21. ELEVATIONS (Show whether DF, RT, GR, etc.)
6524' GR

22. APPROX. DATE WORK WILL START*
9-10-71

23. PROPOSED CASING AND CEMENTING PROGRAM

SIZE OF HOLE	SIZE OF CASING	WEIGHT PER FOOT	SETTING DEPTH	QUANTITY OF CEMENT
12 1/4"	8 5/8"	24.0#	200'	100 sacks (to surface)
7 7/8"	4 1/2"	11.6#	3845'	160 sacks (to 200' above P.C.)

We propose to drill this well to develop the Chacra reserves. No cores or DST's are planned. All appropriate logs will be run. The rig will be equipped with a blowout preventer.



USGS(6) File(2)

IN ABOVE SPACE DESCRIBE PROPOSED PROGRAM: If proposal is to deepen or plug back, give data on present productive zone and proposed new productive zone. If proposal is to drill or deepen directionally, give pertinent data on subsurface locations and measured and true vertical depths. Give blowout preventer program, if any.

24. SIGNED Elmer L. Phillips TITLE Administrative Supervisor DATE 8-23-71
(This space for Federal or State office use)

PERMIT NO. _____ APPROVAL DATE _____

APPROVED BY Cee TITLE _____ DATE AUG 29 1971
CONDITIONS OF APPROVAL, IF ANY:

**NEW MEXICO OIL CONSERVATION COMMISSION
WELL LOCATION AND ACERAGE DEDICATION PLAT**

All distances must be from the outer boundaries of the Section

Operator **CONTINENTAL OIL COMPANY** Lease **JICARILLA "J"** Well No. **18**
 Unit Letter **L** Section **6** Township **25 NORTH** Range **5 WEST** County **RIO ARriba**
 Actual acreage location of Well **1695** feet from the **SOUTH** line of **950** feet from the **WEST** line
 acreage of the **6524.0** Chacra **Otero-Chacra** Dedicated Acreage **159.11-460** Acres

- Outline the acreage dedicated to the subject well by colored pencil or hatchure marks on the plat below.
- If more than one lease is dedicated to the well, outline each and identify the ownership thereof (both as to working interest and royalty).
- If more than one lease of different ownership is dedicated to the well, have the interests of all leases been consolidated by communitization, unitization, force-pooling, etc?
 Yes ☐ No ☐ If answer is "yes," type of consolidation _____
 If answer is "no," list the owners and tract descriptions which have actually consolidated. (Use reverse of this form if necessary) _____
 Has allowable well been agreed to the well until all interests have been consolidated (by communitization, unitization, forced-pooling, or otherwise) or until a non standard unit eliminating such interests, has been approved by the Commission. _____

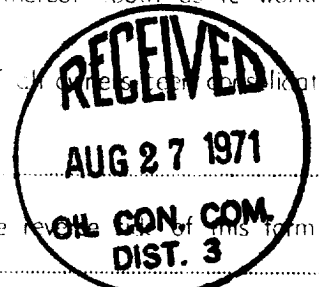

CERTIFICATION

I hereby certify that the information contained herein is true and complete to the best of my knowledge and belief.

Name *Elmer L. Phillips*
 Position Acty. Administrative Supervisor
 Company CONTINENTAL OIL COMPANY
 Date August 23, 1971

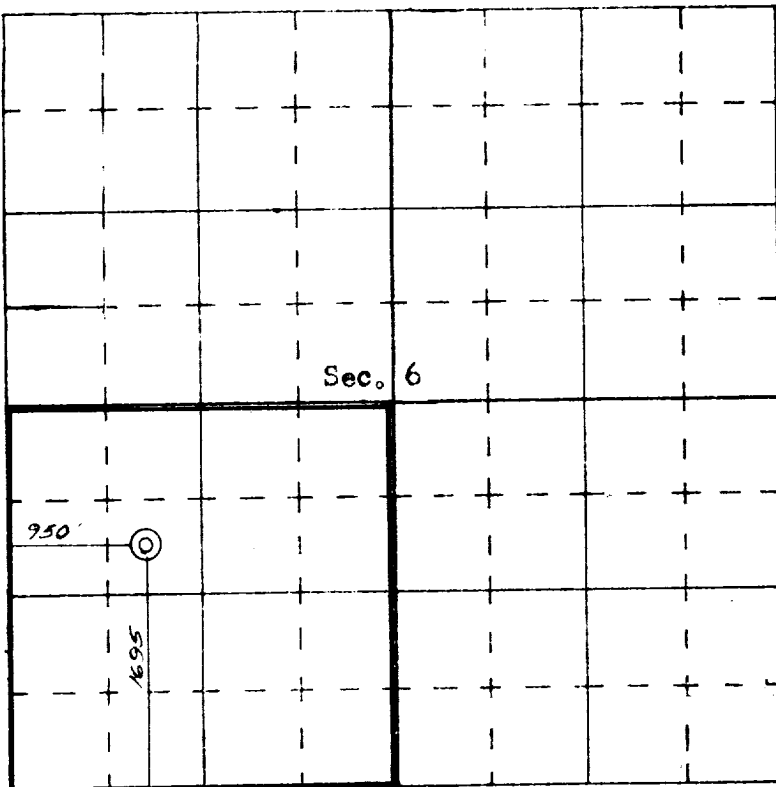

SCALE—4 INCHES EQUALS 1 MILE

I hereby certify that the well location shown on this plat was plotted from field notes of actual surveys made by me or under my supervision, and that the same is true and correct to the best of my knowledge and belief.

Date Surveyed 18 August, 1971
 Registered Professional Engineer and/or Land Surveyor *James P. Leese*
JAMES P. LEESE

1463
 Certificate No. _____