

UNITED STATES
DEPARTMENT OF THE INTERIOR
GEOLOGICAL SURVEY

APPLICATION FOR PERMIT TO DRILL, DEEPEN, OR PLUG BACK

1a. TYPE OF WORK DRILL <input checked="" type="checkbox"/> DEEPEN <input type="checkbox"/> PLUG BACK <input type="checkbox"/>		5. LEASE DESIGNATION AND SERIAL NO. 66
b. TYPE OF WELL OIL WELL <input checked="" type="checkbox"/> GAS WELL <input type="checkbox"/> OTHER <input type="checkbox"/> SINGLE ZONE <input type="checkbox"/> MULTIPLE ZONE <input checked="" type="checkbox"/>		6. IF INDIAN, ALLOTTEE OR TRIBE NAME Jicarilla Apache
2. NAME OF OPERATOR Continental Oil Company		7. UNIT AGREEMENT NAME
3. ADDRESS OF OPERATOR 152 North Durbin, Casper, Wyoming 82601		8. FARM OR LEASE NAME Jicarilla 28
4. LOCATION OF WELL (Report location clearly and in accordance with any State requirements.) At surface NE NE 375' FNL, 925' FEL (Unit Letter "A") At proposed prod. zone		9. WELL NO. 13
14. DISTANCE IN MILES AND DIRECTION FROM NEAREST TOWN OR POST OFFICE*		10. FIELD AND POOL, OR WILDCAT W. Lindrith - Undesignated Gallup and Dakota
15. DISTANCE FROM PROPOSED* LOCATION TO NEAREST PROPERTY OR LEASE LINE, FT. (Also to nearest drg. unit line, if any)		11. SEC., T., R., M., OR BLK. AND SURVEY OR AREA Sec. 27, T25N, R4W
16. NO. OF ACRES IN LEASE 2560		12. COUNTY OR PARISH Rio Arriba
17. NO. OF ACRES ASSIGNED TO THIS WELL 40		13. STATE New Mexico
18. DISTANCE FROM PROPOSED LOCATION* TO NEAREST WELL, DRILLING COMPLETED, OR APPLIED FOR, ON THIS LEASE, FT. 7735'		20. ROTARY OR CABLE TOOLS Rotary
21. ELEVATIONS (Show whether D.P., RT., GR., etc.) 6931.0' GR		22. APPROX. DATE WORK WILL START* 9-30-71

23. PROPOSED CASING AND CEMENTING PROGRAM				
SIZE OF HOLE	SIZE OF CASING	WEIGHT PER FOOT	SETTING DEPTH	QUANTITY OF CEMENT
12 1/4"	3 5/8"	24#	200'	to surface
7 7/8"	4 1/2"	11.6# & 10.5#	7735'	885 sacks (2-stage)

Location Change

We were advised by the New Mexico Oil Conservation Commission that our original request to drill this well in the NE NE Section 27, T25N, R4W (1190' FNL, 990' FEL) was not a standard location and that Administrative approval would be required.

The well has been restaked at the above new location to conform with the New Mexico Oil Conservation Commission request. We propose to drill this well to further develop the Gallup and Dakota reserves. No coring of DST's is planned. All appropriate logs will be run. The rig will be equipped with a blowout preventer. If commercial production is encountered the well will be completed by running production casing as indicated above, perforated, stimulated, and dually completed.

IN ABOVE SPACE DESCRIBE PROPOSED PROGRAM: If proposal is to deepen or plug back, give data on present productive zone and proposed new productive zone. If proposal is to drill or deepen directionally, give pertinent data on subsurface locations and measured and true vertical depths. Give blowout preventer program, if any.

SIGNED <u>[Signature]</u>	TITLE <u>Administrative Supervisor</u>	DATE <u>9-22-71</u>
(This space for Federal or State office use)		
PERMIT NO. _____	APPROVAL DATE _____	
APPROVED BY _____	DATE _____	
CONDITIONS OF APPROVAL, IF ANY:		

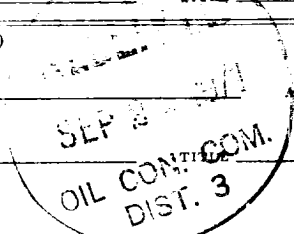

*See Instructions On Reverse Side

**NEW MEXICO OIL CONSERVATION COMMISSION
WELL LOCATION AND ACERAGE DEDICATION PLAT**

All distances must be from the outer boundaries of the Section

Operator CONTINENTAL OIL COMPANY			Lease JICARILLA 28		Well No. 13
Unit Letter A	Section 27	Township 25 NORTH	Range 4 WEST	County RIO ARriba	
Actual Footage Location of Well:					
375	feet from the	NORTH	line and	925	feet from the
Ground Level Elev.	Producing Formation		East		Dedicated Acreage.
6931.0					Acres

1. Outline the acreage dedicated to the subject well by colored pencil or hatchure marks on the plat below.
2. If more than one lease is dedicated to the well, outline each and identify the ownership thereof (both as to working interest and royalty).
3. If more than one lease of different ownership is dedicated to the well, have the interests of all owners been consolidated by communization, unitization, force-pooling, etc?
☐ Yes ☐ No If answer is "yes," type of consolidation: _____

If answer is "no," list the owners and tract descriptions which have actually consolidated. (Use reverse side of this form if necessary.) _____

No allowable will be assigned to the well until all interests have been consolidated (by communization, unitization, force-pooling, or otherwise) or until a non standard unit, eliminating such interests, has been approved by the Commission.

CERTIFICATION

I hereby certify that the information contained herein is true and complete to the best of my knowledge and belief.

Name _____

Position _____

Company _____

Date _____

I hereby certify that the well location shown on this plat was plotted from field notes of actual surveys made by me or under my supervision and that the same is true and correct to the best of my knowledge and belief.

18 September, 1971

Date Surveyed _____

James P. Leese
Registered Professional Engineer
and/or Land Surveyor

JAMES P. LEESE

1463

Certificate No. _____

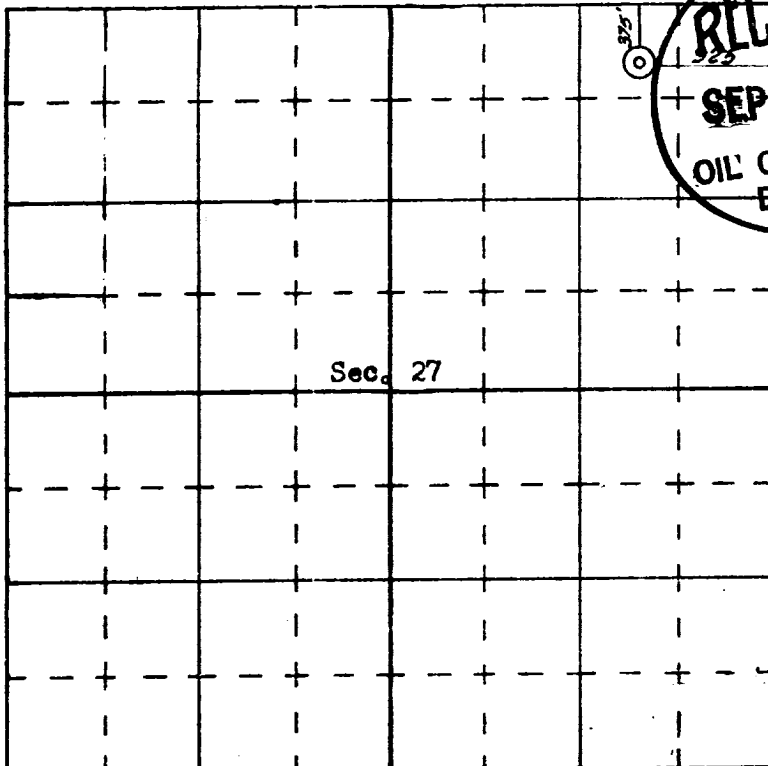

SCALE—4 INCHES EQUALS 1 MILE

SAN JUAN ENGINEERING COMPANY, FARMINGTON, N. M.