

UNITED STATES  
DEPARTMENT OF THE INTERIOR  
GEOLOGICAL SURVEY

## APPLICATION FOR PERMIT TO DRILL, DEEPEN, OR PLUG BACK

## 1a. TYPE OF WORK

DRILL ☒DEEPEN ☐PLUG BACK ☐

## b. TYPE OF WELL

OIL  
WELL ☒GAS  
WELL ☒

OTHER

## 2. NAME OF OPERATOR

SOUTHERN UNION PRODUCTION COMPANY

## 3. ADDRESS OF OPERATOR

P. O. Box 808, FARMINGTON, NEW MEXICO 87401

## 4. LOCATION OF WELL (Report location clearly and in accordance with any State requirements.)\*

At surface

940 FT. FROM THE SOUTH LINE AND 1850 FT. FROM THE WEST LINE.  
At proposed prod. zone SAME AS ABOVE.

## 14. DISTANCE IN MILES AND DIRECTION FROM NEAREST TOWN OR POST OFFICE\*

15 MILES NORTHWEST OF COUNSELLORS, NEW MEXICO

## 15. DISTANCE FROM PROPOSED\*

LOCATION TO NEAREST  
PROPERTY OR LEASE LINE, FT.  
(Also to nearest drlg. unit line, if any)

1850 FT. - LEASE LINE

## 18. DISTANCE FROM PROPOSED LOCATION\*

TO NEAREST WELL, DRILLING, COMPLETED,  
OR APPLIED FOR, ON THIS LEASE, FT.

1190 APPROX.

## 19. PROPOSED DEPTH

7180 FT.

## 21. ELEVATIONS (Show whether DF, RT, GR, etc.)

6745 FT. UNGRADED GROUND LEVEL

## 23.

## PROPOSED CASING AND CEMENTING PROGRAM

SIZE OF HOLE	SIZE OF CASING	WEIGHT PER FOOT	SETTING DEPTH	QUANTITY OF CEMENT
12-1/4"	8-5/8"	24.0#	300 FT.	250 BAGS
7-7/8"	5-1/2"	15.5#	7180 FT.	2400 CU. FT.

WE PROPOSE TO DRILL A WELL TO BE FULLY COMPLETED IN THE GALLUP AND DAKOTA FORMATIONS.  
ANTICIPATED TOTAL DEPTH 7180 FEET.

## 1. CASING PROGRAM:

SURFACE: 8-5/8", 24.0#, J-55 SET AT 300 FT. CEMENTED TO SURFACE w/250 BAGS.  
PRODUCTION: 5-1/2", 15.50# SET AT TOTAL DEPTH OF 7180 FT. R.K.B.

1ST STAGE CEMENTED w/600 CU. FT. OF CEMENT. STAGE COLLAR SET AT  
APPROX. 5000 FT. UNDER MESAVERDE AND CEMENTED w/400 CU. FT. OF CEMENT.  
STAGE COLLAR SET UNDER CHAGRA AT APPROX. 3700 FT. AND CEMENTED WITH  
1400 CU. FT. OF CEMENT.

## 2. ROTARY TOOLS WILL BE USED TO MUD DRILL WELL FROM SURFACE TO TOTAL DEPTH.

## 3. GALLUP AND DAKOTA FORMATIONS WILL BE SAID FRACED TO STIMULATE PRODUCTION.

## 4. BAKER 5-1/2" MODEL "D" PRODUCTION PACKER WILL BE SET AT APPROXIMATELY 6800 FT. R.K.B.

## 5. 2-1/16", 3.30#, JCN TUBING WILL BE RUN TO DAKOTA AND LANDED AT APPROX. 6950 FT. R.K.B.

## 6. 2-1/16", 3.30#, JCN TUBING WILL BE RUN TO GALLUP AND LANDED AT APPROX. 6180 FT. R.K.B.

IN ABOVE SPACE DESCRIBE PROPOSED PROGRAM: If proposal is to deepen or plug back, give data on present productive zone and proposed new productive zone. If proposal is to drill or deepen directionally, give pertinent data on subsurface locations and measured and true vertical depths. Give blowout preventer program, if any.

## 24.

ORIGINAL SIGNED BY

SIGNED B. R. VANDERSLICE  
BILL VANDERSLICE  
(This space for Federal or State office use)TITLE AREA SUPERINTENDENTDATE SEPTEMBER 28, 1971PERMIT NO. 94

APPROVAL DATE

APPROVED BY

TITLE

CONDITIONS OF APPROVAL, IF ANY:

RECEIVED

OCT 1 1971

\*See Instructions On Reverse Side

U. S. GEOLOGICAL SURVEY  
DURANGO, COLO.

## Instructions

**General:** This form is designed for submitting proposals to perform certain well operations, as indicated, on all types of lands and leases for appropriate action by either a Federal or a State agency, or both, pursuant to applicable Federal and/or State laws and regulations. Any necessary special instructions concerning the use of this form and the number of copies to be submitted, particularly with regard to local, area, or regional procedures and practices, either are shown below or will be issued by, or may be obtained from, the local Federal and/or State office.

**Item 1:** If the proposal is to redrill to the same reservoir at a different subsurface location or to a new reservoir, use this form with appropriate notations. Consult applicable State or Federal regulations concerning subsequent work proposals or reports on the well.

**Item 4:** If there are no applicable State requirements, locations on Federal or Indian land should be described in accordance with Federal requirements. Consult local State or Federal office for specific instructions.

**Item 14:** Needed only when location of well cannot readily be found by road from the land or lease description. A plat, or plats, separate or on this reverse side, showing the roads to, and the surveyed location of, the well, and any other required information, should be furnished when required by Federal or State agency offices.

**Items 15 and 18:** If well is to be, or has been directionally drilled, give distances for subsurface location of hole in any present or objective production zone.

**Item 22:** Consult applicable Federal or State regulations, or appropriate officials, concerning approval of the proposal before operations are started.

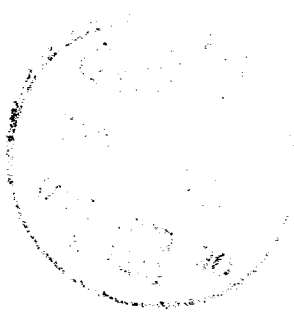

# NEW MEXICO OIL CONSERVATION COMMISSION

## WELL LOCATION AND ACERAGE DEDICATION PLAT

All distances must be from the outer boundaries of the Section

Operator <b>SOUTHERN UNION PRODUCTION COMPANY</b>		Lease <b>JICARILLA L</b>		Well No. <b>5</b>
Unit Letter <b>N</b>	Section <b>33</b>	Township <b>25 NORTH</b>	Range <b>5 WEST</b>	County <b>RIO ARriba</b>
Actual Footage Location of Well: <b>940</b> feet from the <b>SOUTH</b> line and <b>1850</b> feet from the <b>WEST</b> line				
Ground Level Elev. <b>6745.0</b>	Producing Formation <b>GALLUP - DAKOTA</b>	Pool <b>BASIN DAKOTA OTERO GALLUP</b>	Dedicated Acreage <b>DAKOTA - 320 GALLUP - 40</b> Acres	

- Outline the acreage dedicated to the subject well by colored pencil or hachure marks on the plat below.
- If more than one lease is dedicated to the well, outline each and identify the ownership thereof (both as to working interest and royalty).
- If more than one lease of different ownership is dedicated to the well, have the interests of all owners been consolidated by communitization, unitization, force-pooling, etc?

( ) Yes ( ) No If answer is "yes," type of consolidation .....

If answer is "no," list the owners and tract descriptions which have actually consolidated. (Use reverse side of this form if necessary.) .....

No allowable will be assigned to the well until all interests have been consolidated (by communitization, unitization, forced-pooling, or otherwise) or until a non standard unit, eliminating such interests, has been approved by the Commission.

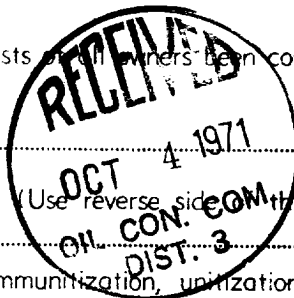

### CERTIFICATION

I hereby certify that the information contained herein is true and complete to the best of my knowledge and belief.

ORIGINAL SIGNED BY  
**B. R. VANDERSLICE**

Name .....

**BILL VANDERSLICE**

Position .....

**AREA SUPERINTENDENT**

Company .....

**SOUTHERN UNION PRODUCTION**

Date .....

**SEPTEMBER 28, 1971**

I hereby certify that the well location shown on this plat was plotted from field notes of actual surveys made by me or under my supervision, and that the same is true and correct to the best of my knowledge and belief.

Date **28 September, 1971**

Registered Professional Engineer  
and Professional Land Surveyor

**JAMES P. LEESE**

**1463**

Certificate No. ....

DEDICATED DAKOTA ACERAGE  
DEDICATED GALLUP ACERAGE

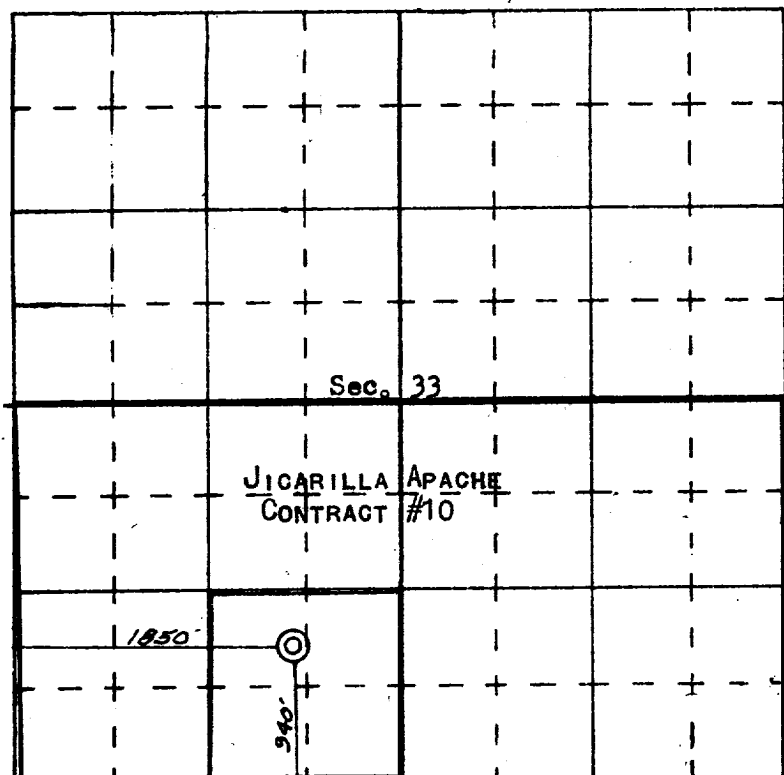

N

SCALE—4 INCHES EQUALS 1 MILE

SAN JUAN ENGINEERING COMPANY, FARMINGTON, N. M.